

MO1210

Plastic Moulded Inductor High L (0.12 μ H-150 μ H)

www.DataSheet4U.com

SMD RF Chip Inductors

Features

- Moulded wound chip inductors.
- Operating temperature (-40°C to +125°C).
- Resistance to solder heat 260 °C, 10 s.
- High current capacity.
- Excellent solderability and resistance to soldering heat.
- Suitable for flow and reflow soldering.

Dimensions

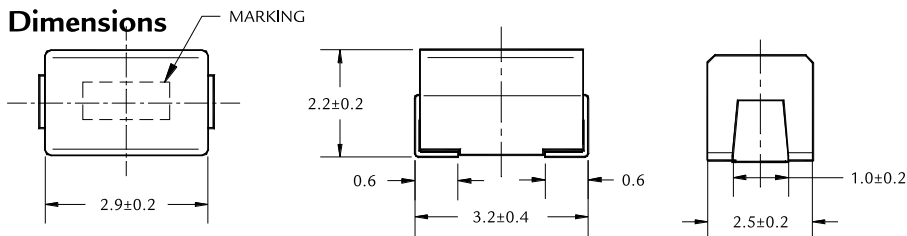

Product List

Ordering code ²	Lr (μ H)	Tolerance ¹	Marking	Q _{Min3}	f _i /f ₀ (MHz)	I _{DC} max. (mA)	RDC max. (Ω)	SRF Min. (MHz)
MO1210-121M	0.12	M	R12	30	25.20	450	0.22	500
MO1210-151M	0.15	M	R15	30	25.20	450	0.25	450
MO1210-181M	0.18	M	R18	30	25.20	450	0.28	400
MO1210-221M	0.22	M	R22	30	25.20	450	0.32	350
MO1210-271M	0.27	M	R27	30	25.20	450	0.36	320
MO1210-331M	0.33	M	R33	30	25.20	450	0.40	300
MO1210-391M	0.39	M	R39	30	25.20	450	0.45	250
MO1210-471M	0.47	M	R47	30	25.20	450	0.50	220
MO1210-561M	0.56	M	R56	30	25.20	450	0.55	180
MO1210-681M	0.68	M	R68	30	25.20	450	0.60	160
MO1210-821M	0.82	M	R82	30	25.20	450	0.65	140
MO1210-102K	1.00	K	1R0	30	7.960	400	0.70	120
MO1210-122K	1.20	K	1R2	30	7.960	390	0.75	100
MO1210-152K	1.50	K	1R5	30	7.960	370	0.85	85
MO1210-182K	1.80	K	1R8	30	7.960	350	0.90	80
MO1210-222K	2.20	K	2R2	30	7.960	320	1.00	75
MO1210-272K	2.70	K	2R7	30	7.960	290	1.10	70
MO1210-332K	3.30	K	3R3	30	7.960	260	1.20	60
MO1210-392K	3.90	K	3R9	30	7.960	250	1.30	55
MO1210-472K	4.70	K	4R7	30	7.960	220	1.50	50
MO1210-562K	5.60	K	5R6	30	7.960	200	1.60	47
MO1210-682K	6.80	K	6R8	30	7.960	180	1.80	43
MO1210-822K	8.20	K	8R2	30	7.960	170	2.00	40
MO1210-103K	10.0	K	100	30	2.520	150	2.10	36
MO1210-123K	12.0	K	120	30	2.520	140	2.50	33
MO1210-153K	15.0	K	150	30	2.520	130	2.80	28
MO1210-183K	18.0	K	180	30	2.520	120	3.30	25
MO1210-223K	22.0	K	220	30	2.520	110	3.70	23
MO1210-273K	27.0	K	270	30	2.520	80	5.00	18
MO1210-333K	33.0	K	330	30	2.520	70	5.60	17
MO1210-393K	39.0	K	390	30	2.520	65	6.40	16
MO1210-473K	47.0	K	470	30	2.520	60	7.00	15
MO1210-563K	56.0	K	560	30	2.520	55	8.00	13
MO1210-683K	68.0	K	680	30	2.520	50	9.00	12
MO1210-823K	82.0	K	820	30	2.520	45	10.0	11
MO1210-104K	100	K	101	20	0.796	40	11.0	10
MO1210-124K	120	K	121	20	0.796	70	11.0	10
MO1210-154K	150	K	151	20	0.796	65	15.0	8

Applications.

- Computers.
- VCR and TV.
- Notebooks.
- Digital cameras

Materials:

- A: Ferrite DR core.
- B: Enamelled copper wire class H.
- C: Terminal: Cu/Sn
- D: Encapsulate: epoxy NOVOLAC moulding compound.

Pad layout

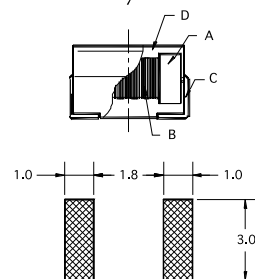

1. Closer tolerances upon request.
2. Replace the + by the code letter for the required inductance tolerance (G=2%, J=5%, K=10%, M=20%).
3. See Q graphics in page for more details.