

2 Phase Hybrid Stepper Motor 14HR series-Size 36mm(0.9 degree)

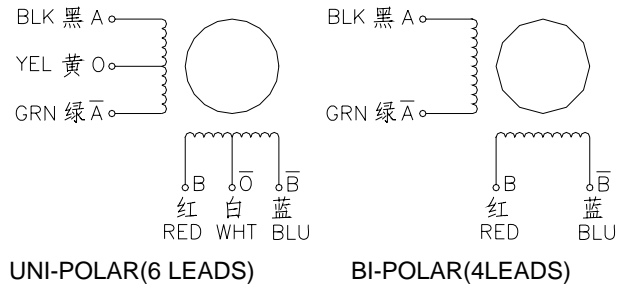

Wiring Diagram:



Electrical Specifications:

Series Model	Step Angle (deg)	Motor Length (mm)	Rated Current (A)	Phase Resistance (ohm)	Phase Inductance (mH)	Holding Torque (N.cm Min)	Detent Torque (N.cm Max)	Rotor Inertia (g.cm ²)	Lead Wire (No.)	Motor Weight (g)
14HR1403	0.9	15.2	0.3	16.8	8.5	3.6	0.3	7.3	4	60
14HR2445	0.9	19.7	0.45	15	8.2	8.8	0.3	19	4	110

*Note: We can manufacture products according to customer's requirements.

Dimensions: unit=mm

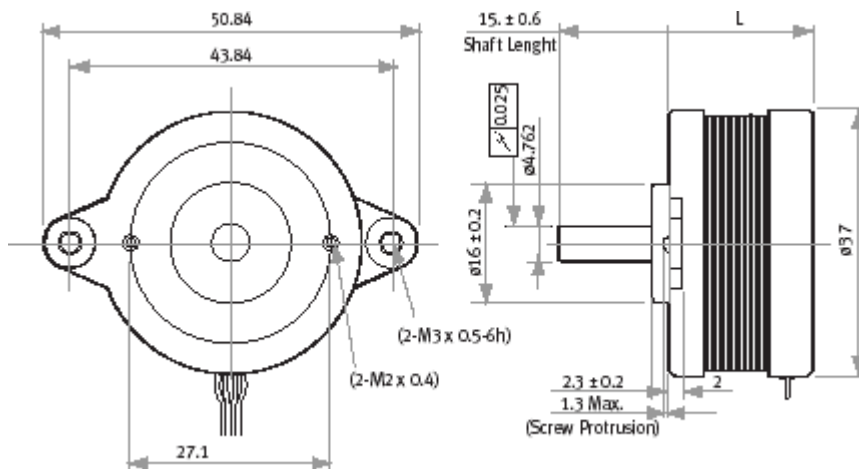

Motor Length:

Model	Length
14HR1XXX	15.2 mm
14HR2XXX	19.7 mm