

# Technical Data

## DIODE



### maximum ratings

Voltage, Reverse (VR)	3.0	V	NO.	1N23E
Voltage, Reverse Peak (VRM)	4.0	V	TYPE	MICROWAVE
Current at VR = 0V (IO)		A		X-BAND
Current Average Rectified (IF)	0.03	A		
Current Surge Peak (IFM)		A	CASE	DO-23
Current, Surge (IFM) at tp =		A		
Max. Power Dissipation (PT) at TC = °C		W		
Max. Thermal Resistance (Rth J-A)		°C/W		
Max. Junction Temperature (TJ)	90.0	°C		

### PERFORMANCE CHARACTERISTICS at $T_c = 25^\circ\text{C}$ , unless otherwise noted

NO.	SYMBOL	CONDITIONS	MIN.	MAX.	UNITS
1.	NF	f = 9.375 GHz	-	7.5	dB
2.	ZIF	f = 9.375 GHz	335.0	465.0	$\Omega$
3.	VSWR	f = 9.375 GHz, Pin = 1.0 mW	-	1.3	-
4.	Lc	f = 9.375 GHz, Pin = 1.0 mW	-	5.0	dB
5.					
6.					
7.					
8.					
9.					
10.					
11.					
12.					
13.					
14.					
15.					
16.					
17.					
18.					
19.					
20.					

Notes

DIMENSIONS  
in mm

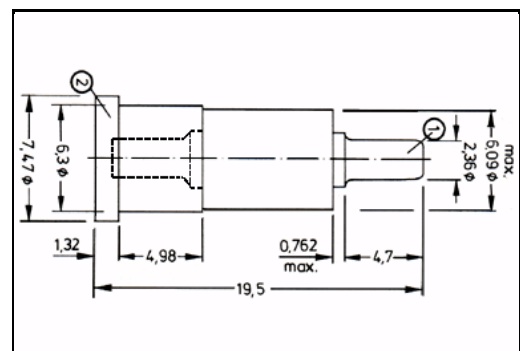

Marking 1N23E  
Customer GENERAL PURPOSE