

1N6097-1N6098

50 AMP SCHOTTKY RECTIFIER

FEATURES

- Available as "HR" (high reliability) screened per MIL-PRF-19500, JANTX level. Add "HR" suffix to base part number.
- Available as non-RoHS (Sn/Pb plating), standard, and as RoHS by adding "-PBF" suffix.

MAXIMUM RATINGS

Parameter	Symbol	Value
Storage temperature range	T _{STG}	-65 to +150°C
Operating junction temperature range	T _J	-65 to +150°C
Maximum thermal resistance	R _{θJC}	1.0°C/W junction to Case
Maximum mounting torque		30 inch pounds maximum
Weight		0.54 ounces (15.3 grams) typical

ELECTRICAL CHARACTERISTICS (T_A = 25°C unless otherwise specified)

Parameter	Symbol	1N6097	1N6098	Test Condition
Working peak reverse voltage	V _{RWM}	30V	40V	
Peak repetitive reverse voltage	V _{RRM}	30V	40V	
Average forward current	I _{F(AV)}	50A		T _C = 70°C, square wave, R _{θJC} = 1.0°C/W
Maximum surge current	I _{FSM}	800A		8.3ms, half sine T _J = 150°C
Maximum repetitive peak reverse current	I _{R(OV)}	2A		f = 1 KHz, 25°C, 1 μsec square wave
Maximum peak forward voltage	V _{FM}	.60V		I _{FM} = 10A; T _J = 25°C*
Maximum peak forward voltage	V _{FM}	.86V		I _{FM} = 157A, T _J = 70°C*
Maximum peak reverse current	I _{RM}	250mA		V _{RRM} , T _J = 125°C*
Maximum peak reverse current	I _{RM}	2mA		V _{RRM} , T _J = 25°C
Typical junction capacitance	C _J	7000pF		V _R = 1.0V, T _J = 25°C

Pulse test: Pulse width 300 μsec, duty cycle 2%

1N6097-1N6098

50 AMP SCHOTTKY RECTIFIER

MECHANICAL CHARACTERISTICS

Case	DO-5(R)
Marking	Alpha numeric
Normal polarity	Cathode is stud
Reverse polarity	Anode is stud (add "R" suffix)

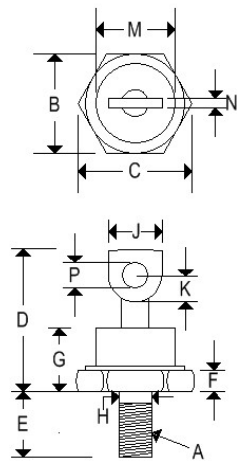

	DO-5(R)			
	Inches		Millimeters	
	Min	Max	Min	Max
A	¼-28 UNF2A threads			
B	0.669	0.688	16.990	17.480
C	-	0.794	-	20.160
D	-	1.000	-	25.400
E	0.422	0.453	10.720	11.510
F	0.115	0.200	2.920	5.080
G	-	0.450	-	11.430
H	0.220	0.249	5.580	6.320
J	0.250	0.375	6.350	9.530
K	0.156	-	3.960	-
M	-	0.667	-	16.940
N	0.030	0.080	0.760	2.030
P	0.140	0.175	3.560	4.450

1N6097-1N6098

50 AMP SCHOTTKY RECTIFIER

