



Solid State Devices, Inc.

14701 Firestone Blvd * La Mirada, Ca 90638
Phone: (562) 404-4474 * Fax: (562) 404-1773
ssdi@ssdi-power.com * www.ssdi-power.com

2R3S THRU 20R3S

**8 AMPS
20 – 200 VOLTS
35 nsec
HYPER FAST RECTIFIER**

Designer's Data Sheet

Part Number/Ordering Information ^{1/}

R3S Screening^{3/} = Not Screened
 TX = TX Level
 TXV = TXV Level
 S = S Level

Family/Voltage

2 = 20V
3 = 30V
4 = 40V
5 = 50V
7 = 70V
10 = 100V
12 = 125V
15 = 150V
20 = 200V

- Features:**
- Hyper Fast Recovery: 35nsec Maximum
 - Low Forward Voltage Drop
 - Low Reverse Leakage Current
 - Single Chip Construction
 - Hermetically Sealed Package
 - Metalurgically Bonded Construction
 - TX, TXV, and S-Level Screening Available ^{2/}

Maximum Ratings ^{2/}		Symbol	Value	Units
Peak Repetitive Reverse Voltage	2R3S		20	Volts
	3R3S		30	
	4R3S		40	
	5R3S	V _{RRM}	50	
	7R3S	V _{RWM}	70	
	10R3S	V _R	100	
	12R3S		125	
	15R3S		150	
	20R3S		200	
Average Rectified Forward Current (Resistive Load, 60 Hz Sine Wave, T _A = 25 °C)		I _o	8	Amps
Peak Surge Current (8.3 ms Pulse, Half Sine Wave, T _A = 25 °C)		I _{FSM}	200	Amps
Operating & Storage Temperature		T _{OP} & T _{STG}	-65 to +175	°C
Maximum Total Thermal Resistance Junction to Case		R _{θJC}	1.5	°C/W

DO-4:

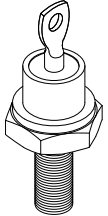

- Notes:**
- 1/ For ordering information, Price, Operating Curves, and Availability- Contact Factory.
 - 2/ Unless Otherwise Specified, All Maximum Ratings/Electrical Characteristics @25°C.
 - 3/ Screened to MIL-PRF-19500.



Solid State Devices, Inc.

14701 Firestone Blvd * La Mirada, CA 90638

Phone: (562) 404-4474 * Fax: (562) 404-1773

ssdi@ssdi-power.com * www.ssdi-power.com

2R3S THRU 20R3S

Electrical Characteristics	Symbol	Max	Units
Instantaneous Forward Voltage Drop ($I_F=8A$, $T_A=25^\circ C$, 300 μ sec pulse)	V_F	0.90	V_{DC}
Reverse Leakage Current (Rated V_R , $T_A=25^\circ C$, 300 μ sec pulse minimum)	I_{R1}	100	μA
Reverse Leakage Current (Rated V_R , $T_A=100^\circ C$, 300 μ sec pulse minimum)	I_{R2}	2.0	mA
Reverse Recovery Time ($T_A=25^\circ C$, $I_F = 0.5A$, $I_R = 1.0A$, $I_{RR} = 0.25A$)	t_{RR}	35	nsec
Typical Junction Capacitance ($V_R = 10V_{DC}$, $T_A = 25^\circ C$, $f = 1MHz$)	C_J	300	pF

Notes:

1/ For ordering information, Price, Operating Curves, and Availability- Contact Factory.

2/ Screened to MIL-PRF-19500.

3/ Unless Otherwise Specified, All Maximum Ratings/Electrical Characteristics @25°C.

Case Outline: DO-4

Stud: Cathode

Lead: Anode

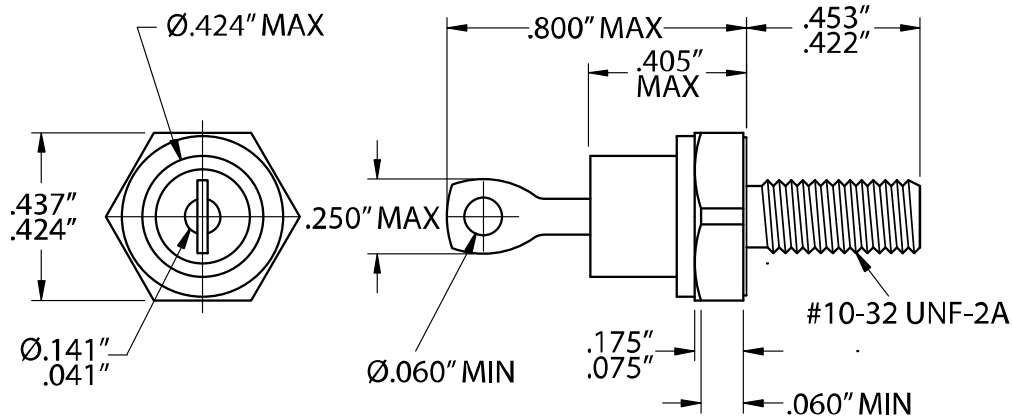

TYPICAL OPERATING CURVES

$T_A = 25^\circ C$ Unless otherwise specified

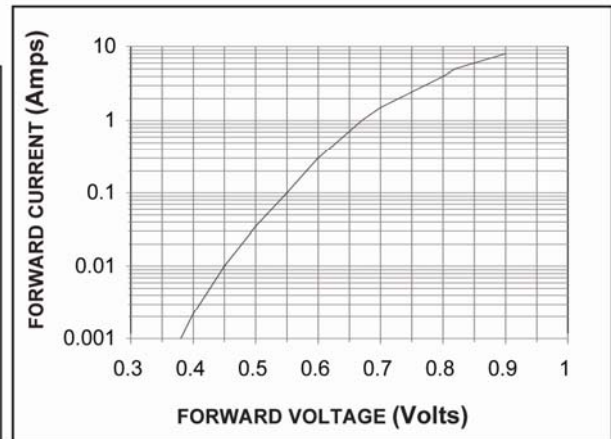
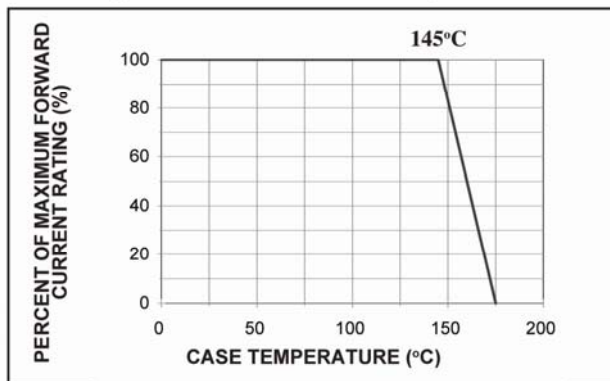

NOTE: All specifications are subject to change without notification. SCD's for these devices should be reviewed by SSDI prior to release.

DATA SHEET #: RC0029D

DOC