



Congratulations on becoming the proud owner of a Philips CTV.

Your television set has been designed, engineered and tested to very high standards to provide superior quality Picture and Sound for your enjoyment

Philips Colour Television means that the best design, reliability and quality are ensured with every set manufactured. In addition, your set complies with International Safety Standards - IEC 65.

Your television set has a host of features. Please read this 'Operating Instructions' booklet carefully and get to know about your set.

We wish you a very enjoyable viewing on your new Philips Colour Television.

Superior Picture Clarity

Features depends on specific to type no. of model. Specification are subject to change without notice.

PHILIPS

3115 116 15963

B Safety information

- Disconnect mains plug when :
 - the indicator light below the TV screen is flashing continuously,
 - a bright white line is displayed across the screen,
 - there is a lightning storm,
 - the set is left unattended for a prolonged period of time.
- cleaning the TV screen. Never use abrasive cleaning agents. Use a slight damp chamois leather or soft cloth.
- No naked flame sources, such as lighted candles, should be placed on top of the TV or in the vicinity.
- Do not place your TV set under direct sunlight or heat.
- Leave at least 10 cm around each side of TV set to allow for proper ventilation.
- Avoid placing your set (e.g. near the window) where it is likely to be exposed to rain or water.
- No objects filled with liquids should be placed on top the TV so as to avoid dripping or splashing of liquids on the set.



Useful information

- Do not leave your set on standby mode for a prolonged period of time. Switch off set to allow it to be demagnetised. A demagnetised set supports good picture quality.
- Do not shift or move the set around when it is switched on. Unevenness in colour in some parts of the screen may occur.
- Never attempt to repair a defective TV yourself. Always consult a skilled service personnel.

D Connecting peripheral equipment

Other equipment

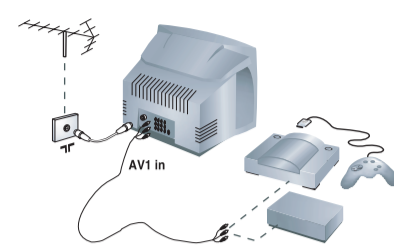

- 1 Carry out the connections as shown.
- 2 To optimise picture quality, connect the equipment which produces the video signals (digital decoder, games, etc) to AV1 in and equipment which produces the S-Video signals S-Video and Hi-8 video recorders, certain DVD drives to AV2 in and all other equipment to either AV1 in or AV2 in.

Amplifier



- 1 To connect to a hi-fi system, use an audio connection cable and connect the "L" and "R" outputs on the TV set to the "AUDIO IN" "L" and "R" input on your hi-fi amplifier. Make the connections as shown.

Side connections

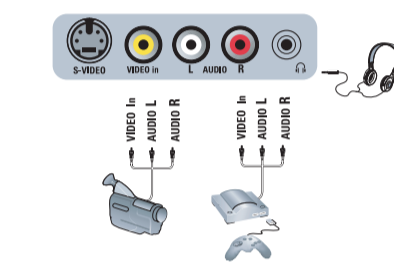

With the **Side** key, select the channel Side. For a monophonic device, connect the audio signal to the AUDIO L input. Use the **Left** key to reproduce the sound on the left and right speakers of the TV set.

Headphones

When headphones are connected, the sound on the TV set will be cut. The VOL + or - keys are used to adjust the volume level. The headphone impedance must be between 32 and 600 Ohms.

A Installing your television set

Positioning the television set

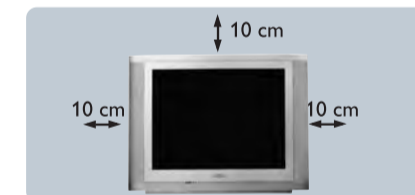

Place your TV on a solid, stable surface, leaving a space of at least 10 cm around the appliance.

Remote control

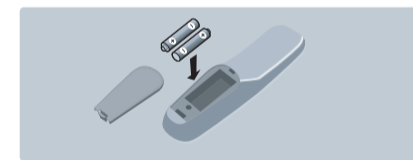

Insert the two R6-type batteries making sure that they are the right way round.

If remote control is not used for a long period of time remove the batteries and store it in a cool, dry place.

Connections

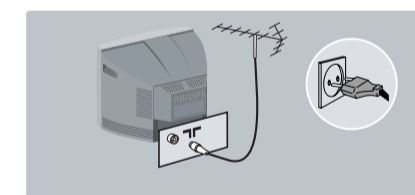

- Insert the aerial plug into the **T** socket at the rear of the set. If you are using an indoor aerial, reception may be difficult in certain conditions. You can improve reception by rotating the aerial. If the reception remains poor, you will need to use an external aerial.
- Insert the mains plug into a wall socket.

Switching on



To switch on the set, press the on/off key. A red indicator means that the television is on standby mode. Refer to the next page on 'Remote Control keys' for the various keys that you could use to switch on the set. An indicator light will flash when it is receiving signal from the remote control.

The keys on the TV set

The television set has 4 keys which are located at the top or front.

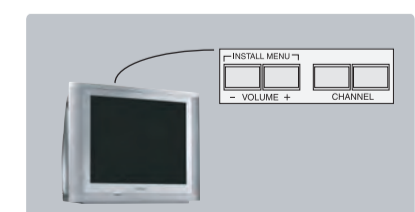

The **Volume +/-** keys are used to adjust the sound levels. The **Channel +/-** keys are used to select channels. To access or exit the main menu, press down the **Volume +/-** keys, simultaneously. To select an item in the main menu, press the **Channel +/-** key. To select an adjustment, press down the **Volume +/-** key.

C Connecting peripheral equipment

DVD player

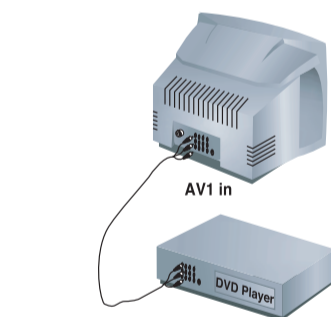

- 1 Connect the TV's green, blue and red Y Pb Pr (AV1 in) jacks to the corresponding COMPONENT VIDEO OUT jacks on the player.
- 2 Connect the TV's red and white (R and L) AUDIO IN jacks to the corresponding AUDIO OUT jacks on the player. Match the cable colour to the jacks' colour. The red jack is the Right audio channel and the white jack is the Left audio channel.
- 3 Turn on the TV and DVD player. Set the TV to CVI and DVD background screen will come on the screen. You can now play your disc. Note: You need to select the channel CVI manually to playback DVD disc.

Video recorder

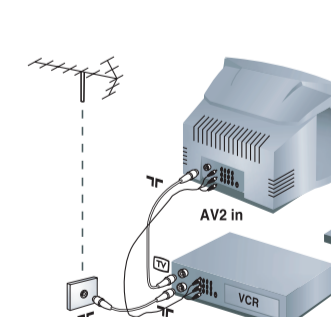

- 1 Connect the TV's yellow, white and red (AV2 in) jacks to the corresponding Video and Audio jacks on the player.
- 2 Connect the TV's red and white (R and L) AUDIO IN jacks to the corresponding AUDIO OUT jacks on the player. Match the cable colour to the jacks' colour. The red jack is the Right audio channel and the white jack is the Left audio channel.
- 3 Turn on the TV and VCR player. Set the TV to channel AV2. You can now play your video cassette tape. Connection is also possible via the aerial cable. You will therefore need to tune in your video recorder's test signal and assign a channel number 0. Select channel 0 to playback.

E Remote control keys

- Personal Zapping**: You can surf up to 10 personal channels for each key.
- Sleeptimer**: Selects a period of time after which the TV will go into standby mode automatically.
- Add Personal Zapping list**: Adds and stores channels into Personal Zapping list.
- Smart Sound**: Used to access a series of stored settings: Theatre, Music, Voice, Hall, Indipop, Raga, Orchestra, Bhajan, Disco, Opera, Bhanga, Gazal, Personal.
- Menu**: To call up or exits menus.
- Cursor**: These 4 keys are used to move around the menus or provide direct access to the different picture formats.
- Volume**: To adjust the sound level.
- Digit keys**: Direct access to the channels. For a 2-digit channel, enter the 2nd digit before the dash disappears.
- Alternate channel**: Switched between the current and the previous channel.
- Standby**: Lets you place the TV set on standby. To turn on the TV, press CH + or -, AV, A/CH or digit keys.
- AV channel selection**: Press several times to select AV1, CVI, AV2, YPbPr or Side.
- Delete Personal Zapping list**: Deletes stored channels from Personal Zapping list.
- Smart Picture**: Used to access a series of stored settings: Rich, Natural, Soft, DVD/VCD or Personal.
- Incredible Surround**: To activate/disable the Incredible Surround feature. In stereo, the speakers appear further apart. In mono, a pseudo-spatial effect is obtained.
- I/II**: During stereo transmission (in AV mode), to switch from Stereo to Mono. During dual sound transmission, to switch between language I or II.
- Channel selection**: To access the next or previous channel. The number and sound mode are displayed for a few moments whenever you select a new channel.
- Mute**: To mute or restore sound.
- On screen display**: To display/clear the on screen information. Press the key for 3 seconds to activate permanent display of channel number. This key is also used to exit from the menu.

F Before Calling Service

Below is a list of frequently occurred symptoms. Before you call for service, make these simple checks. Some of these symptoms can easily be rectified if you know what to do.

Symptom	What you should do
Colour patch (unevenness)	<ul style="list-style-type: none"> • Switch off the TV by the mains power button. Wait for 20 minutes before switching on again. • Check the TV is not placed too near speakers or magnetic objects.
No power	<ul style="list-style-type: none"> • Check the TV's AC power cord is plugged into the mains socket. If there is still no power, disconnect plug. Wait for 60 seconds and re-insert plug. Switch on the TV again.
No picture	<ul style="list-style-type: none"> • Check the antenna connection at the rear of the TV. • Possible TV station problem. Try another channel.
Good picture but no sound	<ul style="list-style-type: none"> • Try increasing the volume. • Check that the sound is not muted. If it is muted, press the Mute button on the remote control to restore sound.
Good sound but poor colour or no picture	<ul style="list-style-type: none"> • Try increasing the contrast and brightness setting.
Snowish picture and noise	<ul style="list-style-type: none"> • Check antenna connection at the rear of the TV.
Horizontal dotted lines	<ul style="list-style-type: none"> • Possible electrical interference e.g. hairdryer, vacuum cleaner, etc. Switch off appliances.
Double images or "Ghost" images	<ul style="list-style-type: none"> • Possible poor positioning of antenna. Using a highly directional antenna may improve reception.
TV not responding to remote control handset	<ul style="list-style-type: none"> • Check life span of batteries of remote control handset. • Aim remote control handset directly at remote control sensor lens on the TV.
No colour in picture	<ul style="list-style-type: none"> • Select your desired colour system manually if reception is poor in Auto mode.
One white line across	<ul style="list-style-type: none"> • Switch-off the TV immediately and call for after-sales service
Doming	<ul style="list-style-type: none"> • A prolonged view of very bright static picture can lead to development of uneven colour patches in some portions of the screen. This is not a defect and will disappear in few minutes after moving picture resumes

G Auto Store

This menu is used to store all available channels automatically.

- 1 Press the **Auto Store** key.
- 2 With the cursor, select the **Install** menu and follow by the **Auto Store**.

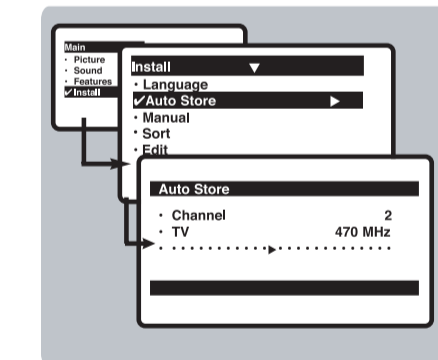

- 3 Use the **Left** key to start auto store. All the available TV channels will be stored automatically. This operation takes a few minutes. The display shows the progress of the search and the number of channels found.
- 4 To quit the menus, press **Exit**.

Manual Store

This menu is used to store channels one at a time.

- 1 Press the **Manual Store** key.
- 2 With the cursor, select the **Install** menu and follow by the **Manual**.

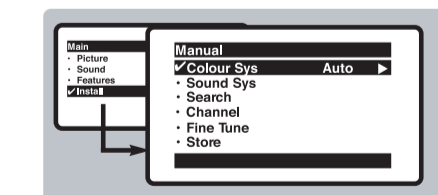

- 3 **Colour Sys(tem)**: use the **Left** or **Right** key to select the desired colour system: Auto, PAL, NTSC 3.58 or NTSC 4.43.
- 4 **Sound Sys(tem)**: use the **Left** or **Right** key to select the desired sound system: BG, I, DK or M.
- 5 **Search**: Press **Search**. The search starts. Once a channel is found, the scanning stops. Go to the next step.
- 6 **Channel**: enter the required channel with the **Left**, **Right** or digit keys.
- 7 **Fine Tune**: if the reception is not satisfactory, adjust using the **Left** or **Right** keys.
- 8 **Store**: Press **Store**. The channel is stored.
- 9 Repeat steps 3 to 4 for each channel you wish to store.
- 10 To quit the menus, press **Exit**.

