

# 23HM SERIES 1.8°

## Key Features

- Low Noise
- Low Inertia
- High Acceleration



## General Specifications

Bi-polar

Model Number	Resistance per Phase	Inductance per Phase	Rated Current	Holding Torque		Detent Torque		Rotor Inertia	
	ohm	mH	A	mNm	oz-in	mNm	oz-in	g.cm <sup>2</sup>	oz-in <sup>2</sup>
23HM0401-01	1.8	3.2	1.5	420	59.49	25	3.54	100	0.55
23HM0402-01	0.85	1.5	2.2	420	59.49	25	3.54	100	0.55
23HM1402-01	2.6	5.6	1.5	650	92.07	45	6.37	175	0.96
23HM1403-01	1.2	2.6	2.2	650	92.07	45	6.37	175	0.96
23HM2403-01	1.4	3.1	2.2	900	127.48	52	7.37	210	1.16
23HM2404-01	0.7	1.4	3.1	900	127.48	52	7.37	210	1.16
23HM4401-01	1.7	4.7	2.2	1250	177.05	88	12.46	360	1.98
23HM4402-01	0.85	2.4	3.1	1250	177.05	88	12.46	360	1.98

Motor Wiring Diagram —> Page A-8

## Mechanical Dimension

Model Number	L	Mass
	mm (in.)	kg (lb.)
23HM0**	40 (1.56)	0.36 (0.79)
23HM1**	51 (1.99)	0.52 (1.14)
23HM2**	55 (2.15)	0.60 (1.32)
23HM4**	76 (2.96)	0.90 (1.98)

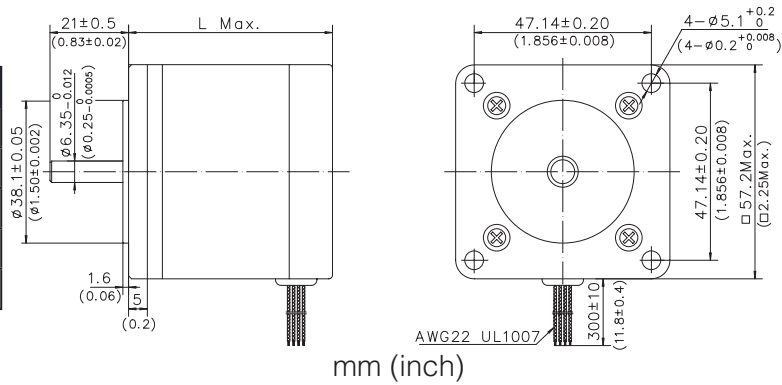

0.9°

1.8°

3.6°

3.75°

1.2°

2-PHASE

3-PHASE

DIGITAL LINEAR ACTUATOR

INTEGRATED STEPPING MOTOR

HB MOTOR

MOTOR DRIVER

Dynamic Torque Curves

23HM0401-01

Conditions: Bi-polar Constant Current Driver  
 IC: AMA MS3540M  
 Mode: Full Step

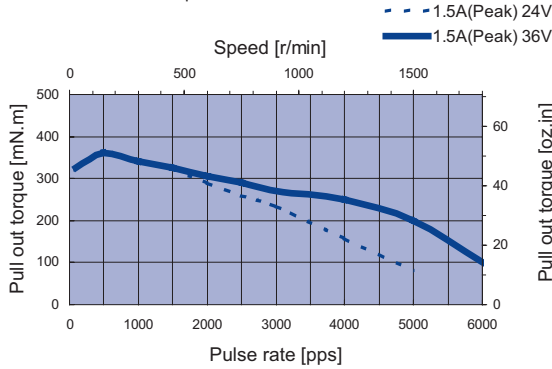

23HM0402-01

Conditions: Bi-polar Constant Current Driver  
 IC: AMA MS3540M  
 Mode: Full Step

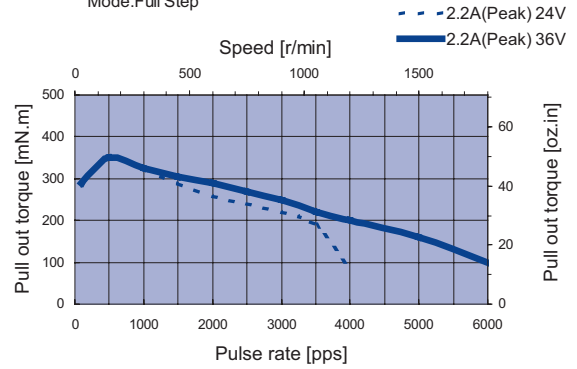

23HM1402-01

Conditions: Bi-polar Constant Current Driver  
 IC: AMA MS3540M  
 Mode: Full Step

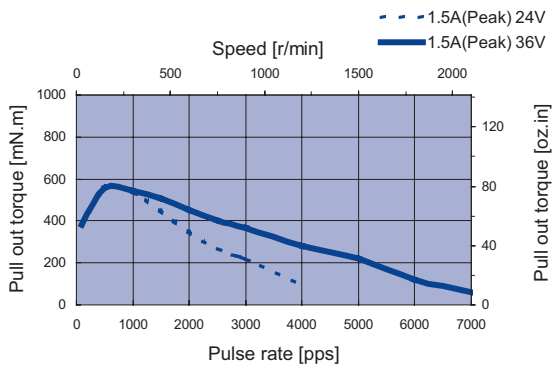

23HM1403-01

Conditions: Bi-polar Constant Current Driver  
 IC: AMA MS3540M  
 Mode: Full Step

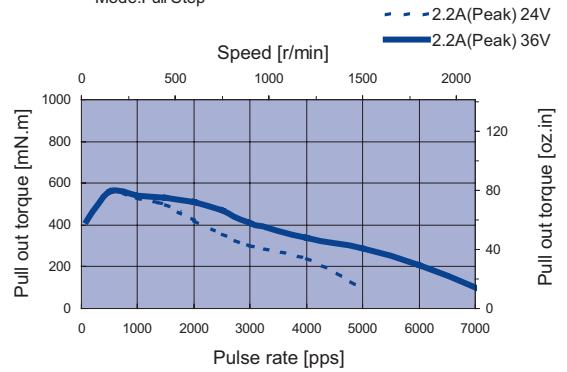

23HM2403-01

Conditions: Bi-polar Constant Current Driver  
 IC: AMA MS3540M  
 Mode: Full Step

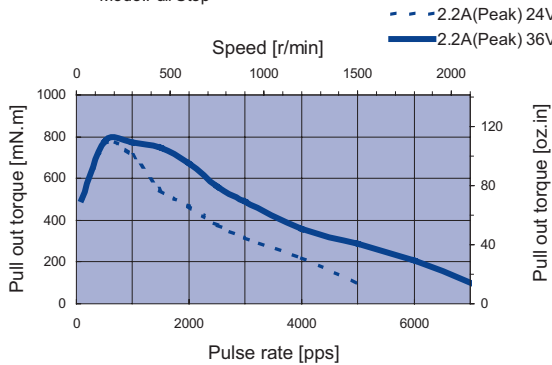

23HM2404-01

Conditions: Bi-polar Constant Current Driver  
 IC: AMA MS3540M  
 Mode: Full Step

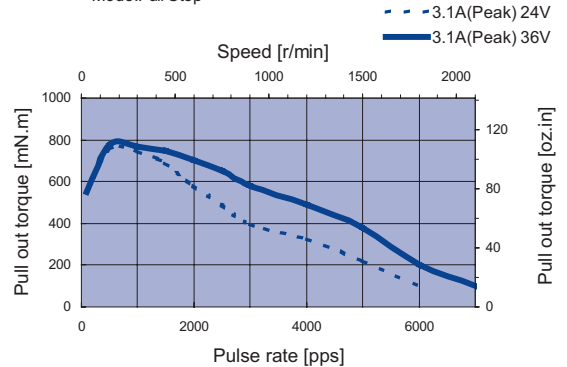

0.39in.  
(10mm)

1.10in.  
(28mm)

1.38in.  
(35mm)

1.53in.  
(39mm)

1.65in.  
(42mm)

2.22in.  
(56.4mm)

Ø2.25in.  
(Ø57.2mm)

2.36in.  
(60mm)

3.35in.  
(85mm)

Ø3.39in.  
(Ø86mm)

Dynamic Torque Curves

23HM4401-01

Conditions: Bi-polar Constant Current Driver  
 IC: AMA MS3540M  
 Mode: Full Step

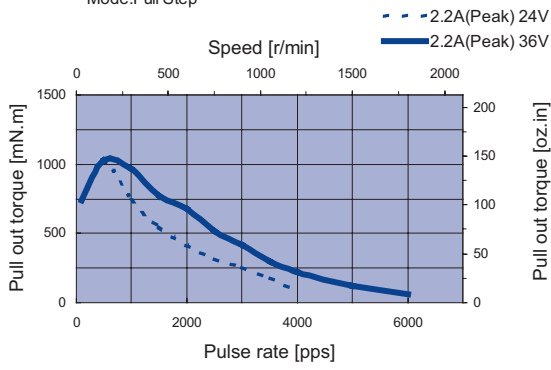

23HM4402-01

Conditions: Bi-polar Constant Current Driver  
 IC: AMA MS3540M  
 Mode: Full Step

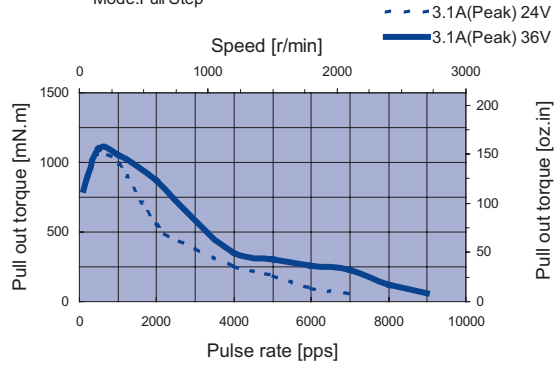

0.9°		2-PHASE	3.6°	3.75°	3-PHASE	DIGITAL LINEAR ACTUATOR	INTERGRATED STEPPING MOTOR	MOTOR DRIVER
1.8°								
3.75°		1.2°						