

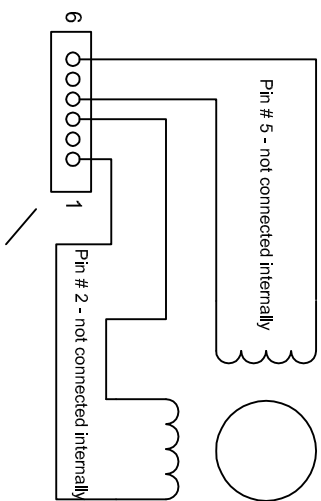

SPECIFICATIONS	
Step Angle	deg 1.8
Voltage	V DC 3.0
Current / phase	A / phase 3.0
Resistance / phase	ohm / phase 1.0
Inductance / phase	mH / phase 2.5
Holding Torque	oz-in 168
	N-cm 118
Detent Torque	oz-in 7.1
	N-cm 5.0
Rotor Inertia	oz-in ² 2.2
	g-cm ² 400
Weight	Ibs 2.4
	kg 1.1

Special version with oversized shaft diameter for demanding applications.
 Bipolar driver required.
 Keep motor case temperature below 100°C.
 Allow sufficient time to accelerate the load.
 Do not allow other power lines to run along step motor lead wires.
 Do not use holding torque of motor as fail safe brake.
 Properly align the motor with load.
 Do not disassemble the motor.

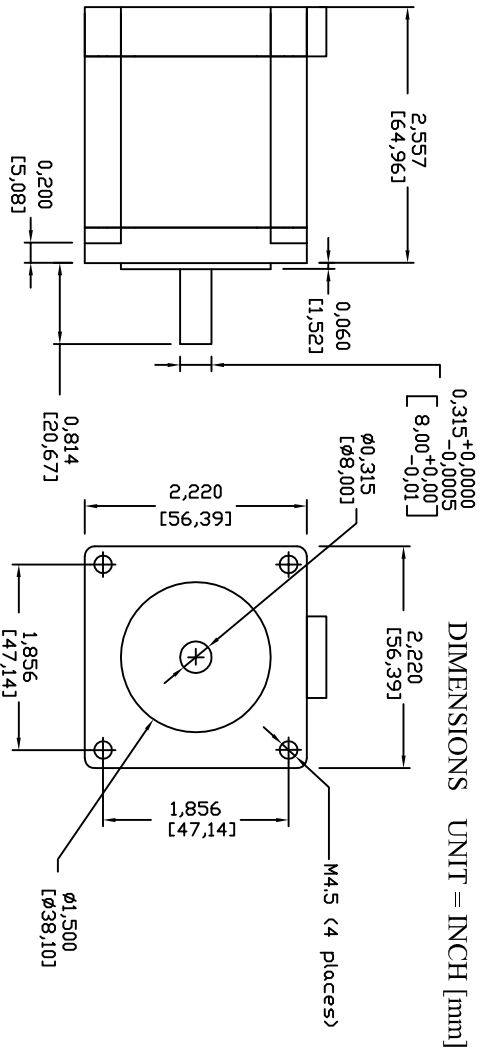

Rectangular housing with 6 crimp contacts is supplied with motor (crimping tool required)
 Housing - JST MFG. CO. p/n: XHP-6 Digi-Key p/n: 455-2218-ND
 Contacts - JST MFG. CO. p/n: SXH-001T-P0.6 Digi-Key p/n: 455-1135-2-ND
 Does not include cable.

Manufactured by: Minnbea Motor Manufacturing Corporation
 The names of companies or their products specified in this data sheet are the trade names and/or trademarks of such respective companies.

We have used our best effort in preparing this document. We make no representations or warranties with respect to the accuracy or completeness of the contents of this document and specifically disclaim any implied warranties of fitness for a particular purpose. We shall not be liable for any loss of profit or any other commercial damages.

REV	REV NDT	DATE
1		

		TITLE	
http://www.interinar.com		2-PHASE STEP MOTOR	
support@interinar.com		23KM-K102-P1V	
DWG	M.W.	DWG#	SHEET
CAT	SCALE	P0117.11	1
76	not to scale	FILE NAME	DF
		23KM-K102-P1V.dwg	1
			DATE
			01-17-2011