

10kV 6.0A POTTING TYPE HV SUBASSEMBLY

Outline Drawings

Features

- Diffused Junction
- High Voltage Capability
- High Case Dielectric Strength
- Low frequency
- Plastic Material has Underwriters Laboratory
- Flammability Classification 94V-O

Mechanical Data

- Case: Molded Plastic
- Polarity: Marked on Body
- Weight: 118 grams (approx.)
- Mounting Position: Through Hole for #5 Screw
- Marking: Type Number

Maximum Ratings and Characteristics

- Absolute Maximum Ratings

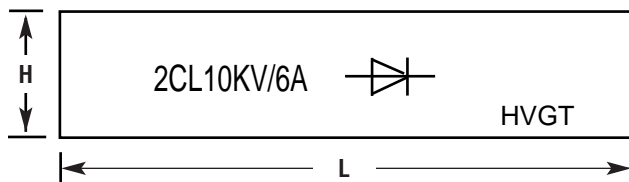
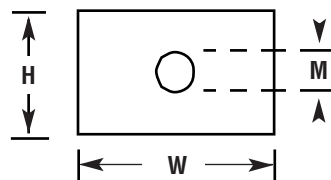

Shape Size(Unit: mm)			
L	W	H	M
150	25	20	5

Items	Symbols	Condition	2CL10KV/6A	Units
Repetitive Peak Reverse Voltage	V_{RRM}		10	kV
Average Output Current	I_o	$T_a=30^{\circ}C, \text{Resistive Load}$	6.0	A_{peak}
Surge Current	I_{FSM}		120	A_{peak}
Junction Temperature	T_j		125	$^{\circ}C$
Allowable Operation Case Temperature	T_c		125	$^{\circ}C$
Storage Temperature	T_{stg}		-40 to +125	$^{\circ}C$

- Electrical Characteristics ($T_a=25^{\circ}C$ Unless otherwise specified)

Items	Symbols	Conditions	2CL10KV/6A	Units
Maximum Forward Voltage Drop	V_F	at $25^{\circ}C, I_F = I_{F(AV)}$	12	V
Maximum Reverse Current	IR1	at $25^{\circ}C, V_R = V_{RRM}$	20	μA
	IR2	at $100^{\circ}C, V_R = V_{RRM}$	200	μA
Maximum Reverse Recovery Time	T_{rr}	at $25^{\circ}C, I_F=100mA, I_{rm}=200mA$	--	nS
Junction Capacitance	C_j	at $25^{\circ}C, V_R=0V, f=1MHz$	--	pF