



Micro Commercial Components
 20736 Marilla Street Chatsworth
 CA 91311
 Phone: (818) 701-4933
 Fax: (818) 701-4939

2SB744

Features

- Capable of 10Watts of Power Dissipation.
- Collector-current 3.0A
- Collector-base Voltage 70V
- Operating and storage junction temperature range: -55°C to +150°C

Maximum Ratings

Symbol	Rating	Rating	Unit
V _{CEO}	Collector-Emitter Voltage	45	V
V _{CBO}	Collector-Base Voltage	70	V
V _{EBO}	Emitter-Base Voltage	5.0	V
I _C	Collector Current	3.0	A
P _C	Collector power dissipation	10	W
T _J	Junction Temperature	-55 to +150	°C
T _{STG}	Storage Temperature	-55 to +150	°C

PNP Silicon Power Transistor

TO-126

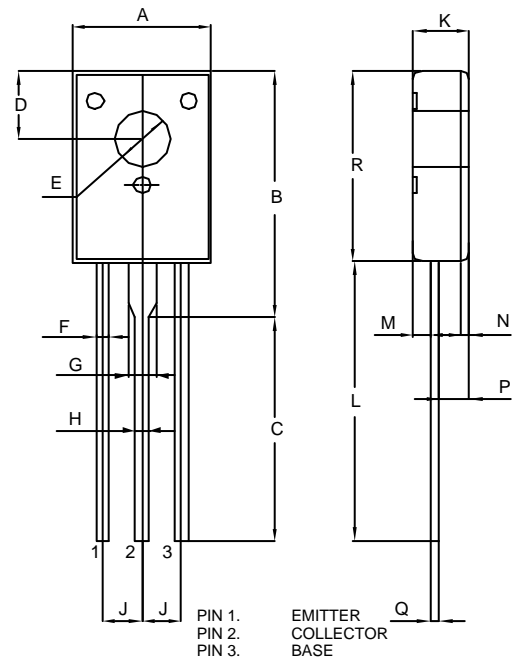

Electrical Characteristics @ 25°C Unless Otherwise Specified

Symbol	Parameter	Min	Max	Units
OFF CHARACTERISTICS				
V _{CEO(SUS)}	Collector-Emitter Sustaining Voltage (I _C =1.0mA, I _B =0)	45	---	Vdc
V _{(BR)CBO}	Collector-Base Breakdown Voltage (I _C =1.0mA, I _E =0)	70	---	Vdc
V _{(BR)EBO}	Emitter-Base Breakdown Voltage (I _E =1.0mA, I _C =0)	5.0	---	Vdc

ON CHARACTERISTICS

h _{FE(1)}	Forward Current Transfer ratio (I _C =20mA, V _{CE} =5.0Vdc)	30	---	---
h _{FE(2)}	Forward Current Transfer ratio (I _C =0.5A, V _{CE} =5.0Vdc)	60	320	---
V _{CE(sat)}	Collector-Emitter Saturation Voltage (I _C =1.5A, I _B =0.15A)	---	2.0	Vdc

DIM	INCHES		MM		NOTE
	MIN	MAX	MIN	MAX	
A	0.30	0.33	7.70	8.30	
B		0.56		14.20	
C	0.50	0.53	12.76	13.36	
D	0.15	0.16	3.80	4.0	
E	0.12	0.13	3.10	3.30	
F	0.025	0.033	0.65	0.85	
G	0.06	0.07	1.50	1.70	
H	0.025	0.033	0.65	0.85	
J	0.08	0.10	2.08	2.48	
K	0.12	0.14	3.05	3.45	
L	0.63	0.64	15.90	16.30	
M		0.04		1.0	
N		0.02		0.5	
P	0.06	0.08	1.55	1.95	
Q	0.018	0.023	0.45	0.60	
R	0.43	0.44	10.80	11.20	