

Silicon NPN Power Transistors

2SD1270

DESCRIPTION

www.datasheet4u.com

- With TO-220Fa package
- Low collector saturation voltage
- Large collector current I_C
- Complement to type 2SB945

APPLICATIONS

- For power switching applications

PINNING

PIN	DESCRIPTION
1	Base
2	Collector
3	Emitter

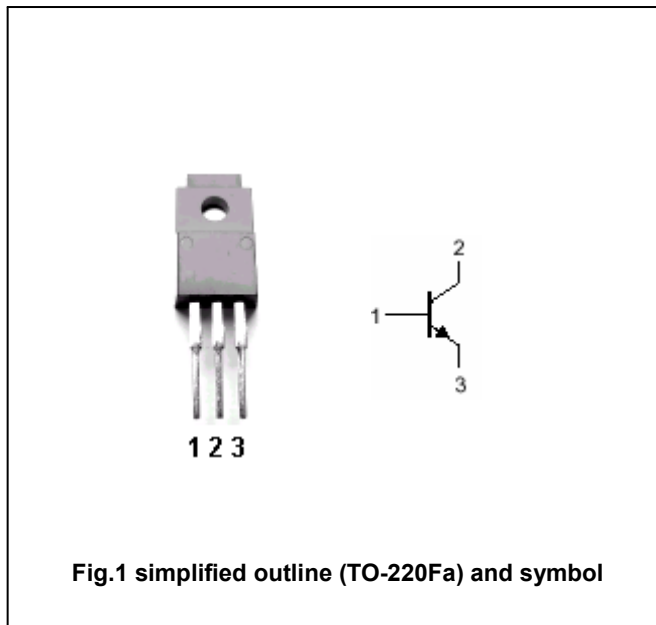

Fig.1 simplified outline (TO-220Fa) and symbol

ABSOLUTE MAXIMUM RATINGS AT $T_a=25^\circ\text{C}$

SYMBOL	PARAMETER	CONDITIONS	VALUE	UNIT
V_{CBO}	Collector-base voltage	Open emitter	130	V
V_{CEO}	Collector-emitter voltage	Open base	80	V
V_{EBO}	Emitter-base voltage	Open collector	7	V
I_C	Collector current (DC)		5	A
I_{CM}	Collector current-peak		10	A
P_C	Collector power dissipation	$T_C=25^\circ\text{C}$	40	W
		$T_a=25^\circ\text{C}$	2	
T_j	Junction temperature		150	$^\circ\text{C}$
T_{stg}	Storage temperature		-55~150	$^\circ\text{C}$

Silicon NPN Power Transistors

2SD1270

CHARACTERISTICS

T_j=25°C unless otherwise specified

www.datasheet4u.com

SYMBOL	PARAMETER	CONDITIONS	MIN	TYP.	MAX	UNIT
V _{(BR)CEO}	Collector-emitter breakdown voltage	I _C =10mA, I _B =0	80			V
V _{CEsat}	Collector-emitter saturation voltage	I _C =4A; I _B =0.2A			0.5	V
V _{BEsat}	Base-emitter saturation voltage	I _C =4A; I _B =0.2A			1.5	V
I _{CBO}	Collector cut-off current	V _{CB} =100V; I _E =0			10	μA
I _{EBO}	Emitter cut-off current	V _{EB} =5V; I _C =0			50	μA
h _{FE-1}	DC current gain	I _C =0.1A; V _{CE} =2V	45			
h _{FE-2}	DC current gain	I _C =2A; V _{CE} =2V	60		260	
f _T	Transition frequency	I _C =0.5A; V _{CE} =10V; f=10MHz		30		MHz

Switching times

t _{on}	Turn-on time	I _C =2A; I _{B1} =0.2A; I _{B2} =-0.2A V _{CC} =50V		0.5		μs
t _s	Storage time			1.5		μs
t _f	Fall time			0.15		μs

◆ h_{FE-2} Classifications

R	Q	P
60-120	90-180	130-260

Silicon NPN Power Transistors

2SD1270

PACKAGE OUTLINE

www.datasheet4u.com

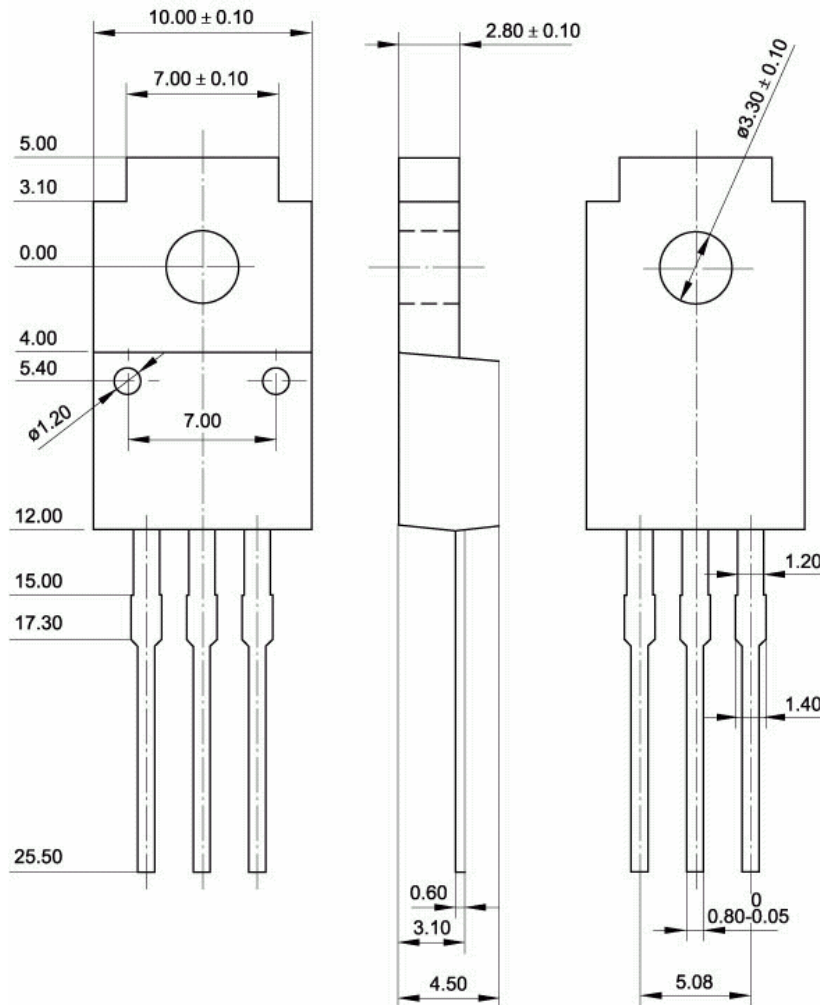

Fig.2 Outline dimensions (unindicated tolerance: ± 0.15 mm)

Silicon NPN Power Transistors

2SD1270

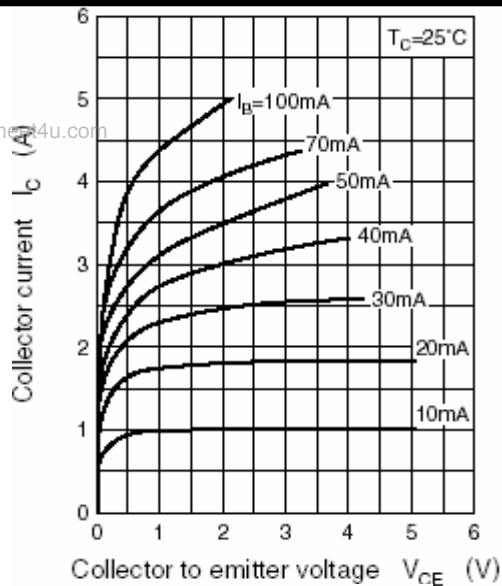

Fig.3 Static Characteristic

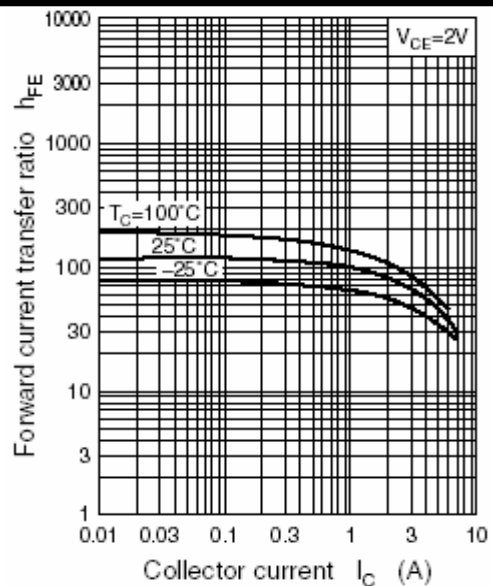

Fig.4 DC current Gain

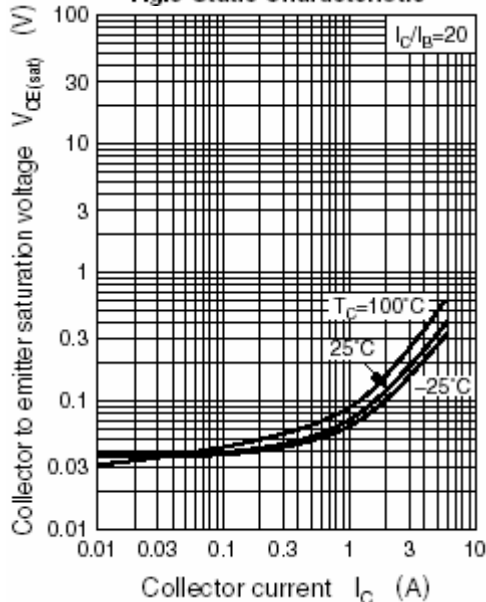

Fig.5 Collector-Emitter Saturation Voltage

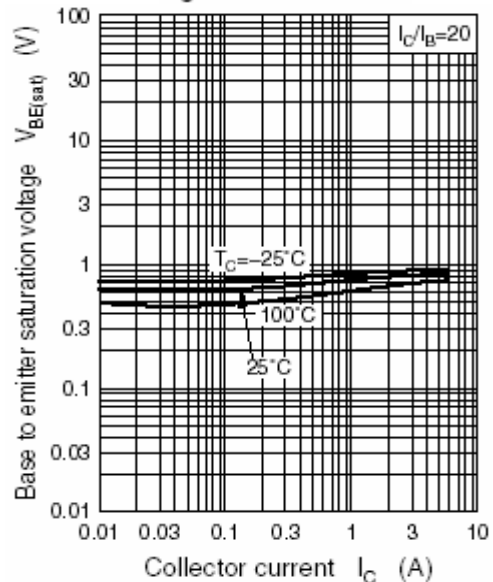

Fig.6 Base-Emitter Saturation Voltage

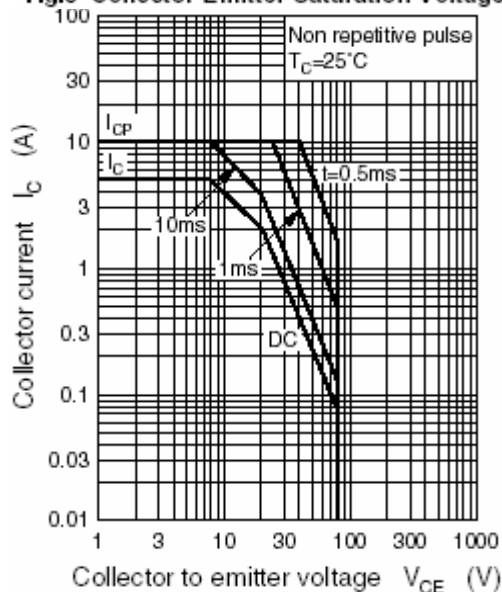

Fig.7 Safe Operating Area