

Pushbutton Units and Indicator Lights

SIRIUS 3SB3

Dimension drawings (mm) Operator and indicator elements

Dimension drawings

Mounting dimensions

Round design

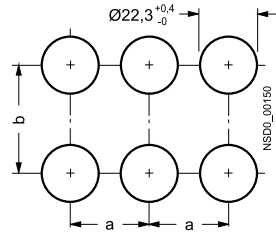

Square design

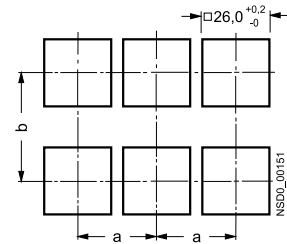

Minimum clearance

	a	b
Switch blocks (1 contact) and lampholder		
• for front plate mounting, with screw terminals	30 ¹⁾	45
• for front plate mounting, with spring-loaded terminals	30 ¹⁾	30 ¹⁾
• for use on PCB, with solder pins	30 ¹⁾	30 ¹⁾
Switch blocks with 2 contacts		
• for front plate mounting	30 ¹⁾	50
When using holders for labeling plates		
• 12.5 mm × 27 mm	30 ¹⁾	45 ²⁾
• 27.0 mm × 27 mm	30 ¹⁾	60

- 1) For mushroom pushbutton, EMERGENCY-STOP and push-pull button:
Note mushroom diameter d = 40 mm or 60 mm.
- 2) 60 mm with switch blocks having two contacts.

Molded-plastic version, round

Pushbutton or illuminated pushbutton
with flat pushbutton
and single-pole switch block
(and lampholder)

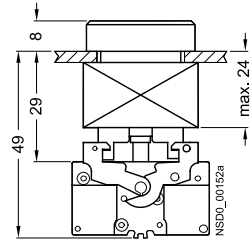

Pushbutton or illuminated pushbutton
with raised button

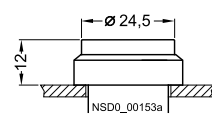

Pushbutton
with raised front ring

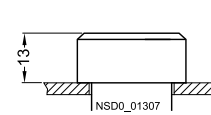

Pushbutton
with raised front ring castellated

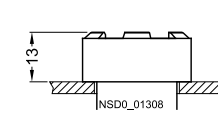

Mushroom pushbutton, illuminated mushroom pushbutton, push-pull-button or illuminated push-pull-button,
? 30 mm

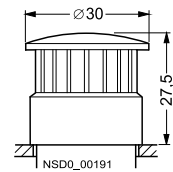

Mushroom pushbutton, illuminated mushroom pushbutton, push-pull-button or illuminated push-pull-button,
? 40 mm

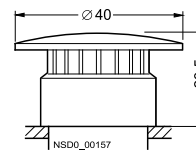

Mushroom pushbutton, illuminated mushroom pushbutton, push-pull-button or illuminated push-pull-button,
? 60 mm

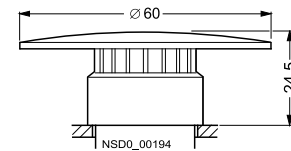

Selector switch or illuminated selector switch

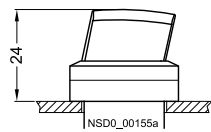

RONIS key-operated switch

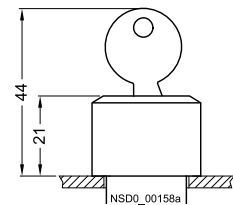

BKS, CES, IKON, O.M.R. key-operated switches

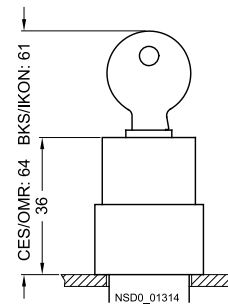

Joystick switch

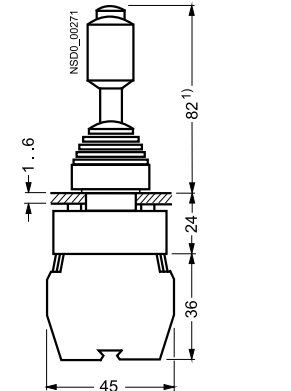

- 1) 82 with mechanical interlock, 77 without mechanical interlock

Pushbutton
with raised button, latching

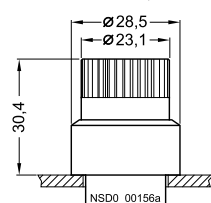

Operating mechanism for potentiometer
with shaft Ø 6 mm,
30 ... 32 mm long

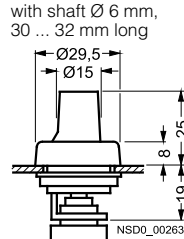

Pushbutton with extended stroke

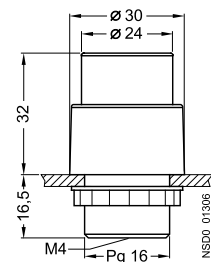

Pushbutton Units and Indicator Lights

SIRIUS 3SB3

Dimension drawings (mm) Operator and indicator elements

EMERGENCY-STOP mushroom pushbutton,
Ø 32 mm, pull to unlatch

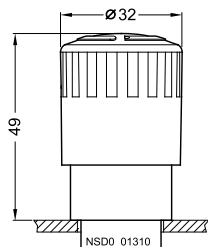

EMERGENCY-STOP mushroom pushbutton,
Ø 40 mm, pull to unlatch

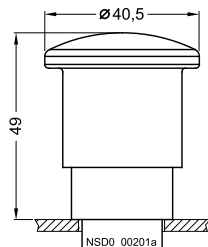

EMERGENCY-STOP mushroom pushbutton,
Ø 40 mm, pull to unlatch

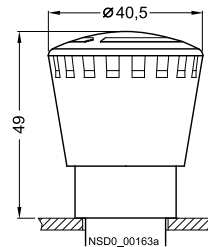

EMERGENCY-STOP mushroom pushbutton,
Ø 60 mm, rotate to unlatch

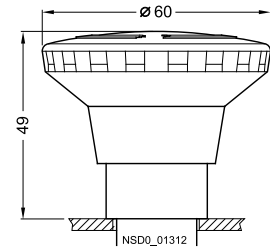

EMERGENCY-STOP mushroom pushbutton
with RONIS key-operated switch

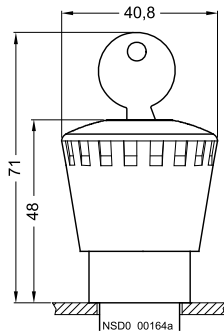

EMERGENCY-STOP mushroom pushbutton
with BKS, CES, IKON, O.M.R.
key-operated switch

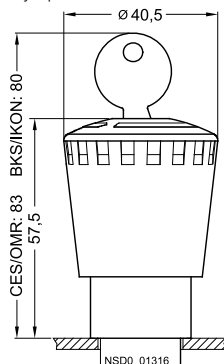

Indicator light

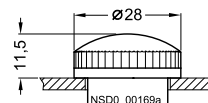

Gear Holder

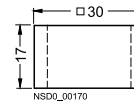

Audible signal device

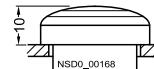

Hole plug

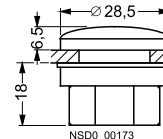

On-Off pushbutton
with flat buttons

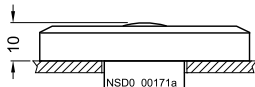

On-Off pushbutton
with raised buttons

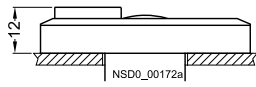

On-Off pushbutton
with or without indicator light

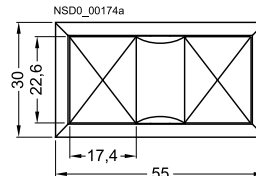

Top view

Operating mechanism for potentiometer
with shaft Ø 6 mm,
30 ... 32 mm long

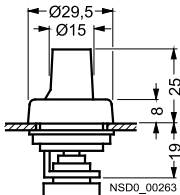

Pushbutton with extended stroke

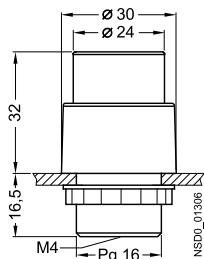

Pushbutton Units and Indicator Lights

SIRIUS 3SB3

Dimension drawings (mm) Operator and indicator elements

Plastic version, square

Pushbutton or illuminated pushbutton with flat pushbutton

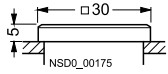

Indicator light

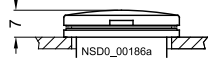

Selector switch or illuminated selector switch

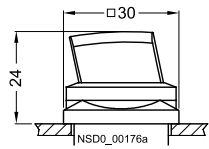

RONIS key-operated switch

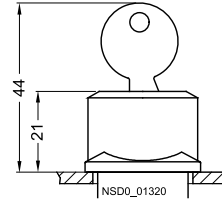

BKS, CES, IKON, O.M.R. key-operated switch

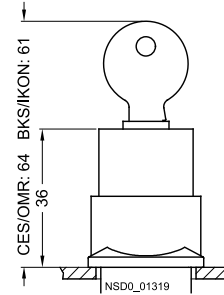

EMERGENCY-STOP mushroom pushbutton with safety lock

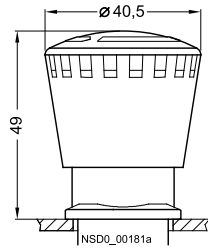

EMERGENCY-STOP mushroom pushbutton with RONIS key-operated switch

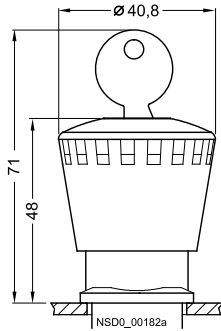

EMERGENCY-STOP mushroom pushbutton with BKS, CES, IKON, O.M.R. key-operated switch

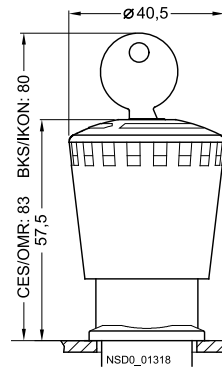

Gear Holder

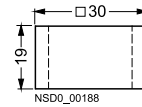

Hole plug

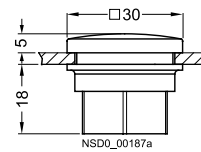

Metal version, round

Pushbutton or illuminated pushbutton
with flat button and single-pole switch block (and lampholder)

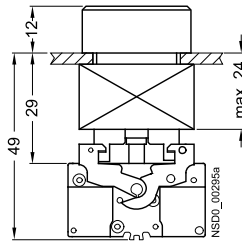

Selector switch or illuminated selector switch,
standard

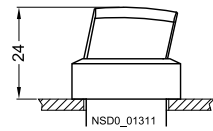

Selector switch or illuminated selector switch,
heavy duty

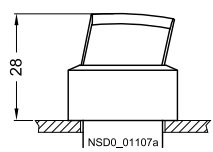

EMERGENCY-STOP mushroom pushbutton,
Ø 32 mm, pull to unlatch

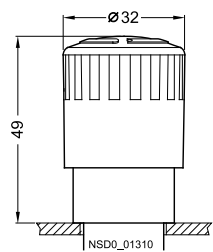

EMERGENCY-STOP mushroom pushbutton
with RONIS key-operated switch

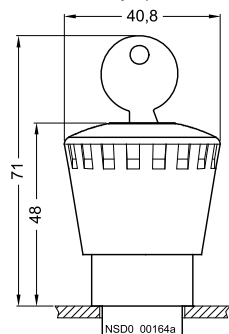

Pushbutton or illuminated pushbutton
with raised button

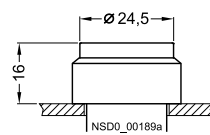

Mushroom pushbutton, illuminated mushroom pushbutton, push-pull-button or illuminated push-pull-button, ? 30 mm

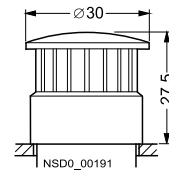

Selector switch or illuminated selector switch
with long handle

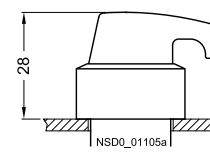

EMERGENCY-STOP mushroom pushbutton,
Ø 40 mm, rotate to unlatch

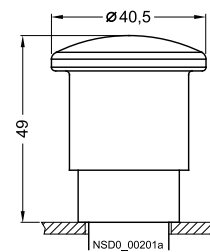

EMERGENCY-STOP mushroom pushbutton
with BKS, CES, IKON, O.M.R. key-operated switch

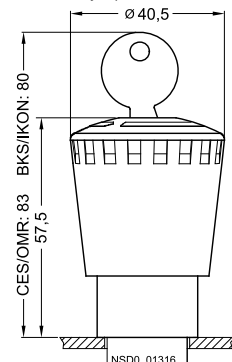

Pushbutton or illuminated pushbutton, latching,
with flat button

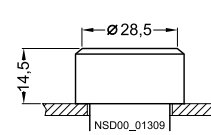

Mushroom pushbutton, illuminated mushroom pushbutton, push-pull-button or illuminated push-pull-button, ? 40 mm

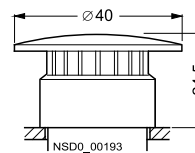

RONIS key-operated switch

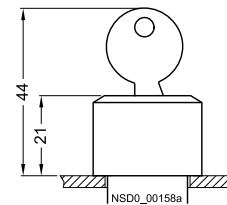

EMERGENCY-STOP mushroom pushbutton,
Ø 40 mm, rotate to unlatch

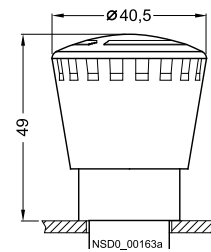

Indicator light

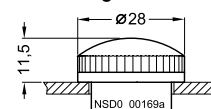

Pushbutton
with raised front ring

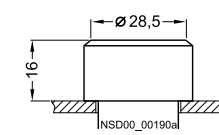

Mushroom pushbutton, illuminated mushroom pushbutton, push-pull-button or illuminated push-pull-button, ? 60 mm

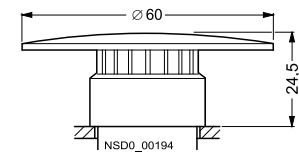

BKS, CES, IKON, O.M.R. key-operated switches

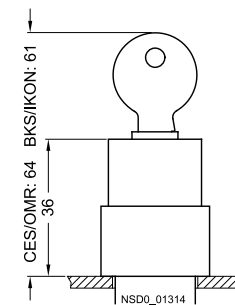

EMERGENCY-STOP mushroom pushbutton,
Ø 60 mm, rotate to unlatch

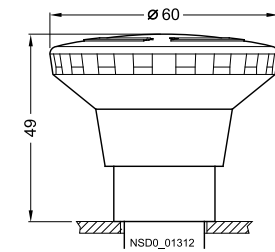

Gear Holder

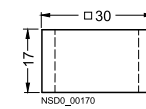

Pushbutton Units and Indicator Lights

SIRIUS 3SB3

Dimension drawings (mm) Contact blocks and lampholders

Contact blocks and lampholders

Screw connection, for front plate mounting

Switch block with 1 contact

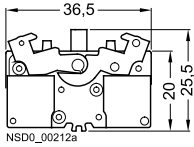

Switch block with 2 contacts

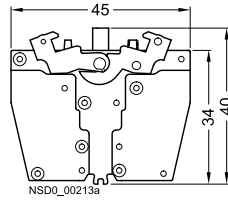

BA 9s lampholder

with or without integrated voltage reducer

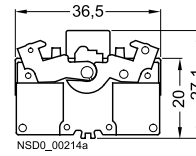

BA 9s lampholder with separate lamp test function

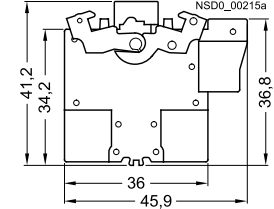

Lampholder with integrated LED

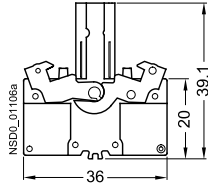

Pushbutton or illuminated pushbutton with switch blocks with 1 contact

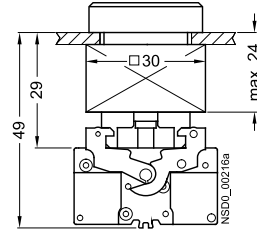

Pushbutton with switch blocks with 1 contact

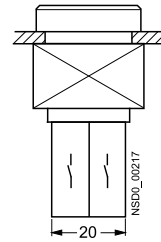

Illuminated pushbutton with switch blocks with 1 contact and lampholder

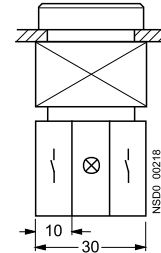

Pushbutton or illuminated pushbutton with switch blocks with 2 contacts

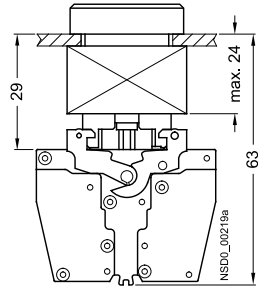

Illuminated pushbutton with switch blocks with 2 contacts and lampholder

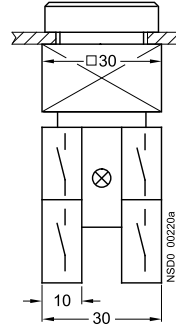

Illuminated pushbutton with switch blocks with 1 contact and lampholder with snapped-on transformer

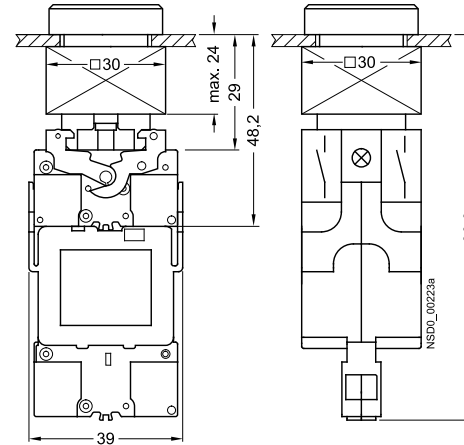

Spring-loaded terminals, for front plate mounting

Switch block with 1 contact

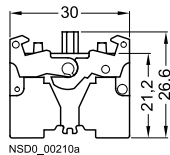

Switch block with 2 contacts

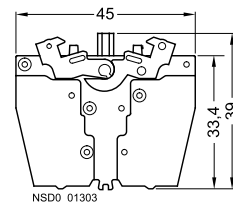

Lampholder BA 9s

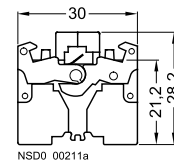

Lampholder with integrated LED

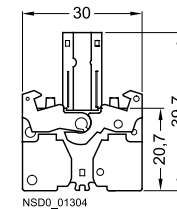

With solder pins, for use on PCB

Contact block 1 NO and 1 NC

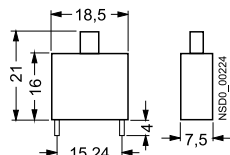

Lampholder

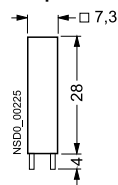

Solder pin spacing

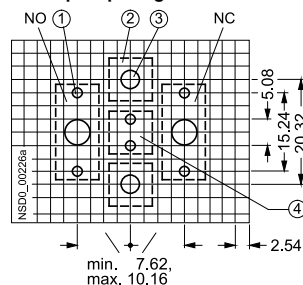

Pushbutton or illuminated pushbutton with contact blocks with 1 contact and PCB support

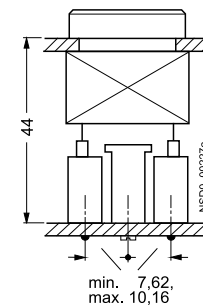

- ① Solder pin $\varnothing 1.3^{+0.1}$
- ② PCB holder
- ③ Centering hole $\varnothing 4.2^{+0.1}$
- ④ Lampholder

Accessories

3SB39 21-0AK shroud for front plate mounting ¹⁾, for EMERGENCY-STOP mushroom pushbutton without key-operated switch

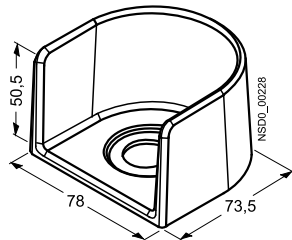

3SB39 21-0AX shroud for front plate mounting ¹⁾, for EMERGENCY-STOP mushroom pushbutton with key-operated switch

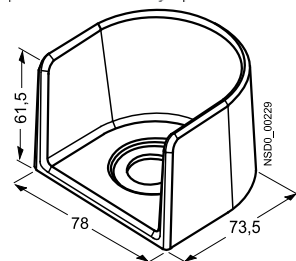

1) Can be used with a front plate thickness up to 4 mm.

Holder for mounting 3 elements

Holder for pushbuttons

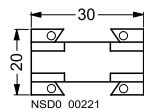

Holder for selector switch, key-operated switch and On-Off pushbutton, with pressure plate

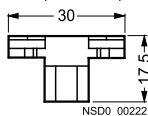

SIRIUS Complete Operating and Display Systems

SIRIUS 3SB3

Dimension drawings (mm) Accessories and enclosures

Enclosures

Enclosure without shroud, molded plastic

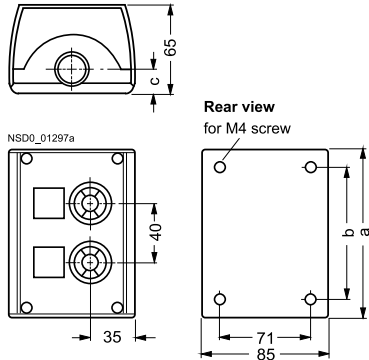

top and bottom with knockouts
for one gland each

Number of command points	Length a	Spacing b	Spacing c
1	85	54	17,5
2	114	83	17,5
3	154	123	17,5
4	194	163	17,5
6	280	249	20,5

Enclosure without shroud, metal

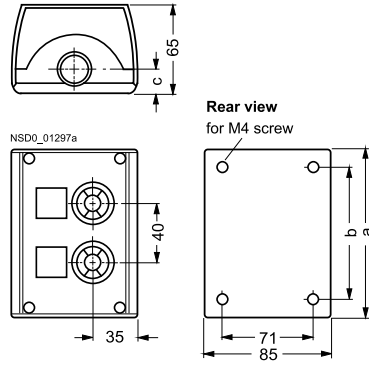

top and bottom with opening
for one gland each

Number of command points	Length a	Spacing b	Spacing c
1	85	54	21
2	114	83	21
3	154	123	21
4	194	163	21
6	280	249	21

Enclosure with shroud, molded plastic

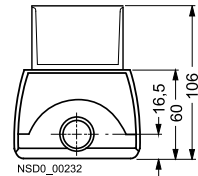

top and bottom with knockouts
for one gland each

Enclosure with shroud, metal

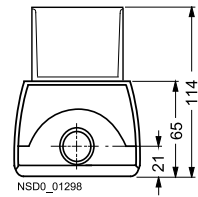

top and bottom with opening
for one gland each

Screw connection, for base mounting

Contact block with 1 contact

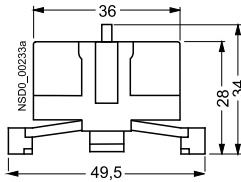

BA9s lampholder with or without integrated voltage reducer

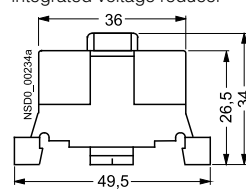

Lampholder with integrated LED

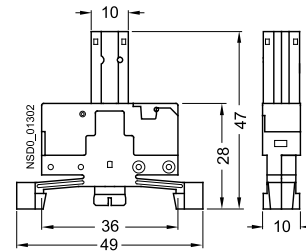

Spring-loaded terminals, for base mounting

Contact block with 1 contact

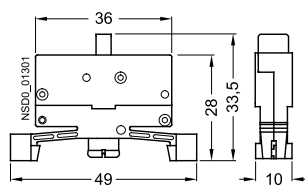

Lampholder with integrated LED

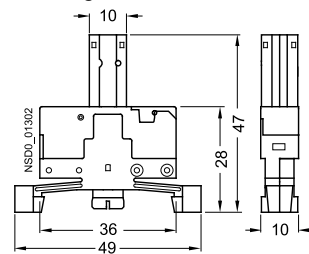

Support terminal

