

TOSHIBA

FILE NO. 050-200423

SERVICE MANUAL

PROJECTION TV

44NHM84

SAFETY PRECAUTIONS

IMPORTANT SAFETY NOTICE

Many electrical and mechanical parts in this chassis have special safety-related characteristics. These parts are identified by \triangle in the Schematic Diagram and Replacement Parts List.

It is essential that these special safety parts should be replaced with the same components as recommended in this manual to prevent X-RADIATION, Shock, Fire, or other Hazards.

Do not modify the original design without permission of manufacturer.

General Guidance

An **Isolation Transformer should always be used** during the servicing of a receiver whose chassis is not isolated from the AC power line. Use a transformer of adequate power rating as this protects the technician from accidents resulting in personal injury from electrical shocks.

It will also protect the receiver and its components from being damaged by accidental shorts of the circuitry that may be inadvertently introduced during the service operation.

If any fuse (or Fusible Resistor) in this monitor is blown, replace it with the specified.

When replacing a high wattage resistor (Oxide Metal Film Resistor, over 1W), keep the resistor 10mm away from PCB.

Keep wires away from high voltage or high temperature parts.

Leakage Current Cold Check(Antenna Cold Check)

With the instrument AC plug removed from AC source, connect an electrical jumper across the two AC plug prongs. Place the AC switch in the on position, connect one lead of ohm-meter to the AC plug prongs tied together and touch other ohm-meter lead in turn to each exposed metallic parts such as antenna terminals, phone jacks, etc.

If the exposed metallic part has a return path to the chassis, the measured resistance should be between $1M\Omega$ and $5.2M\Omega$.

When the exposed metal has no return path to the chassis the reading must be infinite.

An other abnormality exists that must be corrected before the receiver is returned to the customer.

Leakage Current Hot Check (See below Figure)

Plug the AC cord directly into the AC outlet.

Do not use a line Isolation Transformer during this check.

Connect 1.5K/10watt resistor in parallel with a 0.15uF capacitor between a known good earth ground (Water Pipe, Conduit, etc.) and the exposed metallic parts.

Measure the AC voltage across the resistor using AC voltmeter with 1000 ohms/volt or more sensitivity.

Reverse plug the AC cord into the AC outlet and repeat AC voltage measurements for each exposed metallic part. Any voltage measured must not exceed 0.75 volt RMS which is corresponds to 0.5mA.

In case any measurement is out of the limits specified, there is possibility of shock hazard and the set must be checked and repaired before it is returned to the customer.

Leakage Current Hot Check circuit

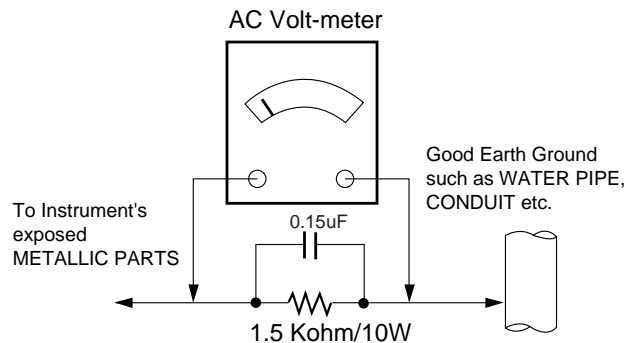

TABLE OF CONTENTS

SPECIFICATIONS	4
DESCRIPTION OF CONTROLS	5
ADJUSTMENT INSTRUCTION	12
PRINTED CIRCUIT BOARDS	18
BLOCK DIAGRAM	29
EXPOLODED VIEW	30
EXPOLODED VIEW PARTS LIST	31
SCHEMATIC DIAGRAM	32
ELECTRICAL REPLACEMENT PARTS LIST	48

SPECIFICATIONS

Product Specifications

- *This model complies with the specifications listed below.*
- *Designs and specifications are subject to change without notice.*
- *This model may not be compatible with features and/or specifications that may be added in the future.*

Model	
44NHM84	Horizontal Size (Inches) 39.92 Height (Inches) 29.19 Depth (Inches) 14.29 Weight (lbs.) 59.5
Power Requirement	AC 120V, 60Hz
Television System broadcasting	NTSC, External STB is required for the reception of Satellite broadcasting or Digital Cable
Television Channels	VHF: 2 - 13 UHF: 14 - 69 CATV: 1 - 125
Power Consumption (W)	230W
Antenna	75 ohm External Terminal for VHF/UHF
Audio Output (W)	12W x 2
External Input/Output Ports	A/V input (3 set) Monitor out (1 set) S-Video input (2) COLORSTREAM HD input (2 set) RGB input (1) DVI input (1) RGB/DVI audio input (1 set) Variable audio output (1 set) Audio center mode input (1) Upgrade port (1) RF input (1)

DESCRIPTION OF CONTROLS

Function Status Indicators

Lamp indicator, operation indicator, and temperature indicator located below the front panel controls, reveal the operating status of the DLP projection TV.

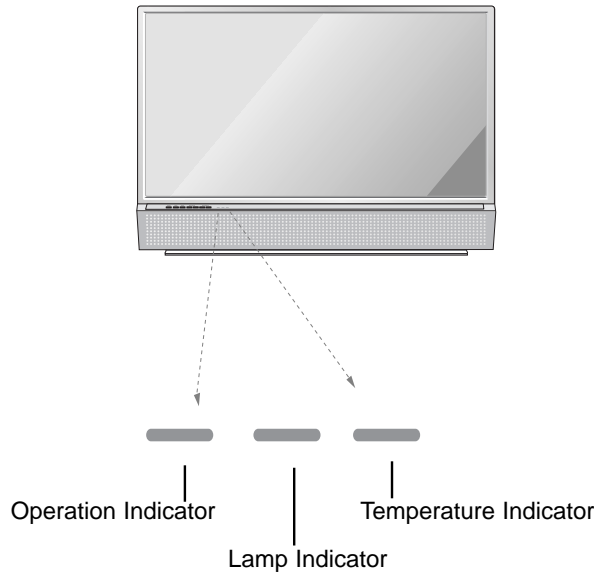

Operation Indicator	Off	Power cord is not connected.
	Red	Power Cord is connected, TV is in standby mode.
	Green	TV turns on.
	Orange (flashing)	Preparing operation in standby mode.
Lamp Indicator	Green (flashing)	The lamp cover is not closed.
Temperature Indicator	Orange	The projection TV is overheating. Check the blocked vents of the projection TV .
	Red	The projection TV shut down due to overheating.
	Red (flashing)	The projection TV shut down due to the cooling fan trouble. Contact an authorized service center.

DESCRIPTION OF CONTROLS

Rear Connections Panel

Connecting cables and external equipment to your TV.

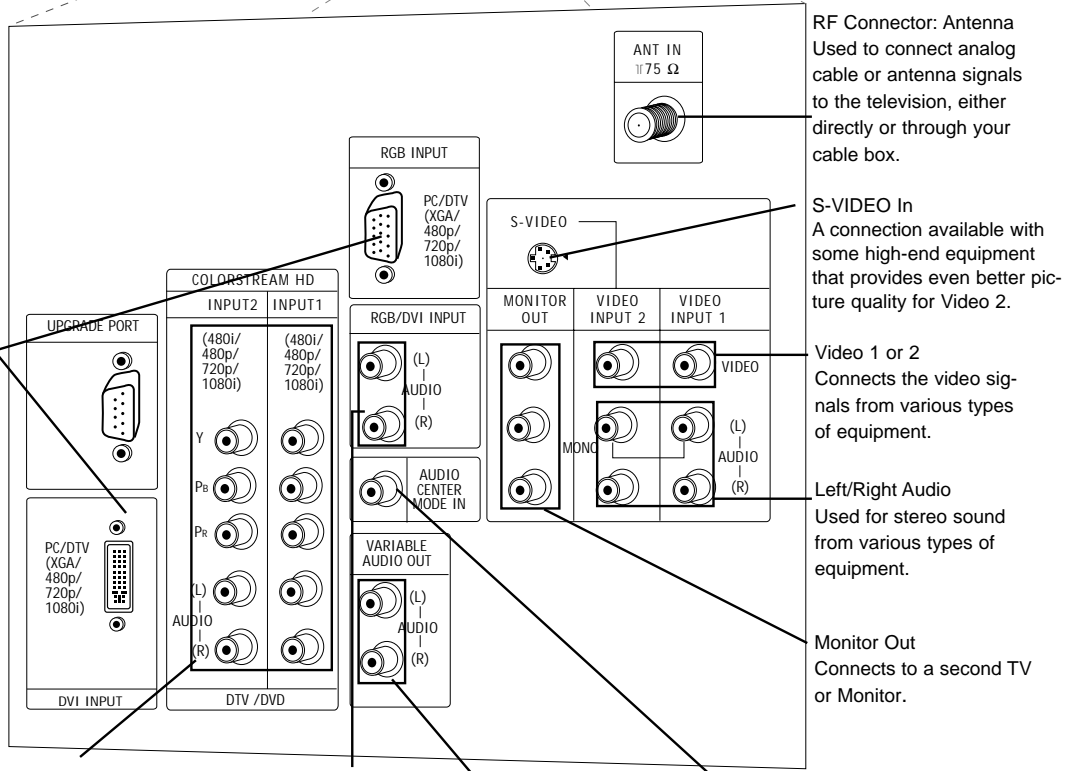
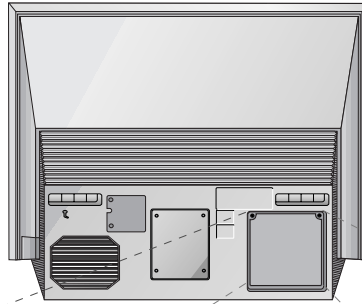

RF Connector: Antenna
Used to connect analog cable or antenna signals to the television, either directly or through your cable box.

S-VIDEO In
A connection available with some high-end equipment that provides even better picture quality for Video 2.

Video 1 or 2
Connects the video signals from various types of equipment.

Left/Right Audio
Used for stereo sound from various types of equipment.

Monitor Out
Connects to a second TV or Monitor.

RGB/DVI Input
Connect the TV output connector from a PC/DTV to the appropriate input port.

COLORSTREAM HD
Connect a ColorStream HD video/audio device to these jacks. Refer to your DVD manual for further information.

RGB/DVI Input
Used for audio connections from a PC source or HD-STB Satellite system.

Variable Audio Out
Used to connect either an external amplifier, or add a sub-woofer to your surround sound system.

Audio Center Mode In
Connect to external Dolby® Digital Center "preamp output."

Mini glossary

JACK A connection on the back of a TV, VCR, or any other A/V device. This includes the RF jack and the Audio/Video jacks that are color-coded.

SIGNAL Picture and sound traveling through cable, or over the air, to your television screen.

DESCRIPTION OF CONTROLS

Front Connection Panel

There are four jacks on the left front of your projection TV that make connecting Audio/Video devices like video games and camcorders very simple.

The jacks are like those found on the back jack connection panel. This means that most equipment that connects to those types of jacks on the rear jackpack, may be connected to the front connection panel.

To use the front jacks as the signal source, select them using Main Input menu as described on page 27. They will be named "Front Video" in the Main Input menu.

- ◆ If you input both Front Video and S-Video, only the S-Video will work.
- ◆ If you're connecting a video game device, make sure to change the picture settings with the Picture Mode option in the Video menu.

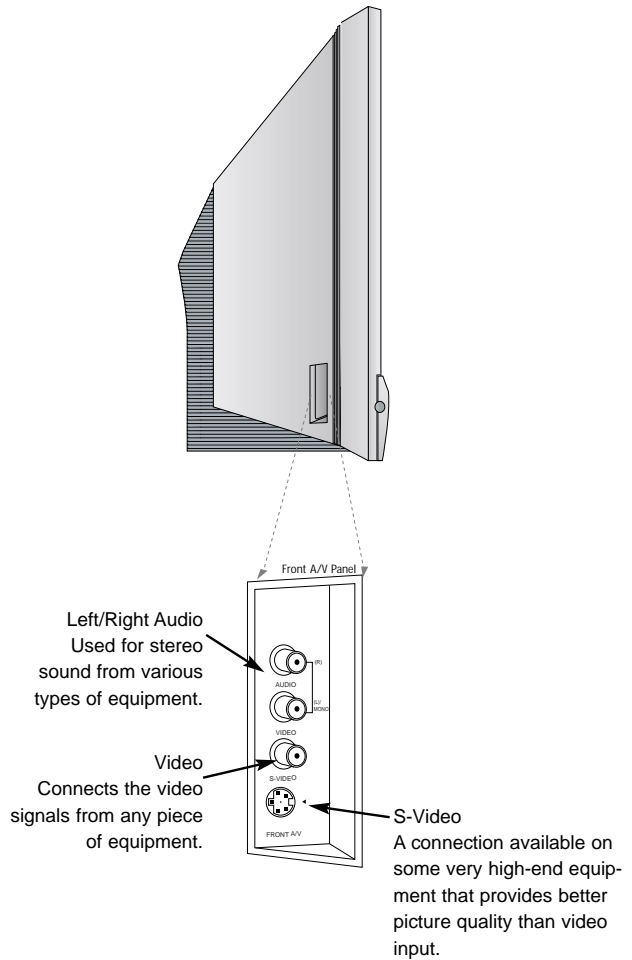

Mini glossary

A/V CABLES Audio/Video cables. Three cable connectors—Right audio (red), Left audio (white), and Video (yellow). A/V cables are used for stereo playback of videocassettes and for higher quality picture and sound from other A/V devices.

A/V DEVICE Any device that produces video or sound (VCR, DVD, cable box, or television).

DESCRIPTION OF CONTROLS

Remote Control Functions in TV Mode

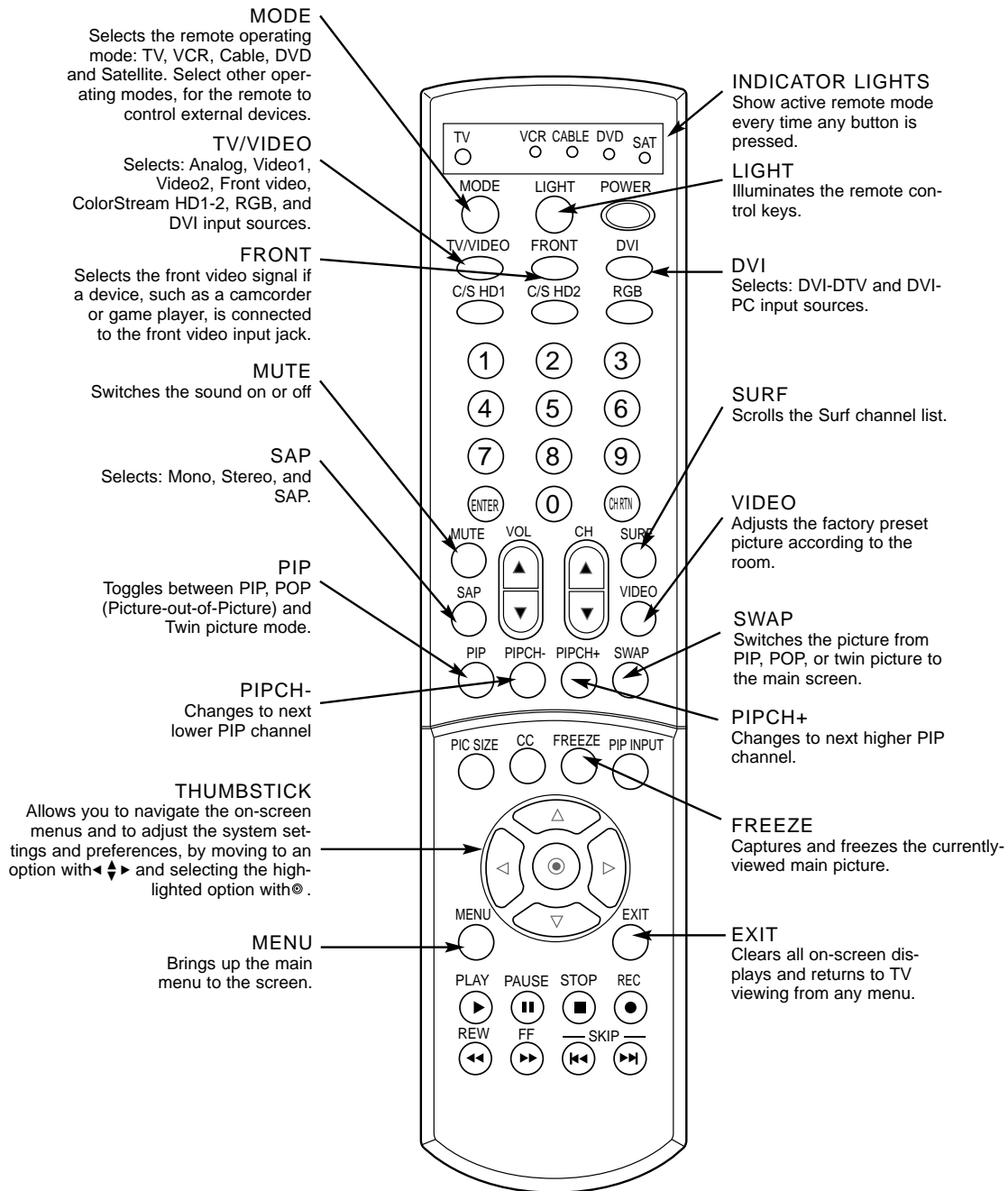

DESCRIPTION OF CONTROLS

Remote Control Functions in TV Mode

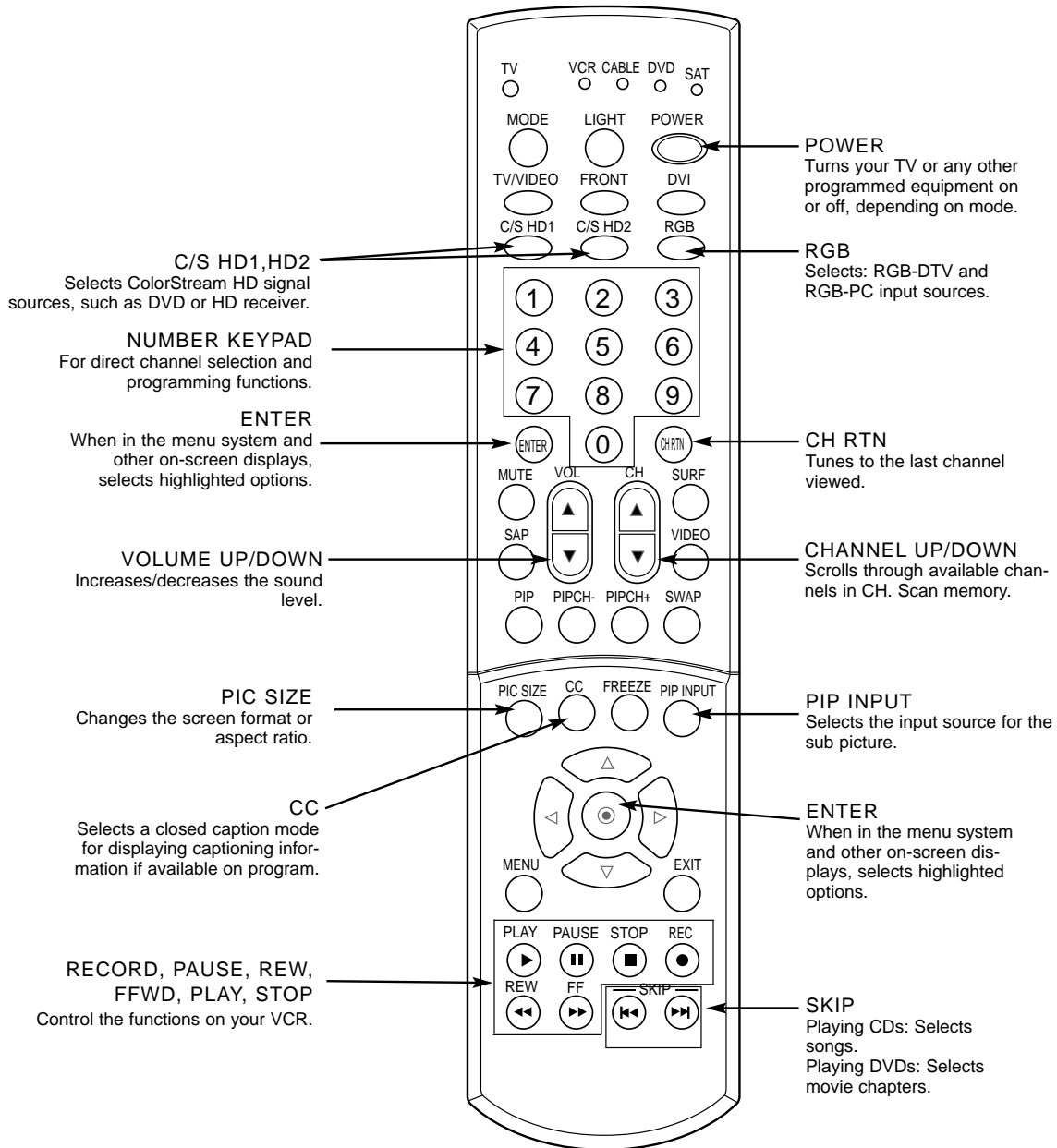

DESCRIPTION OF CONTROLS

On-Screen Displays

This page describes your on-screen display and information banner options.

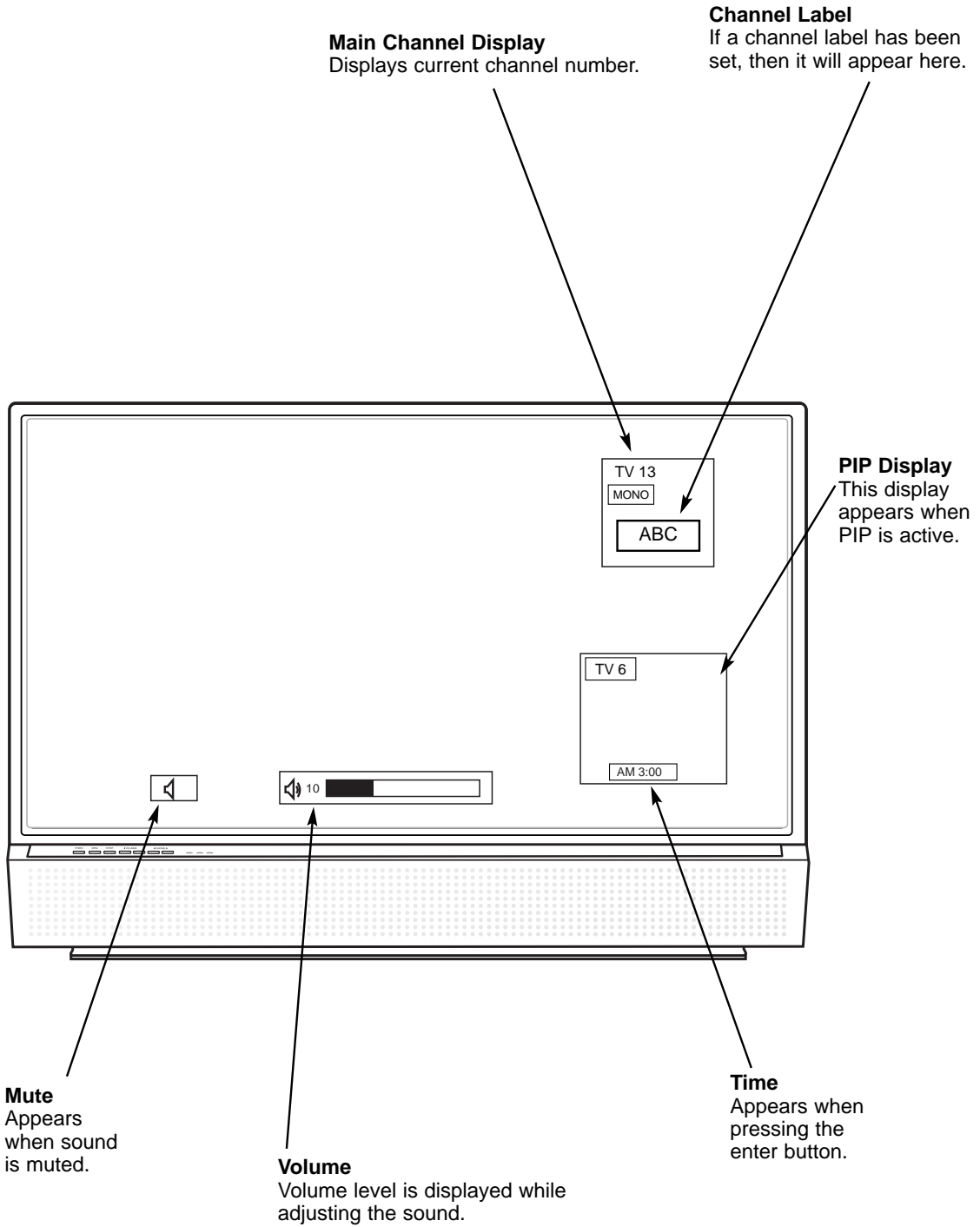

DESCRIPTION OF CONTROLS

Front Panel Controls

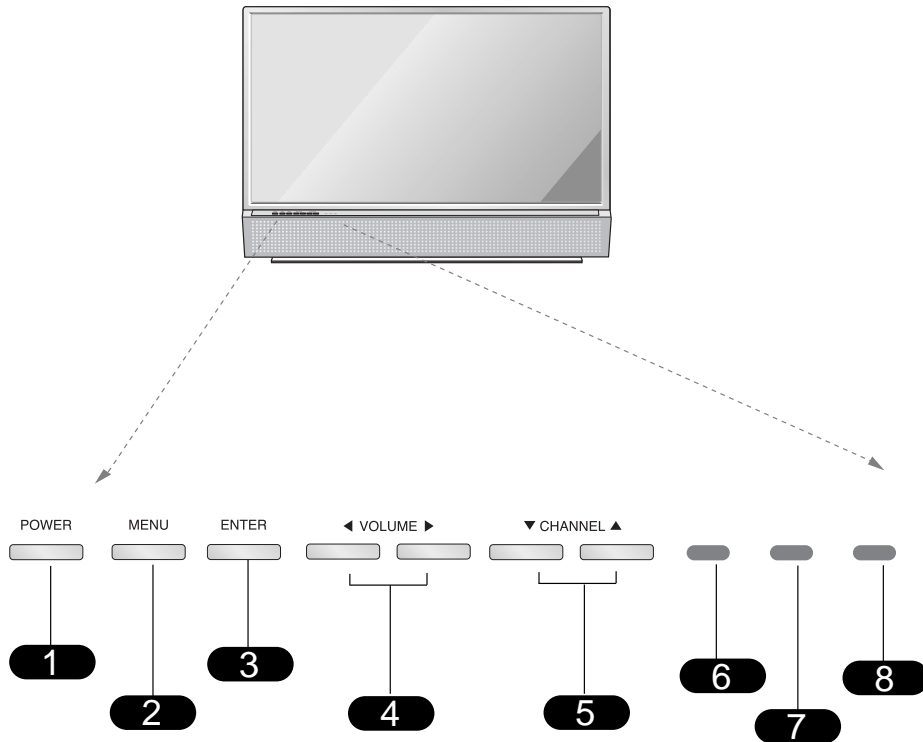

- 1** POWER
- 2** MENU
- 3** ENTER (Same as ENTER button on your remote control)
- 4** VOLUME UP / DOWN
- 5** CHANNEL UP / DOWN
- 6** Operation indicator.
- 7** Lamp indicator.
- 8** Temperature indicator.

- ◆ See menu pages for instructions on using the on-screen menus.
- ◆ The POWER, MENU, ENTER, VOLUME, and CHANNEL buttons work just as they do on your remote control.
- ◆ If TV is moved from cold to normal room temperature, condensation may form inside TV, wait 6~7 hours for the TV to adjust to room temperature before turning it on.

ADJUSTMENT INSTRUCTIONS

1. Application Object

This instruction is for the application to the DLP Projection(Chassis: MB-042G).

2. Notes

- (1) The power source insulation of this DLP Projection is not charging type and you may not use the transformer for insulation. But you'd better adjust the set after operating it with insulation transformer between power supply cable and input part of the set for protecting the adjusting equipments.
- (2) The adjustment must be performed under the correct sequence.
- (3) The adjustment must be performed in the circumstance of $25\pm 5^{\circ}\text{C}$ of temperature and $65\pm 10\%$ of relative humidity if there is no specific designation.
- (4) The input voltage of the receiver must keep AC 120V, 60Hz in adjusting.
- (5) The set must be operated for 5 minutes preliminarily before adjustment if there is no specific designation. The preliminary operation must be performed after receiving 100% white pattern, but reception of the moving picture may also be possible in unavoidable case.

3. Composition of Adjustment Mode

- (1) All adjustment mode are entered by pressing the ADJ key on the remote control, after adjustment press the ADJ key to come out.
- (2) Below picture is screen composition when press the first ADJ key.



<Fig. 1> Adjustment Mode OSD

- (3) As shown <Fig. 1>, using the (CH+ (▲)), CH- (▼) key, select to item press the ENTER or VOLUME+ (▶) key to enter the appropriate item and operate the adjustment.
- (4) Change the value of adjustment with using the volume + (▶), volume - (◀) key after select adjustment item one more using the (CH+ (▲)), CH- (▼) key in ADJ Mode.
- (5) Press the ADJ key to come out after adjustment.
- (6) Preparation for Adjustment
 - 1) Connect the power to TV Set and set the status of "Power on".
 - 2) Heat-Run must operate over 5 minutes before adjustment.

4. Driver Board Bin Setting

See Bias Voltage Bin on the DMD as shown <Fig. 2> and adjust the switch on the lower Driver Board as shown <Fig. 3>.

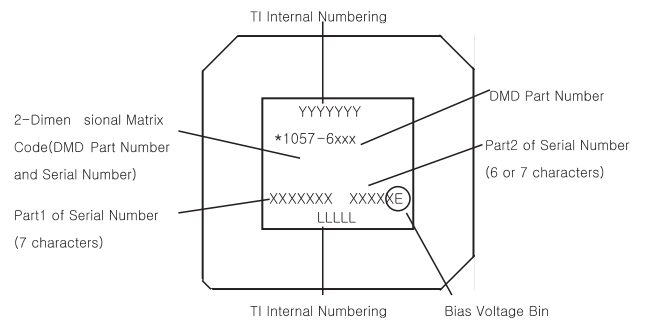

<Fig. 2> DMD Marking Locations

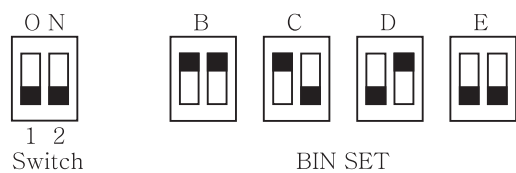

<Fig. 3> Driver Board Bin Setting

ADJUSTMENT INSTRUCTIONS

11. Screen Position Adjustment

11-1. Required Test Equipments

Remote Control for Adjustment

11-2. Horizontal Position Adjustment

- (1) Press ADJ key on the remote control to enter the adjustment mode.
- (2) Select the POSITION of the adjustment menu.
- (3) Appear the adjustment pattern as below figure.

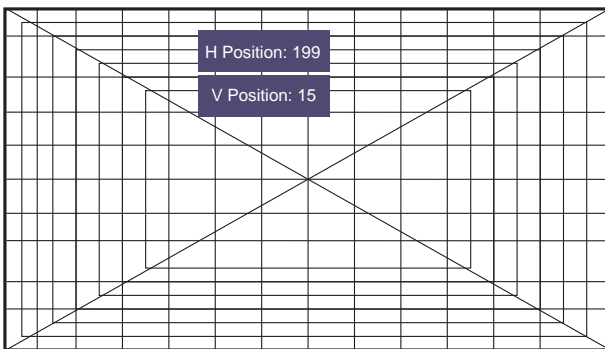

<Fig. 13> Pattern for Screen Adjustment

- (4) Change data with using the VOLUME key on the remote control in order to be left/right symmetry screen.
- (5) In case of over variable range is N.G.

11-3. Vertical Position Adjustment

- (1) Change data with using the CHANNEL key on the remote control in order to be upper/down symmetry screen. (Refer to <Fig. 14>)
- (2) In case of over variable range is N.G.

* After adjustment completed, receive NTSC-M Digital Pattern and check the adjustment level.

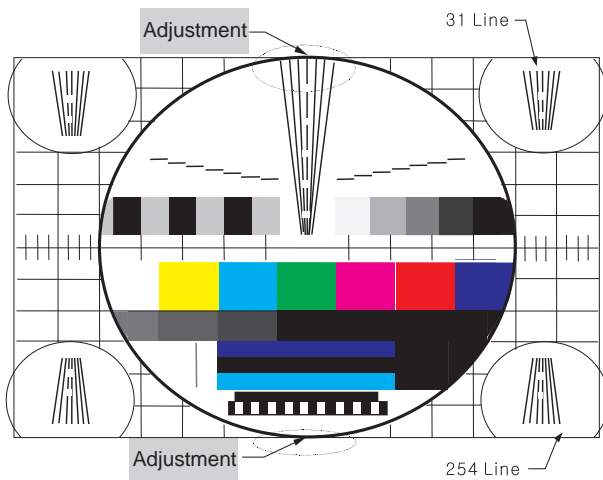

<Fig. 14>

12. White Balance Adjustment

(Day Light Mode) : R fixation

12-1. Required Test Equipments

CA110 or CA210

12-2. White base value (Medium)

$x = 0.283$; 0.01 , $y = 0.297$; 0.01

12-3. Adjustment Sequence

- (1) Install the equipment(CA110) be 20cm(CA210: 5cm) away from screen center.
- (2) Select White balance by pressing ADJ Mode Key on Remote control.
- (3) Warm(6500°K) : $x = 0.313$, $y = 0.320$
 - 1) R Gain 110 fixation
 - 2) Adjust white balance changing G, B gain.
 - 3) Offset fixation R/G/B --> -8, -10, -8
- (4) Medium(9300°K) : $x = 0.283$, $y = 0.297$
 - 1) R Gain 112 fixation
 - 2) Adjust white balance changing G, B gain.
 - 3) Offset fixation R/G/B --> -11, -11, -8
- (5) Cool(12000°K) : $x = 0.275$, $y = 0.277$
 - 1) R Gain 112 fixation
 - 2) Adjust white balance changing G, B gain.
 - 3) Offset fixation R/G/B --> -12, -13, -8

* Reference : Spoke Func. -> 0
 Gamma table -> 0
 Lamp Type -> 1(OSR2/PHIL)
 Img. Orient. -> 0

ADJUSTMENT INSTRUCTIONS

13. CWI (Color Wheel) Adjustment

13-1. Required Test Equipments

Remote control for adjustment

13-2. Preparation for Adjustment

- (1) Connect the power at TV set to turn set on.
- (2) Using the remote control, enter from ADJUST to CWI.
(Base value: 250)

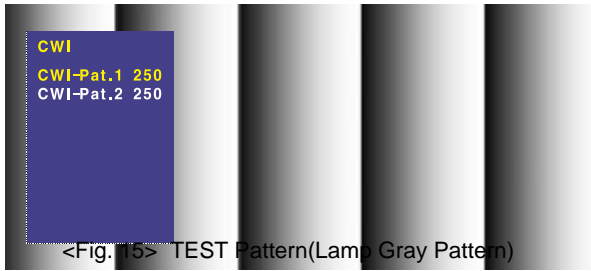

13-3. Adjustment

- (1) Using the Volume key, adjust CWI-Pat. 1 to the left/right.
- (2) As adjustment, check the appearance noise in the TEST Pattern.
Setting the value reduced 3~4 step at a GREEN noise disappearing spot.

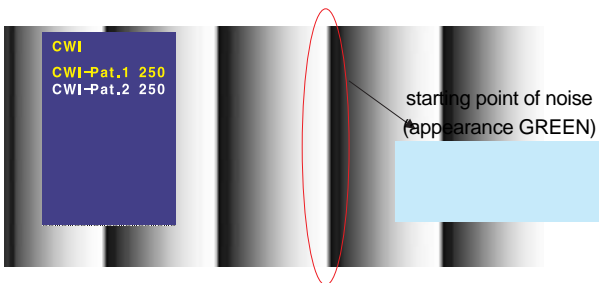

- (3) Using CH UP/DOWN key of the remote control, enter the RED PATTERN.
- (4) Check the RED Pattern to uniform. After checking unless abnormality do OK.



<Fig. 16> TEST Pattern(RED Pattern)

* As temperature is different sensitivity, change angle of the color wheel. At this time, the adjustment is done because color may be changed.

14. Main/Sub Contrast Adjustment

14-1. Preparation for Adjustment

- (1) Connector RF-NTSC Cable to rear terminal.
- (2) Confirms picture probably is the normal.

14-2. Adjustment

- (1) Using the remote control, enter from ADJUST to Contrast.
(Base value: MAIN-135, SUB-46)
- (2) Select the adjustment item of MAIN/SUB using CH +/- key.
- (3) Revises the contrast of MAIN/SUB using VOL +/- key.
- (4) The field and the letters are distinguished.
The field and the letters are distinguished.
Adjust to be difference of the MAIN/SUB it is few most.

14-3. Overseas Factory Production Contrast Adjustment Method

- (1) Do the same method as above method.
- (2) Make the as same below pattern in VHF 6CH using RF MODULATOR and PATTERN GENERATOR.
- (3) Adjust to become dividing 15 and 16 Gray of Main/Sub screen .
- (4) Adjust to be identical Main/Sub contrast of MAX 16Gray.
- (5) Make the adjustment pattern refer to <Fig. 17>.

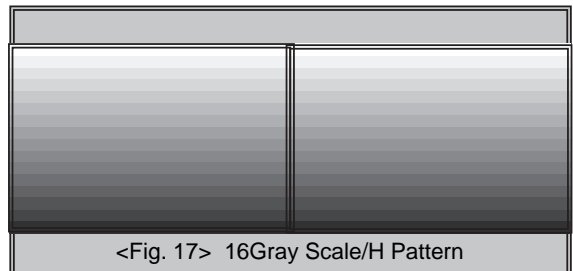

EXPLODED VIEW

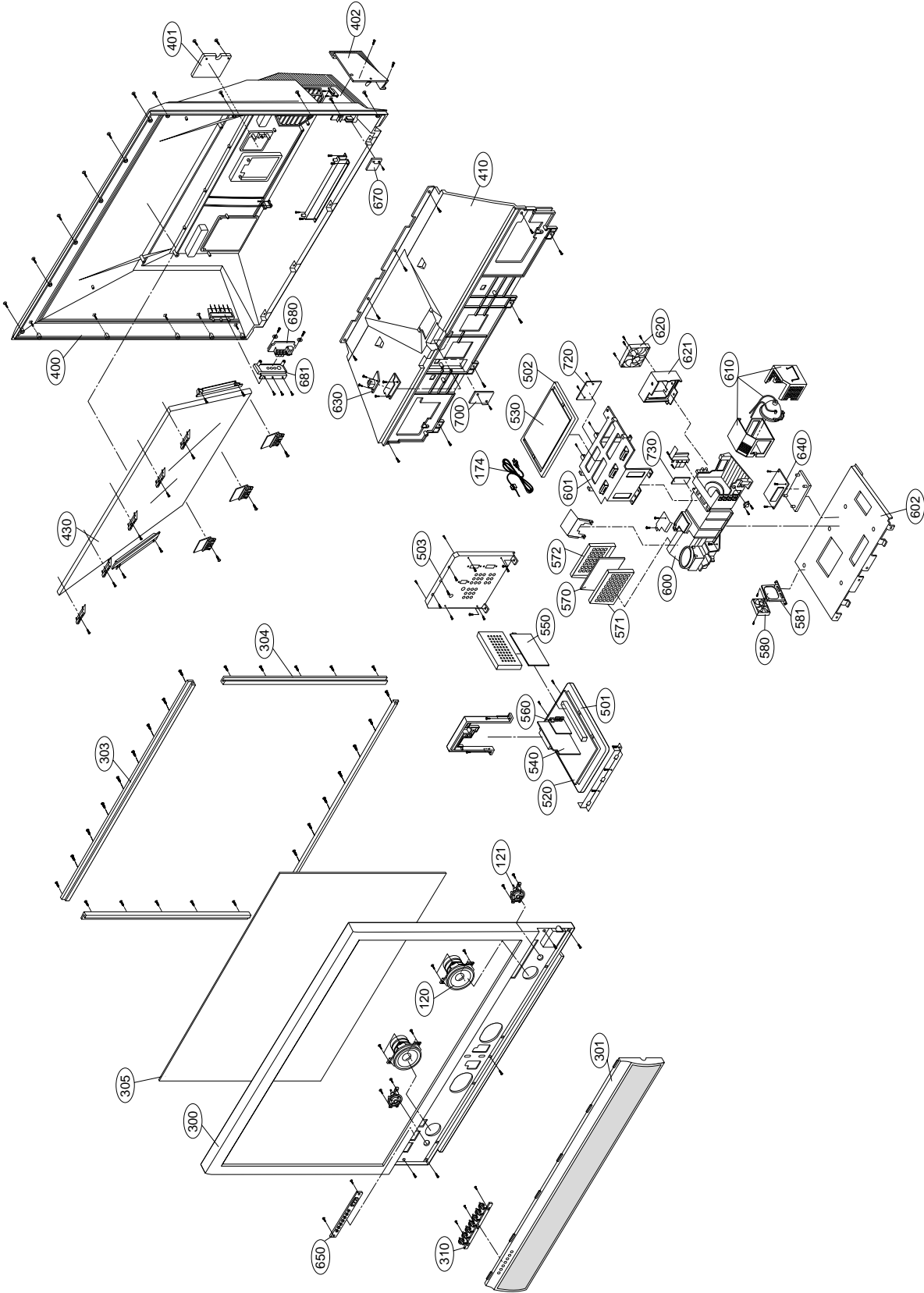

EXPLODED VIEW PARTS LIST

CAUTION:

The international hazard symbols “” in the schematic diagram and the parts list designate components which have special characteristics important for safety and should be replaced only with types identical to those in the original circuit or specified in the parts list. The mounting position of replacements is to be identical with originals. Before replacing any of these components, read carefully the PRODUCT SAFETY NOTICE. Do not degrade the safety of the receiver through improper servicing

NOTICE:

- The parts number must be used when ordering parts, in order to assist in processing, be sure to include the Model number and Description.
- The P.C. board assembly with * mark is no longer available after the end of the production.

LOCA. NO.	PART NO.	DESCRIPTION	REFERENCE NO.
120	AZ684014	SPEAKER, WOOFER C080P23K1450 ESTEC WOOFER 8OHM 15/25W	6400WESC01A
121	AZ684015	SPEAKER, TWEETER D016D01K1450 8OHM 15/25W 85DB 50 NON	6400DESA01A
174	AZ684016	POWER CORD, UL/CSA3000MM 3P 3000MM HUG BLACK 500MH 7A	6410VUH004A
300	AZ780010	CABINET, DN-44SZ80L LCD PJT FRONT	3090V00556A
301	AZ780011	BRACKET ASSEMBLY, SPEAKER RU-44SZ83D MB042G GRILLE TOSHIBA	4811V00174A
303	AZ780012	SOPPORTER, SCREEN AL BAR U/L	4980V00A29G
304	AZ780013	SOPPORTER, SCREEN AL BAR R/L	4980V00A29H
305	AZ780014	SCREEN ASSEMBLY, WLF DN-44SZ80L 991*564*3.4	3351V00020A
310	AZ780015	BUTTON, CONTROL RU-44SZ83D ABS, HF-380 7KEY TOSHIBA OEM	5020V01025A
400	AZ780016	BACK COVER, DN-44SZ80L NB-042A	3808V00455A
401	AZ780017	COVER, DN-44SZ80L ABS POWER CODE	3550V00424A
402	AZ780018	COVER, LAMP RU-44SZ83D HIPS 40AF TOSHIBA	3550V00423D
410	AZ780019	COVER, DN-44SZ80L HIPS 40AF RU-44SZ83D	3550V00425B
430	AZ780020	MIRROR, REFLECTION AVATEC GLASS FRONTSIDE 940 (H1)*500 (H2)*498 (V)*3.0 (T) 1ST 44	5018V00039F
501	AZ780021	FRAME, ABS AF-303S RN-48SZ40H MAIN CHASSIS	3210V00165B
502	AZ780022	FRAME, CHASSIS HIPS 40AF DN-44SZ60D SMPS	3210V00191A
503	AZ780023	BRACKET ASSEMBLY, REAR AV RU-44SZ83D NON BOARD TERMINAL	4811V00125G
520	AZ680001	PCB ASSEMBLY, MAIN MB-042G M/I FOR RU-44SZ83D(TOSHIBA OEM)	6871VMMT51A
530	AZ680002	PCB ASSEMBLY, POWER SMPS MB042G M/I FOR RU-44SZ83D (TOSHIBA OEM)	6871VPMMA84A
540	AZ680003	PCB ASSEMBLY, SUB TUNER MB-042G M/I FOR RU-44SZ83D (TOSHIBA OEM)	6871VSMAAJA
550	AZ680004	PCB ASSEMBLY, SUB DIGITAL MB-042G M/I FOR RU-44SZ83D (TOSHIBA OEM)	6871VSMT19A
560	AZ680005	PCB ASSEMBLY, SUB MB-042G COMPONENT M/I FOR RU-44SZ83D (TOSHIBA OEM)	6871VSMAAHA
570	AZ680006	PCB ASSEMBLY, SUB CRM MB04EA DRIVE M/I ASSY FOR LVDS HD2 (TOSHIBA)	6871VSMZ44F
571	AZ780024	SHIELD, COVER DN-44SZ60D NB03KB AL DRIVER FRONT DLP720P SHILD CASE	4814V00394B
572	AZ780025	SHIELD ASSY, DN-44SZ60D NB03KB SUS, SHILD CASE DRIVE BOTTOM	4814V00434B
580	AZ684017	FAN, DC F6025S06B2-RH DONGYANG 60*25 6 2000RPM.650MM	5900V06007A
581	AZ780026	SUPPORTER, FAN SPCC(CR), DN-44SZ60H	4980V00813B
600	AZ684002	CHASSIS ASSEMBLY, ENGINE MB-042G 720P FOR RU-44SZ83D (TOSHIBA OEM)	3141VEN044A
601	AZ780027	SUPPORTER, SMPS EGI RU-44SZ83D	4980V01175A
602	AZ780028	SUPPORTER, OPTICAL EGI ENGINE DLP RZ-44SZ80DB	4980V00817B
610	AZ684001	LAMP UNIT	TBL4-LMP
620	AZ684018	FAN, DC G12225S06B2-FS DONGYANG 120*120*25 6V 1000RPM.1000MM	5900V12005A
621	AZ780029	BRACKET, FIXER RN-44SZ50H NB03JA ABS, AF-303S FAN HOLDER	4810V00813A
630	AZ680007	PCB ASSEMBLY, SUB P/AMP NB042A DN-44SZ80L	6871VSN221E
640	AZ684019	BALLAST, EUC-120P/H11 PHILIPS 20KV	6316000007A
650	AZ680008	PCB ASSEMBLY, SUB CONT MB042A 80L CONTROL	6871VSME75A
670	AZ680009	PCB ASSEMBLY, SUB MB042A 80L CASE DET	6871VSME03D
680	AZ680010	PCB ASSEMBLY, SUB MB042A SIDE AV DN-44SZ80L	6871VSN220B
681	AZ680011	BOARD ASSY, RU-44SZ83D MB042G TOSHIBA OEM	3500V00061Z
700	AZ680012	PCB ASSEMBLY, SUB INTER MB042G FOR RU-44SZ83D	6871VSMER82G
720	AZ680013	PCB ASSEMBLY, POWER SMPS MB042G AC INPUT M/I (TOSHIBA OEM)	6871VPMMA85A
730	AZ680014	PCB ASSEMBLY, SUB SENSOR MB03CC HD2 7SEGMENT SENSOR B/D	6871VSMW40E

ELECTRICAL REPLACEMENT PARTS LIST

CAUTION:

The international hazard symbols “” in the schematic diagram and the parts list designate components which have special characteristics important for safety and should be replaced only with types identical to those in the original circuit or specified in the parts list. The mounting position of replacements is to be identical with originals. Before replacing any of these components, read carefully the PRODUCT SAFETY NOTICE. Do not degrade the safety of the receiver through improper servicing.

NOTICE:

- The part number must be used when ordering parts, in order to assist in processing, be sure to include the Model number and Description.
- The P.C. board assembly with * mark is no longer available after the end of the production.

For Capacitor & Resistors, the characters at 2nd and 3rd digit in the REFERENCE NO. means as follows;

- | | |
|--------------------------|-----------------------|
| CC, CX, CK, CN : Ceramic | RD : Carbon Film |
| CQ : Polyester | RS : Metal Oxide Film |
| CE : Electrolytic | RN : Metal Film |
| | RF : Fusible |

LOCA. NO.	PART NO.	DESCRIPTION	REFERENCE NO.
IC			
		IC	
IC1	AZ681001	M37151EFFP 42P SSOP R/TP MICOM	0ICTMMI057A
IC1	AZ681002	GP2S40 SHARP 4P	0IMCRSH003A
IC1	AZ681003	TC7S14F(T5L,T)5P	0IPRPTO002A
IC100	AZ681004	74HC14D 14SOP	0IPH741400E
IC100	AZ681005	MC34063ADR2G SO-8P DC-DC CONVERTER	0IPMGON013B
IC1000	AZ681006	M62320FP 16P SOP	0IMI623200B
IC1001	AZ681006	M62320FP 16P SOP	0IMI623200B
IC1004	AZ681007	THC63LVD104A 64P	0IMCRTH003A
IC101	AZ681008	KIA278R05PI TO220IS, 4P	0IMCRKE006A
IC102	AZ681009	M306V7FJFP 100P	0IMCRM1070B
IC102	AZ681010	KIA7809API TO220 ST 3P 9V	0IKE780900M
IC103	AZ681011	24LC256-I/SM 8P 256K IIC SERIAL EEPROM	0IMP242560A
IC104	AZ681012	KIA7027AF 3, SOT-89 TP RESET IC 2.7V	0IKE702700D
IC105	AZ681013	ST3232CDR SOP16 RS232	0IMCRSG010A
IC106	AZ681014	THC63LVD103 64P	0IMCRTH002A
IC107	AZ681015	EL2250CS-T7 8P	0IMCRET002B
IC1200	AZ681016	KIA78R05F 5PIN DPAK R/TP 1A, 5V	0IPMGKE030A
IC1201	AZ681017	CXA2181Q 48P VIDEO SYNC SELECTOR	0IMCRSO025A
IC2	AZ681018	TC7S14F(T5L,T)5P	0IPRPTO002A
IC2	AZ681019	KIA78R33API 4P TO220 ST 3.3V	0IMCRKE019A
IC200	AZ681020	CXA2069Q QFP64 BK 12C BUS AV S/W	0ISO206900A
IC3	AZ681021	KIA78R05API 4P TO220 ST 5V	0IMCRKE018A
IC300	AZ681022	VPC3230D C5 80P VIDEO PROCESSOR	0IIT323000E
IC301	AZ681023	M74HC123RM13TR 16P	0ISTLSSG009A
IC302	AZ681024	XC95144XL-10TQ100C 3.3V	0IMCRXL003A
IC304	AZ681025	P82B715T 8SOP	0IPH827150A
IC305	AZ681026	AT24C02N-10SI-2.7 8P	0IMMRAL014B
IC306	AZ681027	AD9883AKST-110 80P DIGITAL BOARD	0IMCRAD002A
IC307	AZ681028	SIL 169CT100 100P	0IMCRS5003A
IC4	AZ681029	KA75420ZTA 3P TO-92 TP 4.2V	0IFA754207A

LOCA. NO.	PART NO.	DESCRIPTION	REFERENCE NO.
IC404	AZ681008	KIA278R05PI TO220IS, 4P	0IMCRKE006A
IC405	AZ681030	KIA278R33PI TO220IS, 4P	0IMCRKE006B
IC406	AZ681030	KIA278R33PI TO220IS, 4P	0IMCRKE006B
IC407	AZ681031	KIA278R25PI 2.5V 2A TO220IS, 4P	0IPMGKE045A
IC409	AZ681032	KIA278R12API 4P TO220IS	0IMCRKE003B
IC5	AZ681033	AT24C16AN-10SI-2.7 8P	0IMCRAL006A
IC500	AZ681034	LGDT1502M LG IC 304P	0ICTMLG003C
IC501	AZ681035	HY57V643220C(L)T-6 86P	0IMMRHY033A
IC502	AZ681036	SN74LVC00AD 14SOP	0ITI740000Q
IC502	AZ681037	X1272-0346 251P	0IZZVF0020B
IC503	AZ681038	LGDT1901A LG IC 24P	0ICTMLG013A
IC504	AZ681035	HY57V643220C(L)T-6 86P	0IMMRHY033A
IC600	AZ681039	MSP3440G QA B8 V3 80 SOUND IC	0IMCRMN014A
IC601	AZ681040	KA4558D 8SOP OP AMP	0ISS455880A
IC602	AZ681029	KA75420ZTA 3P TO-92 TP 4.2V	0IFA754207A
IC700	AZ681041	2503227-001(DDP1010) 529P	0IMCRT011A
IC701	AZ681030	KIA278R33PI TO220IS, 4P ST 3.3V	0IMCRKE006B
IC701	AZ681042	AT49BV8192A-90TI 48P	0IMMRAL015C
IC702	AZ681030	KIA278R33PI TO220IS, 4P ST 3.3V	0IMCRKE006B
IC702	AZ681043	K4S161622E-TC80 50TSOP	0ISS416162C
IC702	AZ681044	KA2903 FAIRCHILD 8SOP	0IMCRFA003A
IC703	AZ681031	KIA278R25PI 2.5V 2A TO220IS, 4P	0IPMGKE045A
IC703	AZ681045	UPD64011AGM-8ED-A NEC LQFP 160P	0IMCRNE045A
IC705	AZ681033	AT24C16AN-10SI-2.7 8P	0IMCRAL006A
IC706	AZ681046	LA4282 12S 2CHX10W AUDIO AMP	0ISA428200A
IC707	AZ681032	KIA278R12API 4P TO220IS ST 12V/1A	0IMCRKE003B
IC708	AZ681030	KIA278R33PI TO220IS, 4P ST 3.3V	0IMCRKE006B
IC709	AZ681031	KIA278R25PI 2.5V 2A TO220IS, 4P	0IPMGKE045A
IC800	AZ681047	K4R271669F-TCS8 54P	0IMMRSS053B
IC801	AZ681048	CDCR83 24P	0IMCRTI014A
IC802	AZ681049	74VIT125CTR 5P SOT323-5L	0IMCRSG007A
IC803	AZ681050	74LX1G14CTR 5P SOT323-5L	0IMCRSG008A
IC804	AZ681050	74LX1G14CTR 5P SOT323-5L	0IMCRSG008A
IC805	AZ681051	MAX708SCSA 8P	0IMCRMX001A
IC806	AZ681050	74LX1G14CTR 5P SOT323-5L	0IMCRSG008A
IC807	AZ681051	MAX708SCSA 8P	0IMCRMX001A

ELECTRICAL REPLACEMENT PARTS LIST

LOCA. NO.	PART NO.	DESCRIPTION	REFERENCE NO.
IC808	AZ681050	74LX1G14CTR 5P SOT323-5L	0IMCRSG008A
IC809	AZ681052	LD1086DT15TR 2P	0IPMGSG018C
IC810	AZ681053	SC15651ST-1.8 3P SOT223	0IMCRSJ001A
IC810	AZ681054	SMA-E1017 3P	0IMCRSK004A
IC830	AZ681055	PC817XF3 4D PHOTO COUPLER	0ISH817300B
IC850	AZ681056	PQ30RV21 TO-220	0ISH302122A
IC851	AZ681057	KA431Z FAIRCHILD 3DIP	0IMCRFA007A
IC870	AZ681057	KA431Z FAIRCHILD 3DIP	0IMCRFA007A
IC900	AZ681058	LGDP4410 LG IC 176P	0ICTMLG018A
IC900	AZ681059	2503253-0003(DAD1000-3) 80P	0IMCRTI012B
IC901	AZ681060	SNSH6742CFA(P32J6742PAG) 64P	0IMCRTI013A
IC906	AZ681049	74VIT125CTR 5P SOT323-5L	0IMCRSG007A
IC907	AZ681050	74LX1G14CTR 5P SOT323-5L	0IMCRSG008A
IC908	AZ681050	74LX1G14CTR 5P SOT323-5L	0IMCRSG008A
IC909	AZ681061	74LX1G07CTR 5P SOT323-5L	0IMCRSG008B
IC910	AZ681049	74VIT125CTR 5P SOT323-5L	0IMCRSG007A
TRANSISTOR			
IC903	AZ580001	FDS6930A 8P SO-8 30V 5.5A	0TFFC80015A
IC904	AZ580001	FDS6930A 8P SO-8 30V 5.5A	0TFFC80015A
IC905	AZ580001	FDS6930A 8P SO-8 30V 5.5A	0TFFC80015A
Q100	AZ580002	CHIP 2SC3875S(ALY)KEC	0TR387500AA
Q100	AZ580003	BSS83	0TR830009BA
Q1000	AZ580002	CHIP 2SC3875S(ALY)KEC	0TR387500AA
Q1001	AZ580002	CHIP 2SC3875S(ALY)KEC	0TR387500AA
Q1002	AZ580002	CHIP 2SC3875S(ALY)KEC	0TR387500AA
Q1003	AZ580002	CHIP 2SC3875S(ALY)KEC	0TR387500AA
Q1004	AZ580002	CHIP 2SC3875S(ALY)KEC	0TR387500AA
Q1005	AZ580002	CHIP 2SC3875S(ALY)KEC	0TR387500AA
Q101	AZ580003	BSS83	0TR830009BA
Q102	AZ580004	CHIP KRC102S SOY-23	0TR102009AG
Q103	AZ580002	CHIP 2SC3875S(ALY)KEC	0TR387500AA
Q104	AZ580002	CHIP 2SC3875S(ALY)KEC	0TR387500AA
Q105	AZ580005	CHIP 2SA1504S(ASY)KEC	0TR150400BA
Q107	AZ580002	CHIP 2SC3875S(ALY)KEC	0TR387500AA
Q1201	AZ580002	CHIP 2SC3875S(ALY)KEC	0TR387500AA
Q1202	AZ580002	CHIP 2SC3875S(ALY)KEC	0TR387500AA
Q1203	AZ580002	CHIP 2SC3875S(ALY)KEC	0TR387500AA
Q1204	AZ580002	CHIP 2SC3875S(ALY)KEC	0TR387500AA
Q1205	AZ580002	CHIP 2SC3875S(ALY)KEC	0TR387500AA
Q1206	AZ580002	CHIP 2SC3875S(ALY)KEC	0TR387500AA
Q1208	AZ580005	CHIP 2SA1504S(ASY)KEC	0TR150400BA
Q1209	AZ580002	CHIP 2SC3875S(ALY)KEC	0TR387500AA
Q1210	AZ580005	CHIP 2SA1504S(ASY)KEC	0TR150400BA
Q1211	AZ580002	CHIP 2SC3875S(ALY)KEC	0TR387500AA
Q1213	AZ580002	CHIP 2SC3875S(ALY)KEC	0TR387500AA
Q1218	AZ580005	CHIP 2SA1504S(ASY)KEC	0TR150400BA
Q1219	AZ580002	CHIP 2SC3875S(ALY)KEC	0TR387500AA
Q1222	AZ580002	CHIP 2SC3875S(ALY)KEC	0TR387500AA
Q1223	AZ580002	CHIP 2SC3875S(ALY)KEC	0TR387500AA
Q1224	AZ580002	CHIP 2SC3875S(ALY)KEC	0TR387500AA
Q1225	AZ580002	CHIP 2SC3875S(ALY)KEC	0TR387500AA
Q200	AZ580002	CHIP 2SC3875S(ALY)KEC	0TR387500AA
Q201	AZ580002	CHIP 2SC3875S(ALY)KEC	0TR387500AA
Q202	AZ580002	CHIP 2SC3875S(ALY)KEC	0TR387500AA
Q203	AZ580002	CHIP 2SC3875S(ALY)KEC	0TR387500AA
Q204	AZ580002	CHIP 2SC3875S(ALY)KEC	0TR387500AA

LOCA. NO.	PART NO.	DESCRIPTION	REFERENCE NO.
Q205	AZ580002	CHIP 2SC3875S(ALY)KEC	0TR387500AA
Q206	AZ580006	KRA102S SOT23 CHIP TR	0TR102008AA
Q207	AZ580002	CHIP 2SC3875S(ALY)KEC	0TR387500AA
Q208	AZ580002	CHIP 2SC3875S(ALY)KEC	0TR387500AA
Q209	AZ580002	CHIP 2SC3875S(ALY)KEC	0TR387500AA
Q210	AZ580002	CHIP 2SC3875S(ALY)KEC	0TR387500AA
Q211	AZ580002	CHIP 2SC3875S(ALY)KEC	0TR387500AA
Q212	AZ580002	CHIP 2SC3875S(ALY)KEC	0TR387500AA
Q302	AZ580002	CHIP 2SC3875S(ALY)KEC	0TR387500AA
Q305	AZ580002	CHIP 2SC3875S(ALY)KEC	0TR387500AA
Q306	AZ580002	CHIP 2SC3875S(ALY)KEC	0TR387500AA
Q307	AZ580002	CHIP 2SC3875S(ALY)KEC	0TR387500AA
Q308	AZ580003	BSS83	0TR830009BA
Q309	AZ580003	BSS83	0TR830009BA
Q310	AZ580002	CHIP 2SC3875S(ALY)KEC	0TR387500AA
Q311	AZ580002	CHIP 2SC3875S(ALY)KEC	0TR387500AA
Q501	AZ580003	BSS83	0TR830009BA
Q502	AZ580003	BSS83	0TR830009BA
Q600	AZ580002	CHIP 2SC3875S(ALY)KEC	0TR387500AA
Q601	AZ580002	CHIP 2SC3875S(ALY)KEC	0TR387500AA
Q602	AZ580002	CHIP 2SC3875S(ALY)KEC	0TR387500AA
Q603	AZ580002	CHIP 2SC3875S(ALY)KEC	0TR387500AA
Q604	AZ580002	CHIP 2SC3875S(ALY)KEC	0TR387500AA
Q701	AZ580005	CHIP 2SA1504S(ASY)KEC	0TR150400BA
Q703	AZ580005	CHIP 2SA1504S(ASY)KEC	0TR150400BA
Q704	AZ580005	CHIP 2SA1504S(ASY)KEC	0TR150400BA
Q801	AZ580002	CHIP 2SC3875S(ALY)KEC	0TR387500AA
Q801	AZ580007	STW20NK80Z TO-247 500V 17A	0TFSG10004A
Q802	AZ580002	CHIP 2SC3875S(ALY)KEC	0TR387500AA
Q830	AZ580008	STW8NK80Z TO-247 800V 6.2A	0TFSG10003A
Q832	AZ580009	KTC4370A-Y TO-220IS KEC	0TR437000BA
Q840	AZ580010	KTC3227-Y, TP(KTC1627A), KEC	0TR322709AA
Q852	AZ580011	KSC945C-Y TO92 50V 150MA	0TR945009AA
Q871	AZ580012	KTA1024-Y(KTA949)TP KEC	0TR102409AB
Q872	AZ580010	KTC3227-Y, TP(KTC1627A), KEC	0TR322709AA
DIODE			
D1	AZ480001	LED,LTL-30EWJ	0DLLT0260AA
D1	AZ480002	KDS184S CHIP 85V 300MA	0DD184009AA
D100	AZ480003	SDC15 SOT23 12.8V	0DRSE00038A
D100	AZ480004	B140A 40V 1A 30A.SEC 0.5MA	0DRDI00148
D102	AZ480005	SD05.TC SOD323 5V 5A 15A	0DR050008AA
D103	AZ480005	SD05.TC SOD323 5V 5A 15A	0DR050008AA
D104	AZ480005	SD05.TC SOD323 5V 5A 15A	0DR050008AA
D105	AZ480003	SDC15 SOT23 12.8V	0DRSE00038A
D106	AZ480005	SD05.TC SOD323 5V 5A 15A	0DR050008AA
D2	AZ480001	LED,LTL-30EWJ	0DLLT0260AA
D201	AZ480006	1N4148 TP GRANDE	0DD414809ED
D3	AZ480001	LED,LTL-30EWJ	0DLLT0260AA
D3	AZ480007	CHIP KDS226 SOT-23	0DD226239AA
D300	AZ480002	KDS184S CHIP 85V 300MA	0DD184009AA
D4	AZ480002	KDS184S CHIP 85V 300MA	0DD184009AA
D5	AZ480002	KDS184S CHIP 85V 300MA	0DD184009AA
D6	AZ480002	KDS184S CHIP 85V 300MA	0DD184009AA
D700	AZ480008	1SS133 T-72 TP DO34 90V	0DS113379BA
D704	AZ480008	1SS133 T-72 TP DO34 90V	0DS113379BA
D706	AZ480008	1SS133 T-72 TP DO34 90V	0DS113379BA

ELECTRICAL REPLACEMENT PARTS LIST

LOCA. NO.	PART NO.	DESCRIPTION	REFERENCE NO.
D707	AZ480008	1SS133 T-72 TP DO34 90V	0DS113379BA
D708	AZ480008	1SS133 T-72 TP DO34 90V	0DS113379BA
D709	AZ480008	1SS133 T-72 TP DO34 90V	0DS113379BA
D710	AZ480002	KDS184S CHIP 85V 300MA	0DD184009AA
D711	AZ480002	KDS184S CHIP 85V 300MA	0DD184009AA
D712	AZ480002	KDS184S CHIP 85V 300MA	0DD184009AA
△ D801	AZ480009	RBV606 600V 6A 150A NA 10UA	0DD606000AA
D831	AZ480010	EU1AV(1)	0DD100009AU
D832	AZ480010	EU1AV(1)	0DD100009AU
D834	AZ480011	EG01C 1000V 0.5A 10A	0DR010009AA
D835	AZ480006	1N4148 TP GRANDE	0DD414809ED
D840	AZ480006	1N4148 TP GRANDE	0DD414809ED
D851	AZ480012	FML-G12S	0DD120000BB
D861	AZ480012	FML-G12S	0DD120000BB
D871	AZ480013	FML-G22S TO220 200V	0DD220000AC
D881	AZ480012	FML-G12S	0DD120000BB
D891	AZ480014	FML-G14S TO220 400V	0DRSA00170A
D901	AZ480015	BAT54SWT1 60V 3A 4A.SEC.A	0DRON00088A
D902	AZ480015	BAT54SWT1 60V 3A 4A.SEC.A	0DRON00088A
D903	AZ480015	BAT54SWT1 60V 3A 4A.SEC.A	0DRON00088A
D904	AZ480015	BAT54SWT1 60V 3A 4A.SEC.A	0DRON00088A
D905	AZ480015	BAT54SWT1 60V 3A 4A.SEC.A	0DRON00088A
D906	AZ480016	BAV99RWT1 SC-75 70V 215MA	0DSON00028A
D907	AZ480017	MBRD320RL SC-75 30V 150MA	0DRON00098A
D908	AZ480018	ZENERS, SMZJ3793B	0DZGS00108A
D909	AZ480019	SS26 DC-214AC 60V 2A	0ZRGSO0328A
D901	AZ480020	FMG-36S 2.2V 100NSEC 1.0MA	0DR360000AA
XD204	AZ480022	ZENERS, MTZJ5.6B	0DZ560009CF
ZD01	AZ480005	SD05.TC SOD323 5V 5A 15A	0DR050008AA
ZD1	AZ480021	ZENERS, MTZJ6.2B	0DZ620009BB
ZD10	AZ480021	ZENERS, MTZJ6.2B	0DZ620009BB
ZD2	AZ480021	ZENERS, MTZJ6.2B	0DZ620009BB
ZD201	AZ480022	ZENERS, MTZJ5.6B	0DZ560009CF
ZD202	AZ480022	ZENERS, MTZJ5.6B	0DZ560009CF
ZD203	AZ480022	ZENERS, MTZJ5.6B	0DZ560009CF
ZD204	AZ480022	ZENERS, MTZJ5.6B	0DZ560009CF
ZD3	AZ480021	ZENERS, MTZJ6.2B	0DZ620009BB
ZD4	AZ480021	ZENERS, MTZJ6.2B	0DZ620009BB
ZD5	AZ480021	ZENERS, MTZJ6.2B	0DZ620009BB
ZD6	AZ480021	ZENERS, MTZJ6.2B	0DZ620009BB
ZD600	AZ480022	ZENERS, MTZJ5.6B	0DZ560009CF
ZD601	AZ480022	ZENERS, MTZJ5.6B	0DZ560009CF
ZD839	AZ480023	ZENERS, MTZJ30B	0ZD300009BB
ZD9	AZ480021	ZENERS, MTZJ6.2B	0DZ620009BB
CAPACITOR			
C1	AZ180002	47UF STD 16V M	0CE476DF618
C1	AZ180001	22UF STD 16V M	0CE226DF618
C100	AZ180003	4.7UF STD 50V 20%	0CE475DK618
C100	AZ180004	10UF MVG 16V 20%	0CE106SF6DC
C101	AZ180005	10UF STD 16V M	0CE106DF618
C101	AZ180006	22UF MVG 16V 20%	0CE226SF6DC
C103	AZ180007	1UF 2012 16V 20%	0CK105DF64A
C109	AZ180006	22UF MVG 16V 20%	0CE226SF6DC
C110	AZ180005	10UF STD 16V M	0CE106DF618
C111	AZ180002	47UF STD 16V M	0CE476DF618
C112	AZ180008	100UF STD 16V M	0CE107DF618

LOCA. NO.	PART NO.	DESCRIPTION	REFERENCE NO.
C113	AZ180007	1UF 2012 16V 20%	0CK105DF64A
C115	AZ180005	10UF STD 16V M	0CE106DF618
C116	AZ180009	47UF KME 50V M	0CE476BK618
C117	AZ180002	47UF STD 16V M	0CE476DF618
C118	AZ180008	100UF STD 16V M	0CE107DF618
C120	AZ180008	100UF STD 16V M	0CE107DF618
C1200	AZ180010	10UF MV 16V 20%	0CE106VF6DC
C1201	AZ180010	10UF MV 16V 20%	0CE106VF6DC
C1203	AZ180010	10UF MV 16V 20%	0CE106VF6DC
C1204	AZ180010	10UF MV 16V 20%	0CE106VF6DC
C1206	AZ180010	10UF MV 16V 20%	0CE106VF6DC
C1207	AZ180010	10UF MV 16V 20%	0CE106VF6DC
C1208	AZ180010	10UF MV 16V 20%	0CE106VF6DC
C1209	AZ180010	10UF MV 16V 20%	0CE106VF6DC
C121	AZ180007	1UF 2012 16V 20%	0CK105DF64A
C1213	AZ180010	10UF MV 16V 20%	0CE106VF6DC
C1214	AZ180011	220UF MV 16V 20%	0CE227VF6DC
C1217	AZ180012	100UF MVG 16V M	0CE107SF6DC
C123	AZ180013	100UF STD 50V M	0CE107DK618
C1244	AZ180007	1UF 2012 16V 20%	0CK105DF64A
C1246	AZ180014	47UF MVG 16V M	0CE476SF6DC
C1249	AZ180014	47UF MVG 16V M	0CE476SF6DC
C1257	AZ180014	47UF MVG 16V M	0CE476SF6DC
C1259	AZ180014	47UF MVG 16V M	0CE476SF6DC
C126	AZ180009	47UF KME 50V M	0CE476BK618
C129	AZ180004	10UF MVG 16V 20%	0CE106SF6DC
C130	AZ180004	10UF MVG 16V 20%	0CE106SF6DC
C132	AZ180003	4.7UF STD 50V 20%	0CE475DK618
C134	AZ180002	47UF STD 16V M	0CE476DF618
C136	AZ180009	47UF KME 50V M	0CE476BK618
C139	AZ180004	10UF MVG 16V 20%	0CE106SF6DC
C145	AZ180004	10UF MVG 16V 20%	0CE106SF6DC
C147	AZ180008	100UF STD 16V M	0CE107DF618
C149	AZ180015	100UF STD 25V M	0CE107DH618
C15	AZ180007	1UF 2012 16V 20%	0CK105DF64A
C150	AZ180004	10UF MVG 16V 20%	0CE106SF6DC
C151	AZ180003	4.7UF STD 50V 20%	0CE475DK618
C162	AZ180004	10UF MVG 16V 20%	0CE106SF6DC
C2	AZ180016	10000PF D 16V 20%	0CN1030F679
C20	AZ180015	100UF STD 25V M	0CE107DH618
C200	AZ180007	1UF 2012 16V 20%	0CK105DF64A
C200	AZ180014	47UF MVG 16V M	0CE476SF6DC
C201	AZ180007	1UF 2012 16V 20%	0CK105DF64A
C202	AZ180004	10UF MVG 16V 20%	0CE106SF6DC
C203	AZ180007	1UF 2012 16V 20%	0CK105DF64A
C203	AZ180014	47UF MVG 16V M	0CE476SF6DC
C204	AZ180007	1UF 2012 16V 20%	0CK105DF64A
C205	AZ180004	10UF MVG 16V 20%	0CE106SF6DC
C205	AZ180007	1UF 2012 16V 20%	0CK105DF64A
C206	AZ180004	10UF MVG 16V 20%	0CE106SF6DC
C207	AZ180004	10UF MVG 16V 20%	0CE106SF6DC
C207	AZ180007	1UF 2012 16V 20%	0CK105DF64A
C208	AZ180007	1UF 2012 16V 20%	0CK105DF64A
C209	AZ180004	10UF MVG 16V 20%	0CE106SF6DC
C209	AZ180007	1UF 2012 16V 20%	0CK105DF64A
C210	AZ180004	10UF MVG 16V 20%	0CE106SF6DC
C210	AZ180007	1UF 2012 16V 20%	0CK105DF64A
C211	AZ180007	1UF 2012 16V 20%	0CK105DF64A

ELECTRICAL REPLACEMENT PARTS LIST

LOCA. NO.	PART NO.	DESCRIPTION	REFERENCE NO.	LOCA. NO.	PART NO.	DESCRIPTION	REFERENCE NO.
C211	AZ180017	220000PF 2012 16V 10%	0CK224DF56A	C611	AZ180020	0.1UF 1608 16V 10%	0CK104CF56A
C212	AZ180007	1UF 2012 16V 20%	0CK105DF64A	C612	AZ180020	0.1UF 1608 16V 10%	0CK104CF56A
C212	AZ180017	220000PF 2012 16V 10%	0CK224DF56A	C614	AZ180020	0.1UF 1608 16V 10%	0CK104CF56A
C213	AZ180007	1UF 2012 16V 20%	0CK105DF64A	C615	AZ180020	0.1UF 1608 16V 10%	0CK104CF56A
C213	AZ180017	220000PF 2012 16V 10%	0CK224DF56A	C616	AZ180008	100UF STD 16V M	0CE107DF618
C214	AZ180007	1UF 2012 16V 20%	0CK105DF64A	C616	AZ180020	0.1UF 1608 16V 10%	0CK104CF56A
C214	AZ180017	220000PF 2012 16V 10%	0CK224DF56A	C617	AZ180020	0.1UF 1608 16V 10%	0CK104CF56A
C215	AZ180007	1UF 2012 16V 20%	0CK105DF64A	C618	AZ180020	0.1UF 1608 16V 10%	0CK104CF56A
C215	AZ180017	220000PF 2012 16V 10%	0CK224DF56A	C619	AZ180020	0.1UF 1608 16V 10%	0CK104CF56A
C216	AZ180017	220000PF 2012 16V 10%	0CK224DF56A	C620	AZ180020	0.1UF 1608 16V 10%	0CK104CF56A
C217	AZ180017	220000PF 2012 16V 10%	0CK224DF56A	C621	AZ180007	1UF 2012 16V 20%	0CK105DF64A
C219	AZ180004	100UF MVG 16V 20%	0CE106SF6DC	C621	AZ180020	0.1UF 1608 16V 10%	0CK104CF56A
C223	AZ180003	4.7UF STD 50V 20%	0CE475DK618	C622	AZ180007	1UF 2012 16V 20%	0CK105DF64A
C224	AZ180007	1UF 2012 16V 20%	0CK105DF64A	C622	AZ180020	0.1UF 1608 16V 10%	0CK104CF56A
C225	AZ180003	4.7UF STD 50V 20%	0CE475DK618	C623	AZ180020	0.1UF 1608 16V 10%	0CK104CF56A
C226	AZ180018	220UF STD 16V M	0CE227DF618	C624	AZ180020	0.1UF 1608 16V 10%	0CK104CF56A
C227	AZ180007	1UF 2012 16V 20%	0CK105DF64A	C625	AZ180020	0.1UF 1608 16V 10%	0CK104CF56A
C229	AZ180001	22UF STD 16V M	0CE226DF618	C626	AZ180020	0.1UF 1608 16V 10%	0CK104CF56A
C23	AZ180008	100UF STD 16V M	0CE107DF618	C627	AZ180020	0.1UF 1608 16V 10%	0CK104CF56A
C231	AZ180008	100UF STD 16V M	0CE107DF618	C628	AZ180005	10UF STD 16V M	0CE106DF618
C237	AZ180017	220000PF 2012 16V 10%	0CK224DF56A	C628	AZ180020	0.1UF 1608 16V 10%	0CK104CF56A
C238	AZ180014	47UF MVG 16V M	0CE476SF6DC	C629	AZ180020	0.1UF 1608 16V 10%	0CK104CF56A
C24	AZ180002	47UF STD 16V M	0CE476DF618	C630	AZ180005	10UF STD 16V M	0CE106DF618
C249	AZ180004	10UF MVG 16V 20%	0CE106SF6DC	C630	AZ180020	0.1UF 1608 16V 10%	0CK104CF56A
C260	AZ180004	10UF MVG 16V 20%	0CE106SF6DC	C631	AZ180005	10UF STD 16V M	0CE106DF618
C261	AZ180004	10UF MVG 16V 20%	0CE106SF6DC	C631	AZ180020	0.1UF 1608 16V 10%	0CK104CF56A
C262	AZ180004	10UF MVG 16V 20%	0CE106SF6DC	C632	AZ180020	0.1UF 1608 16V 10%	0CK104CF56A
C27	AZ180002	47UF STD 16V M	0CE476DF618	C633	AZ180020	0.1UF 1608 16V 10%	0CK104CF56A
C335	AZ180004	10UF MVG 16V 20%	0CE106SF6DC	C634	AZ180020	0.1UF 1608 16V 10%	0CK104CF56A
C338	AZ180004	10UF MVG 16V 20%	0CE106SF6DC	C635	AZ180020	0.1UF 1608 16V 10%	0CK104CF56A
C339	AZ180004	10UF MVG 16V 20%	0CE106SF6DC	C636	AZ180020	0.1UF 1608 16V 10%	0CK104CF56A
C344	AZ180006	22UF MVG 16V 20%	0CE226SF6DC	C637	AZ180020	0.1UF 1608 16V 10%	0CK104CF56A
C345	AZ180006	22UF MVG 16V 20%	0CE226SF6DC	C638	AZ180020	0.1UF 1608 16V 10%	0CK104CF56A
C358	AZ180006	22UF MVG 16V 20%	0CE226SF6DC	C639	AZ180020	0.1UF 1608 16V 10%	0CK104CF56A
C359	AZ180006	22UF MVG 16V 20%	0CE226SF6DC	C640	AZ180020	0.1UF 1608 16V 10%	0CK104CF56A
C363	AZ180019	82000PF 2012 50V 10%	0CK823DK56A	C641	AZ180020	0.1UF 1608 16V 10%	0CK104CF56A
C381	AZ180006	22UF MVG 16V 20%	0CE226SF6DC	C642	AZ180020	0.1UF 1608 16V 10%	0CK104CF56A
C394	AZ180006	22UF MVG 16V 20%	0CE226SF6DC	C643	AZ180002	47UF STD 16V M	0CE476DF618
C395	AZ180006	22UF MVG 16V 20%	0CE226SF6DC	C643	AZ180020	0.1UF 1608 16V 10%	0CK104CF56A
C405	AZ180006	22UF MVG 16V 20%	0CE226SF6DC	C644	AZ180020	0.1UF 1608 16V 10%	0CK104CF56A
C5	AZ180007	1UF 2012 16V 20%	0CK105DF64A	C645	AZ180020	0.1UF 1608 16V 10%	0CK104CF56A
C508	AZ180006	22UF MVG 16V 20%	0CE226SF6DC	C646	AZ180020	0.1UF 1608 16V 10%	0CK104CF56A
C510	AZ180006	22UF MVG 16V 20%	0CE226SF6DC	C647	AZ180020	0.1UF 1608 16V 10%	0CK104CF56A
C550	AZ180004	10UF MVG 16V 20%	0CE106SF6DC	C648	AZ180020	0.1UF 1608 16V 10%	0CK104CF56A
C565	AZ180004	10UF MVG 16V 20%	0CE106SF6DC	C648	AZ180021	3.3UF STD 50V 20%	0CE335DK618
C570	AZ180020	0.1UF 1608 16V 10%	0CK104CF56A	C649	AZ180020	0.1UF 1608 16V 10%	0CK104CF56A
C571	AZ180004	10UF MVG 16V 20%	0CE106SF6DC	C650	AZ180022	27PF 1608 50V 5%	0CC270CK41A
C572	AZ180020	0.1UF 1608 16V 10%	0CK104CF56A	C651	AZ180022	27PF 1608 50V 5%	0CC270CK41A
C574	AZ180020	0.1UF 1608 16V 10%	0CK104CF56A	C652	AZ180022	27PF 1608 50V 5%	0CC270CK41A
C575	AZ180020	0.1UF 1608 16V 10%	0CK104CF56A	C653	AZ180022	27PF 1608 50V 5%	0CC270CK41A
C576	AZ180020	0.1UF 1608 16V 10%	0CK104CF56A	C654	AZ180020	0.1UF 1608 16V 10%	0CK104CF56A
C580	AZ180020	0.1UF 1608 16V 10%	0CK104CF56A	C655	AZ180020	0.1UF 1608 16V 10%	0CK104CF56A
C582	AZ180020	0.1UF 1608 16V 10%	0CK104CF56A	C664	AZ180021	3.3UF STD 50V 20%	0CE335DK618
C583	AZ180020	0.1UF 1608 16V 10%	0CK104CF56A	C668	AZ180007	1UF 2012 16V 20%	0CK105DF64A
C584	AZ180020	0.1UF 1608 16V 10%	0CK104CF56A	C669	AZ180007	1UF 2012 16V 20%	0CK105DF64A
C606	AZ180008	100UF STD 16V M	0CE107DF618	C670	AZ180003	4.7UF STD 50V 20%	0CE475DK618
C609	AZ180020	0.1UF 1608 16V 10%	0CK104CF56A	C671	AZ180003	4.7UF STD 50V 20%	0CE475DK618
C610	AZ180020	0.1UF 1608 16V 10%	0CK104CF56A	C673	AZ180021	3.3UF STD 50V 20%	0CE335DK618

ELECTRICAL REPLACEMENT PARTS LIST

LOCA. NO.	PART NO.	DESCRIPTION	REFERENCE NO.	LOCA. NO.	PART NO.	DESCRIPTION	REFERENCE NO.
C7	AZ180023	220UF STD 10V M	0CE227DD618	C734	AZ180020	0.1UF 1608 16V 10%	0CK104CF56A
C700	AZ180020	0.1UF 1608 16V 10%	0CK104CF56A	C735	AZ180020	0.1UF 1608 16V 10%	0CK104CF56A
C701	AZ180020	0.1UF 1608 16V 10%	0CK104CF56A	C735	AZ180030	0.0068UF D 100V 10%	0CQ6821N509
C702	AZ180020	0.1UF 1608 16V 10%	0CK104CF56A	C736	AZ180005	10UF STD 16V M	0CE106DF618
C703	AZ180024	100UF STD 10V M	0CE107DD618	C736	AZ180020	0.1UF 1608 16V 10%	0CK104CF56A
C704	AZ180020	0.1UF 1608 16V 10%	0CK104CF56A	C737	AZ180020	0.1UF 1608 16V 10%	0CK104CF56A
C705	AZ180023	220UF STD 10V M	0CE227DD618	C737	AZ180030	0.0068UF D 100V 10%	0CQ6821N509
C706	AZ180020	0.1UF 1608 16V 10%	0CK104CF56A	C738	AZ180020	0.1UF 1608 16V 10%	0CK104CF56A
C707	AZ180018	220UF STD 10V M	0CE227DD618	C739	AZ180020	0.1UF 1608 16V 10%	0CK104CF56A
C707	AZ180020	0.1UF 1608 16V 10%	0CK104CF56A	C739	AZ180031	1000UF STD 35V M	0CE108DJ618
C709	AZ180023	220UF STD 10V M	0CE227DD618	C740	AZ180020	0.1UF 1608 16V 10%	0CK104CF56A
C710	AZ180020	0.1UF 1608 16V 10%	0CK104CF56A	C741	AZ180020	0.1UF 1608 16V 10%	0CK104CF56A
C711	AZ180020	0.1UF 1608 16V 10%	0CK104CF56A	C741	AZ180031	1000UF STD 35V M	0CE108DJ618
C711	AZ180023	220UF STD 10V M	0CE227DD618	C742	AZ180005	10UF STD 16V M	0CE106DF618
C712	AZ180020	0.1UF 1608 16V 10%	0CK104CF56A	C742	AZ180020	0.1UF 1608 16V 10%	0CK104CF56A
C713	AZ180020	0.1UF 1608 16V 10%	0CK104CF56A	C743	AZ180020	0.1UF 1608 16V 10%	0CK104CF56A
C713	AZ180023	220UF STD 10V M	0CE227DD618	C743	AZ180032	1000UF STD 16V M	0CE108DF618
C714	AZ180014	47UF MVG 16V M	0CE476SF6DC	C744	AZ180020	0.1UF 1608 16V 10%	0CK104CF56A
C714	AZ180020	0.1UF 1608 16V 10%	0CK104CF56A	C745	AZ180020	0.1UF 1608 16V 10%	0CK104CF56A
C715	AZ180014	47UF MVG 16V M	0CE476SF6DC	C745	AZ180025	220UF STD 25V M	0CE227DH618
C715	AZ180023	220UF STD 10V M	0CE227DD618	C746	AZ180020	0.1UF 1608 16V 10%	0CK104CF56A
C717	AZ180020	0.1UF 1608 16V 10%	0CK104CF56A	C747	AZ180015	100UF STD 25V M	0CE107DH618
C718	AZ180014	47UF MVG 16V M	0CE476SF6DC	C747	AZ180020	0.1UF 1608 16V 10%	0CK104CF56A
C718	AZ180020	0.1UF 1608 16V 10%	0CK104CF56A	C748	AZ180020	0.1UF 1608 16V 10%	0CK104CF56A
C719	AZ180014	47UF MVG 16V M	0CE476SF6DC	C749	AZ180020	0.1UF 1608 16V 10%	0CK104CF56A
C719	AZ180020	0.1UF 1608 16V 10%	0CK104CF56A	C749	AZ180023	220UF STD 10V M	0CE227DD618
C720	AZ180020	0.1UF 1608 16V 10%	0CK104CF56A	C750	AZ180020	0.1UF 1608 16V 10%	0CK104CF56A
C720	AZ180025	220UF STD 25V M	0CE227DH618	C751	AZ180020	0.1UF 1608 16V 10%	0CK104CF56A
C721	AZ180020	0.1UF 1608 16V 10%	0CK104CF56A	C751	AZ180024	100UF STD 10V M	0CE107DD618
C722	AZ180008	100UF STD 16V M	0CE107DF618	C752	AZ180020	0.1UF 1608 16V 10%	0CK104CF56A
C722	AZ180020	0.1UF 1608 16V 10%	0CK104CF56A	C753	AZ180018	220UF STD 10V M	0CE227DD618
C723	AZ180020	0.1UF 1608 16V 10%	0CK104CF56A	C753	AZ180020	0.1UF 1608 16V 10%	0CK104CF56A
C724	AZ180020	0.1UF 1608 16V 10%	0CK104CF56A	C754	AZ180020	0.1UF 1608 16V 10%	0CK104CF56A
C724	AZ180026	0.1UF D 100V 10%	0CQ1041N509	C755	AZ180020	0.1UF 1608 16V 10%	0CK104CF56A
C725	AZ180020	0.1UF 1608 16V 10%	0CK104CF56A	C755	AZ180024	100UF STD 10V M	0CE107DD618
C725	AZ180027	1000UF STD 50V M	0CE108DK61A	C756	AZ180020	0.1UF 1608 16V 10%	0CK104CF56A
C726	AZ180014	47UF MVG 16V M	0CE476SF6DC	C757	AZ180020	0.1UF 1608 16V 10%	0CK104CF56A
C726	AZ180020	0.1UF 1608 16V 10%	0CK104CF56A	C758	AZ180020	0.1UF 1608 16V 10%	0CK104CF56A
C727	AZ180005	10UF STD 16V M	0CE106DF618	C758	AZ180024	100UF STD 10V M	0CE107DD618
C727	AZ180014	47UF MVG 16V M	0CE476SF6DC	C759	AZ180020	0.1UF 1608 16V 10%	0CK104CF56A
C727	AZ180020	0.1UF 1608 16V 10%	0CK104CF56A	C760	AZ180020	0.1UF 1608 16V 10%	0CK104CF56A
C728	AZ180020	0.1UF 1608 16V 10%	0CK104CF56A	C761	AZ180020	0.1UF 1608 16V 10%	0CK104CF56A
C728	AZ180026	0.1UF D 100V 10%	0CQ1041N509	C762	AZ180020	0.1UF 1608 16V 10%	0CK104CF56A
C729	AZ180015	100UF STD 25V M	0CE107DH618	C763	AZ180020	0.1UF 1608 16V 10%	0CK104CF56A
C729	AZ180020	0.1UF 1608 16V 10%	0CK104CF56A	C764	AZ180020	0.1UF 1608 16V 10%	0CK104CF56A
C730	AZ180014	47UF MVG 16V M	0CE476SF6DC	C765	AZ180020	0.1UF 1608 16V 10%	0CK104CF56A
C730	AZ180020	0.1UF 1608 16V 10%	0CK104CF56A	C766	AZ180020	0.1UF 1608 16V 10%	0CK104CF56A
C730	AZ180028	100UF STD 50V M	0CE106DK618	C767	AZ180020	0.1UF 1608 16V 10%	0CK104CF56A
C731	AZ180015	100UF STD 25V M	0CE107DH618	C768	AZ180020	0.1UF 1608 16V 10%	0CK104CF56A
C731	AZ180020	0.1UF 1608 16V 10%	0CK104CF56A	C769	AZ180020	0.1UF 1608 16V 10%	0CK104CF56A
C732	AZ180020	0.1UF 1608 16V 10%	0CK104CF56A	C770	AZ180020	0.1UF 1608 16V 10%	0CK104CF56A
C732	AZ180028	10UF STD 50V M	0CE106DK618	C771	AZ180020	0.1UF 1608 16V 10%	0CK104CF56A
C732	AZ180029	1UF MV 50V 20%	0CE105VK6DC	C772	AZ180020	0.1UF 1608 16V 10%	0CK104CF56A
C733	AZ180004	10UF MVG 16V 20%	0CE106SF6DC	C773	AZ180020	0.1UF 1608 16V 10%	0CK104CF56A
C733	AZ180015	100UF STD 25V M	0CE107DH618	C774	AZ180020	0.1UF 1608 16V 10%	0CK104CF56A
C733	AZ180020	0.1UF 1608 16V 10%	0CK104CF56A	C775	AZ180020	0.1UF 1608 16V 10%	0CK104CF56A
C734	AZ180005	10UF STD 16V M	0CE106DF618	C776	AZ180020	0.1UF 1608 16V 10%	0CK104CF56A
C734	AZ180014	47UF MVG 16V M	0CE476SF6DC	C777	AZ180020	0.1UF 1608 16V 10%	0CK104CF56A

ELECTRICAL REPLACEMENT PARTS LIST

	LOCA. NO.	PART NO.	DESCRIPTION	REFERENCE NO.		LOCA. NO.	PART NO.	DESCRIPTION	REFERENCE NO.	
		C778	AZ180020	0.1UF 1608 16V 10%			C833	AZ180048	10P 50V D NP0 TS	OCC1000K115
		C779	AZ180020	0.1UF 1608 16V 10%			C834	AZ180020	0.1UF 1608 16V 10%	OCC104CF56A
		C780	AZ180020	0.1UF 1608 16V 10%			C834	AZ180049	0.1UF 50V Z F TR	OCC1040K945
		C781	AZ180022	27PF 1608 50V 5%			C835	AZ180006	22UF MVG 16V 20%	OCE226SF6DC
		C782	AZ180022	27PF 1608 50V 5%			C835	AZ180020	0.1UF 1608 16V 10%	OCC104CF56A
		C783	AZ180020	0.1UF 1608 16V 10%			C836	AZ180020	0.1UF 1608 16V 10%	OCC104CF56A
		C800	AZ180020	0.1UF 1608 16V 10%			C836	AZ180050	0.001UF D 1.6KV J	181-011B
⚠		C801	AZ180033	AC275V 0.22UF K (S=22.5)			C837	AZ180020	0.1UF 1608 16V 10%	OCC104CF56A
		C801	AZ180020	0.1UF 1608 16V 10%			C837	AZ180051	SL 100PF 1KV 10%,-10%	181-091N
		C801	AZ180034	DEHR33D821KN3A 820PF 2KV 10%,-10%			C838	AZ180020	0.1UF 1608 16V 10%	OCC104CF56A
							C839	AZ180020	0.1UF 1608 16V 10%	OCC104CF56A
		C802	AZ180020	0.1UF 1608 16V 10%			C840	AZ180020	0.1UF 1608 16V 10%	OCC104CF56A
⚠		C803	AZ180033	AC275V 0.22UF K (S=22.5)			C840	AZ180049	0.1UF 50V Z F TR	OCC1040K945
		C803	AZ180020	0.1UF 1608 16V 10%			C841	AZ180020	0.1UF 1608 16V 10%	OCC104CF56A
⚠		C805	AZ180035	1UF 0 500V 5%			C841	AZ180049	0.1UF 50V Z F TR	OCC1040K945
		C805	AZ180020	0.1UF 1608 16V 10%			C842	AZ180020	0.1UF 1608 16V 10%	OCC104CF56A
		C806	AZ180020	0.1UF 1608 16V 10%			C842	AZ180049	0.1UF 50V Z F TR	OCC1040K945
		C807	AZ180020	0.1UF 1608 16V 10%			C843	AZ180009	47UF KME 50V M	OCE476BK618
		C807	AZ180036	1000P 2KV K B S			C843	AZ180020	0.1UF 1608 16V 10%	OCC104CF56A
		C808	AZ180036	1000P 2KV K B S			C844	AZ180009	47UF KME 50V M	OCE476BK618
		C808	AZ180037	68PF 1608 50V 5%			C844	AZ180020	0.1UF 1608 16V 10%	OCC104CF56A
		C809	AZ180037	68PF 1608 50V 5%			C845	AZ180020	0.1UF 1608 16V 10%	OCC104CF56A
		C810	AZ180020	0.1UF 1608 16V 10%			C846	AZ180020	0.1UF 1608 16V 10%	OCC104CF56A
		C810	AZ180038	0.01UF 50V Z F TR			C847	AZ180020	0.1UF 1608 16V 10%	OCC104CF56A
		C811	AZ180020	0.1UF 1608 16V 10%			C851	AZ180052	1000UF STD 25V M	OCE108DH618
		C811	AZ180039	0.047UF D 50V 80%,-20%			C852	AZ180025	220UF STD 25V M	OCE227DH618
		C812	AZ180020	0.1UF 1608 16V 10%			C853	AZ180053	R 470PF 1KV 10%,-10%	181-091Q
		C812	AZ180040	MPE ECQ-V1H474JL3 (TR), 50V 0.47UF J			C857	AZ180054	1UF STD 50V M	OCE105DK618
		C813	AZ180037	68PF 1608 50V 5%			C861	AZ180032	1000UF STD 16V M	OCE108DF618
		C813	AZ180041	100P 50V KB TS			C862	AZ180055	470UF STD 16V 20%	OCE477DF618
		C814	AZ180037	68PF 1608 50V 5%			C863	AZ180053	R 470PF 1KV 10%,-10%	181-091Q
		C814	AZ180042	470PF 50V K B TS			C866	AZ180051	SL 100PF 1KV 10%,-10%	181-091N
		C815	AZ180020	0.1UF 1608 16V 10%			C867	AZ180051	SL 100PF 1KV 10%,-10%	181-091N
		C815	AZ180041	100P 50V KB TS			C868	AZ180051	SL 100PF 1KV 10%,-10%	181-091N
		C816	AZ180043	10PF 1608 50V 0.5 PF			C869	AZ180051	SL 100PF 1KV 10%,-10%	181-091N
		C816	AZ180044	1000P 50V K B TS			C870	AZ180049	0.1UF 50V Z F TR	OCC1040K945
		C817	AZ180020	0.1UF 1608 16V 10%			C871	AZ180056	3300UF KMG,RD 16V 20%	OCE338EF618
		C818	AZ180020	0.1UF 1608 16V 10%			C872	AZ180055	470UF STD 16V 20%	OCE477DF618
		C818	AZ180020	0.1UF 1608 16V 10%			C873	AZ180053	R 470PF 1KV 10%,-10%	181-091Q
		C819	AZ180037	68PF 1608 50V 5%			C874	AZ180003	4.7UF STD 50V 20%	OCE475DK618
		C820	AZ180020	0.1UF 1608 16V 10%			C881	AZ180057	2200U SMS 16V M	OCE2286F618
		C820	AZ180045	CE 450V 220UF M LUG (105)			C882	AZ180055	470UF STD 16V 20%	OCE477DF618
		C821	AZ180020	0.1UF 1608 16V 10%			C883	AZ180053	R 470PF 1KV 10%,-10%	181-091Q
		C822	AZ180014	47UF MVG 16V M			C891	AZ180058	1000UF KME 50V M	OCE108BK61A
		C822	AZ180020	0.1UF 1608 16V 10%			C892	AZ180059	220M SMS 50V M	OCE2276K618
		C823	AZ180020	0.1UF 1608 16V 10%			C893	AZ180053	R 470PF 1KV 10%,-10%	181-091Q
		C824	AZ180004	10UF MVG 16V 20%			C898	AZ180060	3300PF 4KV M E	181-120L
		C824	AZ180020	0.1UF 1608 16V 10%			C899	AZ180061	DE1B3KX471KA5B 470PF 250V 10%	181-035U
		C825	AZ180014	47UF MVG 16V M			C901	AZ180020	0.1UF 1608 16V 10%	OCC104CF56A
		C825	AZ180020	0.1UF 1608 16V 10%			C902	AZ180020	0.1UF 1608 16V 10%	OCC104CF56A
		C826	AZ180020	0.1UF 1608 16V 10%			C904	AZ180020	0.1UF 1608 16V 10%	OCC104CF56A
		C827	AZ180014	47UF MVG 16V M			C905	AZ180020	0.1UF 1608 16V 10%	OCC104CF56A
		C828	AZ180046	470PF 1608 50V 5%			C906	AZ180020	0.1UF 1608 16V 10%	OCC104CF56A
		C829	AZ180014	47UF MVG 16V M			C908	AZ180020	0.1UF 1608 16V 10%	OCC104CF56A
		C831	AZ180009	47UF KME 50V M			C909	AZ180020	0.1UF 1608 16V 10%	OCC104CF56A
		C832	AZ180020	0.1UF 1608 16V 10%			C910	AZ180020	0.1UF 1608 16V 10%	OCC104CF56A
		C832	AZ180047	100UF STD 35V M			C911	AZ180020	0.1UF 1608 16V 10%	OCC104CF56A
		C833	AZ180020	0.1UF 1608 16V 10%			C912	AZ180062	22UF 7343 35V 20% (SMD)	OCS226GJ6DC

ELECTRICAL REPLACEMENT PARTS LIST

LOCA. NO.	PART NO.	DESCRIPTION	REFERENCE NO.
C913	AZ180020	0.1UF 1608 16V 10%	0CK104CF56A
C915	AZ180014	47UF MVG 16V M	0CE476SF6DC
C919	AZ180020	0.1UF 1608 16V 10%	0CK104CF56A
C920	AZ180020	0.1UF 1608 16V 10%	0CK104CF56A
C921	AZ180020	0.1UF 1608 16V 10%	0CK104CF56A
C922	AZ180020	0.1UF 1608 16V 10%	0CK104CF56A
C923	AZ180014	47UF MVG 16V M	0CE476SF6DC
C924	AZ180020	0.1UF 1608 16V 10%	0CK104CF56A
C926	AZ180020	0.1UF 1608 16V 10%	0CK104CF56A
C927	AZ180020	0.1UF 1608 16V 10%	0CK104CF56A
C929	AZ180020	0.1UF 1608 16V 10%	0CK104CF56A
C930	AZ180046	470PF 1608 50V 5%	0CC471CK41A
C931	AZ180063	270PF 1608 50V 5%	0CK271CK46A
C932	AZ180064	2700PF 1608 50V 5%	0CK272CK46A
C933	AZ180020	0.1UF 1608 16V 10%	0CK104CF56A
C934	AZ180020	0.1UF 1608 16V 10%	0CK104CF56A
C936	AZ180065	100PF 1608 50V 5%	0CC101CK41A
C937	AZ180066	120PF 1608 50V 5%	0CK121CK46A
C938	AZ180067	0.01UF 1608 50V 10%	0CK103CK56A
C939	AZ180020	0.1UF 1608 16V 10%	0CK104CF56A
C940	AZ180067	0.01UF 1608 50V 10%	0CK103CK56A
C941	AZ180020	0.1UF 1608 16V 10%	0CK104CF56A
C942	AZ180020	0.1UF 1608 16V 10%	0CK104CF56A
C943	AZ180020	0.1UF 1608 16V 10%	0CK104CF56A
C944	AZ180020	0.1UF 1608 16V 10%	0CK104CF56A
C945	AZ180020	0.1UF 1608 16V 10%	0CK104CF56A
C946	AZ180020	0.1UF 1608 16V 10%	0CK104CF56A
C947	AZ180020	0.1UF 1608 16V 10%	0CK104CF56A
C949	AZ180020	0.1UF 1608 16V 10%	0CK104CF56A
C950	AZ180020	0.1UF 1608 16V 10%	0CK104CF56A
JACK			
JA1201	AZ780001	JACK ASSEMBLY, PMJ021G 9P	6613V00013G
JA1202A	AZ780002	JACK,RCA PJ6061E 6P	6612VJH006C
JA200	AZ780003	JACK ASSY, PMJ021B 9P	6613V00013B
JA201	AZ780003	JACK ASSY, PMJ016B 3P	6613V00010B
JA201	AZ780004	JACK, DIN PHSJ-9504	380-404A
P501	AZ780005	JACK, DIN 74320-3004 30PIN	6612BBBHN7A
COIL & TRANSFORMER			
L100	AZ380020	COIL, CHOKE SB7032-751 750UH	6140VB0023A
L861	AZ380021	COIL, CHOKE 82UH	150-C02F
L871	AZ380021	COIL, CHOKE 82UH	150-C02F
L881	AZ380021	COIL, CHOKE 82UH	150-C02F
L891	AZ380021	COIL, CHOKE 82UH	150-C02F
L903	AZ380022	COIL, DT1608C-223 22UF+-20% 0.5A	6140VR0007A
L904	AZ380022	COIL, DT1608C-223 22UF+-20% 0.5A	6140VR0007A
T801	AZ380023	TRANSFORMER, SMPS (COIL) EER4220 360UH	6170VMCA06N
T830	AZ380024	TRANSFORMER, SMPS (COIL) EER4215 660UH	6170VMCA13T
CONNECTOR			
JA1200	AZ780006	CONNECTOR, D-SUB 15P 2.29MM	6630TGA004F
P100	AZ780007	CONNECTOR, DIN41612 SOCKET	6630B60F532
P101	AZ780007	CONNECTOR, DIN41612 SOCKET	6630B60F532
P101B	AZ780007	CONNECTOR, DIN41612 SOCKET	6630B60F532

LOCA. NO.	PART NO.	DESCRIPTION	REFERENCE NO.
P102	AZ780008	CONNECTOR, D-SUB 24P 1.91MM	6630GZ00724
P102B	AZ780007	CONNECTOR, DIN41612 SOCKET	6630B60F532
P104	AZ780009	CONNECTOR, D-SUB 9PIN 2.77MM	6630VGA004A
P1200B	AZ780007	CONNECTOR, DIN41612 SOCKET	6630B60F532
P300	AZ780008	CONNECTOR, D-SUB 24P 1.91MM	6630GZ00724
RESISTOR			
AR1001	AZ280001	22 OHM 1/16W 1608 5%	0RRZVTA001D
AR1002	AZ280001	22 OHM 1/16W 1608 5%	0RRZVTA001D
AR1003	AZ280001	22 OHM 1/16W 1608 5%	0RRZVTA001D
AR1004	AZ280001	22 OHM 1/16W 1608 5%	0RRZVTA001D
AR1005	AZ280001	22 OHM 1/16W 1608 5%	0RRZVTA001D
AR1006	AZ280001	22 OHM 1/16W 1608 5%	0RRZVTA001D
AR1007	AZ280001	22 OHM 1/16W 1608 5%	0RRZVTA001D
AR1008	AZ280001	22 OHM 1/16W 1608 5%	0RRZVTA001D
AR503	AZ280001	22 OHM 1/16W 1608 5%	0RRZVTA001D
AR504	AZ280001	22 OHM 1/16W 1608 5%	0RRZVTA001D
AR506	AZ280001	22 OHM 1/16W 1608 5%	0RRZVTA001D
AR516	AZ280001	22 OHM 1/16W 1608 5%	0RRZVTA001D
AR518	AZ280001	22 OHM 1/16W 1608 5%	0RRZVTA001D
AR519	AZ280001	22 OHM 1/16W 1608 5%	0RRZVTA001D
AR522	AZ280001	22 OHM 1/16W 1608 5%	0RRZVTA001D
AR523	AZ280001	22 OHM 1/16W 1608 5%	0RRZVTA001D
AR526	AZ280001	22 OHM 1/16W 1608 5%	0RRZVTA001D
AR529	AZ280001	22 OHM 1/16W 1608 5%	0RRZVTA001D
AR530	AZ280001	22 OHM 1/16W 1608 5%	0RRZVTA001D
AR531	AZ280001	22 OHM 1/16W 1608 5%	0RRZVTA001D
AR744	AZ280002	MNR-14-E0A-J-101 R OHM 100 OHM 5%	0RRZVTA001A
AR746	AZ280002	MNR-14-E0A-J-101 R OHM 100 OHM 5%	0RRZVTA001A
AR748	AZ280002	MNR-14-E0A-J-101 R OHM 100 OHM 5%	0RRZVTA001A
AR750	AZ280002	MNR-14-E0A-J-101 R OHM 100 OHM 5%	0RRZVTA001A
AR846	AZ280002	MNR-14-E0A-J-101 R OHM 100 OHM 5%	0RRZVTA001A
AR847	AZ280002	MNR-14-E0A-J-101 R OHM 100 OHM 5%	0RRZVTA001A
AR848	AZ280002	MNR-14-E0A-J-101 R OHM 100 OHM 5%	0RRZVTA001A
J2	AZ280003	0.02 OHM 1 W 20%	0RP0020J809
R1	AZ280004	75 OHM 1/6 W 5.00%	0RD0752F609
R1286	AZ280005	10K OHM 1/6 W 1.00%	0RN1002F409
R2	AZ280006	470K OHM 1/6 W 5.00%	0RD4703F609
R3	AZ280006	470K OHM 1/6 W 5.00%	0RD4703F609
R4	AZ280007	75 OHM 1/6 W 5.00%	0RD0752F609
R5	AZ280007	75 OHM 1/6 W 5.00%	0RD0752F609
R722	AZ280008	3.3 OHM 1/2 W 5.00%	0RF0331H609
R724	AZ280008	3.3 OHM 1/2 W 5.00%	0RF0331H609
R779	AZ280009	5.6 OHM 1/2 W 5.00%	0RD0561H609
R800	AZ280010	4.7M OHM 1/2 W 5%	0RKZVTA001B
R810	AZ280011	2.2M OHM 1/6 W 5.00%	0RD2204F609
R811	AZ280011	2.2M OHM 1/6 W 5.00%	0RD2204F609
R812	AZ280012	33K OHM 1/6 W 5%	0RD3302F609
R813	AZ280013	10K OHM 1/6 W 5%	0RD1002F609
R814	AZ280014	560K OHM 1/4 W 1.00%	0RN5603G409
R815	AZ280015	510K OHM 1/4 W 1%	0RN5103G409
R816	AZ280015	510K OHM 1/4 W 1%	0RN5103G409

ELECTRICAL REPLACEMENT PARTS LIST

LOCA. NO.	PART NO.	DESCRIPTION	REFERENCE NO.
R817	AZ280015	510K OHM 1/4 W 1%	0RN5103G409
R818	AZ280016	22K OHM 1/6 W 5%	0RD2202F609
R819	AZ280017	56K OHM 1/6 W 5%	0RD5602F609
R820	AZ280018	10 OHM 1/6 W 5%	0RD0102F609
R821	AZ280019	100K OHM 1/6 W 5%	0RD1003F609
R823	AZ280020	0.13 OHM 2 W 5% RWR	180-A01P
R824	AZ280016	22K OHM 1/6 W 5%	0RD2202F609
R831	AZ280021	27 OHM 1/2 W(7.0) 5.00%	0RD0272A609
R832	AZ280022	68K OHM 1/6 W 5.00%	0RD6802F609
R833	AZ280023	6.8K OHM 1/6 W 5.00%	0RD6801F609
R834	AZ280024	100 OHM 1/6 W 5%	0RD1000F609
R835	AZ280025	15 OHM 1/6 W 5.00%	0RD0152F609
R836	AZ280026	1K OHM 1/6 W 5%	0RD1001F609
R837	AZ280027	2 W RW ROUND G 0.27 J TA31(63)	180-A01H
R838	AZ280028	430 OHM 1/6 W 5.00%	0RD4300F609
R839	AZ280029	3K OHM 1/6 W 5.00%	0RD3001F609
R840	AZ280024	100 OHM 1/6 W 5%	0RD1000F609
R841	AZ280030	100K OHM 2 W 5.00%	0RS1003K607
R842	AZ280031	470 OHM 1/2 W 5.00%	0RD4700H609
R843	AZ280031	470 OHM 1/2 W 5.00%	0RD4700H609
R844	AZ280032	47K OHM 1/6 W 5%	0RD4702F609
R845	AZ280033	30 OHM 1/6 W 5.00%	0RD0302F609
R850	AZ280034	330K OHM 1/4 W 1.00%	0RN3303G409
R851	AZ280035	2K OHM 1/6 W 5%	0RD2001F609
R852	AZ280036	18K OHM 1/6 W 1.00%	0RN1802F409
R854	AZ280037	4.7K OHM 1/6 W 1.00%	0RN4701F409
R855	AZ280038	1.5K OHM 1/6 W 5%	0RD1501F609
R856	AZ280039	510 OHM 1/6 W 5.00%	0RD5100F609
R857	AZ280039	510 OHM 1/6 W 5.00%	0RD5100F609
R865	AZ280040	3.6K OHM 1/6 W 5.00%	0RD3601F609
R866	AZ280041	3.9K OHM 1/6 W 5%	0RD3901F609
R867	AZ280039	510 OHM 1/6 W 5.00%	0RD5100F609
R868	AZ280042	1.2K OHM 1/6 W 1.00%	0RN1201F409
R872	AZ280034	330K OHM 1/4 W 1.00%	0RN3303G409
R873	AZ280043	270K OHM 1/4 W 5.00%	0RD2703G609
R874	AZ280044	5.1K OHM 1/6 W 5.00%	0RN5101F609
R875	AZ280045	10K OHM 1/6 W 5%	0RD1002F609
R876	AZ280026	1K OHM 1/6 W 5%	0RD1001F609
R877	AZ280046	3.9 OHM 1/6 W 5.00%	0RD0391F609
R891	AZ280047	10K OHM 1/2 W 5.00%	0RD1002H609
R892	AZ280048	470 OHM 2 W 5.00%	0RS4700K607
R893	AZ280048	470 OHM 2 W 5.00%	0RS4700K607
R894	AZ280026	1K OHM 1/6 W 5%	0RD1001F609
R895	AZ280049	8.2K OHM 1/6 W 1.00%	0RN8201F409
R896	AZ280050	2.2K OHM 1/6 W 1.00%	0RN2201F409
R897	AZ280026	1K OHM 1/6 W 5%	0RD1001F609
△ R898	AZ280010	4.7M OHM 1/2 W 5%	0RKZVTA001B
SWITCH			
SW01	AZ682001	SWITCH, PUSH SPBS222EP011	140-275E
SW1	AZ682002	SWITCH, TACT 2LEAD 160G(TA)	140-313B
SW2	AZ682002	SWITCH, TACT 2LEAD 160G(TA)	140-313B
SW3	AZ682002	SWITCH, TACT 2LEAD 160G(TA)	140-313B
SW4	AZ682002	SWITCH, TACT 2LEAD 160G(TA)	140-313B
SW5	AZ682002	SWITCH, TACT 2LEAD 160G(TA)	140-313B
SW6	AZ682002	SWITCH, TACT 2LEAD 160G(TA)	140-313B
SW7	AZ682002	SWITCH, TACT 2LEAD 160G(TA)	140-313B
SW701	AZ682003	SWITCH, DIP 1-1437590-3 50VDC	6600DU2093V

LOCA. NO.	PART NO.	DESCRIPTION	REFERENCE NO.
FILTER & CRYSTAL			
FB851	AZ380001	FILTER, EMC BFD3565R2F	125-123A
FB861	AZ380001	FILTER, EMC BFD3565R2F	125-123A
FB871	AZ380001	FILTER, EMC BFD3565R2F	125-123A
FB882	AZ380001	FILTER, EMC BFD3565R2F	125-123A
FB891	AZ380001	FILTER, EMC BFD3565R2F	125-123A
FL100	AZ380002	FILTER, EMC NFL21SP207X1C3	6200J000012
FL101	AZ380002	FILTER, EMC NFL21SP207X1C3	6200J000012
FL104	AZ380002	FILTER, EMC NFL21SP207X1C3	6200J000012
FL106	AZ380002	FILTER, EMC NFL21SP207X1C3	6200J000012
FL107	AZ380002	FILTER, EMC NFL21SP207X1C3	6200J000012
FL108	AZ380002	FILTER, EMC NFL21SP207X1C3	6200J000012
FL109	AZ380002	FILTER, EMC NFL21SP207X1C3	6200J000012
FL112	AZ380002	FILTER, EMC NFL21SP207X1C3	6200J000012
FL113	AZ380002	FILTER, EMC NFL21SP207X1C3	6200J000012
FL117	AZ380002	FILTER, EMC NFL21SP207X1C3	6200J000012
FL123	AZ380003	FILTER, EMC STC222D 50VOLT 4A 2200PF	6200VJT006A
FL124	AZ380003	FILTER, EMC STC222D 50VOLT 4A 2200PF	6200VJT006A
FL125	AZ380003	FILTER, EMC STC222D 50VOLT 4A 2200PF	6200VJT006A
FL127	AZ380003	FILTER, EMC STC222D 50VOLT 4A 2200PF	6200VJT006A
FL134	AZ380002	FILTER, EMC NFL21SP207X1C3	6200J000012
FL139	AZ380002	FILTER, EMC NFL21SP207X1C3	6200J000012
FL300	AZ380004	FILTER, B.P. H354LAI-K5202	6200C000010
FL301	AZ380004	FILTER, B.P. H354LAI-K5202	6200C000010
FL303	AZ380004	FILTER, B.P. H354LAI-K5202	6200C000010
FL304	AZ380004	FILTER, B.P. H354LAI-K5202	6200C000010
L515	AZ380005	FILTER, EMC MLB-201209-0120P-N2 5A	0LCML00003B
L601	AZ380006	FILTER, EMC MLB-321611-0050P-N1 6A	0LCML00002B
L700	AZ380007	FILTER, EMC MLB-160808-0068P-N2 1A	0LCML00004A
L702	AZ380007	FILTER, EMC MLB-160808-0068P-N2 1A	0LCML00004A
L704	AZ380006	FILTER, EMC MLB-321611-0050P-N1 6A	0LCML00002B
L705	AZ380005	FILTER, EMC MLB-201209-0120P-N2 5A	0LCML00003B
L800	AZ380007	FILTER, EMC MLB-160808-0068P-N2 1A	0LCML00004A
△ L801	AZ380008	FILTER, EMC SQE2828 17.2MH 60TURNS	6200JBB8012T
△ L802	AZ380008	FILTER, EMC SQE2828 17.2MH 60TURNS	6200JBB8012T
△ L803	AZ380009	FILTER, EMC SQE3535 27.5MH 0.6PHY	150-F06U
L901	AZ380005	FILTER, EMC MLB-201209-0120P-N2 5A	0LCML00003B
L902	AZ380007	FILTER, EMC MLB-160808-0068P-N2 1A	0LCML00004A
L906	AZ380005	FILTER, EMC MLB-201209-0120P-N2 5A	0LCML00003B
L907	AZ380010	FILTER, EMC MLB-201209-0600L-N2 0.5A	0LCML00003A
L908	AZ380005	FILTER, EMC MLB-201209-0120P-N2 5A	0LCML00003B
L909	AZ380005	FILTER, EMC MLB-201209-0120P-N2 5A	0LCML00003B

ELECTRICAL REPLACEMENT PARTS LIST

LOCA. NO.	PART NO.	DESCRIPTION	REFERENCE NO.	
L910	AZ380005	FILTER, EMC MLB-201209-0120P-N2 5A	0LCML00003B	
T300	AZ380011	FILTER, B.PAFM730F6M00X3 (AF9497A)	0IZZVF0022C	
T400	AZ380003	FILTER, EMC STC222D 50VOLT 4A 2200PF	6200VJT006A	
T401	AZ380003	FILTER, EMC STC222D 50VOLT 4A 2200PF	6200VJT006A	
T402	AZ380003	FILTER, EMC STC222D 50VOLT 4A 2200PF	6200VJT006A	
T403	AZ380003	FILTER, EMC STC222D 50VOLT 4A 2200PF	6200VJT006A	
T404	AZ380003	FILTER, EMC STC222D 50VOLT 4A 2200PF	6200VJT006A	
T501	AZ380012	FILTER, EMC BMS400 25V 200MA	6200QJ3001A	
T502	AZ380012	FILTER, EMC BMS400 25V 200MA	6200QJ3001A	
T504	AZ380012	FILTER, EMC BMS400 25V 200MA	6200QJ3001A	
T509	AZ380012	FILTER, EMC BMS400 25V 200MA	6200QJ3001A	
T511	AZ380012	FILTER, EMC BMS400 25V 200MA	6200QJ3001A	
T512	AZ380003	FILTER, EMC STC222D 50VOLT 4A 2200PF	6200VJT006A	
T513	AZ380003	FILTER, EMC STC222D 50VOLT 4A 2200PF	6200VJT006A	
T514	AZ380003	FILTER, EMC STC222D 50VOLT 4A 2200PF	6200VJT006A	
T515	AZ380003	FILTER, EMC STC222D 50VOLT 4A 2200PF	6200VJT006A	
T601	AZ380012	FILTER, EMC BMS400 25V 200MA	6200QJ3001A	
T602	AZ380012	FILTER, EMC BMS400 25V 200MA	6200QJ3001A	
T603	AZ380012	FILTER, EMC BMS400 25V 200MA	6200QJ3001A	
T604	AZ380012	FILTER, EMC BMS400 25V 200MA	6200QJ3001A	
X1	AZ380013	RESONATOR, CRYSTAL HC49U 8.000MHZ	156-A01P	
X100	AZ380014	RESONATOR, CRYSTAL HC49/SM 16MHZ	6212AB2015D	
X102	AZ380015	RESONATOR, CRYSTAL SX-1SMD 20250000HZ	6202VDT002E	
X1202	AZ380016	RESONATOR, CRYSTAL HC49U 4.000MHZ	156-A01E	
X1203	AZ380017	RESONATOR, CRYSTAL CSALA2M69G4ZF01-B0	6212BA2002C	
X600	AZ380018	RESONATOR, CRYSTAL HC49U18.432MHZ	156-A02R	
X700	AZ380019	RESONATOR, CRYSTAL SX-1 24.576MHZ	6212AB2806A	
MISCELLANEOUS				
⚠	F701	AZ684005	FUSE, SLOW BLOW 0FS 4000MA 250V	0FS4001B84B
⚠	F800	AZ684006	FUSE, SLOW BLOW 5000MA 250V	0FS5001B51D
	IC505	AZ684007	OSCILLATOR, 27MHZ +/-100 PPM 3.3V	6204B60001B
	IC704	AZ684008	OSCILLATOR, SCO-103 100MHZ	6204B47985C
	PA1	AZ684009	REMOTE CONTROLLER RECEIVER, 38KHZ	6726VH0001A
⚠	TH801	AZ684010	TERMISTOR, NTC KL15L2R5 +/-15% 125V	163-048D
⚠	TH802	AZ684010	TERMISTOR, NTC KL15L2R5 +/-15% 125V	163-048D
	TU100	AZ684011	TUNER, TAUD-H101F	6700NFNS06Q
	TU101	AZ684012	TUNER, TAFD-H101P	6700NFNS06P
⚠	VA800	AZ684013	VARISTOR, SVC621D-14A 620V 0%	164-003K

LOCA. NO.	PART NO.	DESCRIPTION	REFERENCE NO.
ACCESSORIES			
A1	AZ684004	MANUAL, OWNERS TOSHIBA	3828VA0465G
A2	AZ684003	REMOTE CONTROLLER, TOSHIBA	6710V00102R

TOSHIBA CORPORATION

1-1, SHIBAURA 1-CHOME, MINATO-KU, TOKYO 105-8001, JAPAN