

PFM STEP-UP DC-DC CONVERTER WITH HIGH EFFICIENCY AND LOW NOISE

A7530

Description

A7530 is CMOS-based PFM step-up DC-DC converter. The converter can start up by supply voltage as low as 0.8V, and capable of delivering maximum 200mA output current at 3.3V output with 1.8V input voltage. Quiescent current drawn from power source is as low as 7uA. All of these features make A7530 be suitable for the portable devices, which are supplied by a single battery for four-cell batteries.

To reduce the noise caused by the switch regulator, A7530 is well considerate in circuit design and manufacture. So that the interferer to other circuits by the device is reduced greatly.

The A7530 integrates stable reference circuits and trimming technology, so it can afford high precision and low temperature-drift coefficient of the output voltage.

The A7530 is available in SOT-23 and SOT-25 package. And in SOT-25 package, the device can be switch on or off easily by CE pin to minimize the standby supply current.

Ordering Information

E3	SOT-23	PN: A7530E3-XXY
E5	SOT-25	PN: A7530E5-XXY
Note	Y	XX: Output voltage
		1: Internal Tr. Driver, W/O Enable Circuit
		2: Internal Tr. Driver, W/Enable Circuit
		3: External Tr. Driver, W/O Enable Circuit
		4: External Tr. Driver, W/Enable Circuit

Features

- Deliver 200mA at 3.3V Output Voltage with 1.8V Input Voltage
- Low Start-Up Voltage @1mA:0.8V
- The Converter Output Voltage Can Be Adjusted From 2.5V~6.0V (in 0.1V step)
- Output Voltage Accuracy: $\pm 2\%$
- Low Temperature-Drift Coefficient of the Output Voltage: $\pm 100\text{ppm}/^\circ\text{C}$
- Only Three External Components are needed: an Inductor, a Schottky Diode and an Output Filter Capacitor.
- High Power Conversion Efficiency: 85%
- Low Quiescent Current Drawn from Power Source: $<7\mu\text{A}$

Application

- Portable Source for PDA, DSC, MP3 Player, Electronic Toy and Wireless Mouse
- Power Source for a Single or Dual-Cell Battery-Powered Equipments
- Power Source for LED

Pin Assignment

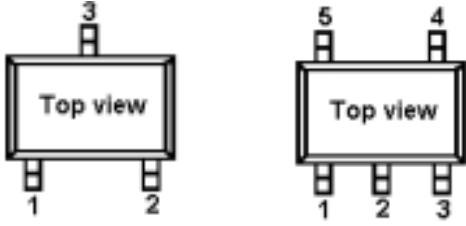

**PFM STEP-UP DC-DC CONVERTER
WITH HIGH EFFICIENCY AND LOW NOISE**

A7530

Absolute Maximum Ratings

Input Voltage Range	0.3V~+12V
Input Voltage: Vi (Lx)	0.3V ~ (Vout+0.3V)
CE Pin Voltage	0.3V ~ (Vout+0.3V)
LX Pin Output Current	0.7A
Maximum Power Dissipation, T=25°C	
SOT-23	0.15W
SOT-25	0.15W
Maximum Junction Temperature	+150°C
Storage Temperature Range	-40°C ~ +125°C
Operating Free-air Temperature	-20°C ~ +80°C
Lead Temperature (Soldering, 10s)	+260°C, 10S

Electrical Characteristics

Parameter	Conditions	Min	Typ	Max	Unit
Vout (Output Voltage)		2.450	2.5	2.55	V
		2.646	2.7	2.754	
		2.94	3.0	3.06	
		3.234	3.3	3.366	
		3.528	3.6	3.672	
		3.920	4.0	4.080	
		4.900	5.0	5.100	
		5.880	6.0	6.120	
Vin (Input Voltage)				12	V
Iin (Input Current)	Iout=0mA, Vin=Vout*0.6		12	15	µA
Vstart (Start-up Voltage)	Iout=1mA, Vin: 0 ->2V		0.8	0.9	V
Vhold (Hold-on Voltage)	Iout=1mA, Vin: 2-> 0V	0.6	0.7		V
IDD (Quiescent Current Drawn From Power Source)	Without External Components, Vout=Vout*1.05		4	7	µA
Rswon (Switch On Resistance)			0.4	0.5	Ω
ILXleak (LX Leakage Current)	Vout=Vlx=6V			0.5	µA
VCEH (CE "H" Threshold Voltage)	VCE: 0 -> 2V	0.6	0.9		V
VCEL (CE "L" Threshold Voltage)	VCE: 2-> 0V		0.3	0.6	V
Fosc (Oscillation Frequency)	LX on "L" side, Vout=Vout*0.96	300	350	400	KHz
Maxdty (Oscillator Duty Cycle)	On (Vlx "L") Side	70	75	80	%
η (Efficiency)			85		%

PFM STEP-UP DC-DC CONVERTER WITH HIGH EFFICIENCY AND LOW NOISE

A7530

Typical Characteristics

1. Output Voltage VS. Output Current

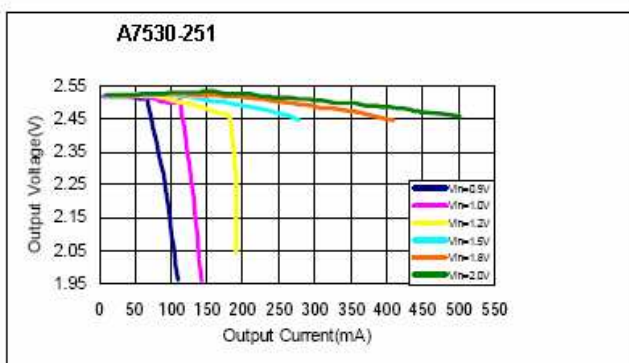

2. Output Voltage VS. Output Current

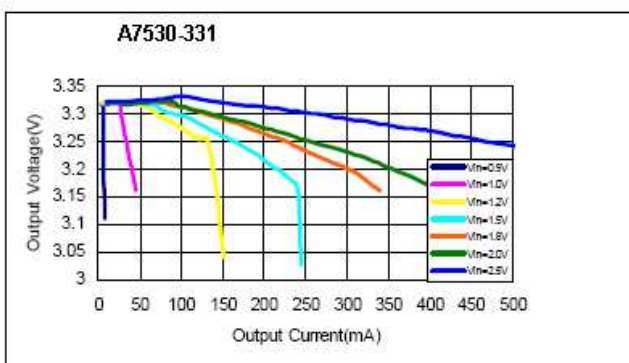

3. Output Voltage VS. Output Current

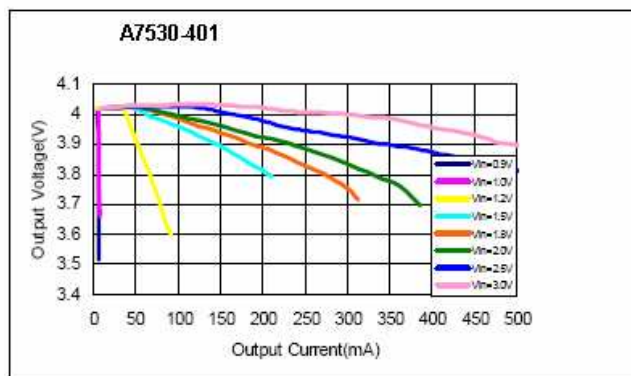

4. Efficiency VS. Output Current

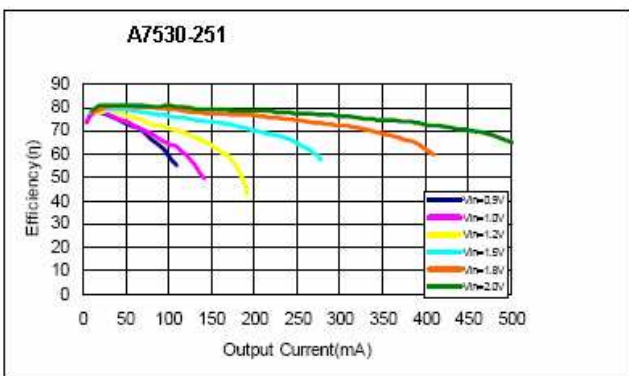

5. Efficiency VS. Output Current

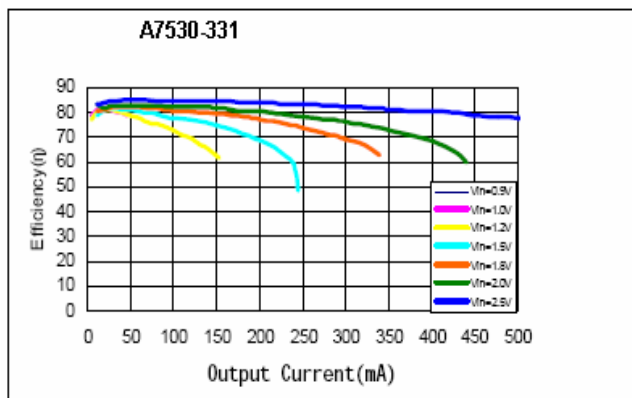

6. Efficiency VS. Output Current

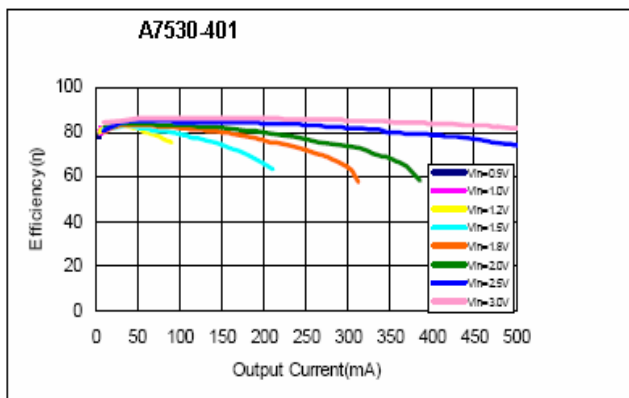

PFM STEP-UP DC-DC CONVERTER WITH HIGH EFFICIENCY AND LOW NOISE

A7530

7. Ripple VS. Output Current

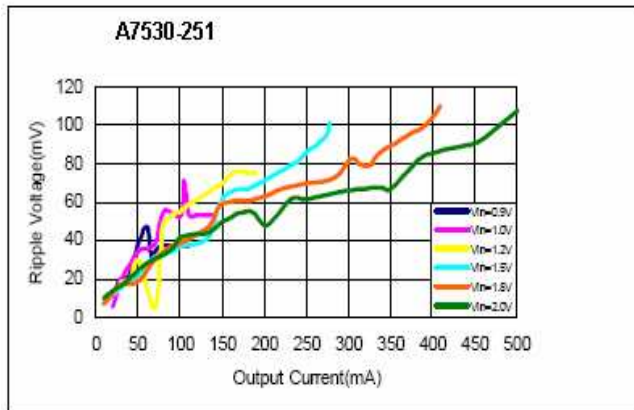

8. Ripple VS. Output Current

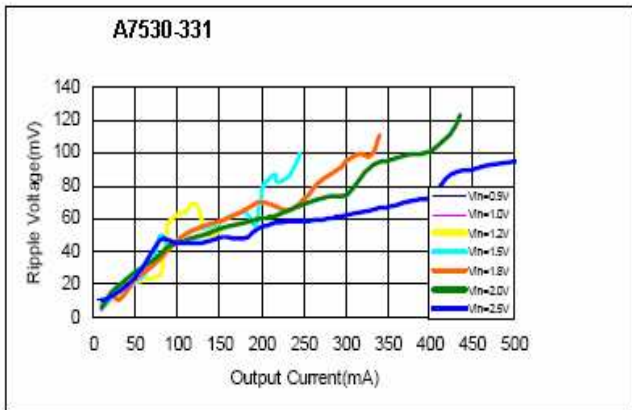

9. Ripple VS. Output Current

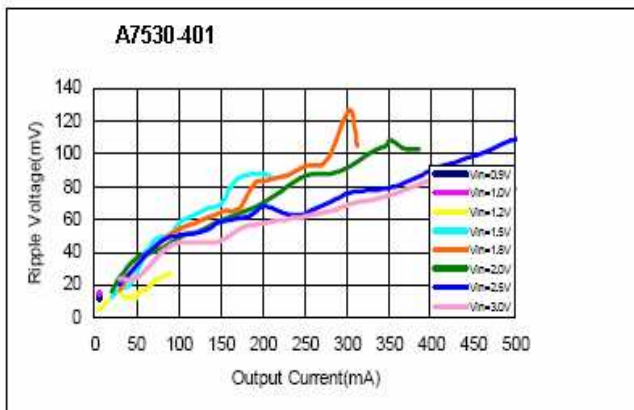

10. No load VS. Input Voltage

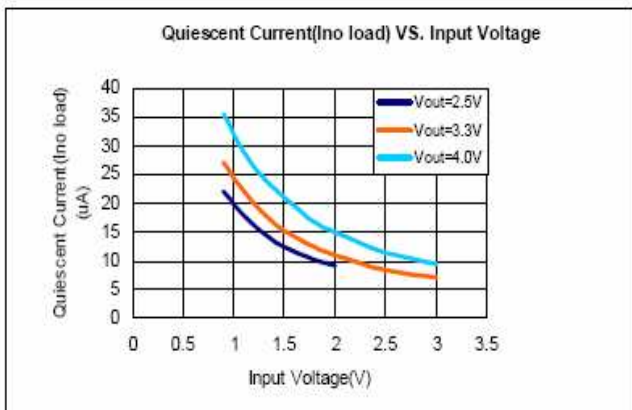

**PFM STEP-UP DC-DC CONVERTER
WITH HIGH EFFICIENCY AND LOW NOISE**

A7530

Package Information

Dimension in SOT-23 (Unit: mm)

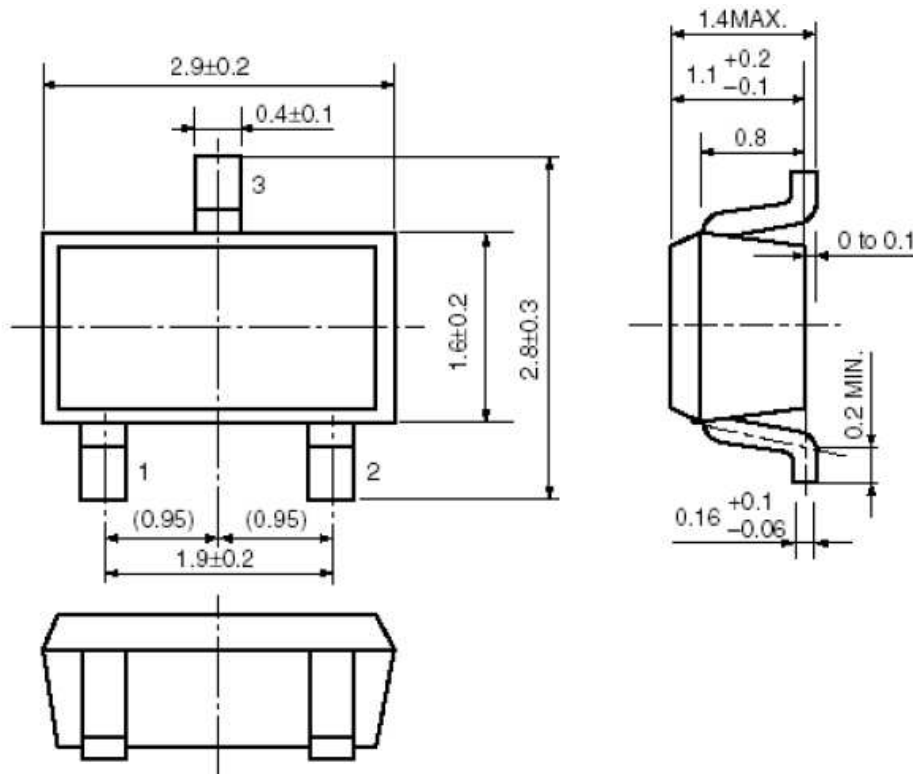

Tape Dimension

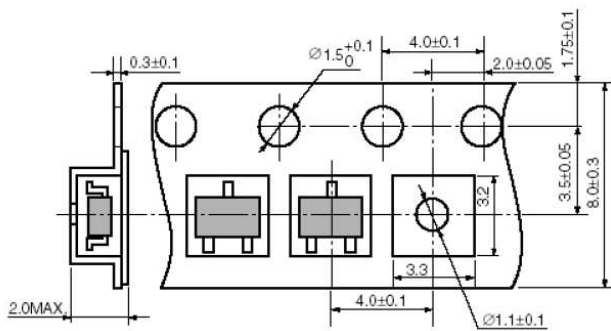

Reel Dimension

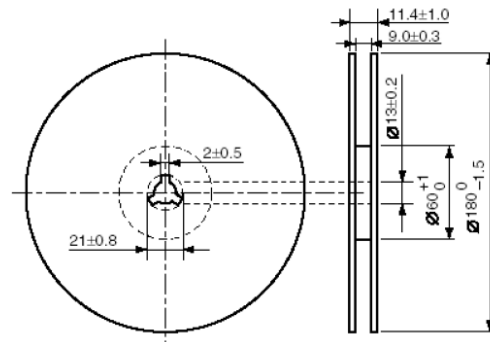

**PFM STEP-UP DC-DC CONVERTER
WITH HIGH EFFICIENCY AND LOW NOISE**

A7530

Dimension in SOT-25 (Unit: mm)

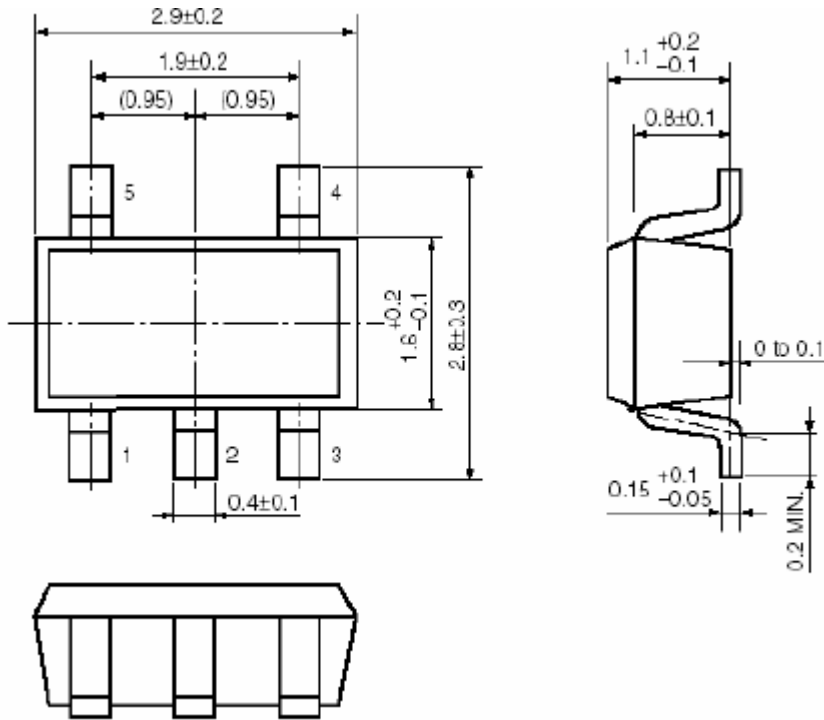

Tape Dimension

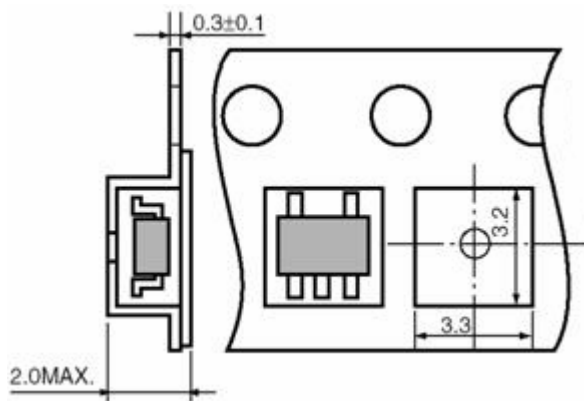

Reel Dimension

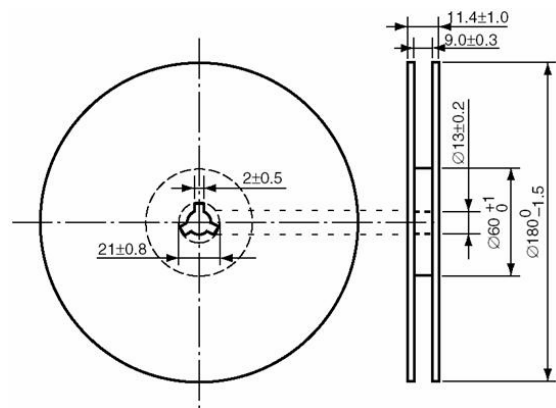

IMPORTANT NOTICE

Advanced Innovation Technology Corp. (AiT) reserves the right to make changes to any its product, specifications, to discontinue any integrated circuit product or service without notice, and advises its customers to obtain the latest version of relevant information to verify, before placing orders, that the information being relied on is current.

Advanced Innovation Technology Corp.'s integrated circuit products are not designed, intended, authorized, or warranted to be suitable for use in life support applications, devices or systems or other critical applications. Use of AiT products in such applications is understood to be fully at the risk of the customer. As used herein may involve potential risks of death, personal injury, or severe property, or environmental damage. In order to minimize risks associated with the customer's applications, the customer should provide adequate design and operating safeguards.

Advanced Innovation Technology Corp. assumes to no liability to customer product design or application support. AiT warrants the performance of its products of the specifications applicable at the time of sale.