

REV 版本	DESCRIPTION 描述	DATE 日期
A	First issue	Nov-17-2007

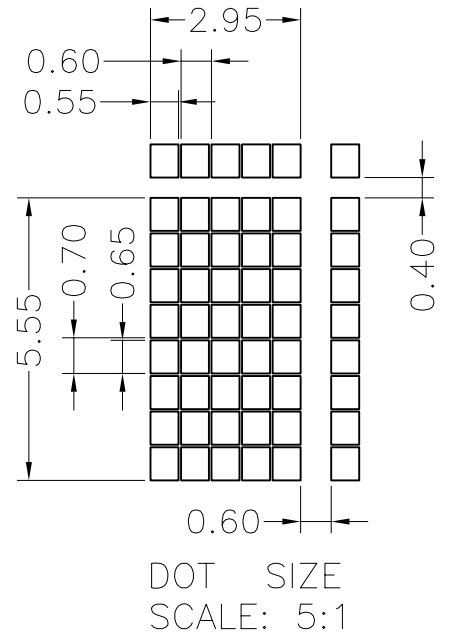
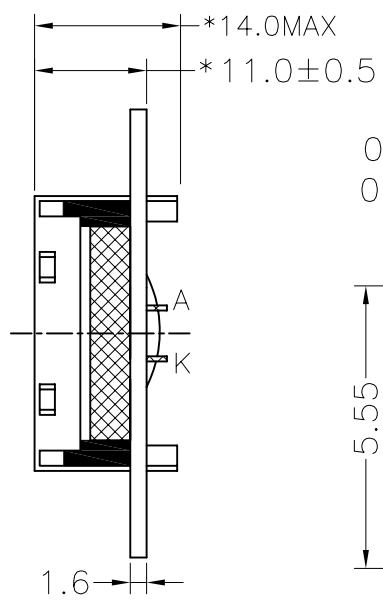
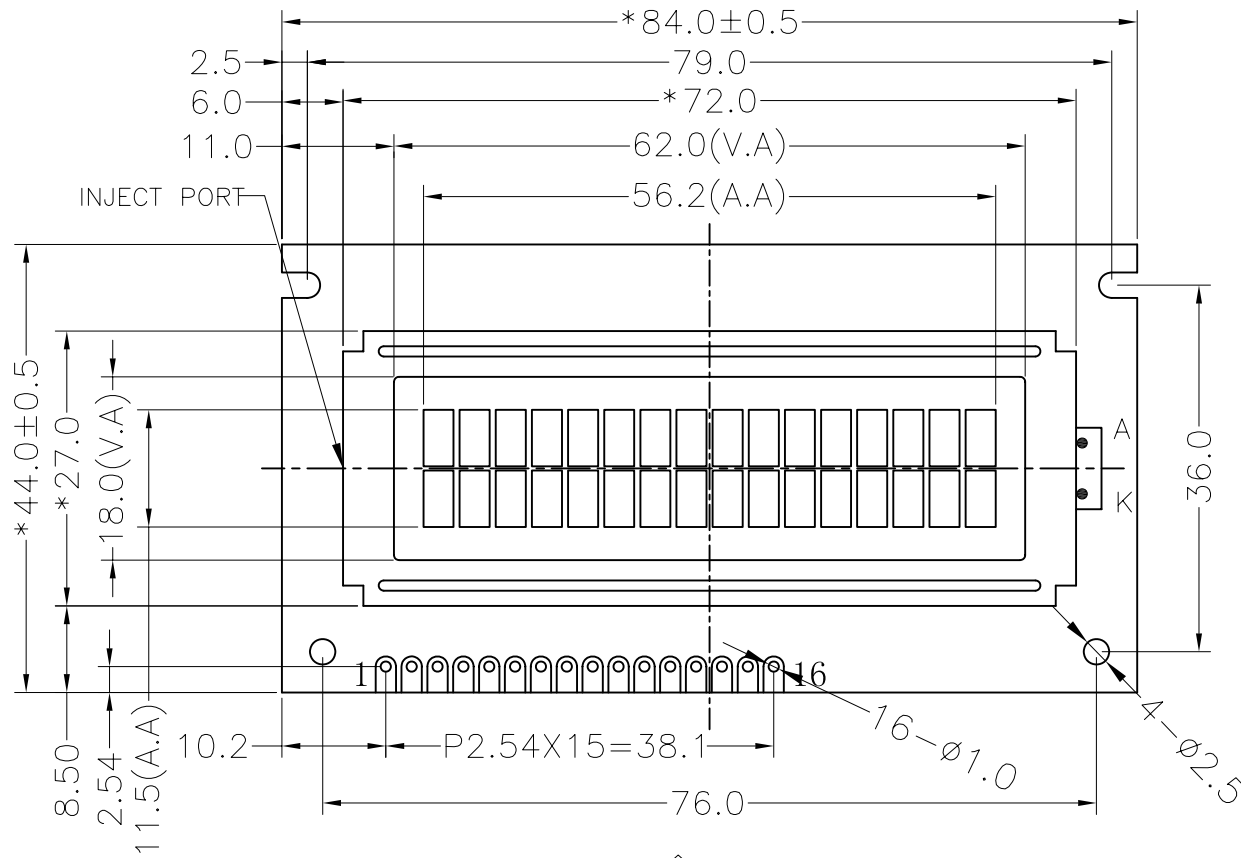

↑
VIEWING DIRECTION

Specification:

- 1). Driving: Duty:1/16, Bias:1/5, VDD:5.0V, VLCD:4.8V
- 2). Viewing direction: 6 O'clock
- 3). Display mode: STN/Positive/Transflective/Y-G
- 4). Operating temp.: -20°C ~ +70°C
- 5). Storage temp.: -30°C ~ +80°C
- 6). Drive IC: CS0066
- 7). Backlight: Bottom, Yellow-Green,
- 8). Dimensions with mark "*" are important, with mark "()" are referenced
- 9). All the raw materials are RoHS compliant

PIN	1	2	3	4	5	6	7	8
CONNECTOR	DB7	DB6	DB5	DB4	DB3	DB2	DB1	DB0
PIN	9	10	11	12	13	14	15	16
CONNECTOR	E	R/W	RS	VO	VDD	VSS	LEDA	LEDK

<p>深圳秋田微电子有限公司 SHENZHEN AV-DISPLAY CO.,LTD.</p>			SCALE: 比例 FIT 适应图面		
			SHEET: 页次 1 OF 1		
PART NO: C/D 结构图		PROJECTION: 三角法	MODEL NUMBER: ABC016002G11-YHY-R-02	APPROVALS: 签字	UNIT 单位: mm
ABC016002G11-YHY-R-02			DO NOT SCALE THIS DRAWING.	APP: 洪俊斌	DATE: 日期
				CHK: 邵飞兰	
				DWN: 郑学东	