

AEL High Speed Fuse



FEATURES:

- 80 Vdc EV high speed fuse
- Rated Current: 30-800 A
- Rated Breaking Capacity: 3 kA at 80 Vdc
- Bolt Size: M10
- Torque: M10:19 N·m;
- Recommended fuse holder:
 - BHR061-25-M10 (with cover): 30-200A;
 - BHR061-25-M10-S (no cover): 30-800A;

APPROVALS INFORMATION:

- Ref. to: UL 248; DIN 43560; IEC60269-4
- Approvals: UL (File: E485737) and TÜV (50546731)
- Manufactured under IATF 16949 quality system
- RoHS and REACH Compliant

ELECTRICAL SPECIFICATIONS

Part Number	Rated Current	Ampere Code	Rated Voltage	Breaking Capacity	Certifications	
					cURus	TUV
AEL2300801	30 A	2300	80 Vdc	3 kA@80 Vdc	●	●
AEL2400801	40 A	2400			●	●
AEL2500801	50 A	2500			●	●
AEL2600801	60 A	2600			●	●
AEL2700801	70 A	2700			●	●
AEL2800801	80 A	2800			●	●
AEL3100801	100 A	3100			●	●
AEL3125801	125 A	3125			●	●
AEL3130801	130 A	3130			●	●
AEL3150801	150 A	3150			●	●
AEL3175801	175 A	3175			●	●
AEL3200801	200 A	3200			●	●
AEL3225801	225 A	3225			●	●
AEL3250801	250 A	3250			●	●
AEL3275801	275 A	3275			●	●
AEL3300801	300 A	3300			●	●
AEL3325801	325 A	3325	●	●		
AEL3350802	350 A	3350	80 Vdc	3 kA@80 Vdc	●	●
AEL3400802	400 A	3400			●	●
AEL3450802	450 A	3450			●	●
AEL3500802	500 A	3500			●	●
AEL3550802	550 A	3550			●	●
AEL3600802	600 A	3600			●	●
AEL3675803	675 A	3675	80 Vdc	3 kA@80 Vdc	●	●
AEL3700803	700 A	3700			●	●
AEL3750803	750 A	3750			●	○
AEL3800803	800 A	3800			●	○

TIME VS CURRENT CHARACTERISTIC

Rated Current	100 %	150 %	160 %	220 %	250 %	400 %
30-200 A	-	>1 h	--	<60 s	0.8-10s	0.25-2 s
225-800 A	>1 h	-	>60 s	<60 s	<10 s	0.25-2 s

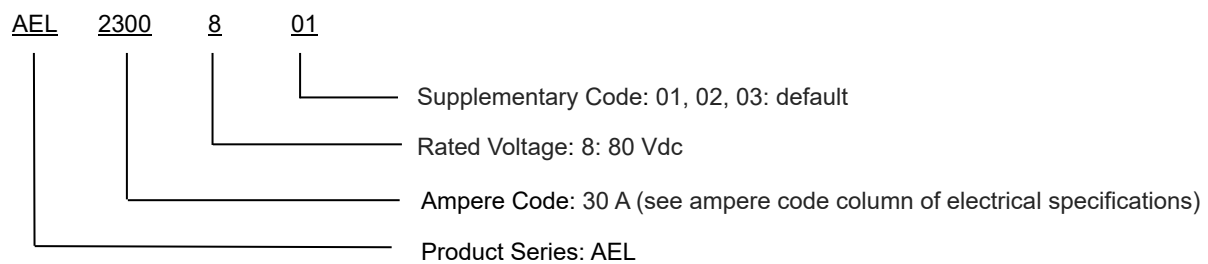
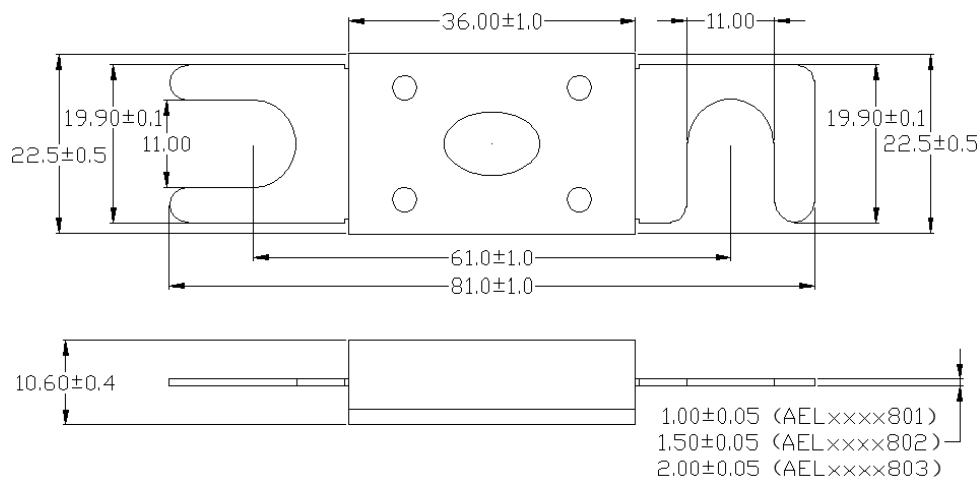
PART NUMBERING SYSTEM

DIMENSIONS (mm)

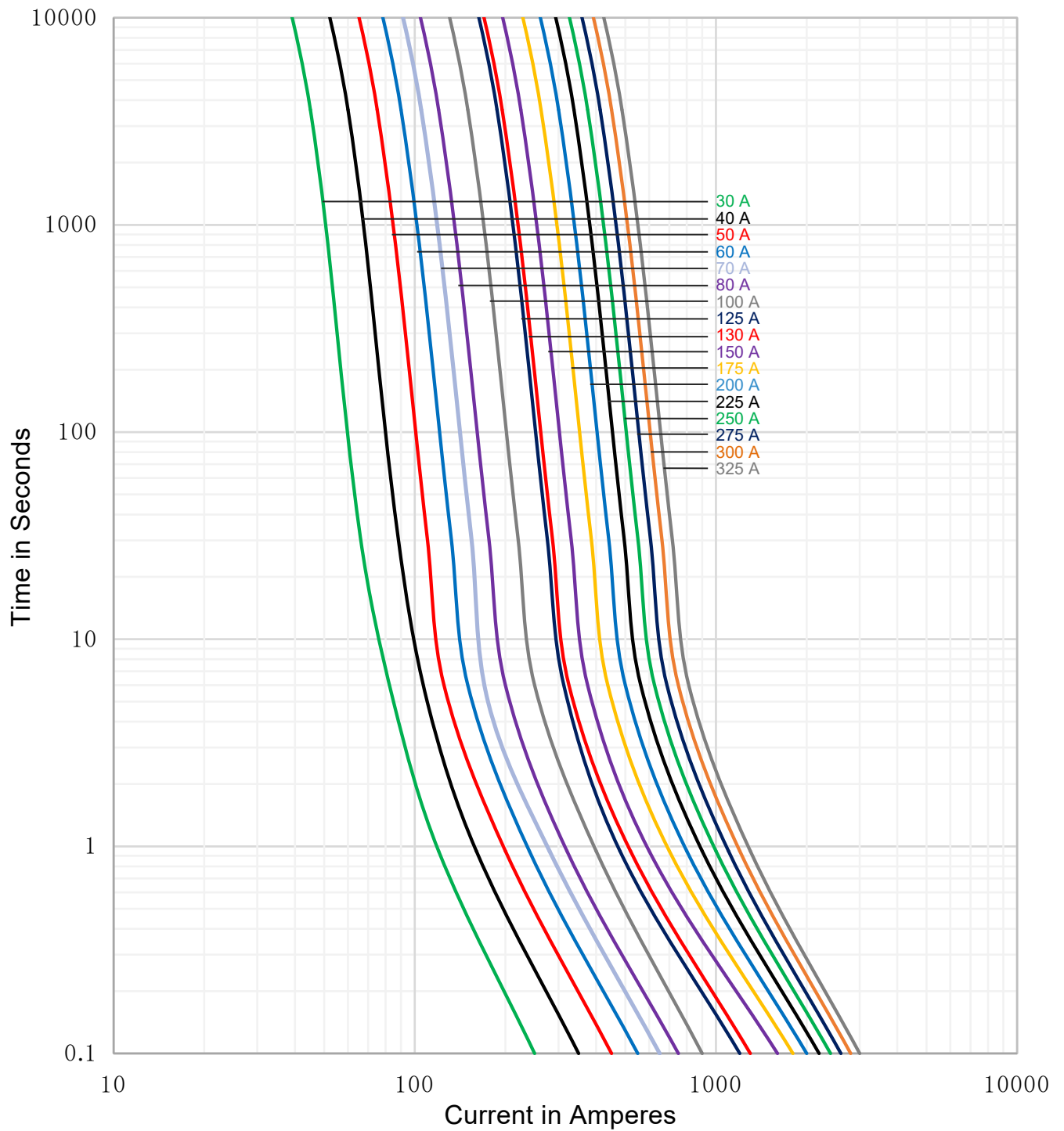
TIME CURRENT CURVE: 30-325 A





TIME CURRENT CURVE: 350-800 A

