

P & N-Channel Load Switch MOSFET

These miniature surface mount MOSFETs utilize High Cell Density process. Low $r_{DS(on)}$ assures minimal power loss and conserves energy, making this device ideal for use in power management circuitry. Typical applications are power switching, power management in portable and battery-powered products such as computers, printers, PCMCIA cards, cellular and cordless telephones.

- Low $r_{DS(on)}$ Provides Higher Efficiency and Extends Battery Life
- Miniature TSOP-6 Surface Mount Package Saves Board Space
- Control N-Channel MOSFET include a Zener Diode to protect the ESD requirement

PRODUCT SUMMARY		
V_{IN} (V)	$r_{DS(on)}$ (OHM)	I_L (A)
5.0	0.068 @ $V_{DROP} = 0.2V$	2.8
2.5	0.100 @ $V_{DROP} = 0.2V$	1.9

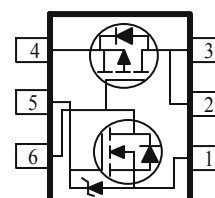
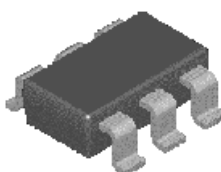

ABSOLUTE MAXIMUM RATINGS ($T_A = 25^\circ\text{C}$ UNLESS OTHERWISE NOTED)			
Parameter	Symbol	Rating	Units
Input Voltage Range	V_{IN}	2.5 - 8	V
On/Off Voltage Range	$V_{ON/OFF}$	1.5 - 8	
Continuous Load Current ^a	$T_A=25^\circ\text{C}$	-2.5	A
	$T_A=70^\circ\text{C}$	-1.8	
Pulsed Drain Current ^b	I_{LM}	-10	
Electrostatic Discharge Rating	ESD	6	KV
Power Dissipation ^a	$T_A=25^\circ\text{C}$	0.7	W
	$T_A=70^\circ\text{C}$	0.56	
Operating Junction and Storage Temperature Range	T_J, T_{stg}	-55 to 150	$^\circ\text{C}$

THERMAL RESISTANCE RATINGS			
Parameter	Symbol	Maximum	Units
Maximum Junction-to-Ambient ^a	$t \leq 5 \text{ sec}$	180	$^\circ\text{C}/\text{W}$
	Steady-State	235	

Notes

- Surface Mounted on 1" x 1" FR4 Board.
- Pulse width limited by maximum junction temperature

SPECIFICATIONS ($T_A = 25^{\circ}\text{C}$ UNLESS OTHERWISE NOTED)						
Parameter	Symbol	Test Conditions	Limits			Unit
			Min	Typ	Max	
Switching On Characteristics						
Conduction Voltage	V_{DROP}	$V_{\text{IN}} = 5\text{ V}, V_{\text{ON/OFF}} = 3.3\text{ V}, I_{\text{L}} = 2.8\text{ A}$		0.13	0.2	V
		$V_{\text{IN}} = 5\text{ V}, V_{\text{ON/OFF}} = 3.3\text{ V}, I_{\text{L}} = 1.9\text{ A}$		0.15	0.2	
Loading Current	I_{L}	$V_{\text{DROP}} = 0.2\text{ V}, V_{\text{IN}} = 5\text{ V}, V_{\text{ON/OFF}} = 3.3\text{ V}$	-2.8			A
		$V_{\text{DROP}} = 0.2\text{ V}, V_{\text{IN}} = 2.5\text{ V}, V_{\text{ON/OFF}} = 3.3\text{ V}$	-1.9			
Static On Resistance	$R_{(\text{ON})}$	$V_{\text{GS}} = -5\text{ V}, I_{\text{D}} = -2.5\text{ A}$		47	69	m Ω
		$V_{\text{GS}} = -2.5\text{ V}, I_{\text{D}} = -2.0\text{ A}$		73	100	
Switching Off Characteristics						
Forward Leakage Current	I_{FL}	$V_{\text{IN}} = 8\text{ V}, V_{\text{ON/OFF}} = 0\text{ V},$			1	μA

Application In Load Switch

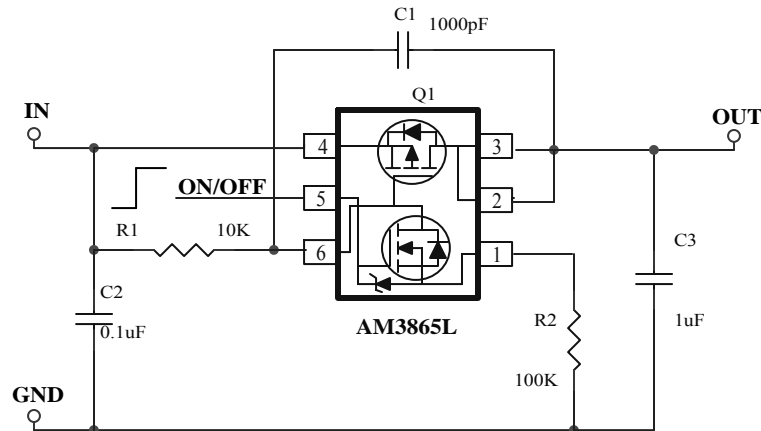

Notes

- a. Pulse test: $PW \leq 300\mu\text{s}$ duty cycle $\leq 2\%$.
- b. Guaranteed by design, not subject to production testing.

Analog Power (APL) reserves the right to make changes without further notice to any products herein. APL makes no warranty, representation or guarantee regarding the suitability of its products for any particular purpose, nor does APL assume any liability arising out of the application or use of any product or circuit, and specifically disclaims any and all liability, including without limitation special, consequential or incidental damages. "Typical" parameters which may be provided in APL data sheets and/or specifications can and do vary in different applications and actual performance may vary over time. All operating parameters, including "Typical" must be validated for each customer application by customer's technical experts. APL does not convey any license under its patent rights nor the rights of others. APL products are not designed, intended, or authorized for use as components in systems intended for surgical implant into the body, or other applications intended to support or sustain life, or for any other application in which the failure of the APL product could create a situation where personal injury or death may occur. Should Buyer purchase or use APL products for any such unintended or unauthorized application, Buyer shall indemnify and hold APL and its officers, employees, subsidiaries, affiliates, and distributors harmless against all claims, costs, damages, and expenses, and reasonable attorney fees arising out of, directly or indirectly, any claim of personal injury or death associated with such unintended or unauthorized use, even if such claim alleges that APL was negligent regarding the design or manufacture of the part. APL is an Equal Opportunity/Affirmative Action Employer.

Typical Electrical Characteristics

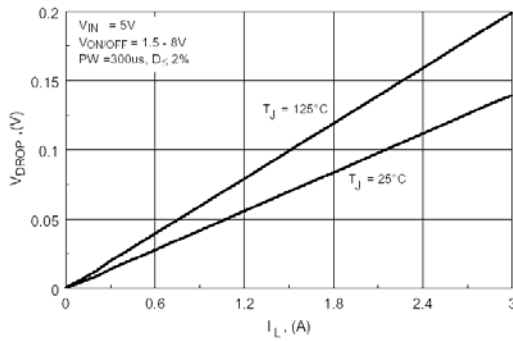

Figure 1. Conduction Voltage Drop Variation with Load Current.

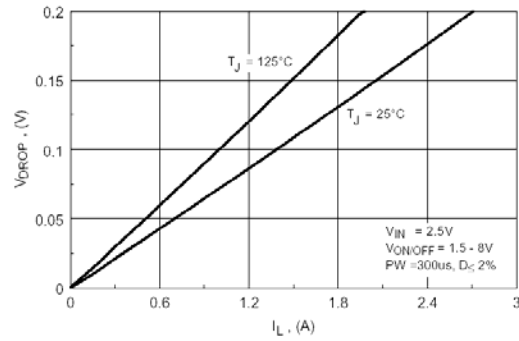

Figure 2. Conduction Voltage Drop Variation with Load Current.

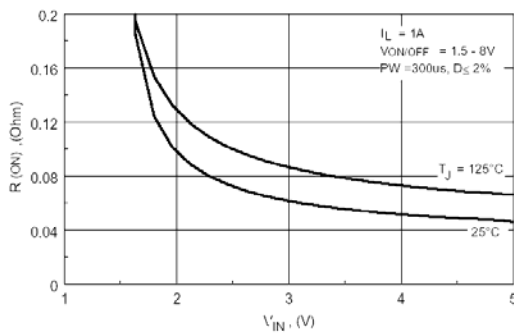

Figure 3. On-Resistance Variation with Input Voltage.

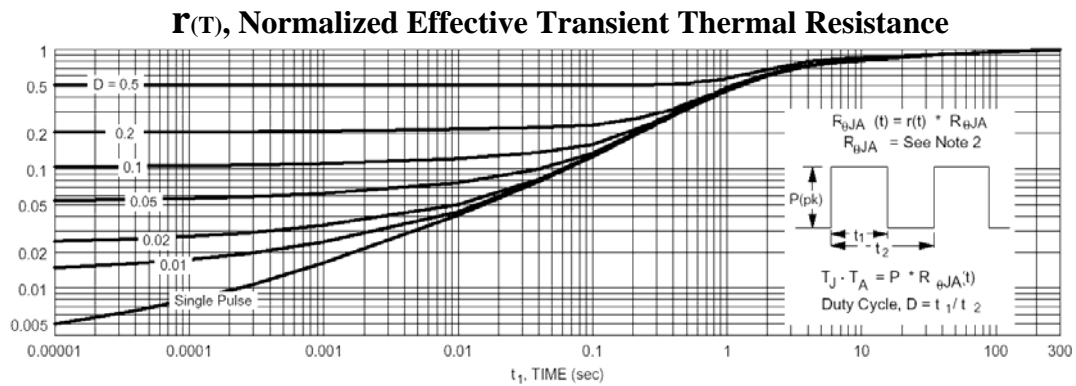
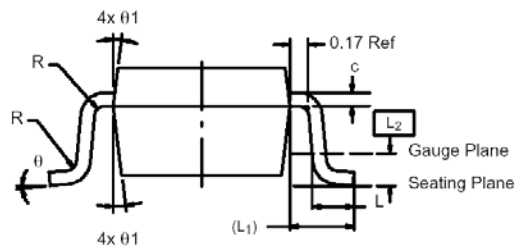
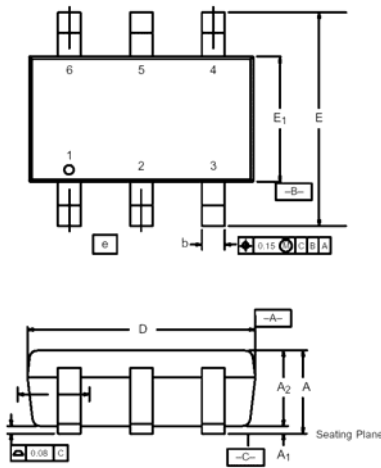

Figure 4. Transient Thermal Response Curve

Package Information

TSOP-6: 6LED



Dim	MILLIMETERS			INCHES		
	Min	Nom	Max	Min	Nom	Max
A	0.91	–	1.10	0.036	–	0.043
A ₁	0.01	–	0.10	0.0004	–	0.004
A ₂	0.84	–	1.00	0.033	0.038	0.039
b	0.30	0.32	0.45	0.012	0.013	0.018
c	0.10	0.15	0.20	0.004	0.006	0.008
D	2.95	3.05	3.10	0.116	0.120	0.122
E	2.70	2.85	2.98	0.106	0.112	0.117
E ₁	1.55	1.65	1.70	0.061	0.065	0.067
e	1.00 BSC			0.0394 BSC		
L	0.35	–	0.50	0.014	–	0.020
L ₁	0.60 Ref			0.024 Ref		
L ₂	0.25 BSC			0.010 BSC		
R	0.10	–	–	0.004	–	–
θ	0°	4°	8°	0°	4°	8°
θ ₁	7° Nom			7° Nom		