

## Alloy Molding Power Inductors



Chilisin's AME Series provides high current and low DCR in compact sizing with magnetically shielded construction. This power inductor is an excellent power solution for space-limited devices.

### Features

- Monolithic, magnetically shielded
- Compact sizing, high saturation current
- Minimum height=1.0mm Max

### Applications

- Smartphone
- Tablet PC
- Hard Disk of ultrabook
- LTE module
- Portable device

### Product Identification

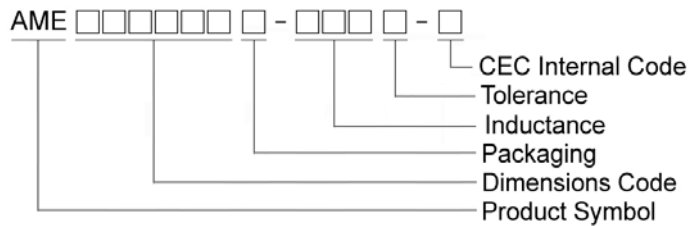

- Packaging : T : Tape and Reel , B : Bulk
- Tolerance : M =  $\pm 20\%$  , T =  $\pm 30\%$

### Shape and Dimensions

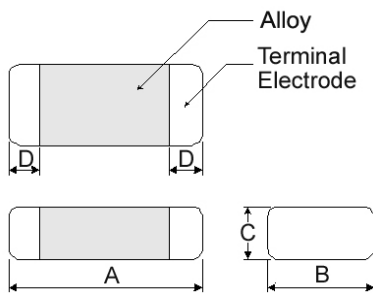

### Recommended Pattern

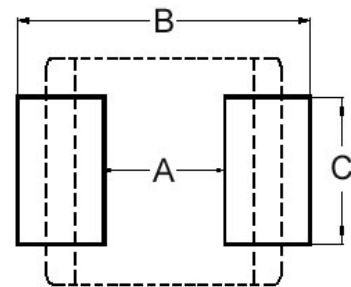

Dimensions in mm

TYPE	A	B	C	D
201610	2.0 $\pm$ 0.20	1.6 $\pm$ 0.20	1.0 Max	0.5 $\pm$ 0.3
252010	2.5 $\pm$ 0.2	2.0 $\pm$ 0.2	1.0 Max	0.6 $\pm$ 0.3
252012	2.5 $\pm$ 0.2	2.0 $\pm$ 0.2	1.2 Max	0.6 $\pm$ 0.3

Dimensions in mm

TYPE	A	B	C
201610	0.8 ~ 1.2	2.1 ~ 2.7	1.6 ~ 2.0
252010	1.2	2.8	2.0
252012	1.2	2.8	2.0

## Electrical Characteristics

Part Number	Inductance (uH)	Test Frequency (MHz)	Tolerance (±%)	RDC (Ω) Max	Isat (A) Max	Irms (A) Max
AME201610T-R47□-N	0.47	1	20,30	0.059	2.9	2.8
AME201610T-R68□-N	0.68	1	20,30	0.072	2.6	2.5
AME201610T-1R0□-N	1.0	1	20,30	0.096	2.2	2.0
AME201610T-1R5□-N	1.5	1	20,30	0.144	1.8	1.6
AME201610T-2R2□-N	2.2	1	20,30	0.204	1.5	1.2

- Tolerance : M = ±20% , T = ±30%
- Packaging: Clear tape and reel {standard}
- L : Agilent/HP4287A+16197A, 1MHz 500mV
- RDC : HP 4338B, or equivalent
- Rated Current : Applied the current to coils, the temperature rise shall not be more than 40°C
- Operating temperature range from -40°C to 125°C. (Including self - temperature rise)

**Test Instruments :** HP4287A Inductance / Material Analyzer

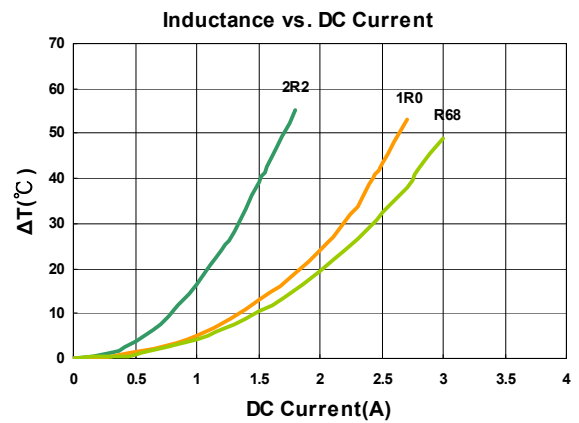
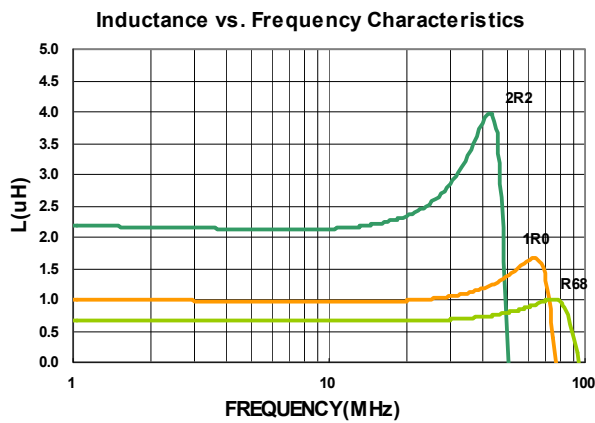

## Electrical Characteristics

Part Number	Inductance (uH)	Test Frequency (MHz)	Tolerance (±%)	RDC (Ω) Max	Isat (A) Max	Irms (A) Max
AME252010T-R47□-N	0.47	1	20,30	0.053	3.7	3.5
AME252010T-R68□-N	0.68	1	20,30	0.065	3.0	3.1
AME252010T-1R0□-N	1.0	1	20,30	0.078	2.7	2.5
AME252010T-1R5□-N	1.5	1	20,30	0.108	2.1	1.9
AME252010T-2R2□-N	2.2	1	20,30	0.156	1.9	1.5

- Tolerance : M = ±20% , T = ±30%
- Packaging: Clear tape and reel {standard}
- L : Agilent/HP4287A+16197A, 1MHz 500mV
- RDC : HP 4338B, or equivalent
- Rated Current : Applied the current to coils, the temperature rise shall not be more than 40°C
- Operating temperature range from -40°C to 125°C. (Including self - temperature rise)

**Test Instruments :** HP4287A Inductance / Material Analyzer

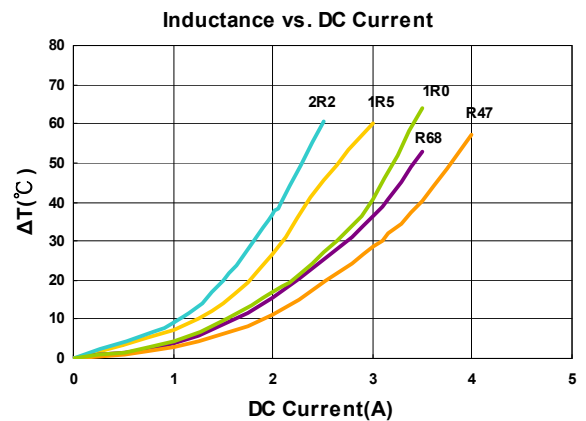
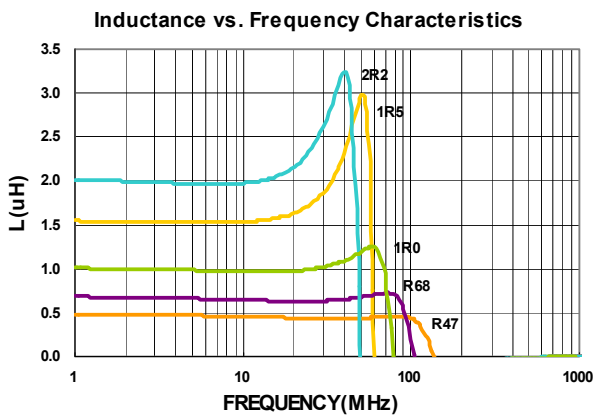

## Electrical Characteristics

Part Number	Inductance (uH)	Test Frequency (MHz)	Tolerance (±%)	RDC (Ω) Max	Isat (A) Max	Irms (A) Max
AME252012T-R47□-N	0.47	1	20,30	0.04	4.2	3.7
AME252012T-R68□-N	0.68	1	20,30	0.047	3.8	3.3
AME252012T-1R0□-N	1.0	1	20,30	0.06	3.0	3.0
AME252012T-2R2□-N	2.2	1	20,30	0.11	2.2	2.0

- Tolerance : M = ±20% , T = ±30%
- Packaging: Clear tape and reel {standard}
- L : Agilent/HP4287A+16197A, 1MHz 500mV
- RDC : HP 4338B, or equivalent
- Rated Current : Applied the current to coils, the temperature rise shall not be more than 40°C
- Operating temperature range from -40°C to 125°C. (Including self - temperature rise)

**Test Instruments :** HP4287A Inductance / Material Analyzer

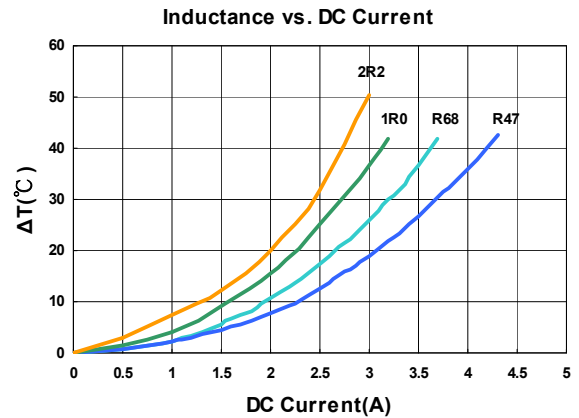
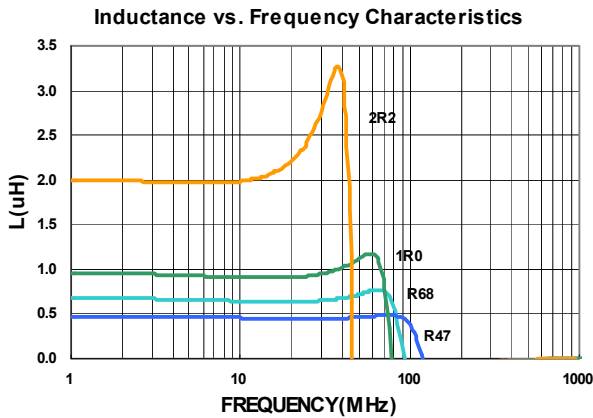

Packaging Specifications

Tape Dimensions

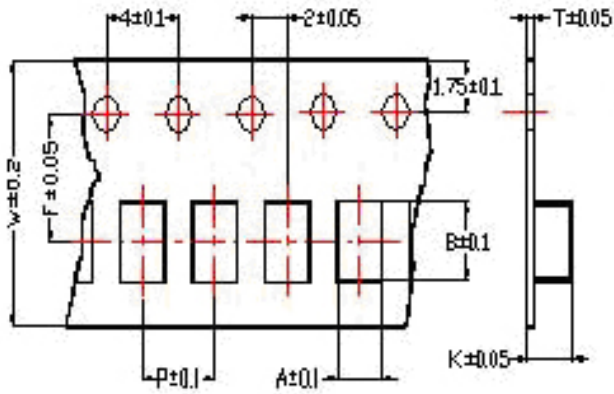

Tape Material

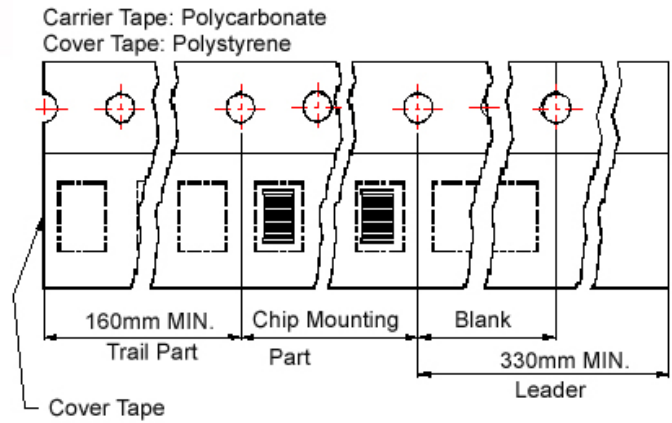

Reel Dimensions

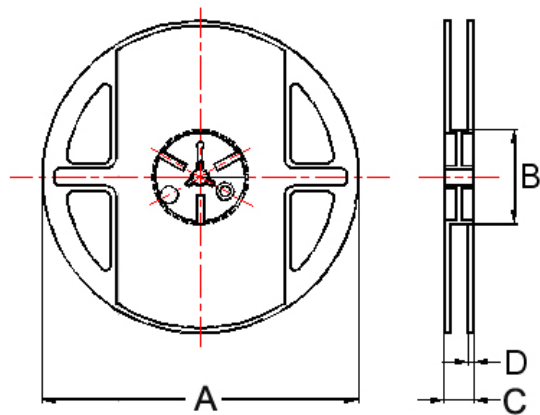

Dimensions in mm

TYPE	Tape Dimensions							Reel Dimensions				Quantity
	A	B	T	W	P	F	K	A	B	C	D	PCS / REEL
201610	1.80	2.2	0.22	8.0	4.0	3.5	1.15	178	60	12	1.5	4000
252010	2.25	2.8	0.25	8.0	4.0	3.5	1.15	178	60	12	1.5	3000
252012	2.25	2.8	0.25	8.0	4.0	3.5	1.35	178	60	12	1.5	3000