

Features

General

- Single Chip Turnkey Solution
- Strong Challenge-Response Authentication Using Digital Signature
- Digital Signature (3DES MAC, RSA PKCS#1, ECDSA)
- Encryption (3DES, RSA PKCS#1)
- Message Digest (SHA-1, SHA-256)
- Public Key Pair Generation (RSA including CRT or ECC)
- High Speed Hardware Cryptographic Engines
 - Hardware 3DES Crypto Accelerator (112-bits keys)
 - Hardware 32-bit Public Key Crypto Accelerator (RSA 2048 bits, ECC 239 bits)
- SecureAVR™ 8-/16-bit RISC CPU
- Internal 8K bytes EEPROM (10 years data retention, 500K cycles) with password protected file system
- Serial Peripheral Interface (SPI) or UART * Interface and 1 GPIO
- Hardware True Random Number Generator (RNG)
- Secure Architecture Based on ATMEL secureAVR Microcontroller (AT90SC)
 - To meet FIPS140-2 requirements
 - To meet Common Criteria EAL5+ requirements
- Operating Range 1.62V to 5.5V
- Lower Power Mode
- 44-QFN and 8-SOIC* Packages

Description

Based on ATMEL Smart Card chip design expertise and leadership. The AT98SC008CT is a fully integrated secure solution (Hardware and Firmware) designed for embedded systems (Servers/Routers, Peripherals, Set Top Boxes, PDAs, etc.).

This secure chip has been designed to serve anti-cloning, access control and hardware protection applications. It provides an embedded crypto application allowing a strong authentication, digital signature, encryption, message digest and secure storage of user data (keys, etc.).

The AT98SC008CT includes a hardware Triple DES supporting symmetric-key operations and a 32-bit crypto accelerator for public-key operations (RSA and Elliptic Curves signature algorithms).

The chip comprises also a hardware Random Number Generator used to generate on-chip public keys and challenges during authentication process.

Communication with the chip occurs through a SPI interface running up to 2 Mbps (UART interface will be implemented in the future).

In addition to the crypto application, the chip provides a robust communication protocol, a persistent data storage with secure memory management (access control, anti-tearing), and an administration application to manage contents and configuration of the chip.

State-of-the-art security features embedded in Smart Cards secure products dedicated for Banking, ID and Pay-TV are also included in the AT98SC008CT. Including power and frequency protection logic, logical scrambling on data and address, power analysis countermeasures and EEPROM access control.

Note: * Introduced in future product



Secure ASSP

AT98SC008CT Summary

6526AS-SMIC-25Jan06



Note: This is a summary document. A complete document will be available under NDA. For more information, please contact your local Atmel sales office.

The AT90SC008CT is offered to OEM manufacturers as a turnkey and easy-to-use solution, including the firmware integrated on the chip. ATMEL provides an evaluation kit, a full datasheet, and an application note for customer integration support.

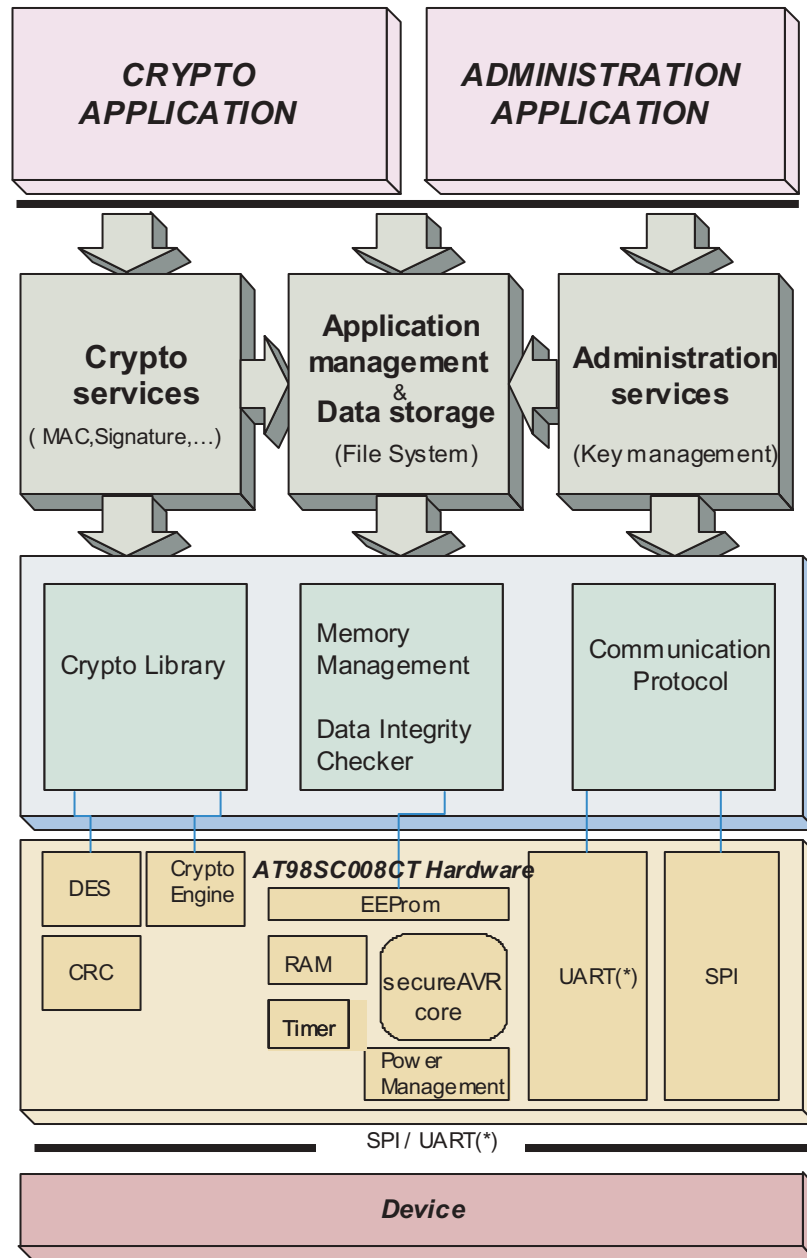
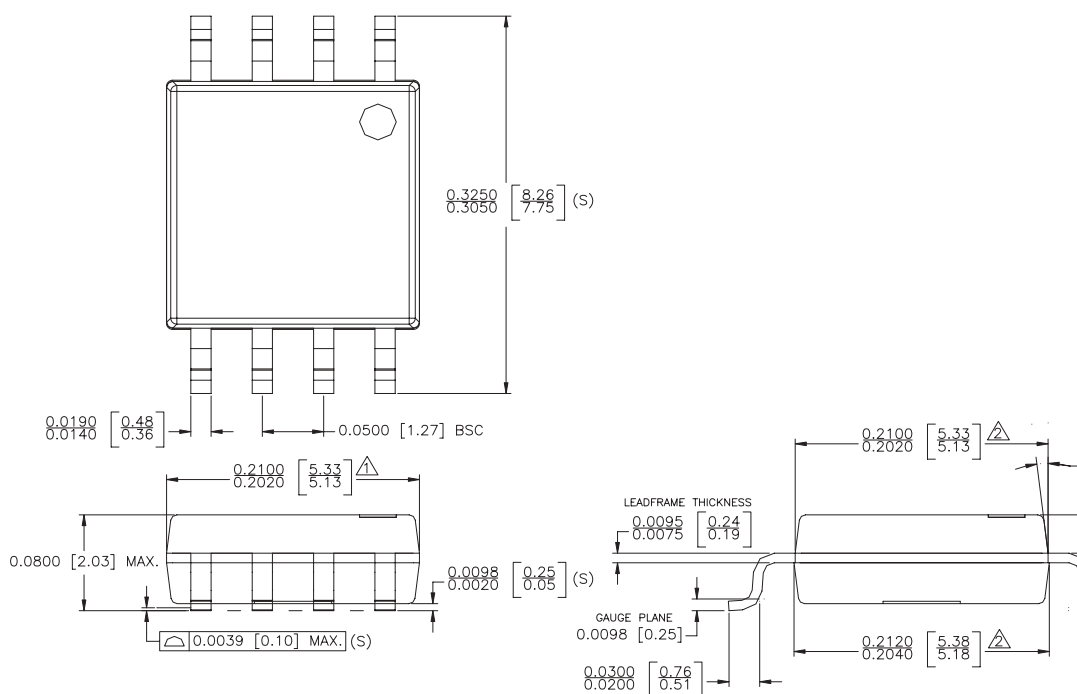
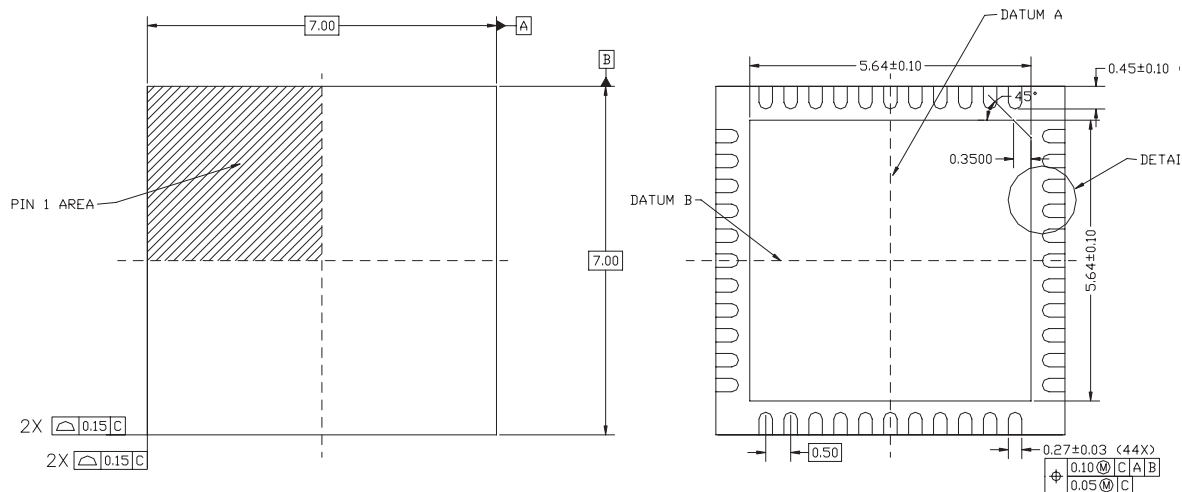

Figure 1. AT98SC008CT Hardware and Software Diagram

Note: * Introduced in future product

8 leads SOIC (207 mils body) ***44-QFN (Quad Flat No Lead)****Figure 2. Package Drawings**

Note: * Introduced in future product



Atmel Corporation

2325 Orchard Parkway
San Jose, CA 95131, USA
Tel: 1(408) 441-0311
Fax: 1(408) 487-2600

Regional Headquarters

Europe

Atmel Sarl
Route des Arsenalux 41
Case Postale 80
CH-1705 Fribourg
Switzerland
Tel: (41) 26-426-5555
Fax: (41) 26-426-5500

Asia

Room 1219
Chinachem Golden Plaza
77 Mody Road Tsimshatsui
East Kowloon
Hong Kong
Tel: (852) 2721-9778
Fax: (852) 2722-1369

Japan

9F, Tonetsu Shinkawa Bldg.
1-24-8 Shinkawa
Chuo-ku, Tokyo 104-0033
Japan
Tel: (81) 3-3523-3551
Fax: (81) 3-3523-7581

Atmel Operations

Memory

2325 Orchard Parkway
San Jose, CA 95131, USA
Tel: 1(408) 441-0311
Fax: 1(408) 436-4314

Microcontrollers

2325 Orchard Parkway
San Jose, CA 95131, USA
Tel: 1(408) 441-0311
Fax: 1(408) 436-4314

La Chantrerie
BP 70602
44306 Nantes Cedex 3, France
Tel: (33) 2-40-18-18-18
Fax: (33) 2-40-18-19-60

ASIC/ASSP/Smart Cards

Zone Industrielle
13106 Rousset Cedex, France
Tel: (33) 4-42-53-60-00
Fax: (33) 4-42-53-60-01

1150 East Cheyenne Mtn. Blvd.
Colorado Springs, CO 80906, USA
Tel: 1(719) 576-3300
Fax: 1(719) 540-1759

Scottish Enterprise Technology Park
Maxwell Building
East Kilbride G75 0QR, Scotland
Tel: (44) 1355-803-000
Fax: (44) 1355-242-743

RF/Automotive

Theresienstrasse 2
Postfach 3535
74025 Heilbronn, Germany
Tel: (49) 71-31-67-0
Fax: (49) 71-31-67-2340

1150 East Cheyenne Mtn. Blvd.
Colorado Springs, CO 80906, USA
Tel: 1(719) 576-3300
Fax: 1(719) 540-1759

Biometrics/Imaging/Hi-Rel MPU/ High Speed Converters/RF Datacom

Avenue de Rochepleine
BP 123
38521 Saint-Egreve Cedex, France
Tel: (33) 4-76-58-30-00
Fax: (33) 4-76-58-34-80

Literature Requests

www.atmel.com/literature

Disclaimer: The information in this document is provided in connection with Atmel products. No license, express or implied, by estoppel or otherwise, to any intellectual property right is granted by this document or in connection with the sale of Atmel products. **EXCEPT AS SET FORTH IN ATMEL'S TERMS AND CONDITIONS OF SALE LOCATED ON ATMEL'S WEB SITE, ATMEL ASSUMES NO LIABILITY WHATSOEVER AND DISCLAIMS ANY EXPRESS, IMPLIED OR STATUTORY WARRANTY RELATING TO ITS PRODUCTS INCLUDING, BUT NOT LIMITED TO, THE IMPLIED WARRANTY OF MERCHANTABILITY, FITNESS FOR A PARTICULAR PURPOSE, OR NON-INFRINGEMENT. IN NO EVENT SHALL ATMEL BE LIABLE FOR ANY DIRECT, INDIRECT, CONSEQUENTIAL, PUNITIVE, SPECIAL OR INCIDENTAL DAMAGES (INCLUDING, WITHOUT LIMITATION, DAMAGES FOR LOSS OF PROFITS, BUSINESS INTERRUPTION, OR LOSS OF INFORMATION) ARISING OUT OF THE USE OR INABILITY TO USE THIS DOCUMENT, EVEN IF ATMEL HAS BEEN ADVISED OF THE POSSIBILITY OF SUCH DAMAGES.** Atmel makes no representations or warranties with respect to the accuracy or completeness of the contents of this document and reserves the right to make changes to specifications and product descriptions at any time without notice. Atmel does not make any commitment to update the information contained herein. Unless specifically provided otherwise, Atmel products are not suitable for, and shall not be used in, automotive applications. Atmel's products are not intended, authorized, or warranted for use as components in applications intended to support or sustain life.

© Atmel Corporation 2006. All rights reserved. Atmel®, logo and combinations thereof, and others are registered trademarks. Everywhere You Are®, secureAVR™ are the trademark of Atmel Corporation.

Other terms and product names may be trademarks of others.



Printed on recycled paper.

www.DataSheet4U.com
6526AS-SMIC-25Jan06