

## SCHOTTKY BARRIER RECTIFIERS

## B220A--B260A

### FEATURES

- For surface mounted applications
- Low profile package
- Built-in strain relief
- Metal silicon junction, majority carrier conduction
- High surge capability
- Low power loss, high efficiency
- For use in low voltage high frequency inverters, free wheeling and polarity protection applications
- Guardring for overvoltage protection
- Plastic package has Underwriters Laboratory Flammability Classification 94V-0
- High temperature soldering guaranteed:250°C/10 seconds at terminals



Lead-free

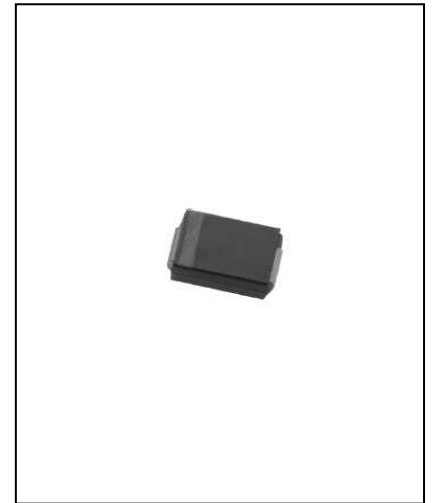

### MECHANICAL DATA

- Case: JEDEC SMA, molded plastic over passivated chip
- Terminals: Solder plated, solderable per MIL-STD-750, Method 2026
- Polarity: Color band denotes cathode end
- Weight: 0.002 ounces, 0.064 gram

### MAXIMUM RATINGS AND ELECTRICAL CHARACTERISTICS

Ratings at 25°C ambient temperature unless otherwise specified

|   |                 | B220A       | B230A | B240A | B250A | B260A | UNITS |
|---|-----------------|-------------|-------|-------|-------|-------|-------|
| Maximum repetitive peak reverse voltage   | $V_{RRM}$       | 20          | 30    | 40    | 50    | 60    | V     |
| Maximum RMS voltage   | $V_{RWS}$       | 14          | 21    | 28    | 35    | 42    | V     |
| Maximum DC blocking voltage   | $V_{DC}$        | 20          | 30    | 40    | 45    | 50    | V     |
| Maximum average for word rectified current at $T_L$<br>(SEE FIG.1)  | $I_{F(AV)}$     | 2.0         |       |       |       |       | A     |
| Peak forward surge current<br>8.3ms single half-sine-wave   | $I_{FSM}$       | 50.0        |       |       |       |       | A     |
| Maximum instantaneous forward voltage<br>at 2.0A(NOTE1)   | $V_F$           | 0.50        |       |       | 0.70  |       | V     |
| Maximum DC reverse current @ $T_A=25^\circ C$<br>at rated DC blockjng voltage @ $T_A=100^\circ C$ (NOTE1) | $I_R$           | 0.5<br>20.0 |       |       |       |       | mA    |
| Typical junction capacitance (NOTE2)  | $R_{\theta JL}$ | 15.0        |       |       |       |       | °C/W  |
| Operating temperature range   | $T_J$           | -55--- +125 |       |       |       |       | °C    |
| Storage temperature range   | $T_{STG}$       | -55--- +125 |       |       |       |       | °C    |

NOTE: 1.Pulse test:300 μ S pulse width,1%duty cycle

2. P.C.B. mounted with 0.55"X0.55"(14.0X14.0mm2) copper pad areas

## SCHOTTKY BARRIER RECTIFIERS

## B220A--B260A

### PACKAGE OUTLINE DIMENSIONS

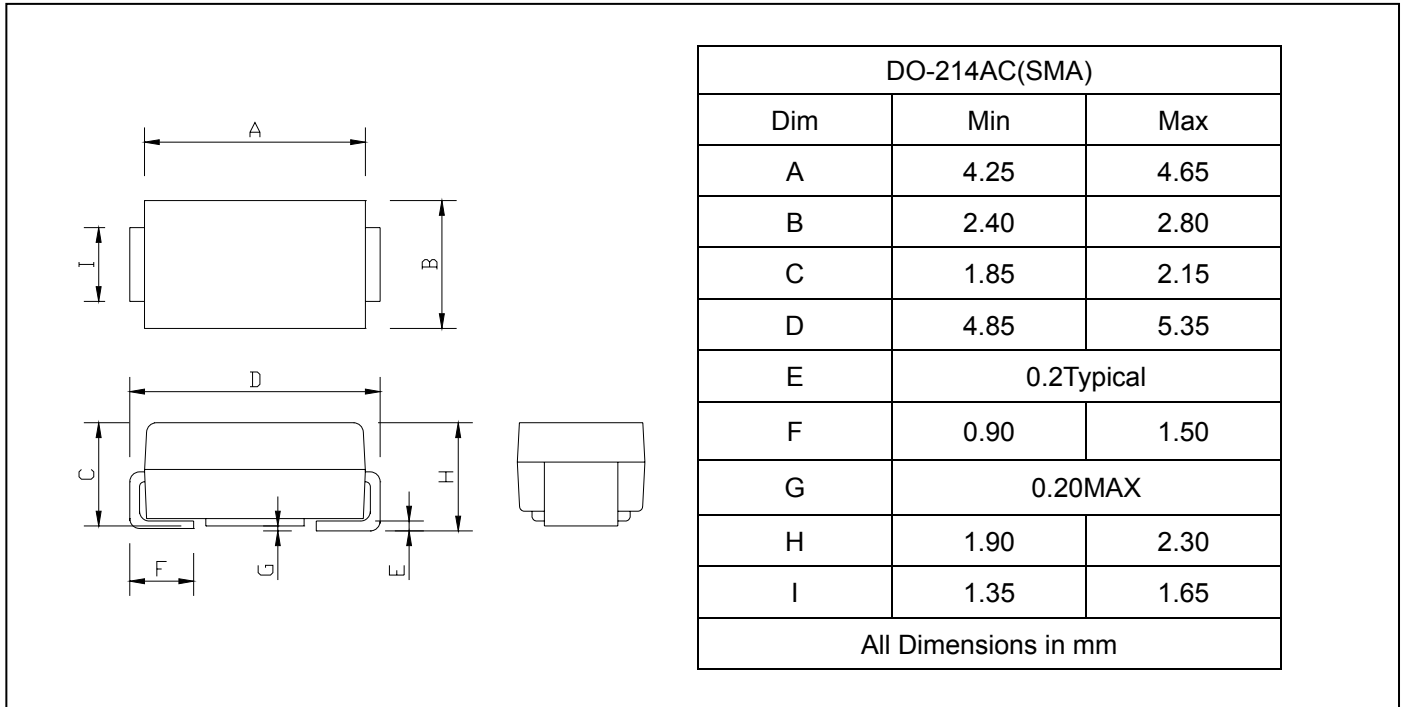

### SOLDERING FOOTPRINT

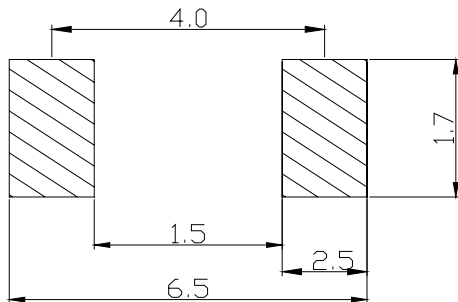

Unit : mm

### PACKAGE INFORMATION

| Device       | Package       | Shipping       |
|--------------|---------------|----------------|
| B220A--B260A | DO-214AC(SMA) | 5000/Tape&Reel |

## SCHOTTKY BARRIER RECTIFIERS

## B220A--B260A

**FIG.1 – FORWARD DERATING CURVE**

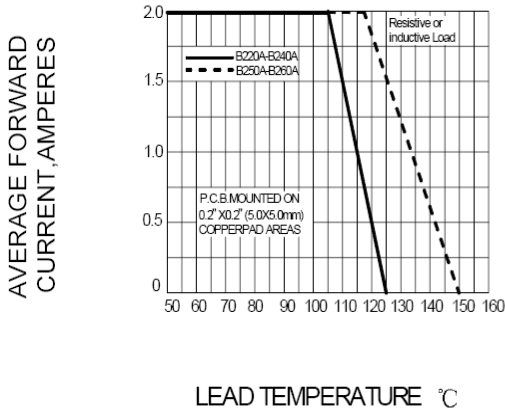

**FIG.2- PEAK FORWARD SURGE CURRENT**

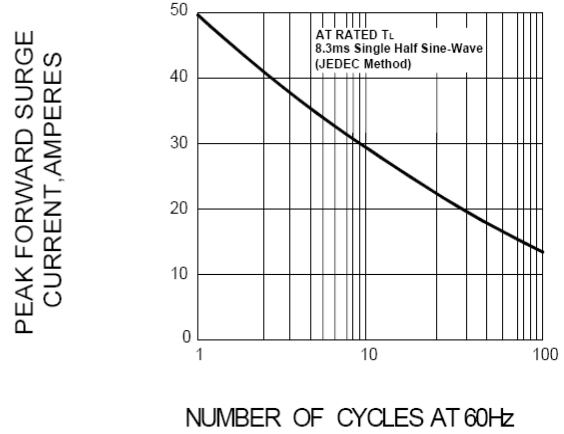

**FIG.3 – TYPICAL FORWARD CHARACTERISTICS**

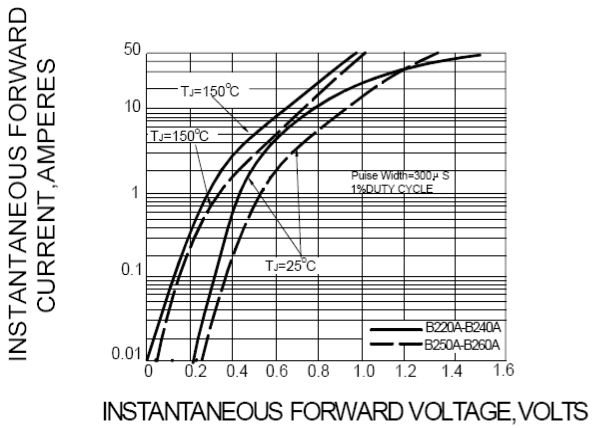

**FIG.4 – TYPICAL REVERSE CHARACTERISTICS**

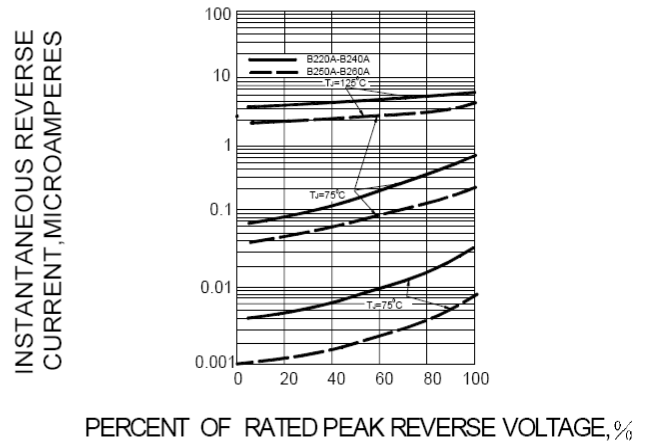

**FIG.5-TYPICAL JUNCTION CAPACITANCE**

