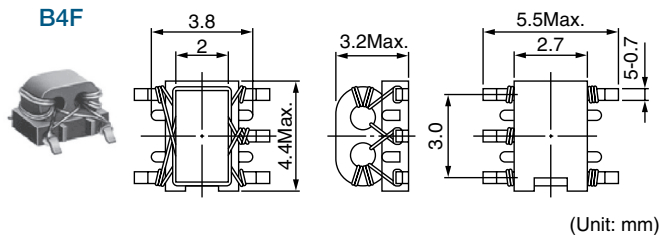
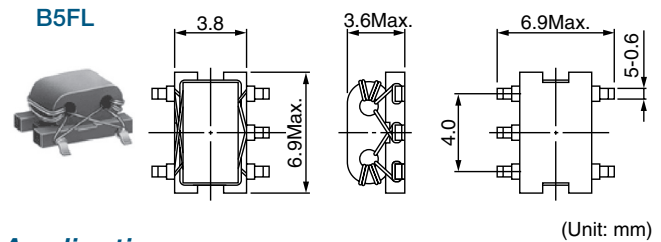

**TYPE B4F: Surface Mount**

**Features**

- Pair wire coil for high stability.
- Base pin terminal treated, allowing mounting 'as is' on a PCB.

**TYPE B5FL: Surface Mount**

**Applications**

- Double balance mixers, broad-band transformers, impedance transformers, etc.

**STANDARD TRANSFORMERS SELECTION GUIDE**
**TYPE B4F**

TOKO Part Number	Number of Turns per Winding	Operating Frequency Range (MHz)	Insertion Loss (dB)	Fig.
<b>Double Balanced Mixer</b>				
617DB-1007	2	25~2000	3	1
617DB-1009	3	6~2000	3	1
617DB-1006	3	150~2300	3	1
617DB-1010	4	3.5~2000	3	1
617DB-1018	5	2~2000	3	1
<b>Frequency Mixer</b>				
617PT-1025	1	—	—	2
617PT-1019	2	8~750	3	2
617PT-1026	3	3.5~700	3	2
<b>Balun Transformer</b>				
617DB-1021	1½	20~750	3	3
617DB-1022	2½	4.5~3300	3	3
617DB-1023	3½	2.3~2700	3	3
617DB-1024	4½	1.5~2400	3	3
<b>Distributor</b>				
617DS-1079	2	1300~1700	IN to OUT-1,2 4.5dB max.	5
617DS-1076	3	800~1000	IN to OUT-2 (ISOLATION) 15dB min.	5

**TYPE B5FL**

TOKO Part Number	Number of Turns per Winding	Operating Frequency Range (MHz)	Insertion Loss (dB)	Fig.
<b>Double Balanced Mixer</b>				
616DB-1003	2	30~850	3	1
616DB-1004	3	6.5~1000	3	1
616DB-1007	4	3.5~1600	3	1
616DB-1008	5	2.5~1500	3	1
<b>Frequency Mixer</b>				
616PT-1027	1	—	3	2
616PT-1028	2	8~550	3	2
616PT-1029	3	3.5~500	3	2
616PT-1030	4	2~370	3	2
616PT-1037	1	—	3	2
616PT-1038	2	500~850	3	2
616PT-1039	3	240~500	3	2
616PT-1040	4	85~380	3	2
<b>Balun Transformer</b>				
616DB-1048	1½	5.5~850	3	3
616DB-1049	2½	2.5~2000	3	3
616DB-1050	3½	1.2~1700	3	3
616DB-1051	4½	0.8~1400	3	3
616DB-1078	5½	0.6~1300	3	3
<b>Balun Transformer</b>				
616DB-1053	1½	160~2200	3	4
616DB-1017	2½	55~1700	3	4
616DB-1054	3½	30~1400	3	4

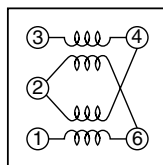
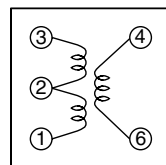
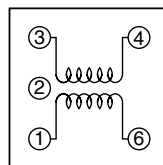
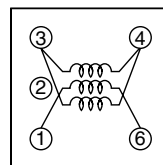
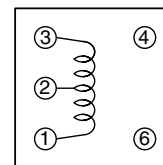
**Pin Connections**

 Double balanced  
 Fig. 1

 Mixer transformer  
 Fig. 2

 Balun transformer  
 Fig. 3

 Balun transformer  
 Fig. 4

 Distributor  
 Fig. 5