

Plastic-Encapsulate Schottky Barrier Diode

Features

- ◆ High Current Capability
- ◆ Low Forward Voltage Drop

Mechanical Data

- ◆ SOD-323 Small Outline Plastic Package
- ◆ Polarity: Color band denotes cathode end
- ◆ EpoxyUL:94V-0
- ◆ Mounting Position:Any

SOD-323

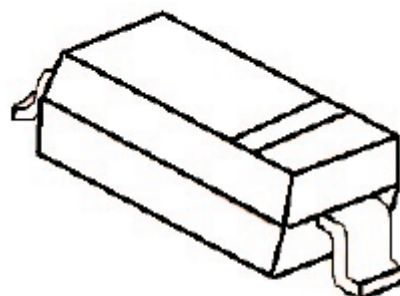

Marking: B5817WS: SJ
B5818WS: SK
B5819WS: SL

Maximum Ratings and Thermal Characteristics

Ratings at 25°C ambient temperature unless otherwise specified.

Parameter	Symbol	B5817WS	B5818WS	B5819WS	UNITS
Maximum recurrent peak reverse voltage	V_{RRM}	20	30	40	V
Maximum RMS voltage	V_{RMS}	14	21	28	V
Maximum DC blocking voltage	V_{DC}	20	30	40	V
Maximum average forward rectified Current .	I_{FM}	1.0			A
Peak forward surge current 8.3 ms single half sine -wave	I_{FSM}	9			A
Typical Current Squared Time	I^2T	0.337			A ² S
Typical thermal resistance	$R_{\theta JA}$	400			°C/W
Power Dissipation	PD	250			mW
Storage temperature range	T_{STG}	-50-+150			°C

Electrical Characteristics

Ratings at 25°C ambient temperature unless otherwise specified.

Parameter	Symbol	Test conditions	B5817WS	B5818WS	B5819WS	UNITS
Maximum forward voltage	V_F	IF=1.0A IF=3.0A	0.450 0.750	0.550 0.875	0.600 0.900	V
Maximum reverse breakdown voltage	V_R	IR=1mA	20	30	40	V
Maximum reverse current	I_R	VR=20V B5817WS VR=30V B5818WS VR=40V B5819WS	1.0			mA
Type junction capacitance	C_J	VR=4.0V,f=1MHz	120			pF

RATING AND CHARACTERISTICS CURVES (B5817WS THRU B5819WS)

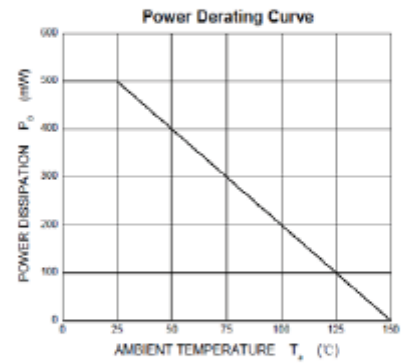
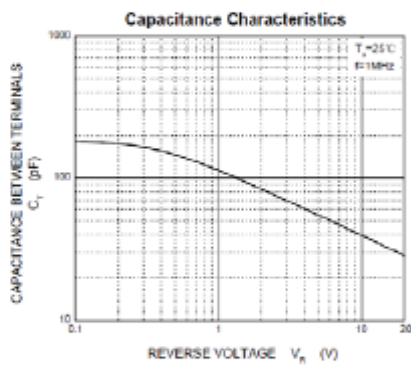
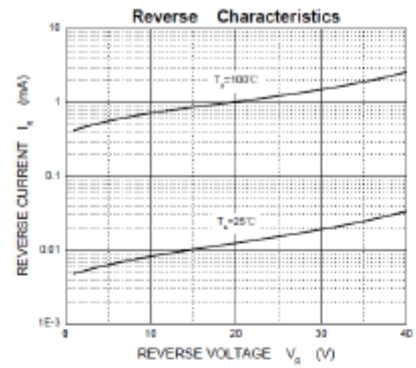
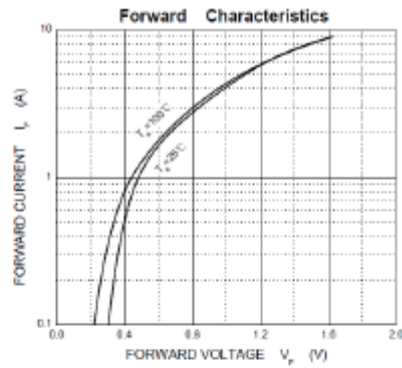

SOD-323 PACKAGE OUTLINE Plastic surface mounted package

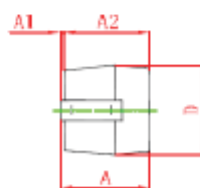
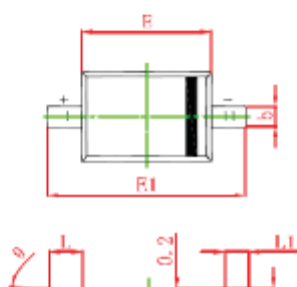

Symbol	Min.(mm)	Max.(mm)
A		1.000
A1	0.000	0.100
A2	0.800	0.900
b	0.250	0.350
c	0.080	0.150
D	1.200	1.400
E	1.600	1.800
E1	2.500	2.700

SOD-323

Mechanical Data

Case: SOD-323

Case Material: Molded Plastic. UL Flammability

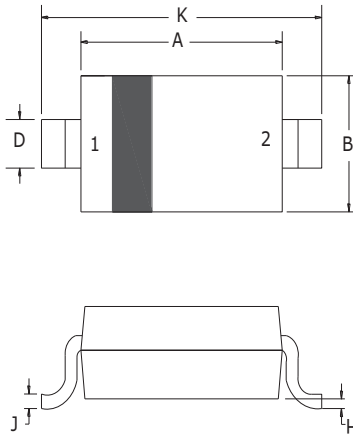

Dim	Millimeters		Inches	
	Min	Max	Min	Max
A	1.60	1.80	0.063	0.071
B	1.2	1.40	0.047	0.055
C	0.80	0.90	0.031	0.035
D	0.25	0.35	0.010	0.014
E	0.15REF		0.006REF	
H	0	0.10	0	0.004
J	0.08	0.15	0.003	0.006
K	2.50	2.70	0.098	0.106

Recommended Pad outline

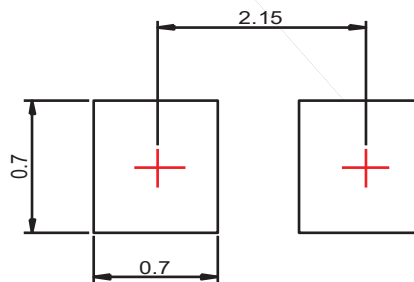

SOD-323 Reel Dim

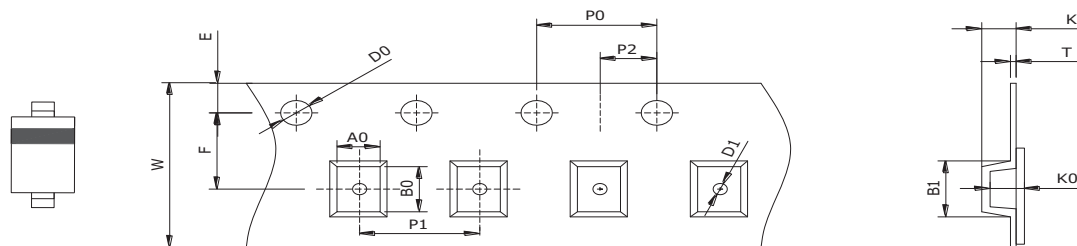

Package	Diode Size	Pocket Size B0×A0×K0(mm)	Tape Width	Reel Diameter	Quantity Per Reel	P0	P1
SOD-323	2.60×1.40×1.05	3.30×1.50×1.25	8mm	178mm(7")	3000	4mm	4mm
D0	D1	E	F	K	T	W	
1.5mm	1.05mm	1.75mm	3.5mm	0.95mm	0.2mm	8mm	

Packing

Reel	Reel Size	Box (Box Size)	Carton(Carton Size)
3000pcs	7inch	45,000pcs(203*203*195)	180,000pcs(438*438*220)

DISCLAIMER NOTICE

Rectron Inc reserves the right to make changes without notice to any product specification herein, to make corrections, modifications, enhancements or other changes. Rectron Inc or anyone on its behalf assumes no responsibility or liability for any errors or inaccuracies. Data sheet specifications and its information contained are intended to provide a product description only. "Typical" parameters which may be included on RECTRON data sheets and/ or specifications can and do vary in different applications and actual performance may vary over time. Rectron Inc does not assume any liability arising out of the application or use of any product or circuit.

Rectron products are not designed, intended or authorized for use in medical, life-saving implant or other applications intended for life-sustaining or other related applications where a failure or malfunction of component or circuitry may directly or indirectly cause injury or threaten a life without expressed written approval of Rectron Inc. Customers using or selling Rectron components for use in such applications do so at their own risk and shall agree to fully indemnify Rectron Inc and its subsidiaries harmless against all claims, damages and expenditures.