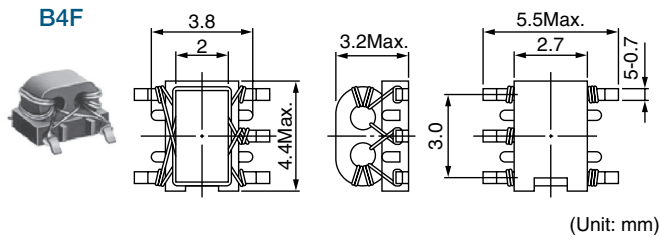
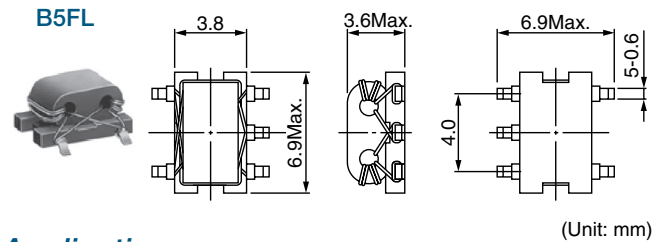

TYPE B4F: Surface Mount**Features**

- Pair wire coil for high stability.
- Base pin terminal treated, allowing mounting 'as is' on a PCB.

TYPE B5FL: Surface Mount**Applications**

- Double balance mixers, broad-band transformers, impedance transformers, etc.

STANDARD TRANSFORMERS SELECTION GUIDE**TYPE B4F**

| TOKO Part Number | Number of Turns per Winding | Operating Frequency Range (MHz) | Insertion Loss (dB) | Fig. |
|------------------------------|-----------------------------|---------------------------------|---|------|
| Double Balanced Mixer | | | | |
| 617DB-1007 | 2 | 25~2000 | 3 | 1 |
| 617DB-1009 | 3 | 6~2000 | 3 | 1 |
| 617DB-1006 | 3 | 150~2300 | 3 | 1 |
| 617DB-1010 | 4 | 3.5~2000 | 3 | 1 |
| 617DB-1018 | 5 | 2~2000 | 3 | 1 |
| Frequency Mixer | | | | |
| 617PT-1025 | 1 | — | — | 2 |
| 617PT-1019 | 2 | 8~750 | 3 | 2 |
| 617PT-1026 | 3 | 3.5~700 | 3 | 2 |
| Balun Transformer | | | | |
| 617DB-1021 | 1½ | 20~750 | 3 | 3 |
| 617DB-1022 | 2½ | 4.5~3300 | 3 | 3 |
| 617DB-1023 | 3½ | 2.3~2700 | 3 | 3 |
| 617DB-1024 | 4½ | 1.5~2400 | 3 | 3 |
| Distributor | | | | |
| 617DS-1079 | 2 | 1300~1700 | IN to OUT-1,2 4.5dB max. | 5 |
| 617DS-1076 | 3 | 800~1000 | IN to OUT-2 (ISOLATION) 15dB min. | 5 |

TYPE B5FL

| TOKO Part Number | Number of Turns per Winding | Operating Frequency Range (MHz) | Insertion Loss (dB) | Fig. |
|------------------------------|-----------------------------|---------------------------------|---------------------|------|
| Double Balanced Mixer | | | | |
| 616DB-1003 | 2 | 30~850 | 3 | 1 |
| 616DB-1004 | 3 | 6.5~1000 | 3 | 1 |
| 616DB-1007 | 4 | 3.5~1600 | 3 | 1 |
| 616DB-1008 | 5 | 2.5~1500 | 3 | 1 |
| Frequency Mixer | | | | |
| 616PT-1027 | 1 | — | 3 | 2 |
| 616PT-1028 | 2 | 8~550 | 3 | 2 |
| 616PT-1029 | 3 | 3.5~500 | 3 | 2 |
| 616PT-1030 | 4 | 2~370 | 3 | 2 |
| 616PT-1037 | 1 | — | 3 | 2 |
| 616PT-1038 | 2 | 500~850 | 3 | 2 |
| 616PT-1039 | 3 | 240~500 | 3 | 2 |
| 616PT-1040 | 4 | 85~380 | 3 | 2 |
| Balun Transformer | | | | |
| 616DB-1048 | 1½ | 5.5~850 | 3 | 3 |
| 616DB-1049 | 2½ | 2.5~2000 | 3 | 3 |
| 616DB-1050 | 3½ | 1.2~1700 | 3 | 3 |
| 616DB-1051 | 4½ | 0.8~1400 | 3 | 3 |
| 616DB-1078 | 5½ | 0.6~1300 | 3 | 3 |
| Balun Transformer | | | | |
| 616DB-1053 | 1½ | 160~2200 | 3 | 4 |
| 616DB-1017 | 2½ | 55~1700 | 3 | 4 |
| 616DB-1054 | 3½ | 30~1400 | 3 | 4 |

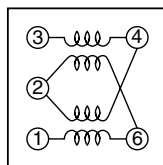
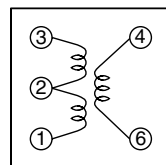
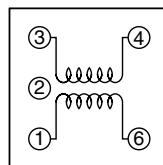
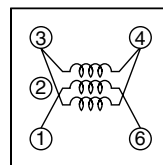
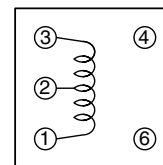
Pin ConnectionsDouble balanced
Fig. 1Mixer transformer
Fig. 2Balun transformer
Fig. 3Balun transformer
Fig. 4Distributor
Fig. 5