



# SAW Components

Data Sheet B9301





**SAW Components**

**B9301**

**Low-Loss Dual Band Filter for Mobile Communication**

**881,5 / 942,5 MHz**

**Data Sheet**



**Chip Sized Saw Package QCS10H**

**Features**

- Low-loss 2in1 RF filter for mobile telephone GSM850/900 systems, receive path
- Usable passband:  
Filter 1 (GSM900): 35 MHz  
Filter 2 (GSM850): 25 MHz
- Unbalanced to balanced operation of both filters
- Impedance transformation from 50 Ω to 150 Ω for both filters
- Suitable for GPRS Class 1 to 12
- Ceramic package for **Surface Mounted Technology (SMT)**

**Terminals**

- Ni, gold-plated

**Pin configuration**

- 1 Input [ Filter 1 ]
- 4 Input [ Filter 2 ]
- 6, 7 Output, balanced [ Filter 2 ]
- 8, 9 Output, balanced [ Filter 1 ]
- 2, 3, 5,10 Case ground

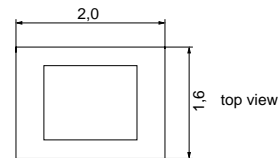
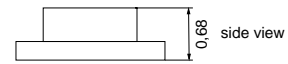
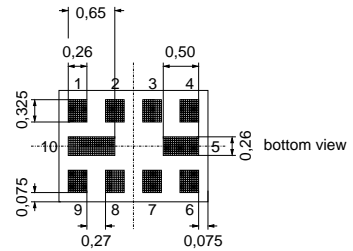

Dimensions in mm, approx. weight 8mg

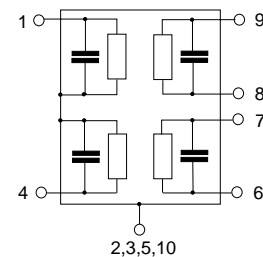

Type	Ordering code	Marking and Package according to	Packing according to
B9301	B39941-B9301-G110	C61157-A7-A141	F61074-V8152-Z000

**Electrostatic Sensitive Device (ESD)**

**Maximum ratings**

Operable temperature range	$T$	- 40 / + 85	°C	Machine Model, 10 pulses
Storage temperature range	$T_{stg}$	- 40 / + 85	°C	
DC voltage	$V_{DC}$	5	V	
ESD voltage	$V_{ESD}^*$	100	V	
Input power at GSM850, GSM900, GSM1800, GSM1900 Tx bands:				
Filter 1 (GSM900-Rx)	$P_{IN}$	15	dBm	effective power in the on-state, duty cycle 4:8
Filter 2 (GSM850-Rx)	$P_{IN}$	15	dBm	

\* - acc. to JESD22-A115A (Machine Model), 10 negative & 10 positive pulses



**Characteristics Filter 1 ( GSM900 )**

Operating temperature range:  $T = -20$  to  $+85^{\circ}\text{C}$   
 Terminating source impedance:  $Z_S = 50\ \Omega$  (unbalanced)  
 Terminating load impedance:  $Z_L = 150\ \Omega$  (balanced)  $\parallel$  82nH

			min.	typ.	max.	
<b>Center frequency</b>	$f_c$		—	942,5	—	MHz
<b>Maximum insertion attenuation</b>	$\alpha_{\max}$	925,0 ... 960,0 MHz	—	1,6	2,1	dB
<b>Amplitude ripple (p-p)</b>	$\Delta\alpha$	925,0 ... 960,0 MHz	—	0,9	1,4	dB
<b>Input VSWR</b>		925,0 ... 960,0 MHz	—	1,8	2,1	
<b>Output VSWR</b>		925,0 ... 960,0 MHz	—	1,9	2,2	
<b>Output amplitude balance (<math> S_{31}/S_{21} </math>)</b>		925,0 ... 960,0 MHz	-1,1	-0,6/+0,6	1,1	dB
<b>Output phase balance (<math>\phi(S_{31})-\phi(S_{21})+180^{\circ}</math>)</b>		925,0 ... 960,0 MHz	-10	-2/+1	10	degree
<b>Attenuation</b>	$\alpha_{\min}$	10,0 ... 480,0 MHz	45	54	—	dB
		480,0 ... 905,0 MHz	30	33	—	dB
		905,0 ... 915,0 MHz	20	27	—	dB
		980,0 ... 1000,0 MHz	25	28	—	dB
		1000,0 ... 1850,0 MHz	28	32	—	dB
		1850,0 ... 1920,0 MHz	40	58	—	dB
		1920,0 ... 6000,0 MHz	35	47	—	dB



Transfer function Filter 1 ( GSM900 )

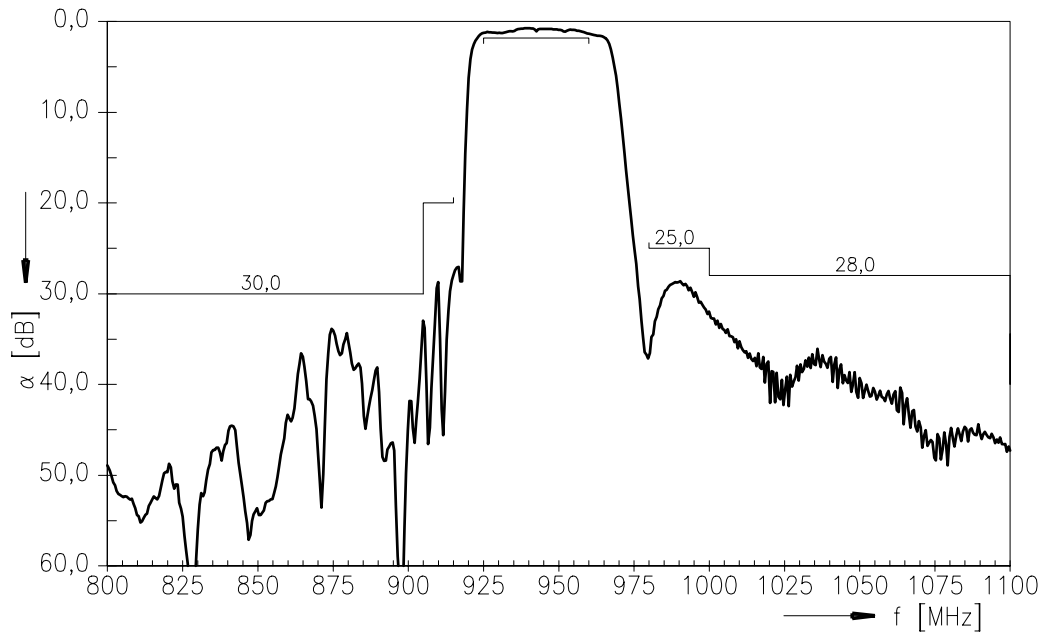

Transfer function Filter 1 ( GSM900 ) - wideband

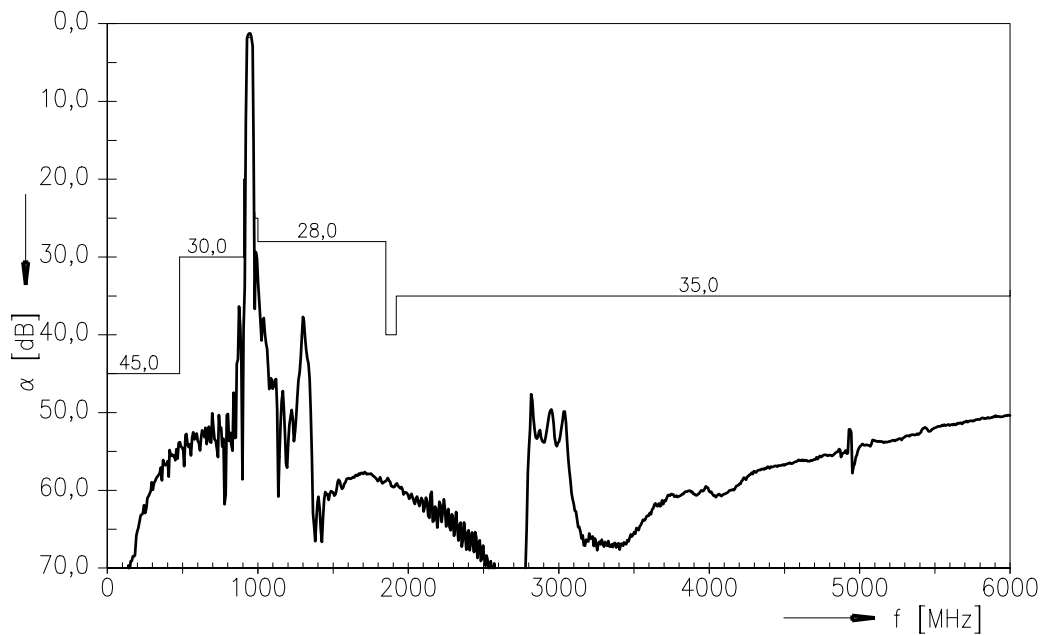



**Characteristics Filter 2 ( GSM850 )**

Operating temperature range:  $T = -20$  to  $+85^{\circ}\text{C}$   
 Terminating source impedance:  $Z_S = 50\ \Omega$  (unbalanced)  
 Terminating load impedance:  $Z_L = 150\ \Omega$  (balanced) || 82nH

			min.	typ.	max.	
<b>Center frequency</b>	$f_c$		—	881,5	—	MHz
<b>Maximum insertion attenuation</b>	$\alpha_{max}$	869,0 ... 894,0 MHz	—	1,2	1,8	dB
<b>Amplitude ripple (p-p)</b>	$\Delta\alpha$	869,0 ... 894,0 MHz	—	0,5	1,0	dB
<b>Input VSWR</b>		869,0 ... 894,0 MHz	—	1,8	2,1	
<b>Output VSWR</b>		869,0 ... 894,0 MHz	—	1,7	2,0	
<b>Output amplitude balance (<math> S_{31}/S_{21} </math>)</b>		869,0 ... 894,0 MHz	-1,0	-0,5/+0,2	1,0	dB
<b>Output phase balance (<math>\phi(S_{31})-\phi(S_{21})+180^{\circ}</math>)</b>		869,0 ... 894,0 MHz	-10	-3/+4	10	degree
<b>Attenuation</b>	$\alpha_{min}$	10,0 ... 447,0 MHz	45	55	—	dB
		447,0 ... 849,0 MHz	30	34	—	dB
		914,0 ... 1000,0 MHz	24	27	—	dB
		1000,0 ... 1738,0 MHz	28	37	—	dB
		1738,0 ... 1788,0 MHz	40	52	—	dB
		1788,0 ... 6000,0 MHz	35	46	—	dB



Transfer function Filter 2 ( GSM850 )

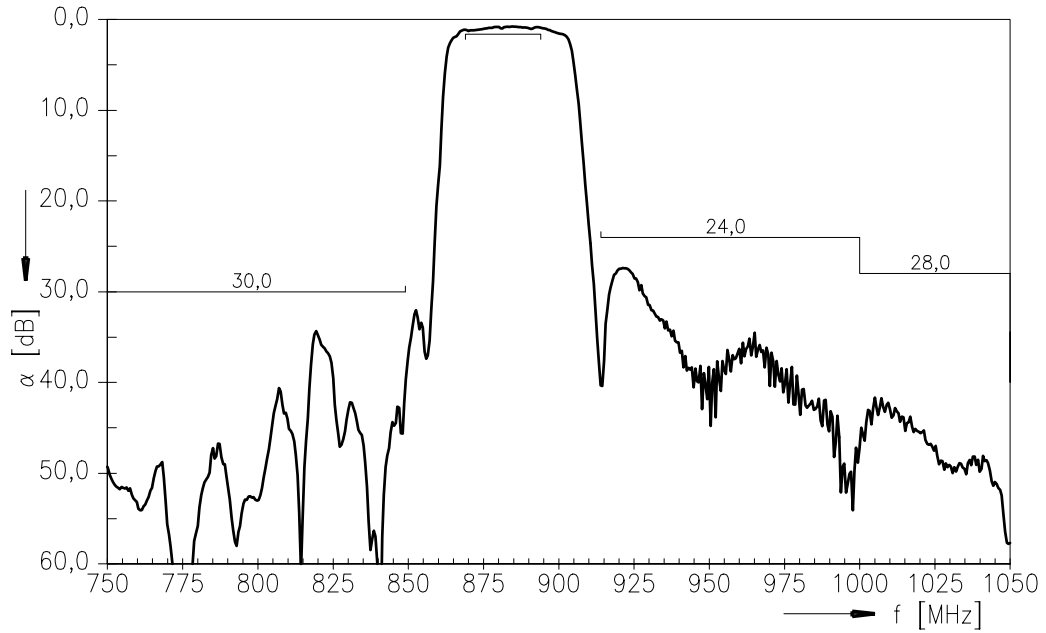

Transfer function Filter 2 ( GSM850 ) - wideband

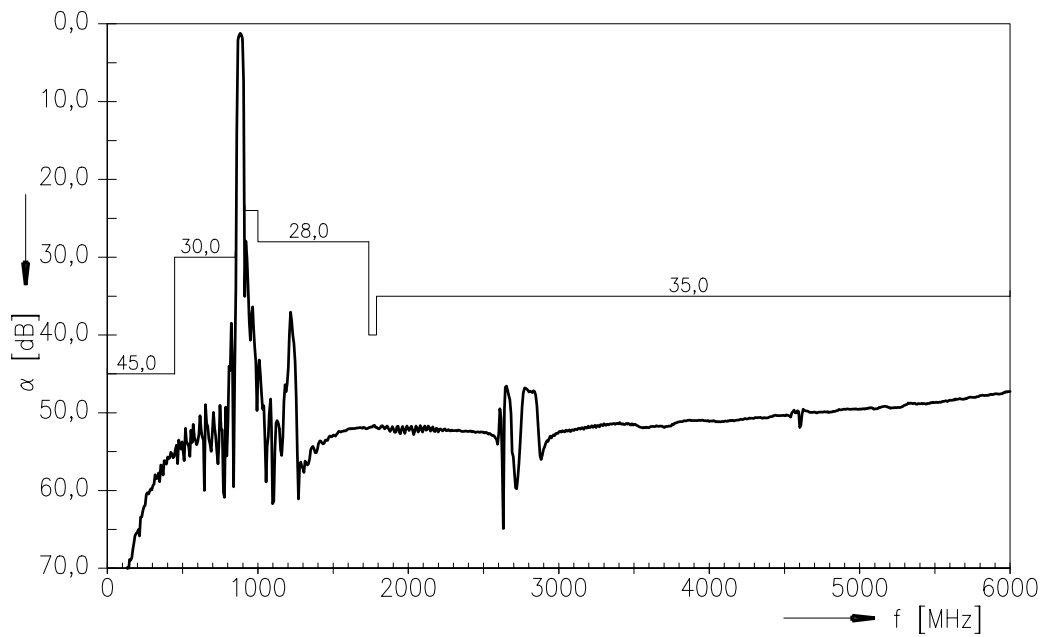



**SAW Components**

**B9301**

**Low-Loss Dual Band Filter for Mobile Communication**

**881,5 / 942,5 MHz**

Data Sheet



**Published by EPCOS AG**

**Surface Acoustic Wave Components Division, SAW MC**

**P.O. Box 80 17 09, 81617 Munich, GERMANY**

© EPCOS AG 2006. Reproduction, publication and dissemination of this brochure and the information contained therein without EPCOS' prior express consent is prohibited.

Purchase orders are subject to the General Conditions for the Supply of Products and Services of the Electrical and Electronics Industry recommended by the ZVEI (German Electrical and Electronic Manufacturers' Association), unless otherwise agreed.

This brochure replaces the previous edition.

For questions on technology, prices and delivery please contact the Sales Offices of EPCOS AG or the international Representatives.

Due to technical requirements components may contain dangerous substances. For information on the type in question please also contact one of our Sales Offices.