

**SURFACE MOUNT
SCHOTTKY BARRIER DIODE**

**REVERSE VOLTAGE – 70 Volts
FORWARD CURRENT – 0.07 Ampere**

FEATURES

- Extremely Fast Switching Speed
- Low Forward Voltage
- Very Small Conduction Losses

MECHANICAL DATA

- Case: SOT-523 Plastic
- Case Material: “Green” molding compound, UL flammability classification 94V-0, (No Br. Sb. Cl)
- Moisture Sensitivity: Level 1 per J-STD-020D
- Lead Free in RoHS 2002/95/EC Compliant

SOT-523

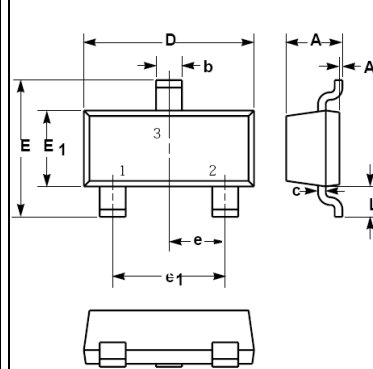

SOT-523		
Dim.	Min.	Max.
A	0.70	0.90
A1	0.00	0.10
b	0.25	0.325
c	0.10	0.20
D	1.50	1.70
E	1.45	1.75
E1	0.75	0.85
e	0.50 Typ.	
e1	0.90	1.10
L	0.55 Ref.	
Dimensions in millimeter		

Maximum Ratings & Thermal Characteristics @ T_A = 25°C unless otherwise specified

Characteristic	Symbol	BAS70T	BAS70-04T	BAS70-05T	BAS70-06T	Units
Repetitive Peak Reverse Voltage Working Peak Reverse Voltage DC Blocking Voltage	V_{RRM} V_{RWM} V_R	70				V
Forward Continuous Current	I_{FM}	70				mA
Non-Repetitive Peak Forward Surge Current @ tp<1.0s	I_{FSM}	100				mA
Power Dissipation	P_D	150				mW
Thermal Resistance Junction to Ambient	$R_{\theta JA}$	833				°C/W
Operating Temperature Range	T_J	125				°C
Storage Temperature Range	T_{STG}	-55~+125				°C

Electrical Characteristics @ T_A = 25°C unless otherwise specified

Characteristic	Test Condition	Symbol	BAS70T	BAS70-04T	BAS70-05T	BAS70-06T	Unit
Reverse Breakdown Voltage	$I_R = 10\mu A$	V_{BR}	70				V
Maximum Forward Voltage	$I_F = 1mA$ $I_F = 15mA$	V_F	410 1000				mV
Maximum DC Reverse Current at Rated DC Blocking Voltage	$V_R = 50V$	I_R	100				nA
Typical Diode Capacitance	$V_R = 0V, f = 1MHz$	C_D	2				pF
Reverse Recovery time	$I_{rr} = 1mA,$ $I_R = I_F = 10mA$ $R_L = 100\Omega$	t_{rr}	5				nS

RATING AND CHARACTERISTIC CURVES
BAS70T, BAS70-04T thru -06T



FIG.1- TYPICAL FORWARD CHARACTERISTICS

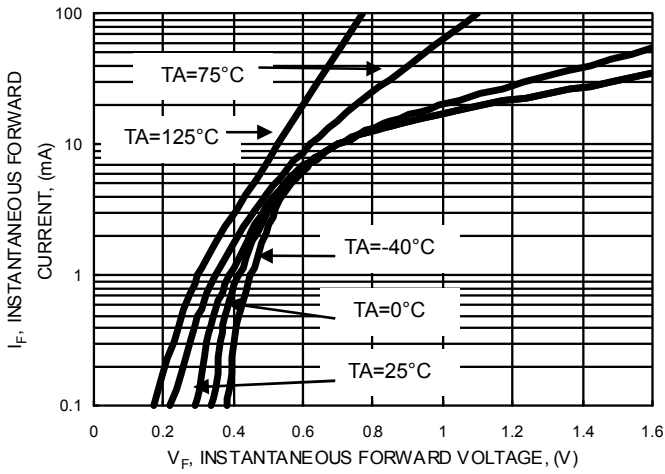

FIG.2- TYPICAL REVERSE CHARACTERISTICS

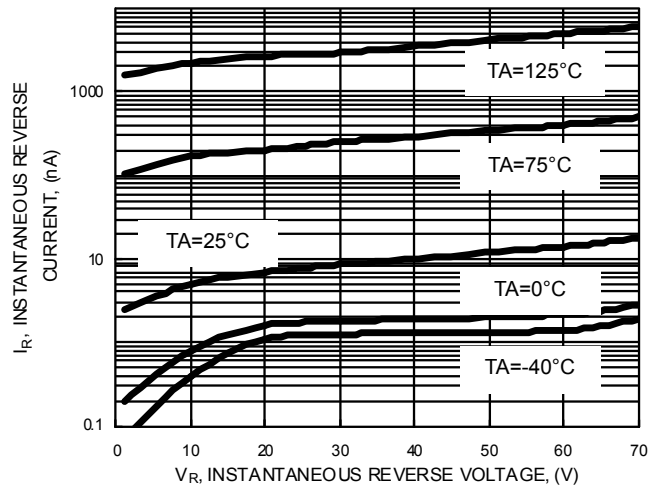

FIG.3- TYPICAL JUNCTION CAPACITANCE

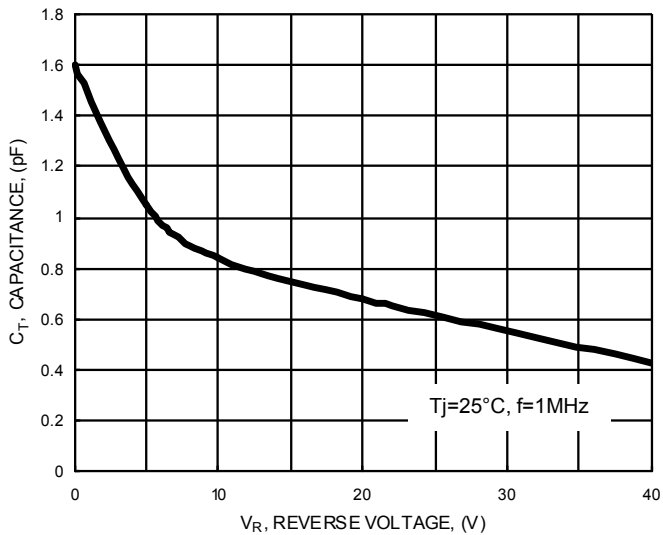
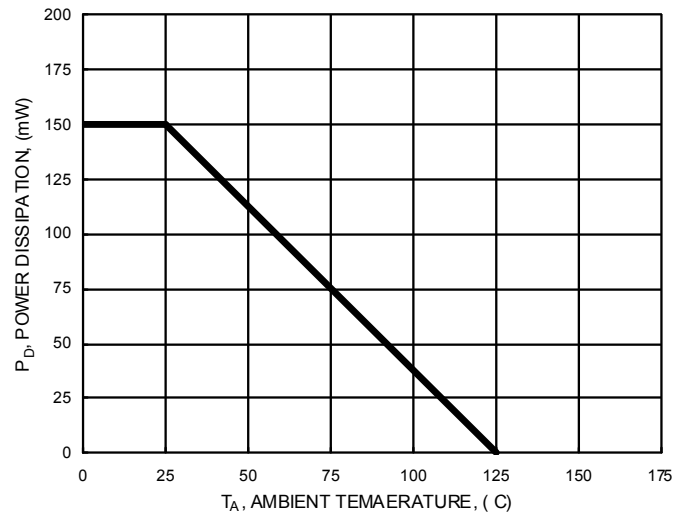

FIG.4- POWER DERATING CURVE



Device Marking :

Device P/N	Marking	Equivalent Circuit Diagram
BAS70T	7C	
BAS70-04T	7D	
BAS70-05T	7E	
BAS70-06T	7F	

Important Notice and Disclaimer

LSC reserves the right to make changes to this document and its products and specifications at any time without notice. Customers should obtain and confirm the latest product information and specifications before final design, purchase or use.

TA=75°C

LSC makes no warranty, representation or guarantee regarding the suitability of its products for any particular purpose, nor does LSC assume any liability for application assistance or customer product design. LSC does not warrant or accept any liability with products that are purchased or used for any unintended or unauthorized application.

TA=0°C

TA=-40°C

No license is granted by implication or otherwise under any intellectual property rights of LSC.

LSC products are not authorized for use as critical components in life support devices or systems without express written approval of LSC.