

RECOMMENDED PCB LAYOUT

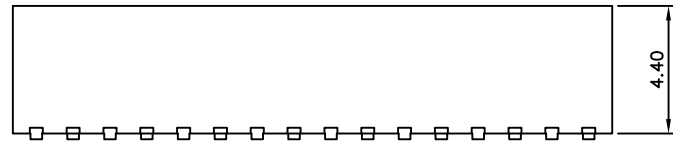
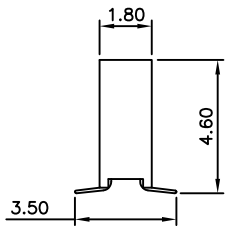

CONTACTS	DIMENSIONS	
	A	B
2	1.27	2.89
3	2.54	4.16
4	3.81	5.43
5	5.08	6.70
6	6.35	7.97
7	7.62	9.24
8	8.89	10.51
9	10.16	11.78
10	11.43	13.05
11	12.70	14.32
12	13.97	15.59
13	15.24	16.86
14	16.51	18.13
15	17.78	19.40
16	19.05	20.67
17	20.32	21.94
18	21.59	23.21
19	22.86	24.48
20	24.13	25.75
21	25.40	27.02
22	26.67	28.29
23	27.94	29.56
24	29.21	30.83
25	30.48	32.10
26	31.75	33.37
27	33.02	34.64
28	34.29	35.91
29	35.56	37.18
30	36.83	38.45
31	38.10	39.72
32	39.37	40.99
33	40.64	42.26
34	41.91	43.53
35	43.18	44.80
36	44.45	46.07
37	45.72	47.34
38	46.99	48.61
39	48.26	49.88
40	49.53	51.15

SPECIFICATIONS 规格:

CURRENT RATING 电流额定值: 1 AMP  
 INSULATOR RESISTANCE 绝缘电阻值: 1000 MΩ MIN.  
 DIELECTRIC WITHSTANDING 耐电压: AC 300 V  
 CONTACT RESISTANCE 接触电阻值: 20mΩ Max.  
 OPERATING TEMPERATURE 工作温度: -40°C TO +105°C  
 CONTACT MATERIAL 端子物料: COPPER ALLOY  
 INSULATOR MATERIAL 绝缘体物料:  
 POLYESTER 聚酯, LCP, UL 94 V-0  
 SOLDERING PROCESS 可焊性: LCP -  
 IR REFLOW 回流焊: 260°C for 10 sec.   
 WAVE 波峰焊: 250°C for 5-10 sec  
 MANUAL SOLDER 人工焊接: 350°C for 3-5 sec

MATES WITH 配套之母座 (SUBJECT TO PIN LENGTH 在端子长度适合的条件下):  
 BD021 BD045 BD100 BD105 BD110

Ordering Grid

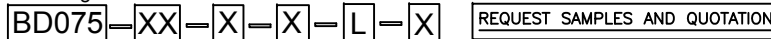

No. of Contacts  
02 to 40

Contact Plating  
**A = Gold Flash All Over (Standard)**  
 B = Selective Gold Flash Contact Area/  
 Tin On Tail  
 C = Tin All Over  
 G = 10µ" Gold Contact Area/Tin On Tail  
 I = 30µ" Gold Contact Area/Tin On Tail

Type  
 1 = B1 Type  
 2 = B2 Type

Packing Options   
**C = Tape & Reel with Film (Standard)**  
 B = Tape & Reel with Cap  
 D = Tube  
 E = Tube with Cap  
 F = Tube with Film

Insulator Material  
 L = LCP

By	LYH	PN	PN	CB	AE	AJO
DETAIL	DRAWING RELEASE	AMENDED TO TOP ENTRY	STANDARD INSULATOR MATERIAL & PACKING OPTIONS CHANGED	PACKING OPTIONS CHANGED	SOLDER TEMP & MATES WITH INFO. UPDATED	B2B PCN002 1.27mm SOCKET N&T REMOVAL
REV DATE	A 28/12/07	B 04/03/09	C 27/04/09	D 20/05/09	E 27/07/09	F 13/12/12



Tolerances (Except as noted)	Part Number:-	Date:-
Dimensions in mm X. ± 0.30 X.* ± 5° X.X ± 0.20 X.* ± 2° X.XX ± 0.15 X.X* ± 1° X.XXX ± 0.10 XXX* ± 0.5°	BD075	28 DEC 07
Third Angle Projection	Description:- 1.27mm PITCH SOCKET, SINGLE ROW, SURFACE MOUNT, TOP ENTRY	
	THIS DRAWING IS CONFIDENTIAL AND MUST NOT BE COPIED OR DISCLOSED WITHOUT WRITTEN CONSENT	

**GCT**

www.globalconnectortechology.com

Scale	Revision	Material	Drawn by	Sheet No.
NTS	F	See Note	LYH	E & OE 1/1