

GDT Product Specification

BF***M SMD Gas Discharge Tube (5×5×4.2mm)

RoHS

1、FEATURES

- Surface Mounting Design UL Certificated E232249
- Size Design EIA 2018 5×5×4.2mm
- High Current Handling Capability 5,000A @ 8/20μs
- Low Capacitance and Insertion Loss
- Fast Response and Long Service Life
- Reliable to Protect Electrostatic Surge
- Moisture sensitivity level: Level 1



2、AVAILABLE PART NUMBER AND ELECTRICAL PARAMETER @ T=25°C RH = 45%-75%

| Part Number | DC Breakdown Voltage① | Tolerance of Vs | Impulse Spark-over Voltage | Impulse Discharge Current② | Insulation Resistance | | C③ (1MHz) |
|-------------|-----------------------|--------------------|----------------------------|----------------------------|-----------------------|------|--------------------|
| | 100V/s④ | | 1kV/μs④ | 8/20μs | GΩ | DC | 0.3V _{DC} |
| BF071M | 70V | ±20% | ≤ 650V | 5,000A | ≥1 | 25V | ≤1pF |
| BF091M | 90V | ±20% | ≤650V | 5,000A | ≥1 | 50V | ≤1pF |
| BF151M | 150V | ±20% | ≤ 650V | 5,000A | ≥1 | 50V | ≤1pF |
| BF201M | 200V | ±20% | ≤ 650V | 5,000A | ≥1 | 100V | ≤1pF |
| BF231M | 230V | ±20% | ≤ 700V | 5,000A | ≥1 | 100V | ≤1pF |
| BF301M | 300V | ±20% | ≤ 700V | 5,000A | ≥1 | 100V | ≤1pF |
| BF351M | 350V | ±20% | ≤900V | 5,000A | ≥1 | 100V | ≤1pF |
| BF401M | 400V | ±20% | ≤ 950V | 5,000A | ≥1 | 100V | ≤1pF |
| BF471M | 470V | ±20% | ≤ 1000V | 5,000A | ≥1 | 100V | ≤1pF |
| BF601M | 600V | ±20% | ≤ 1200V | 5,000A | ≥1 | 100V | ≤1pF |
| BF801M | 800V | ±20% | ≤ 1600V | 3,000A | ≥1 | 100V | ≤1.5pF |
| BF102M | 1000V | ±20% | ≤ 1800V | 3,000A | ≥1 | 100V | ≤1.5pF |
| BF122M | 1200V | ±20% | ≤ 2000V | 3,000A | ≥1 | 100V | ≤1.5pF |

- ①、The parameters of all are tested by ITU-T K12
- ②、Total Impulse Discharge Current 5,000A @ 8/20μs by IEC 61000-4-5, 10 shots
- ③、The capacitance are tested by 1MHz @ DC= 0.3V
- ④、The V-T waveform of DCBV and IPBV mus lie between the shades.

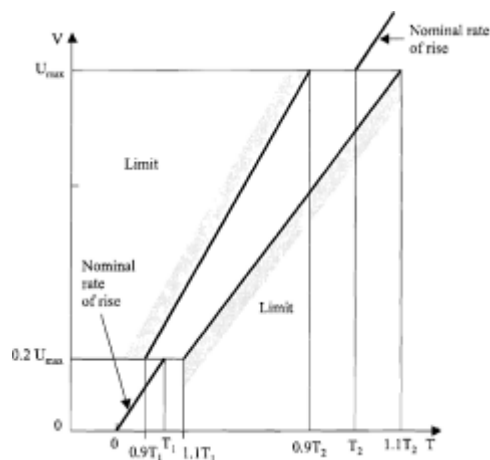

3、PART NUMBERING SYSTEM

BF **XXX** **M**
(1) (2) (3)

- (1) LangTuo SMD Gas Discharge Tube in 5×5×4.2 (L×W×H) (mm), Total Impulse Discharge Current 5,000A @ 8/20μs
- (2) DC Breakdown Voltage, e.g., 151=15×10¹=150V
- (3) Tolerance is DC Breakdown Voltage, M=+-20%, N=+-30%

4、DIMENSIONS

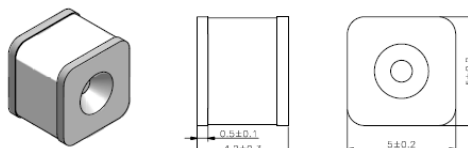

Unit:mm

GDT Product Specification

BF*M SMD Gas Discharge Tube (5×5×4.2mm)**



5、RECOMMENDED SOLDERING PAD AND REFLOW PROFILE

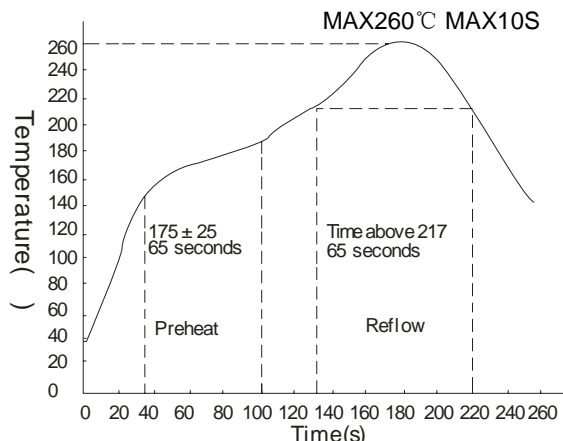
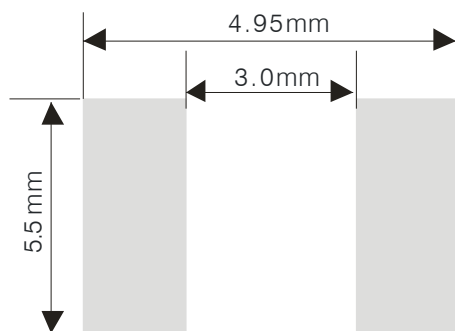

6、OPERATION AND STORAGE TEMPERATURE: -40°C ~ +85°C

7、PACKAGE REEL INFORMATION

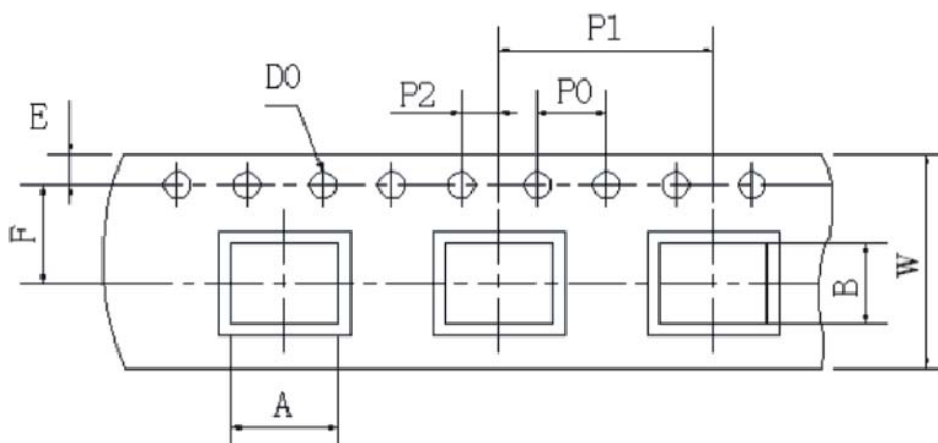

| Item | DIM(mm) |
|------|-------------|
| A | 5.3 ± 0.10 |
| B | 4.5 ± 0.20 |
| D0 | 1.50 ± 0.10 |
| E | 1.75 ± 0.10 |
| F | 5.5 ± 0.1 |
| P0 | 4.0 ± 0.1 |
| P1 | 8.0 ± 0.10 |
| P2 | 2.0 ± 0.1 |
| W | 12.0 ± 0.30 |

| OUTLINE | UNIT WEIGHT (g) | REEL (PCS) | PER CARTON (PCS) | REEL DIAMETERS (mm) | CARTON SIZE(mm) | | |
|---------|-----------------|------------|------------------|---------------------|-----------------|-----|-----|
| | | | | | L | W | H |
| TAPING | ~0.5 | 1,000 | 16,000 | 330 | 360 | 360 | 360 |

Remark:

- 1、 Company name change from *Bencent Electronics Limited* to *Shenzhen Lanq Electronics Co., Ltd*
- 2、 Add items of Operation and Storage Temperature
- 3、 Add items of UNIT WEIGHT

Special Notes

Date Issued:2010/07