

Coaxial DC Block SMA

0.0001 to 8 GHz

NEW!
BLK-89

Maximum Ratings

Operating Temperature	-55°C to 100°C
Storage Temperature	-55°C to 100°C
Max. DC input voltage	50V

Features

- broadband performance
- low insertion loss
- rugged unibody construction
- off-the-shelf availability



CASE STYLE: FF888
CONNECTOR: SMA (F) - SMA (M)
PRICE: \$14.95 ea.
QTY. (1-9)

Applications

- test and measurement instrumentation
- communication systems
- defense systems

Outline Drawing

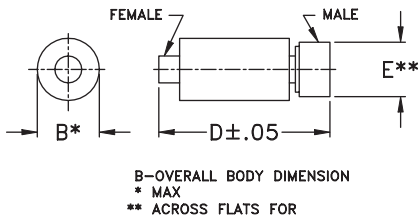

Outline Dimensions (inch/mm)

B	D	E	wt.
.46	1.18	.31	grams
11.68	29.97	7.87	7.0

Schematic

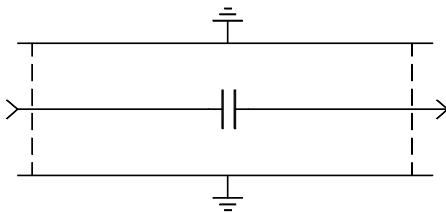

Electrical Specifications at 25°C

FREQUENCY (GHz)	INSERTION LOSS (dB)		RETURN LOSS (dB)	
	Typ.	Max.	Typ.	Min.
0.0001-0.1	.010	.09	40	20
0.01-1.0	0.10	0.3	36	25
1.0-4.0	0.15	0.8	24	18
4.0-8.0	0.5	0.9	20	13

Typical Performance Data

FREQUENCY (MHz)	INSERTION LOSS (dB)	RETURN LOSS (dB)	
		MALE	FEMALE
0.3	0.01	31.86	31.89
0.6	0.01	32.19	32.23
0.9	0.01	32.52	32.58
1.0	0.01	32.63	32.69
50.0	0.02	48.75	48.76
100.0	0.03	44.40	44.44
200.0	0.04	40.26	40.33
300.0	0.05	37.96	38.27
400.0	0.06	36.24	36.45
500.0	0.06	34.94	35.08
700.0	0.07	32.57	32.78
800.0	0.08	31.67	31.84
900.0	0.08	30.86	31.04
1000.0	0.09	30.27	30.41
2000.0	0.12	26.09	26.06
3000.0	0.18	24.48	24.04
4000.0	0.24	22.65	22.58
5000.0	0.41	20.64	21.77
6000.0	0.47	20.26	22.30
7000.0	0.42	19.52	21.11
8000.0	0.51	17.29	18.16

