

# Zener Diode Chip Series

## CD957B thru CD986B



Available in JANHC and JANKC per MIL-PRF-19500/117



### Features

- 0.5 Watt capability with proper heat sinking
- Electrically equivalent to IN957B thru IN986B
- All junctions completely protected with silicon dioxide
- Compatible with all wire bonding and die attach techniques

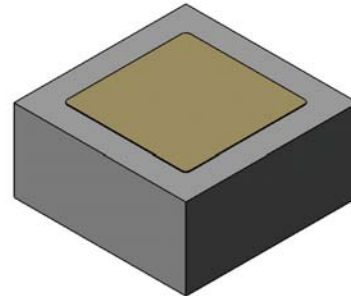

### Maximum Ratings

Operating Temperature: -65°C to +175°C  
 Storage Temperature: -65°C to +175°C  
 Forward Voltage @ 200mA: 1.5 volts maximum

### Electrical Specifications @ +25 °C (Unless Otherwise Specified)

TYPE NUMBER	NOMINAL ZENER VOLTAGE $V_Z$ (NOTE 1)	ZENER TEST CURRENT $I_{ZT}$	MAXIMUM ZENER IMPEDANCE (NOTE 2)			MAXIMUM DC ZENER CURRENT $I_{ZM}$	MAXIMUM REVERSE LEAKAGE CURRENT $I_R @ V_R$	
			$Z_{ZT} @ I_{ZT}$	$Z_{ZK} @ I_{ZK}$			$\mu A$	VOLTS
				OHMS	OHMS			
CD957B	6.8	18.5	4.5	700	1.0	55	5.0	5.2
CD958B	7.5	16.5	5.5	700	0.5	50	5.0	5.7
CD959B	8.2	15.0	6.5	700	0.5	45	5.0	6.2
CD960B	9.1	14.0	7.5	700	0.5	41	5.0	6.9
CD961B	10	12.5	8.5	700	0.25	38	2.0	7.6
CD962B	11	11.5	9.5	700	0.25	32	1.0	8.4
CD963B	12	10.5	11.5	700	0.25	31	1.0	9.1
CD964B	13	9.5	13	700	0.25	28	0.5	9.9
CD965B	15	8.5	16	700	0.25	25	0.5	11
CD966B	16	7.8	17	700	0.25	24	0.5	12
CD967B	18	7.0	21	750	0.25	20	0.5	14
CD968B	20	6.2	25	750	0.25	18	0.5	15
CD969B	22	5.6	29	750	0.25	16	0.5	17
CD970B	24	5.2	33	750	0.25	15	0.5	18
CD971B	27	4.6	41	750	0.25	13	0.5	21
CD972B	30	4.2	49	1000	0.25	12	0.5	23
CD973B	33	3.8	58	1000	0.25	11	0.5	25
CD974B	36	3.4	70	1000	0.25	10	0.5	27
CD975B	39	3.2	90	1000	0.25	9.5	0.5	30
CD976B	43	3.0	93	1500	0.25	8.8	0.5	33
CD977B	47	2.7	105	1500	0.25	7.9	0.5	36
CD978B	51	2.5	125	1500	0.25	7.4	0.5	39
CD979B	56	2.2	150	2000	0.25	6.8	0.5	43
CD980B	62	2.0	185	2000	0.25	6.0	0.5	47
CD981B	68	1.8	230	2000	0.25	5.5	0.5	52
CD982B	75	1.7	270	2000	0.25	5.0	0.5	56
CD983B	82	1.5	330	3000	0.25	4.6	0.5	62
CD984B	91	1.4	400	3000	0.25	4.1	0.5	69
CD985B	100	1.3	500	3000	0.25	3.7	0.5	76
CD986B	110	1.1	750	4000	0.25	3.3	0.5	84

NOTE 1 Zener voltage range equals nominal voltage  $\pm 5\%$  for "B" Suffix. "A" Suffix denotes  $\pm 10\%$ , No Suffix denotes  $\pm 20\%$ . "C" suffix =  $\pm 2\%$  and "D" suffix =  $\pm 1\%$ . Zener voltage is read using a pulse measurement, 10 milliseconds maximum.

NOTE 2 Zener impedance is derived by superimposing on  $I_{ZT}$  a 60Hz rms a.c. current equal to 10% of  $I_{ZT}$ .



**Outline Drawing**

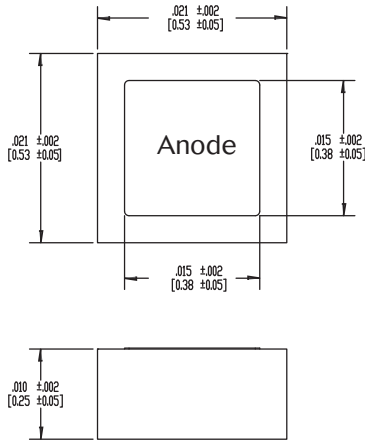

**DESIGN DATA**

**METALLIZATION:** Top: (Anode) Al  
Back: (Cathode) Au

**AL THICKNESS:** 25,000 Å Minimum

**GOLD THICKNESS:** 4,000 Å Minimum

**CHIP THICKNESS:** 10 Mils

**CIRCUIT LAYOUT DATA:** For Zener operation, cathode must be operated positive with respect to anode.

**Graphs**

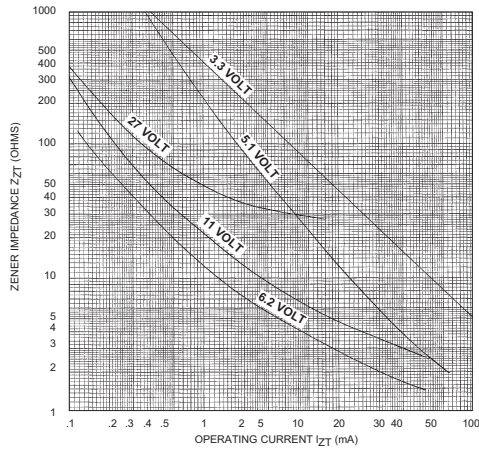

ZENER IMPEDANCE VS. OPERATING CURRENT

**Aeroflex / Metelics, Inc.**

975 Stewart Drive,  
Sunnyvale, CA 94085  
Tel: (408) 737-8181  
Fax: (408) 733-7645

Sales: 888-641-SEMI (7364)

**Hi-Rel Components**

9 Hampshire Street,  
Lawrence, MA 01840  
Tel: (603) 641-3800  
Fax: (978) 683-3264

[www.aeroflex.com/metelics-hirelcomponents](http://www.aeroflex.com/metelics-hirelcomponents)

[www.aeroflex.com/metelics](http://www.aeroflex.com/metelics)      [metelics-sales@aeroflex.com](mailto:metelics-sales@aeroflex.com)

Aeroflex / Metelics, Inc. reserves the right to make changes to any products and services herein at any time without notice. Consult Aeroflex or an authorized sales representative to verify that the information in this data sheet is current before using this product. Aeroflex does not assume any responsibility or liability arising out of the application or use of any product or service described herein, except as expressly agreed to in writing by Aeroflex; nor does the purchase, lease, or use of a product or service from Aeroflex convey a license under any patent rights, copyrights, trademark rights, or any other of the intellectual rights of Aeroflex or of third parties.

Copyright 2011 Aeroflex / Metelics. All rights reserved.

**ISO 9001: 2008 certified companies**



Our passion for performance is defined by three attributes represented by these three icons: solution-minded, performance-driven and customer-focused.