

# SMD Power Inductor CDEIR12D45ME



## Description

- Metal alloy core construction.
- Magnetically shielded.
- L × W × H: 13.7 × 13.0 × 5.0mm Max.
- Product weight :3.0g(Ref.)
- Moisture Sensitivity Level: 1
- RoHS compliance.

## Environmental Data

- Operating temperature range: -40°C~+105°C (including coil's self temperature rise)
- Storage temperature range: -40°C~+105°C
- Solder reflow temperature: 260 °C peak.

## Packaging

- Carrier tape and reel packaging.
- 13.0" diameter reel
- 500pcs per reel

## Applications

- Ideally used in Notebook, PDA and other high current application .

## Dimension - [mm]

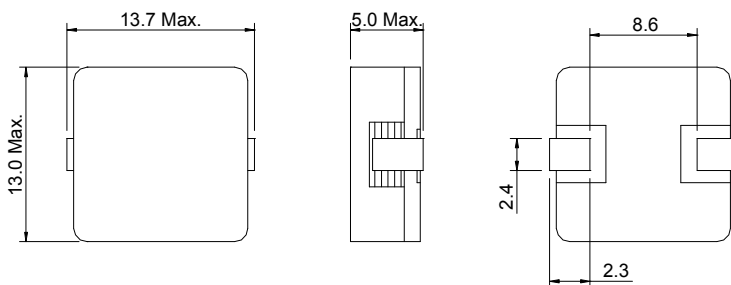

## Land pattern and Schematics - [mm]

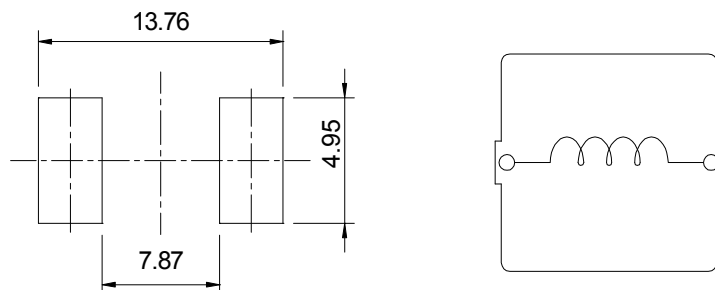

## Electrical Characteristics

Part No.	Stamp	Inductance (μH) [Within] ※2	D. C. R. (mΩ) [Max. ]	Saturation current (A) ※3	Temperature Rise Current (A) ※4
CDEIR12D45MENP-1R0MC	1R0	1.0 ± 20%	1.9 (1.6)	29.6 (37.0)	18.0 (21.0)
CDEIR12D45MENP-1R5MC	1R5	1.5 ± 20%	3.8 (3.0)	25.2 (31.5)	14.0 (16.0)
CDEIR12D45MENP-2R2MC	2R2	2.2 ± 20%	5.3 (4.2)	21.6 (27.0)	11.6 (13.4)
CDEIR12D45MENP-3R3MC	3R3	3.3 ± 20%	7.6 (6.1)	15.2 (19.0)	9.8 (11.0)
CDEIR12D45MENP-4R3MC	4R3	4.3 ± 20%	8.9 (7.1)	13.1 (16.4)	9.0 (10.5)

※1. Measuring condition Inductance at 100kHz

※2. The saturation current: The value of DC current when the inductance decreases to 80% of its nominal value (Ta=20°C).

※3. The temperature rise current: The value of DC current when the temperature rise is ΔT=40°C (Ta=20°C).

# SMD Power Inductor CDEIR12D45ME



## Saturation Current & Temperature Rise Graph

— L (25°C)    —  $\Delta T$

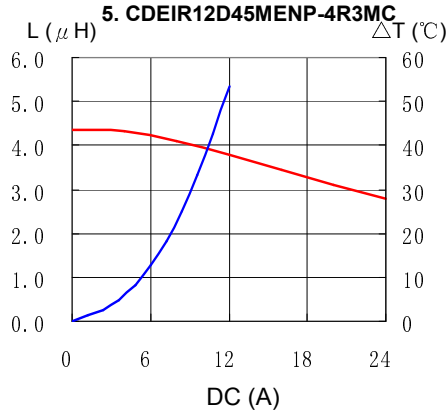
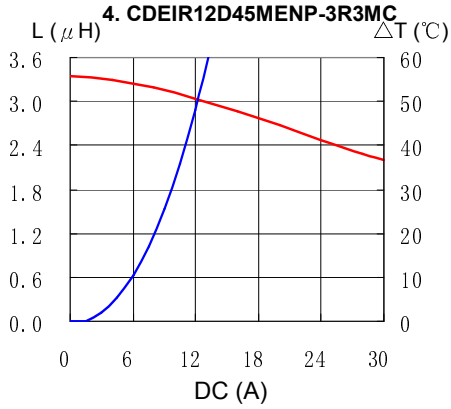
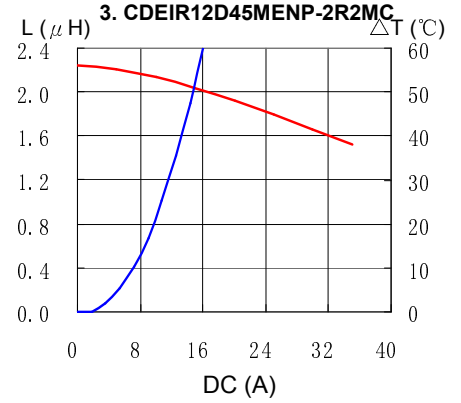
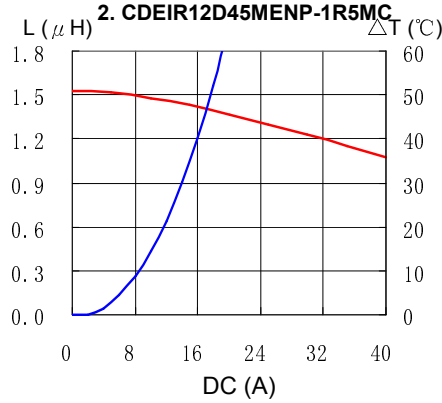
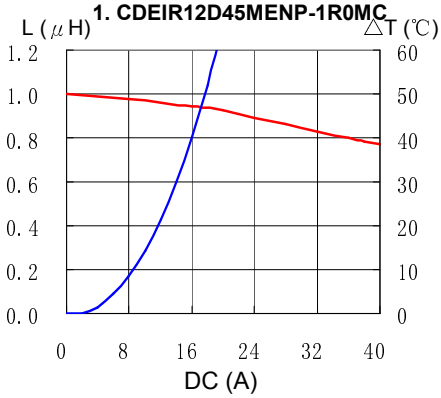

# SMD Power Inductor CDEIR12D45ME



## Solder Reflow Condition

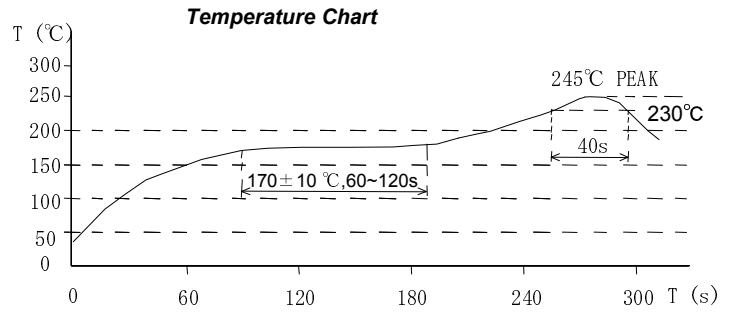
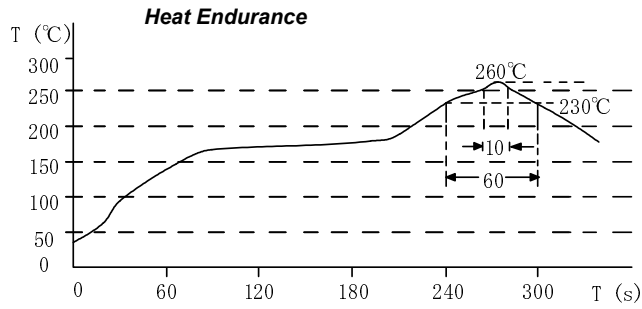

Please refer to the sales offices on our website - <http://www.sumida.com>

### Hong Kong

Tel.+852-2880-6781  
FAX.+852-2565-9600  
[sales@hk.sumida.com](mailto:sales@hk.sumida.com)

### Saitama(Japan)

Tel.+81-48-691-7300  
FAX.+81-48-691-7340  
[sales@jp.sumida.com](mailto:sales@jp.sumida.com)

### Chicago

Tel.+1-847-545-6700  
FAX. +1-847-545-6720  
[sales@us.sumida.com](mailto:sales@us.sumida.com)

### Shanghai

Tel.+86-21-5836-3299  
FAX.+86-21-5836-3266  
[shanghai.sales@cn.sumida.com](mailto:shanghai.sales@cn.sumida.com)

### Seoul

Tel.+82-2-6237-0777  
FAX.+82-2-6237-0778  
[sales@kr.sumida.com](mailto:sales@kr.sumida.com)

### Oberzell

Tel.+49-8591-937-0  
FAX. +49-8591-937-103  
[contact@eu.sumida.com](mailto:contact@eu.sumida.com)

### Shenzhen

Tel.+86-755-8291-0228  
FAX.+86-755-8291-0338  
[shenzhen.sales@cn.sumida.com](mailto:shenzhen.sales@cn.sumida.com)

### Singapore

Tel.+65-6296-3388  
FAX.+65-6841-4426  
[sales@sg.sumida.com](mailto:sales@sg.sumida.com)

### Neumarkt

Tel.+49-9181-4509-110  
FAX. +49-9181-4509-310  
[infocomp@eu.sumida.com](mailto:infocomp@eu.sumida.com)

### Taipei

Tel.+886-2-8751-2737  
FAX.+886-2-8751-2738  
[sales@tw.sumida.com](mailto:sales@tw.sumida.com)

### San Jose

Tel.+1-408-321-9660  
FAX.+1-408-321-9308  
[sales@us.sumida.com](mailto:sales@us.sumida.com)