

SMD Power Inductor CDRH40D28

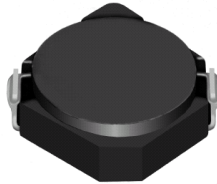

Description

- Ferrite drum core construction.
- Magnetically shielded.
- L × W × H: 4.2 × 4.2 × 3.0 mm Max.
- Product weight: 195mg(Ref.)
- Moisture Sensitivity Level: 1
- RoHS compliance.

Environmental Data

- Operating temperature range: -40°C~+105°C (including coil's self temperature rise)
- Storage temperature range: -40°C~+105°C
- Solder reflow temperature: 260 °C peak.

Packaging

- Carrier tape and reel packaging
- 7.0" diameter reel
- 500pcs per reel

Applications

- Ideally used in Mobilephone, PDA, MP3, DSC/DVC, etc as DC-DC converter inductors.

Dimension - [mm]

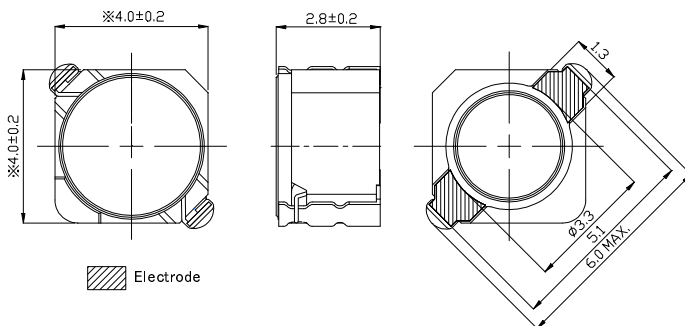

Land pattern and Schematics - [mm]

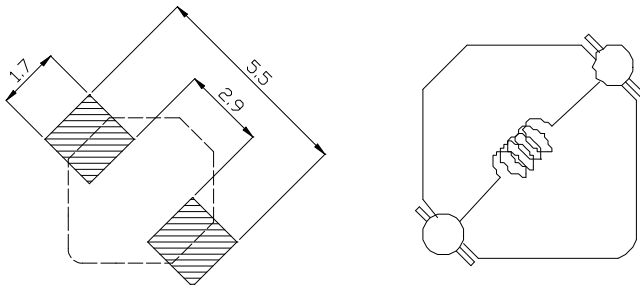

SMD Power Inductor CDRH40D28

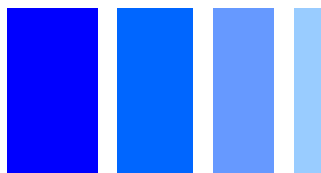

Electrical Characteristics

Part No.	Inductance (μ H) [within]※1	D.C.R. (m Ω) Max. (Typ.) (at 20°C)	Saturation Current (A) ※2		Temperature Rise Current (A) ※3
			at 20°C	at 105°C	
CDRH40D28NP-1R5NC	1.5 \pm 30%	42.0(33.6)	2.90	2.30	2.40
CDRH40D28NP-2R2NC	2.2 \pm 30%	47.0(37.6)	2.20	1.90	2.10
CDRH40D28NP-2R7NC	2.7 \pm 30%	52.0(41.2)	2.10	1.80	2.00
CDRH40D28NP-3R3NC	3.3 \pm 30%	58.0(46.7)	1.90	1.60	1.90
CDRH40D28NP-4R7NC	4.7 \pm 30%	63.0(50.0)	1.65	1.40	1.75
CDRH40D28NP-5R6NC	5.6 \pm 30%	75.0(59.6)	1.50	1.20	1.60
CDRH40D28NP-6R8NC	6.8 \pm 30%	80.0(64.0)	1.30	1.05	1.55
CDRH40D28NP-100PC	10 \pm 25%	125(100)	1.10	0.90	1.20
CDRH40D28NP-120PC	12 \pm 25%	151(121)	1.00	0.80	1.10
CDRH40D28NP-150PC	15 \pm 25%	218(174)	0.90	0.75	0.88
CDRH40D28NP-180PC	18 \pm 25%	231(185)	0.85	0.70	0.83
CDRH40D28NP-220PC	22 \pm 25%	264(211)	0.80	0.65	0.80
CDRH40D28NP-330PC	33 \pm 25%	420(336)	0.62	0.52	0.55
CDRH40D28NP-390PC	39 \pm 25%	619(495)	0.60	0.50	0.48
CDRH40D28NP-470PC	47 \pm 25%	685(548)	0.50	0.40	0.45
CDRH40D28NP-560PC	56 \pm 25%	755(604)	0.45	0.35	0.43
CDRH40D28NP-680PC	68 \pm 25%	836(669)	0.42	0.32	0.40

※1. Inductance measuring condition: at 100kHz.

※2. Saturation current: The value of D.C. current when the inductance decreases to 65% of it's nominal value.

※3. Temperature rise current: The value of D.C. current when the temperature rise is $\Delta t=40^{\circ}\text{C}$ ($T_a=20^{\circ}\text{C}$).

SMD Power Inductor CDRH40D28



Saturation Current & Temperature Rise Graph

— L (20°C) — L (105°C) — ΔT

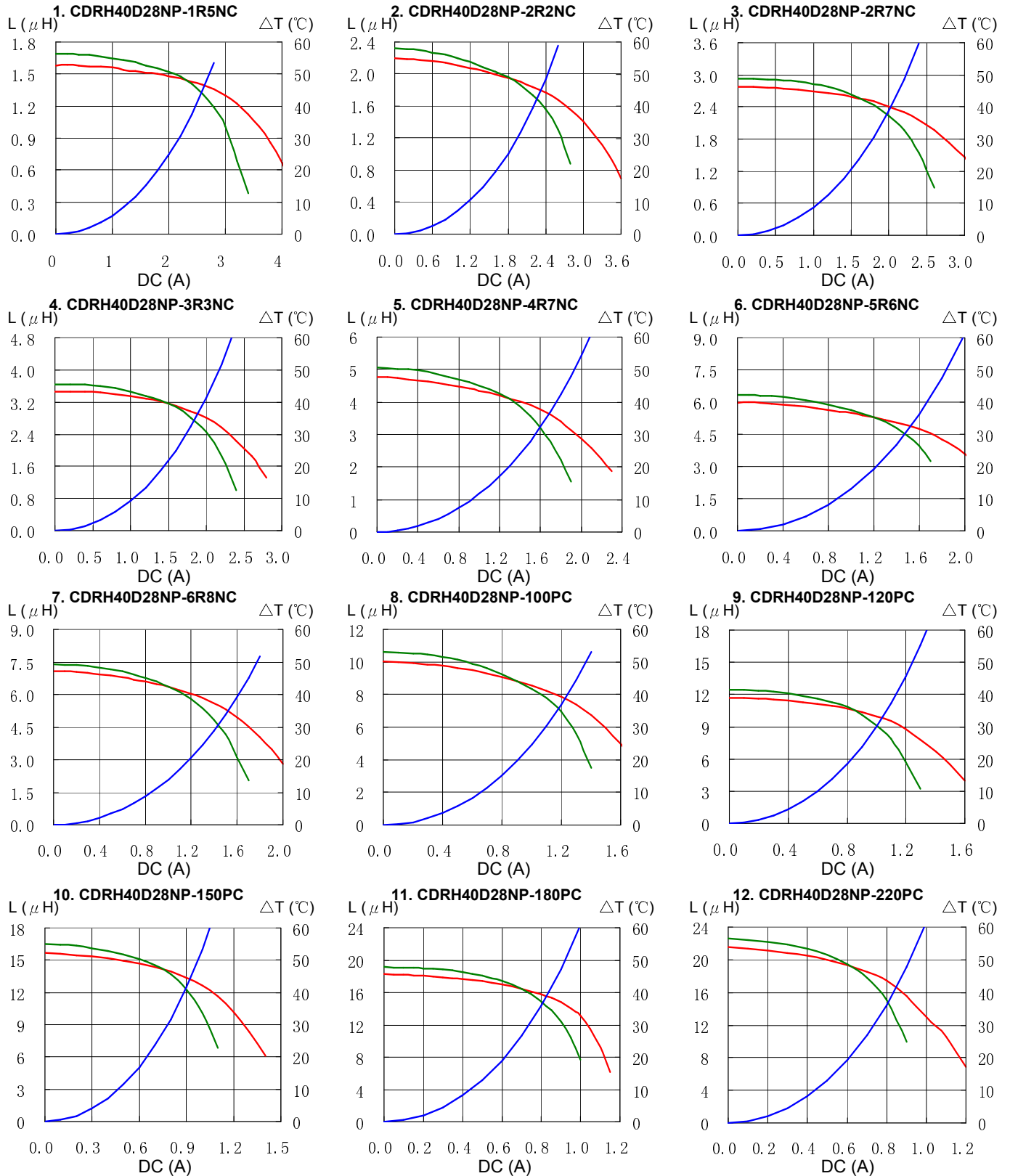

SMD Power Inductor CDRH40D28



Saturation Current & Temperature Rise Graph

— L (20°C) — L (105°C) — ΔT

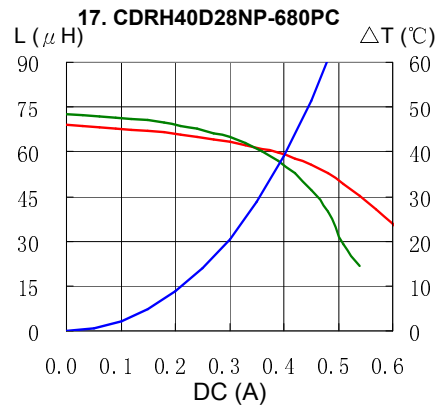
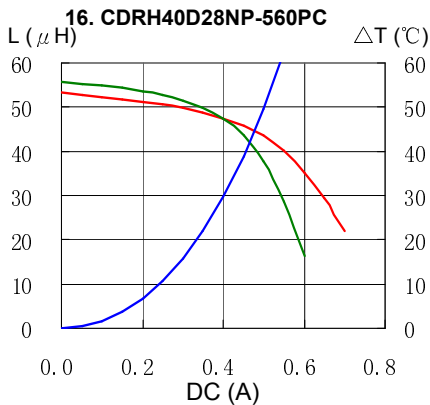
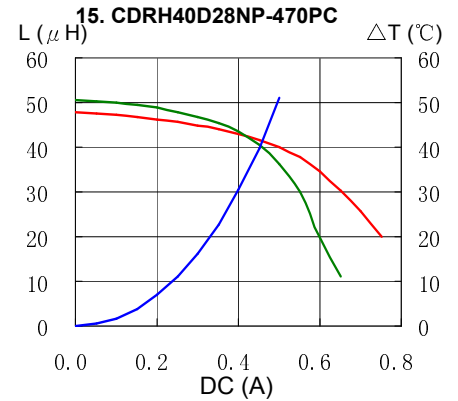
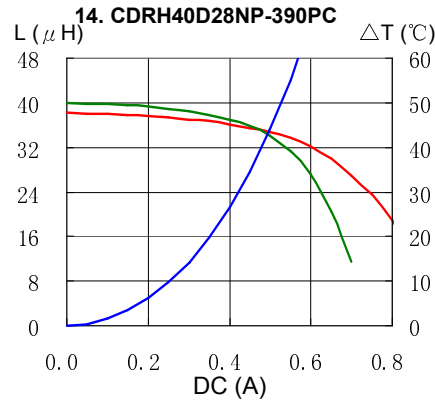
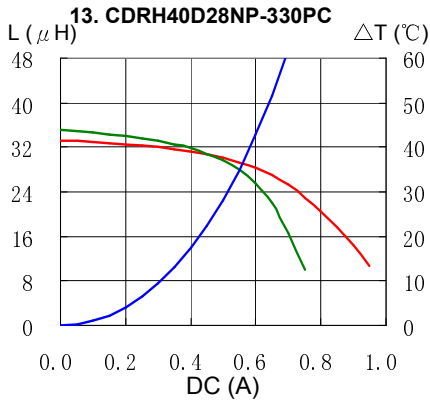

Solder Reflow Condition

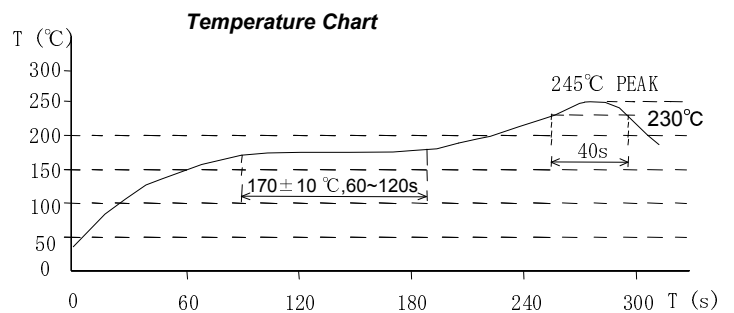
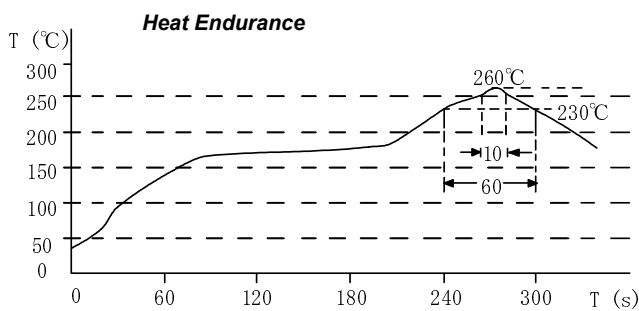

Please refer to the sales offices on our website - <http://www.sumida.com>

Hong Kong
Tel.+852-2880-6781
FAX.+852-2565-9600
sales@hk.sumida.com

Saitama(Japan)
Tel.+81-48-691-7300
FAX.+81-48-691-7340
sales@jp.sumida.com

Chicago
Tel.+1-847-545-6700
FAX. +1-847-545-6720
sales@us.sumida.com

Shanghai
Tel.+86-21-5836-3299
FAX.+86-21-5836-3266
shanghai.sales@cn.sumida.com

Seoul
Tel.+82-2-6237-0777
FAX.+82-2-6237-0778
sales@kr.sumida.com

Oberzell
Tel.+49-8591-937-0
FAX. +49-8591-937-103
contact@eu.sumida.com

Shenzhen
Tel.+86-755-8291-0228
FAX.+86-755-8291-0338
shenzhen.sales@cn.sumida.com

Singapore
Tel.+65-6296-3388
FAX.+65-6841-4426
sales@sg.sumida.com

Neumarkt
Tel.+49-9181-4509-110
FAX. +49-9181-4509-310
infocomp@eu.sumida.com

Taipei
Tel.+886-2-8751-2737
FAX.+886-2-8751-2738
sales@tw.sumida.com

San Jose
Tel.+1-408-321-9660
FAX.+1-408-321-9308
sales@us.sumida.com