

CDRH4D22

DIMENSIONS (mm)
外形寸法図

LAND PATTERNS (mm)
推奨ランド寸法

CONSTRUCTION
磁気構造図

(1.5μH - 150μH)

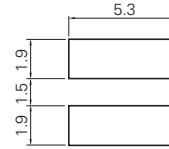
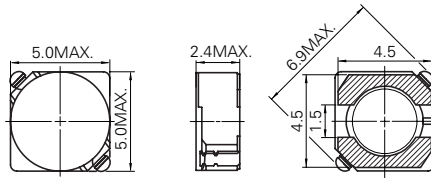

CDRH4D28

DIMENSIONS (mm)
外形寸法図

LAND PATTERNS (mm)
推奨ランド寸法

CONSTRUCTION
磁気構造図

(1.2μH - 180μH)

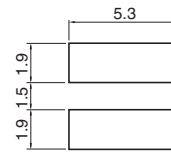
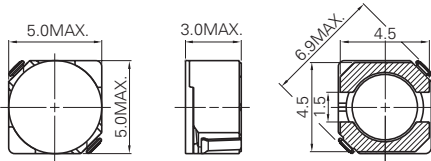

CDRH4D28C

DIMENSIONS (mm)
外形寸法図

LAND PATTERNS (mm)
推奨ランド寸法

CONSTRUCTION
磁気構造図

(1.1μH - 100μH)

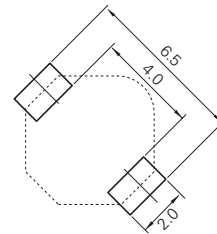
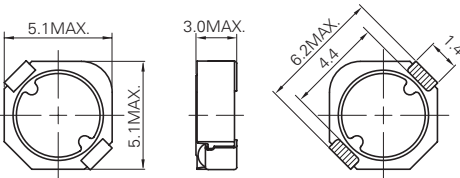

CDRH4D28C/LD

DIMENSIONS (mm)
外形寸法図

LAND PATTERNS (mm)
推奨ランド寸法

CONSTRUCTION
磁気構造図

(1.0μH - 100μH)

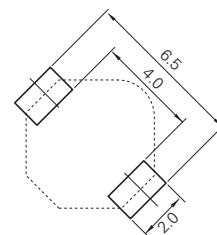
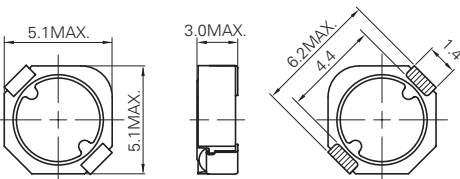

TYPE : CDRH4D22, CDRH4D28, CDRH4D28C, CDRH4D28C/LD

| Parts No. | L (H) | CDRH4D22 | | | CDRH4D28 | | CDRH4D28C | | CDRH4D28C/LD | | | |
|-----------|-------|------------------------|---------------------------------|--------|--|------------------------|----------------------|------------------------|----------------------|------------------------|---------------------------------|---------------------------------------|
| | | D.C.R.(Ω) : Max.(Typ.) | Saturation Rated Current (A) *C | | Temperature Rise Current (Typ.)(A) *IV | D.C.R.(Ω) : Max.(Typ.) | Rated Current (A) *3 | D.C.R.(Ω) : Max.(Typ.) | Rated Current (A) *3 | D.C.R.(Ω) : Max.(Typ.) | Saturation Rated Current (A) *C | Temperature Rise Rated Current (A) *I |
| | | | 20 °C | 100 °C | | | | | | | | |
| 1R0 | 1.0μ | | | | | | | | 17.5m(14m) | 3.0 | 4.9 | |
| 1R1 | 1.1μ | | | | | | 22m(17.5m) | 3.8 | | | | |
| 1R2 | 1.2μ | | | | 23.6m(17.5m) | 2.56 | | | | | | |
| 1R5 | 1.5μ | 18.3m(14.1m) | 2.00 | 1.60 | 4.20 | | | | | | | |
| 1R8 | 1.8μ | 21.6m(16.6m) | 1.90 | 1.50 | 3.70 | 27.5m(20.4m) | 2.20 | | | | | |
| 2R0 | 2.0μ | | | | | | 29m(23.0m) | 2.6 | | | | |
| 2R2 | 2.2μ | | | | | 31.3m(23.2m) | 2.04 | | 23.8m(19m) | 2.0 | 3.6 | |
| 2R3 | 2.3μ | 25.4m(19.5m) | 1.80 | 1.40 | 3.60 | | | | | | | |
| 2R7 | 2.7μ | | | | | 43.3m(32.1m) | 1.60 | | | | | |
| 3R2 | 3.2μ | | | | | | 42m(33.3m) | 2.3 | | | | |
| 3R3 | 3.3μ | 35.1m(27.0m) | 1.40 | 1.10 | 3.07 | 49.2m(36.4m) | 1.57 | | 28.9m(23m) | 1.6 | 3.2 | |
| 3R9 | 3.9μ | 40.2m(30.9m) | 1.30 | 1.00 | 3.04 | 64.8m(48.0m) | 1.44 | | | | | |
| 4R7 | 4.7μ | 55.9m(43.0m) | 1.10 | 900m | 2.08 | 72.0m(53.3m) | 1.32 | 63m(50.0m) | 1.8 | 36.3m(29m) | 1.5 | 2.9 |
| 5R6 | 5.6μ | 62.0m(47.7m) | 1.05 | 850m | 2.05 | 100.9m(74.7m) | 1.17 | | | | | |
| 6R3 | 6.3μ | | | | | | 94m(75.0m) | 1.3 | | | | |
| 6R8 | 6.8μ | 88.0m(67.7m) | 1.00 | 750m | 1.95 | 108.9m(80.7m) | 1.12 | | 48.8m(39m) | 1.2 | 2.4 | |
| 8R2 | 8.2μ | 96.5m(74.2m) | 900m | 650m | 1.85 | 117.5m(87.0m) | 1.04 | | | | | |
| 100 | 10μ | 102.4m(78.8m) | 800m | 600m | 1.82 | 128.3m(95.0m) | 1.00 | 106m(85.0m) | 1.26 | 67.5m(54m) | 900m | 1.8 |
| 120 | 12μ | 110.4m(84.9m) | 750m | 550m | 1.80 | 131.6m(97.5m) | 840m | | | | | |
| 150 | 15μ | 127.4m(98.0m) | 680m | 500m | 1.59 | 149.0m(110.4m) | 760m | 137m(110.0m) | 1.05 | 93.4m(75m) | 810m | 1.6 |
| 180 | 18μ | 168.7m(129.8m) | 600m | 430m | 1.41 | 166.0m(123.0m) | 720m | | | | | |
| 220 | 22μ | 199.7m(153.6m) | 540m | 410m | 1.32 | 235.0m(174.5m) | 700m | 207m(166.0m) | 850m | 140m(112m) | 650m | 1.25 |
| 270 | 27μ | 282.5m(217.3m) | 510m | 380m | 1.04 | 261.0m(193.3m) | 580m | | | | | |
| 330 | 33μ | 325.8m(250.6m) | 480m | 350m | 1.02 | 331.3m(254.8m) | 560m | 331m(265.0m) | 700m | 223m(179m) | 550m | 920m |
| 390 | 39μ | 451.2m(347.1m) | 430m | 320m | 850m | 383.7m(284.2m) | 500m | | | | | |
| 470 | 47μ | 500.4m(384.9m) | 380m | 300m | 820m | 587.0m(435.0m) | 480m | 510m(408.0m) | 540m | 272m(218m) | 430m | 860m |
| 560 | 56μ | 555.4m(427.2m) | 360m | 280m | 720m | 624.5m(462.6m) | 410m | | | | | |
| 680 | 68μ | 634.1m(487.8m) | 330m | 250m | 670m | 699.0m(517.8m) | 350m | 625m(500.0m) | 490m | 366m(293m) | 360m | 720m |
| 820 | 82μ | 794.6m(608.9m) | 300m | 220m | 580m | 914.8m(677.6m) | 320m | | | | | |
| 101 | 100μ | 880m(670 m) | 250m | 200m | 550m | 1.02(765.8m) | 290m | 948m(758.0m) | 400m | 520m(416m) | 300m | 610m |
| 121 | 120μ | 1.14(880 m) | 230m | 180m | 520m | 1.27(976.8m) | 270m | | | | | |
| 151 | 150μ | 1.35(1.04) | 210m | 170m | 470m | 1.35(1.08) | 240m | | | | | |
| 181 | 180μ | | | | | 1.54(1.23) | 220m | | | | | |

Measuring Freq. (L) / インダクタンス測定周波数 (L)

CDRH4D22 100kHz
 CDRH4D28 100kHz
 CDRH4D28C 100kHz
 CDRH4D28C/LD 100kHz

Tolerance of Inductance / インダクタンス公差

CDRH4D22 1.5μH - 150μH ± 30% (N)
 CDRH4D28 1.2μH - 180μH ± 30% (N)
 CDRH4D28C 1.1μH - 100μH ± 25%
 CDRH4D28C/LD 1.0μH - 100μH ± 25%

Rated Current / 定格電流とは

*3 It is either the inductance is 35% lower than its nominal value in D.C. saturation characteristics or temperature raise becomes ΔT=40°C(Ta=20 °C), whichever is lower.
 *3 直流量許容電流において、定格電流を流した時、インダクタンスが公称インダクタンスの65%以上となる電流値もしくは、コイルの発熱がΔT=40°C以下となる電流のどちらか少ない方の値とする。(Ta=20°C)

Other / その他

*C Saturation Rated Current : The current when the inductance becomes 35% lower than its nominal value.(Ta=20 °C)
 *C 直流量許容電流:直流量許容電流を流した時、インダクタンスが公称インダクタンスの65%以上となる電流値とする。(Ta=20°C)

*I Temperature Rise Rated Current : The current when temperature of coil increases up to Max.ΔT=40 °C. (Ta=20 °C)

*I 温度上昇許容電流:直流量を流した時、コイルの温度上昇がΔT=40°C以下となる電流値とする。(Ta=20°C)

*IV Temperature Rise Current (Typ.) : The actual current when temperature of coil becomes ΔT=40 °C. (Ta=20 °C)

*IV 温度上昇実力電流:直流量を流した時、コイルの温度上昇がΔT=40°Cとなる電流の実力値とする。(Ta=20°C)

About Lead-free products / 無鉛製品について

- Lead-free products are now available for sale
- To order a lead-free product, please add"NP" after the product type:
- 無鉛製品は現在、販売されております。
- ご注文の際は製品タイプ名の後に" NP" をつけてください。
- e.g. Ordering code of lead product: Type name-△△△○×
- Ordering code of lead-free product: Type name NP △△△○×