

# SMD Power Inductor CDRH7D58R/A



## Description

- Ferrite drum core construction.
- Magnetically shielded.
- L × W × H: 7.2 × 7.2 × 6.0 mm Max.
- Product weight: 1.0g(Ref.)
- Moisture Sensitivity Level: 1
- RoHS compliance.

## Environmental Data

- Operating temperature range: -40°C~+125°C (excluding coil's self temperature rise)
- Storage temperature range: -40°C~+85°C
- Solder reflow temperature: 260 °C peak.

## Packaging

- Carrier tape and reel packaging

## Applications

- Automotive.

## Dimension - [mm]

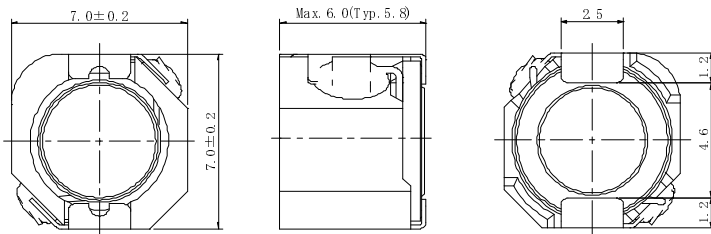

## Land pattern and Schematics - [mm]

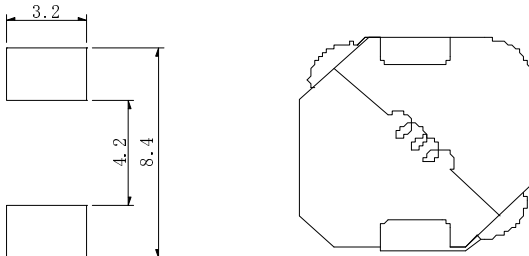

## Electrical Characteristics

PART NO.	STAMP	INDUCTANCE [WITHIN]※1	D.C.R. (mΩ) [Max.](at 20°C) ※2	Rated Current(A) (at125°C) ※3
CDRH7D58R/ANP-100MC	A	10 μH±20%	38(31)	1.82
CDRH7D58R/ANP-150MC	B	15 μH±20%	48(39)	1.53
CDRH7D58R/ANP-220MC	C	22 μH±20%	96(77)	1.28
CDRH7D58R/ANP-330MC	D	33 μH±20%	158(127)	1.08
CDRH7D58R/ANP-470MC	E	47 μH±20%	195(156)	0.86
CDRH7D58R/ANP-680MC	F	68 μH±20%	275(220)	0.73
CDRH7D58R/ANP-101MC	G	100 μH±20%	487(390)	0.58
CDRH7D58R/ANP-151MC	H	150 μH±20%	612(490)	0.47
CDRH7D58R/ANP-221MC	I	220 μH±20%	787(630)	0.38

※1 Measuring frequency inductance at 100kHz.

※2. Rated current: The DC current at which the inductance decreases to 65% of its nominal value or when Δt=30°C, whichever is lower (Ta=20°C).

# SMD Power Inductor CDRH7D58R/A



## Saturation Current & Temperature Rise Graph

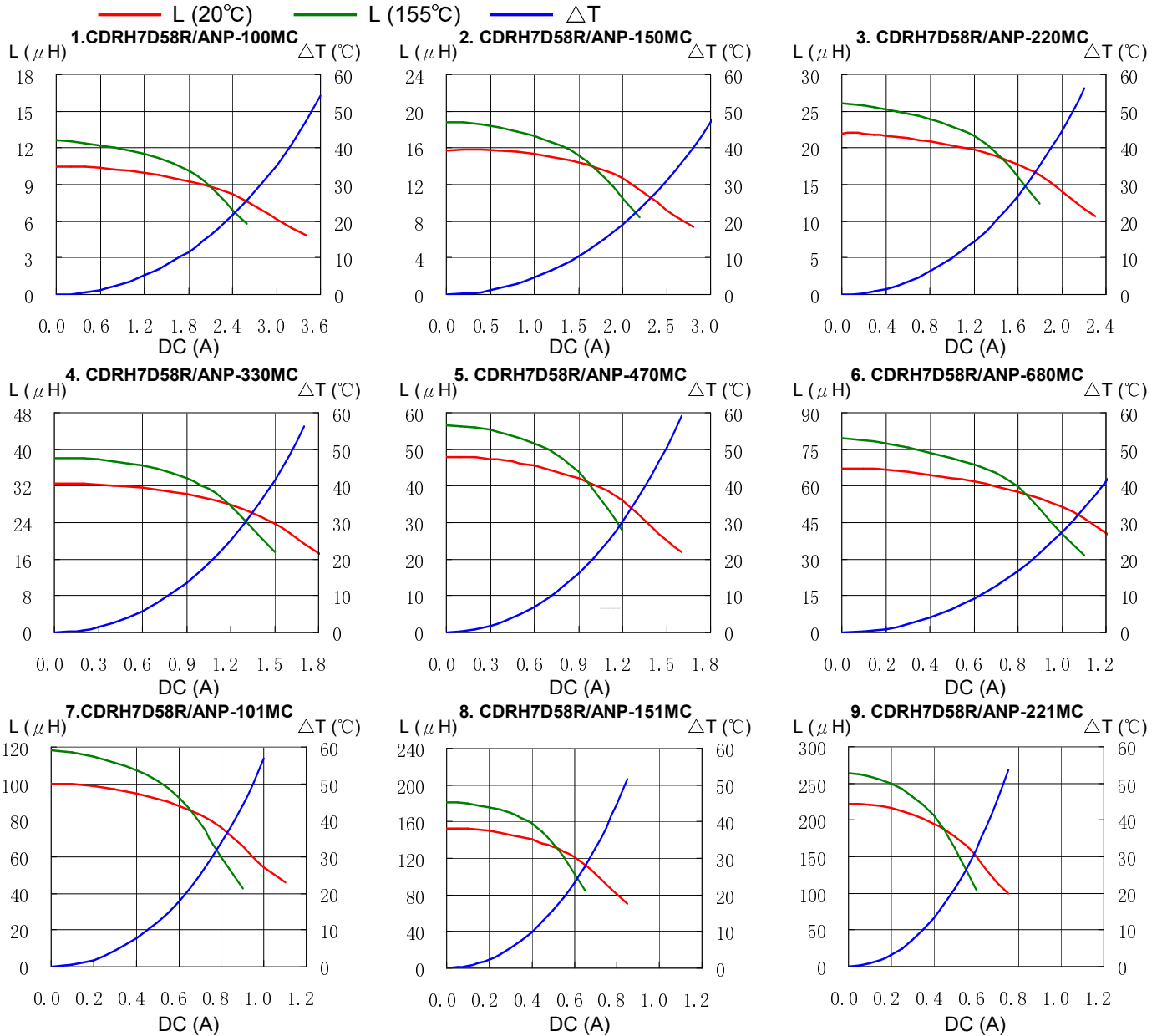

# SMD Power Inductor CDRH7D58R/A



## Solder Reflow Condition

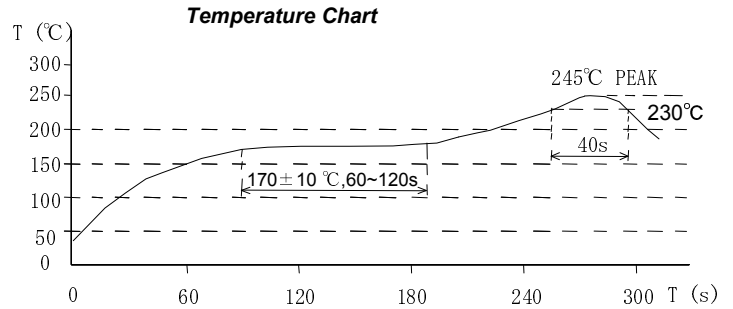
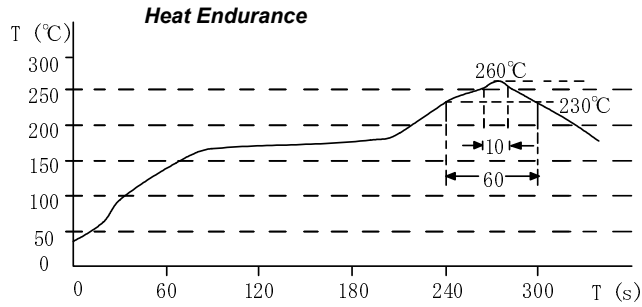

Please refer to the sales offices on our website - <http://www.sumida.com>

### Hong Kong

Tel.+852-2880-6688  
FAX.+852-2565-9600  
[sales@hk.sumida.com](mailto:sales@hk.sumida.com)

### Tokyo

Tel.+81-3-5202-7112  
FAX.+81-3-5202-7105  
[sales@jp.sumida.com](mailto:sales@jp.sumida.com)

### Chicago

Tel.+1-847-545-6700  
FAX. +1-847-545-6720  
[sales@us.sumida.com](mailto:sales@us.sumida.com)

### Shanghai

Tel.+86-021-5836-3299  
FAX.+86-021-5836-3266  
[shanghai.sales@cn.sumida.com](mailto:shanghai.sales@cn.sumida.com)

### Seoul

Tel.+82-2-6237-0777  
FAX.+82-2-6237-0778  
[sales@kr.sumida.com](mailto:sales@kr.sumida.com)

### Oberzell

Tel.+49-8591-937-0  
FAX. +49-8591-937-103  
[contact@sumida-eu.com](mailto:contact@sumida-eu.com)

### Shenzhen

Tel.+86-755-8291-0228  
FAX.+86-755-8291-0338  
[shenzhen.sales@cn.sumida.com](mailto:shenzhen.sales@cn.sumida.com)

### Singapore

Tel.+65-6296-3388  
FAX.+65-6296-3390  
[sales@sg.sumida.com](mailto:sales@sg.sumida.com)

### Neumarkt

Tel.+49-9181-4509-110  
FAX. +49-9181-4509-310  
[infocomp@eu.sumida.com](mailto:infocomp@eu.sumida.com)

### Taipei

Tel.+886-2-8751-2737  
FAX.+886-2-8751-2738  
[sales@tw.sumida.com](mailto:sales@tw.sumida.com)

### San Jose

Tel.+1-408-3219660  
FAX.+1-408-321-9308  
[sales@us.sumida.com](mailto:sales@us.sumida.com)