

CF Series

PTH SMPS Current Transformer Up to 15A

www.DataSheet4U.com

Features

- Specially designed for current-mode feedback in PWM switched mode power supplies and converters.
- Fully encapsulated in Polyurethane according to UL94 V0.
- Frequency range from 5 - 200 KHz.
- Isolation Primary to Secondary 2750 Vac.
- Extended isolation to full fill EN60950 standard available on request.
- Maximum primary current 15 A rms.
- Operating temperature from -20° C to 85° C.

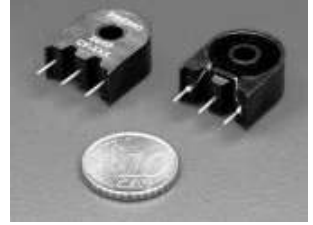

Product List

Part Number	Prim/Sec Ratio	Ip (ARMS Max)	Sec L (mH Min)	Sec Rcu (Ω Max)	V x τ (Max)
CF 050	1/50	15	5.0	0.65	175 VμS
CF 100	1/100	15	22.0	1.30	350 VμS
CF 200	1/200	15	94.5	4.50	700 VμS

Notes:

- L: Inductance: (1-3) tested at 10 KHz & 10 mV
- V x τ: $V = RB \times I_s \quad t = 1/2F$
- IP (A): Primary current
- RB (W): Recommended Terminating Resistance
- Is (A): Secondary current
- F (Hz): Frequency

Dimensions

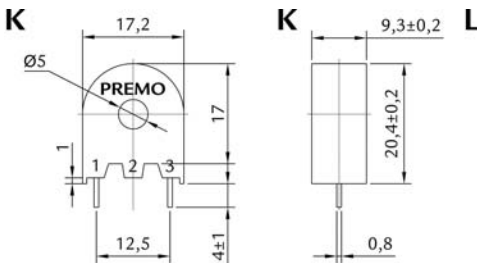

Test Circuit and Schematics

