

CHL 0640-N Crimp Terminal Housing

2.5mm Pitch Wire to Board

FEATURES AND SPECIFICATIONS

Electrical

Voltage Rating : 250VAC max
 Current Rating : 3A max
 Contact Resistance : 30mΩ max
 Insulation Resistance : 1,000MΩ min
 Dielectric Withstanding Voltage : 1,000VAC for 60 seconds

Physical

Housing : Nylon66, UL94V Grade
 Operating Temperature : -40°C ~ +105°C

Reference Information

Mates With : LAL0640-N, LWL0640-N Series
 Packing : Bag
 UL File No : E92854
 Designed In : Millimeters

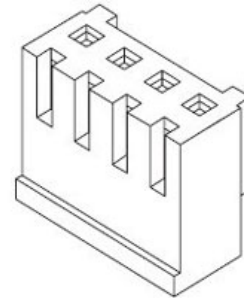

DIMENSIONS (FOR REFERENCE ONLY)

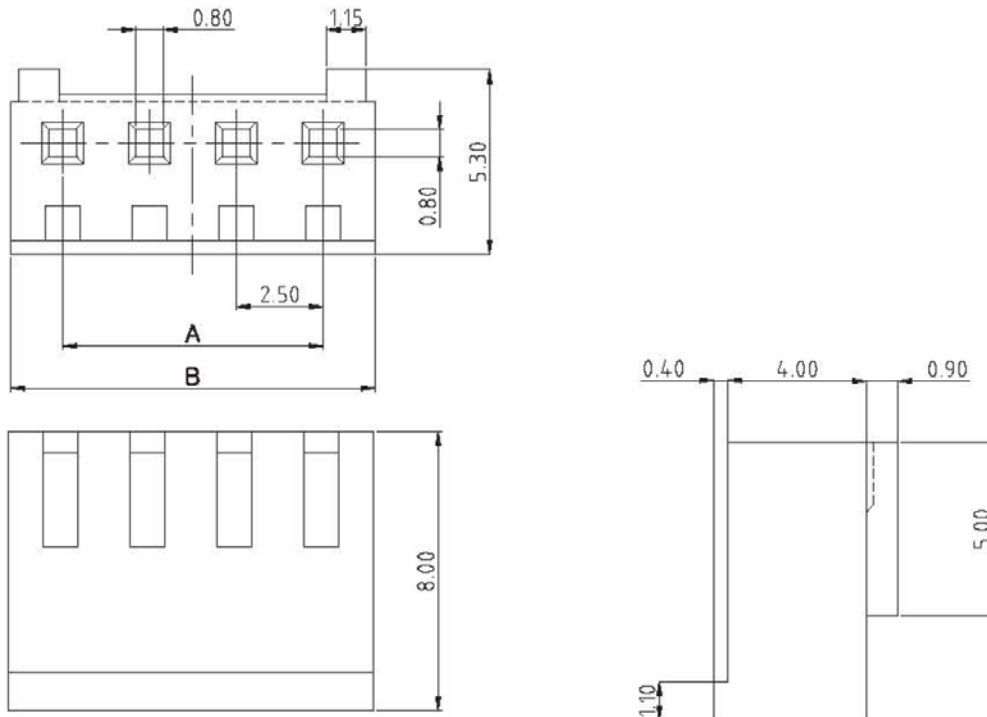

ORDERING INFORMATION AND DIMENSIONS

CKT	MODEL NO.	A	B	CKT	MODEL NO.	A	B
2	CHL0640-02	2.5	5.5	9	CHL0640-09	20.0	23.0
3	CHL0640-03	5.0	8.0	10	CHL0640-10	22.5	25.5
4	CHL0640-04	7.5	10.5	11	CHL0640-11	25.0	28.0
5	CHL0640-05	10.0	13.0	12	CHL0640-12	27.5	30.5
6	CHL0640-06	12.5	15.5	13	CHL0640-13	30.0	33.0
7	CHL0640-07	15.0	18.0	14	CHL0640-14	32.5	35.5
8	CHL0640-08	17.5	20.5	15	CHL0640-15	35.0	38.0