

SILICON PLANAR POWER TRANSISTORS

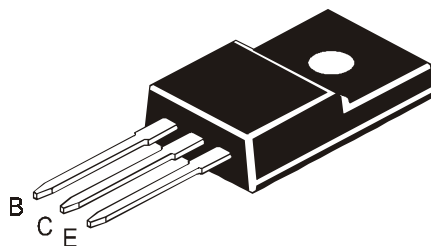

NPN

CJF31

CJF31A

CJF31B

CJF31C

PNP

CJF32

CJF32A

CJF32B

CJF32C

**TO-220FP Fully Isolated
Plastic Package**

Designed for use in General Purpose Amplifier and Switching Applications

ABSOLUTE MAXIMUM RATINGS

| DESCRIPTION | SYMBOL | CJF31 CJF32 | CJF31A CJF32A | CJF31B CJF32B | CJF31C CJF32C | UNIT |
|---|--------------|---------------------------|------------------|------------------|------------------|---------------------|
| Collector Base Voltage | V_{CBO} | 40 | 60 | 80 | 100 | V |
| Collector Emitter Voltage | V_{CEO} | 40 | 60 | 80 | 100 | V |
| Emitter Base Voltage | V_{EBO} | ←————— 5 —————→ | | | | V |
| Collector Current - Continuous Peak | I_C | ←————— 3 —————→ | | | | A |
| | | ←————— 5 —————→ | | | | A |
| Base Current | I_B | ←————— 1 —————→ | | | | A |
| Total Power Dissipation @ $T_c=25^\circ\text{C}$ | P_D | ←————— 40 —————→ | | | | W |
| Derate Above 25°C | | ←————— 0.32 —————→ | | | | W/ $^\circ\text{C}$ |
| Total Power Dissipation @ $T_a=25^\circ\text{C}$ | P_D | ←————— 2 —————→ | | | | W |
| Derate Above 25°C | | ←————— 0.016 —————→ | | | | W/ $^\circ\text{C}$ |
| Operating and Storage Junction Temperature Range | $T_{j,Tstg}$ | ←————— -65 to +150 —————→ | | | | $^\circ\text{C}$ |

THERMAL RESISTANCE

| | | | |
|--------------------------|---------------|---------------------|--------------------|
| From Junction to Ambient | $R_{th(j-a)}$ | ←————— 62.5 —————→ | $^\circ\text{C/W}$ |
| From Junction to Case | $R_{th(j-c)}$ | ←————— 3.125 —————→ | $^\circ\text{C/W}$ |

ELECTRICAL CHARACTERISTICS ($T_c=25^\circ\text{C}$ unless specified otherwise)

| DESCRIPTION | SYMBOL | TEST CONDITION | MIN | MAX | UNIT |
|---------------------------------|------------------|---|-----|-----|---------------|
| Collector Emitter (sus) Voltage | $V_{CEO(sus)}$ * | $I_C=30\text{mA}, I_B=0$ | | | |
| | | CJF31, CJF32 | 40 | - | V |
| | | CJF31A, CJF32A | 60 | - | V |
| | | CJF31B, CJF32B | 80 | - | V |
| | | CJF31C, CJF32C | 100 | - | V |
| Collector Cut off Current | I_{CEO} | CJF31/31A, CJF32/32A $V_{CE}=30\text{V}, I_B=0$ | - | 0.3 | mA |
| | | CJF31B/31C, CJF32B/32C $V_{CE}=60\text{V}, I_B=0$ | - | 0.3 | mA |
| Collector Cut off Current | I_{CES} | $V_{CE}=\text{Rated } V_{CES}, V_{EB}=0$ | - | 200 | μA |
| Emitter Cut off Current | I_{EBO} | $V_{BE}=5\text{V}, I_C=0$ | - | 1.0 | mA |

SILICON PLANAR POWER TRANSISTORS

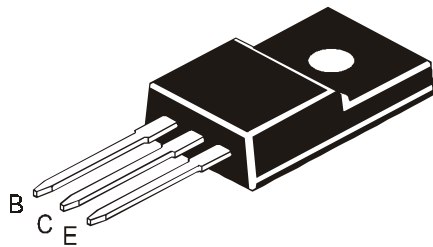

NPN

CJF31
CJF31A
CJF31B
CJF31C

PNP

CJF32
CJF32A
CJF32B
CJF32C

**TO-220FP Fully Isolated
Plastic Package**

ELECTRICAL CHARACTERISTICS ($T_C=25^\circ\text{C}$ unless specified otherwise)

| DESCRIPTION | SYMBOL | TEST CONDITION | MIN | MAX | UNIT |
|--------------------------------------|-----------------|--|----------|---------|------|
| DC Current Gain | h_{FE}^* | $I_C=1.0\text{A}$, $V_{CE}=4\text{V}$ $I_C=3.0\text{A}$, $V_{CE}=4\text{V}$ | 25 10 | - 50 | |
| Collector Emitter Saturation Voltage | $V_{CE(sat)}^*$ | $I_C=3\text{A}$, $I_B=375\text{mA}$ | - | 1.2 | V |
| Base Emitter on Voltage | $V_{BE(on)}^*$ | $I_C=3.0\text{A}$, $V_{CE}=4\text{V}$ | - | 1.8 | V |
| DYNAMIC CHARACTERISTICS | | | | | |
| Current Gain - Bandwidth Product ** | f_T | $I_C=500\text{mA}$, $V_{CE}=10\text{V}$ $f_{test}=1\text{MHz}$ | 3.0 | - | MHz |
| Small Signal Current Gain | $ h_{fe} $ | $I_C=0.5\text{A}$, $V_{CE}=10\text{V}$ $f=1\text{kHz}$ | 20 | - | |

* Pulse Test: Pulse Width $\leq 300\mu\text{s}$, Duty Cycle $\leq 2\%$

** $f_T = |h_{fe}| f_{test}$

| | |
|---------------|---------------|
| NPN | PNP |
| CJF31 | CJF32 |
| CJF31A | CJF32A |
| CJF31B | CJF32B |
| CJF31C | CJF32C |

TO-220FP Fully Isolated Plastic Package

TO-220FP Fully Isolated Plastic Package

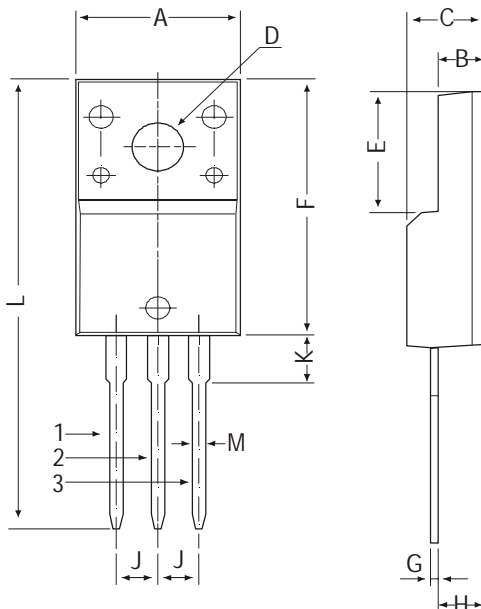

| DIM | MIN | MAX |
|-----|-------|-------|
| A | 9.96 | 10.36 |
| B | 2.60 | 3.00 |
| C | 4.50 | 4.90 |
| D | 3.10 | 3.30 |
| E | 7.90 | 8.20 |
| F | 16.87 | 17.27 |
| G | 0.45 | 0.50 |
| H | 2.56 | 2.96 |
| J | 2.34 | 2.74 |
| K | — | 3.08 |
| L | — | 30.05 |
| M | — | 0.80 |

All dimensions in mm.

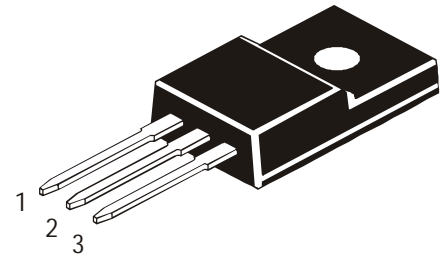

Pin Configuration

1. Base
2. Collector
3. Emitter

TO-220 FP Tube Packing

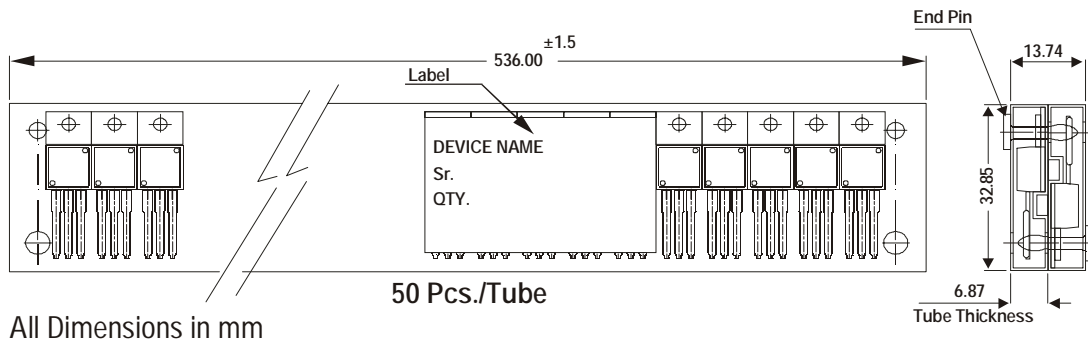

All Dimensions in mm

50 Pcs./Tube

AMMO PACK SIZE

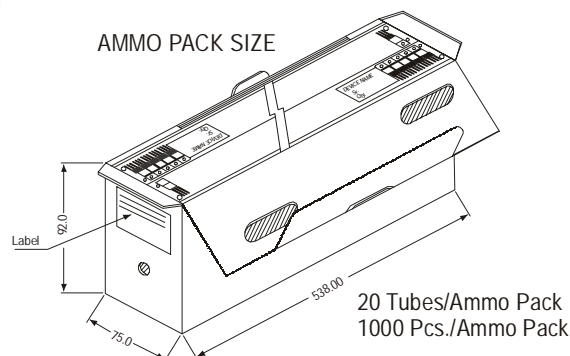

Packing Detail

| PACKAGE | STANDARD PACK | | INNER CARTON BOX | | OUTER CARTON BOX | | |
|----------|-----------------|----------------|---------------------|-----|-------------------|-----|--------|
| | Details | Net Weight/Qty | Size | Qty | Size | Qty | Gr Wt |
| TO-220FP | 200 pcs/polybag | 396 gm/200 pcs | 3" x 7.5" x 7.5" | 1K | 17" x 15" x 13.5" | 16K | 36 kgs |
| | 50 pcs/tube | 135 gm/50 pcs | 3.5" x 3.7" x 21.5" | 1K | 19" x 19" x 19" | 10K | 28 kgs |

| NPN | PNP |
|--------|--------|
| CJF31 | CJF32 |
| CJF31A | CJF32A |
| CJF31B | CJF32B |
| CJF31C | CJF32C |

**TO-220FP Fully Isolated
Plastic Package**

Disclaimer

The product information and the selection guides facilitate selection of the CDIL's Discrete Semiconductor Device(s) best suited for application in your product(s) as per your requirement. It is recommended that you completely review our Data Sheet(s) so as to confirm that the Device(s) meet functionality parameters for your application. The information furnished in the Data Sheet and on the CDIL Web Site/CD is believed to be accurate and reliable. CDIL however, does not assume responsibility for inaccuracies or incomplete information. Furthermore, CDIL does not assume liability whatsoever, arising out of the application or use of any CDIL product; neither does it convey any license under its patent rights nor rights of others. These products are not designed for use in life saving/support appliances or systems. CDIL customers selling these products (either as individual Discrete Semiconductor Devices or incorporated in their end products), in any life saving/support appliances or systems or applications do so at their own risk and CDIL will not be responsible for any damages resulting from such sale(s).

CDIL strives for continuous improvement and reserves the right to change the specifications of its products without prior notice.



CDIL is a registered Trademark of

Continental Device India Limited

C-120 Naraina Industrial Area, New Delhi 110 028, India.

Telephone + 91-11-579 6150 Fax + 91-11-579 9569, 579 5290

e-mail sales@cdil.com www.cdil.com