

**CMS1600**

**Standard-A Receptacle**

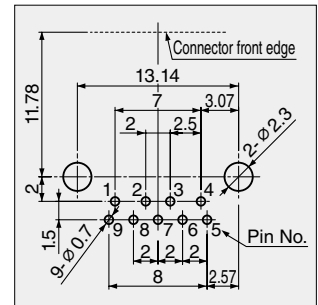

**CMS1600-010020**

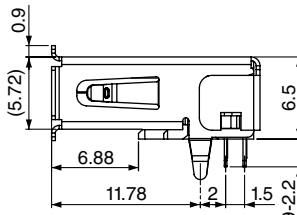
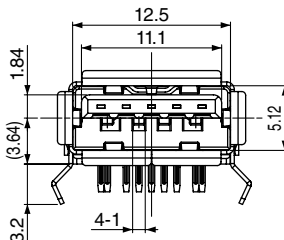
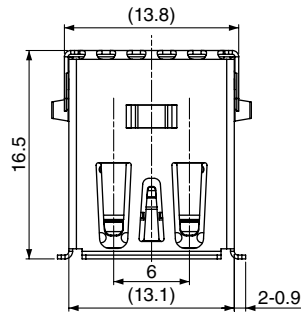

**Hole Layout  
(Bottom View)**

Rated	Power Line : 1.8A 30V AC Signal Line : 0.25A 30V AC
Contact Resistance	• Power-Ground Initial : 30mΩ max. • Other Contacts Initial : 50mΩ max.
Insulation Resistance	100MΩ min. at 100V DC
Withstanding Voltage	100V AC/1 minute
Insertion & Withdrawal Force	Insertion Force Initial : 35N max. Withdrawal Force Initial : 10N min.

**CMS1620**

**Standard-B Receptacle**



**CMS1620-010020**

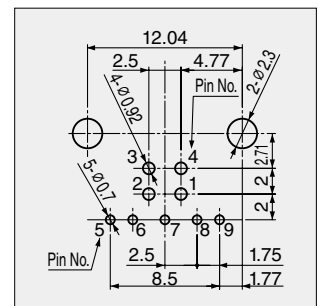
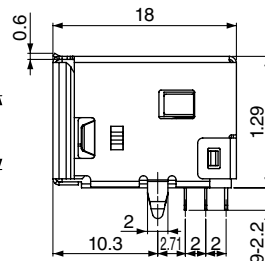
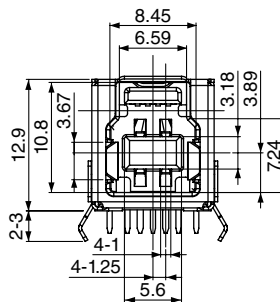
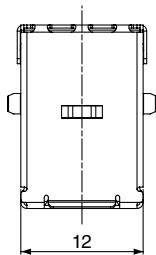

**Hole Layout  
(Bottom View)**

Rated	Power Line : 1.8A 30V AC Signal Line : 0.25A 30V AC
Contact Resistance	• Power-Ground Initial : 30mΩ max. • Other Contacts Initial : 50mΩ max.
Insulation Resistance	100MΩ min. at 100V DC
Withstanding Voltage	100V AC/1 minute
Insertion & Withdrawal Force	Insertion Force Initial : 35N max. Withdrawal Force Initial : 10N min.