

# Magnetic Transducer (AC)

Washing Label

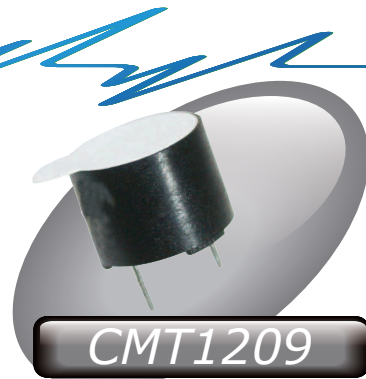
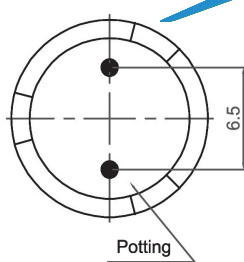
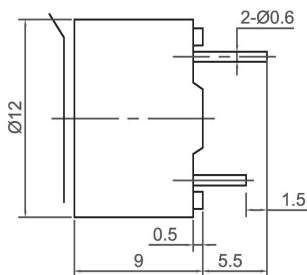
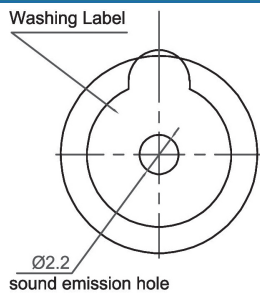

CMT1209

Canopus Part no.	Operating Voltage (V)	Rated Voltage (V)	Max Rated Current (mA)	Coil Resistance ( $\Omega$ )	Min Sound Output (dBA)	Resonant Frequency (Hz)	Operating Temperature ( $^{\circ}$ C)	Housing	Weight (g)
CMT1209A2048NP	1 ~ 2	1.5	70	6.5 $\pm$ 1	75 at 10cm	2048	-20 ~ +60	Noryl	2
CMT1209A2400NP	1 ~ 3	1.5	70	6.5 $\pm$ 1	75 at 10cm	2400	-20 ~ +60	Noryl	2
CMT1209E2048NP	3 ~ 8	5	40	47 $\pm$ 5	85 at 10cm	2048	-40 ~ +85	Noryl	2
CMT1209E2200NP	3 ~ 8	5	40	47 $\pm$ 5	85 at 10cm	2200	-40 ~ +85	Noryl	2
CMT1209E2400NP	3 ~ 8	5	40	47 $\pm$ 5	85 at 10cm	2400	-20 ~ +60	Noryl	2
CMT1209F2200NP	4 ~ 8	6	40	50 $\pm$ 5	85 at 10cm	2200	-40 ~ +85	Noryl	2
CMT1209H2048NP	6 ~ 15	12	40	140 $\pm$ 14	85 at 10cm	2048	-20 ~ +60	Noryl	2
CMT1209H2400NP	6 ~ 15	12	40	140 $\pm$ 14	85 at 10cm	2400	-25 ~ +70	Noryl	2

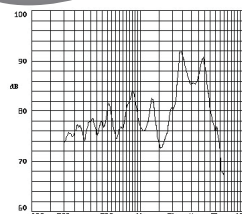

Washing Label

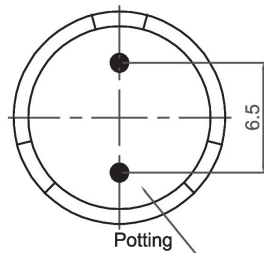
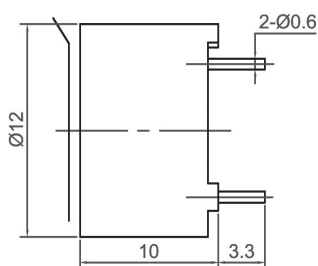
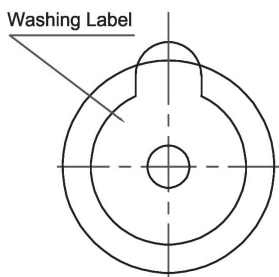

CMT1210

Canopus Part no.	Operating Voltage (V)	Rated Voltage (V)	Max Rated Current (mA)	Coil Resistance ( $\Omega$ )	Min Sound Output (dBA)	Resonant Frequency (Hz)	Operating Temperature ( $^{\circ}$ C)	Housing	Weight (g)
CMT1210A2200TP	0.8 ~ 2.5	1.5	100	3.5 $\pm$ 1	85 at 10cm	2200	-20 ~ +70	PBT	2
CMT1210A2400TP	1 ~ 2	1.5	30	16 $\pm$ 4.5	80 at 10cm	2400	-40 ~ +85	PBT	2
CMT1210A2800TP	1 ~ 3	1.5	30	16 $\pm$ 4.5	85 at 10cm	2800	-20 ~ +70	PBT	2
CMT1210E2400TP	3 ~ 8	5	50	40 $\pm$ 5	85 at 10cm	2400	-40 ~ +85	PBT	2

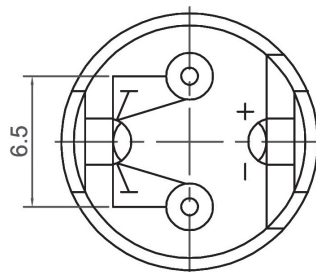
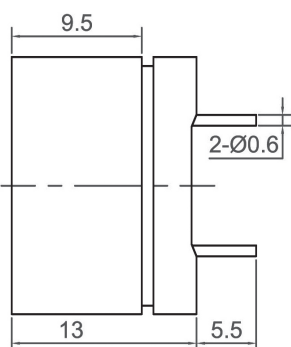
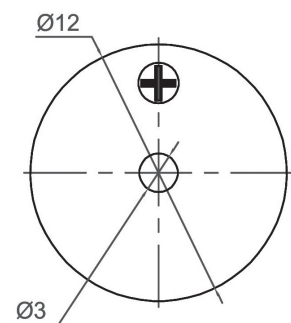
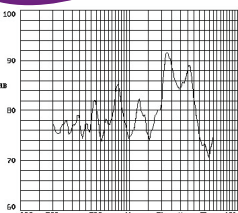

CMT1213

Canopus Part no.	Operating Voltage (V)	Rated Voltage (V)	Max Rated Current (mA)	Coil Resistance ( $\Omega$ )	Min Sound Output (dBA)	Resonant Frequency (Hz)	Operating Temperature ( $^{\circ}$ C)	Housing	Weight (g)
CMT1213A2048NP	1 ~ 2	1.5	30	16 $\pm$ 4.5	80 at 10cm	2048	-20 ~ +60	Noryl	2

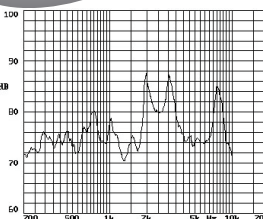

CANOPUS

**Your Efficient Supplier**  
[www.canopus.com.hk](http://www.canopus.com.hk)

TEL.: (852) 2806 2812

Fax: (852) 2652 2216