

CR6A2GPP CR6A8GPP
 CR6A4GPP CR6A10GPP
 CR6A6GPP

GLASS PASSIVATED JUNCTION
 GENERAL PURPOSE SILICON RECTIFIER
 6A, 200 THRU 1000 VOLTS

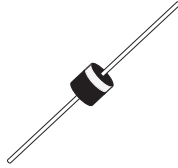

CASE 106

CentralTM

Semiconductor Corp.

DESCRIPTION:

The CENTRAL SEMICONDUCTOR CR6A4GPP Series types are 6.0 Amp Glass Passivated Junction Silicon Rectifiers which are high quality, well constructed, highly reliable components designed for use in all types of military, commercial, industrial, entertainment, computer, and automotive applications.

THIS DEVICE IS MANUFACTURED WITH A GLASS PASSIVATED CHIP FOR OPTIMUM RELIABILITY.

MARKING: FULL PART NUMBER

MAXIMUM RATINGS: ($T_A=25^\circ\text{C}$ unless otherwise noted)

		CR6A					
	SYMBOL	2GPP	4GPP	6GPP	8GPP	10GPP	UNITS
Peak Repetitive Reverse Voltage	V_{RRM}	200	400	600	800	1000	V
DC Blocking Voltage	V_R	200	400	600	800	1000	V
RMS Reverse Voltage	$V_{R(RMS)}$	140	280	420	560	700	V
Non-Repetitive Peak Reverse Voltage (Halfwave, single phase, 60Hz peak)	V_{RSM}	240	480	720	960	1200	V
Average Forward Current, $T_A=60^\circ\text{C}$	I_O			6.0			A
Non-Repetitive Peak Forward Surge Current (Halfwave, single phase, 60Hz peak)	I_{FSM}			400			A
Operating and Storage Junction Temperature	T_J, T_{stg}			-65 to +175			$^\circ\text{C}$

ELECTRICAL CHARACTERISTICS: ($T_A=25^\circ\text{C}$ unless otherwise noted))

SYMBOL	TEST CONDITIONS	MAX	UNITS
I_R	$V_R=Rated V_{RRM}$	10	μA
I_R	$V_R=Rated V_{RRM}, T_A=100^\circ\text{C}$	1.0	mA
V_F	$I_F=6.0\text{A}$	1.0	V

CASE 106 - MECHANICAL OUTLINE

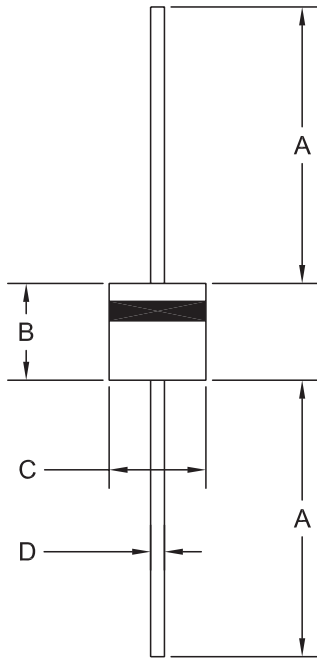

R1

DIMENSIONS				
SYMBOL	INCHES		MILLIMETERS	
	MIN	MAX	MIN	MAX
A	1.000	-	25.40	-
B	0.340	0.360	8.64	9.14
C	0.340	0.360	8.64	9.14
D	0.048	0.053	1.22	1.35

CASE 106 (REV: R1)

MARKING: FULL PART NUMBER

R1 (1-May 2008)