

# PRODUCT SPECIFICATION

**Model No : CSLO-N34SSB1-QA0R**

Descriptions:	
■ LED Type	: Superbright Lamp
■ LED Package	: Oval LED Lamp
■ Emitting Color	: Blue
■ Viewing Angle	: 110°/40°
■ Stopper	



CUSTOMER APPROVED SIGNATURES	APPROVED BY	CHECKED BY	PREPARED BY

**CHINA SEMICONDUCTOR CORPORATION**  
Address: 2FL. NO.909, Chung-Cheng Road,  
Chung-Ho City Taipei Hsien, Taiwan.

**OPTO PLUS TECHNOLOGIES CO.,LTD**  
Address: 696 Shun jiang Rd., Ji Shan St. Shaoxing,  
ZheJiang, China

Tel: 886-2-2223-9696  
Fax: 886-2-2223-9377

Tel: 86-0575-88623888  
Fax: 86-0575-88623112

**Model No : CSLO-N34SSB1-QA0R**

**Features -**

1. Low Power Consumption.
2. High Luminous Output
3. High Reliability and Solid Performance
4. Optimal Optical/Mechanical Design
5. Rohs Compliant

**Device Selection Guide -**

Part No.	Chip		LED Lens
	Material	Emitted Color	
CSLO-N34SSB1-QA0R	InGaN	Blue	Blue Diffused

**Package Outline Dimensions -**

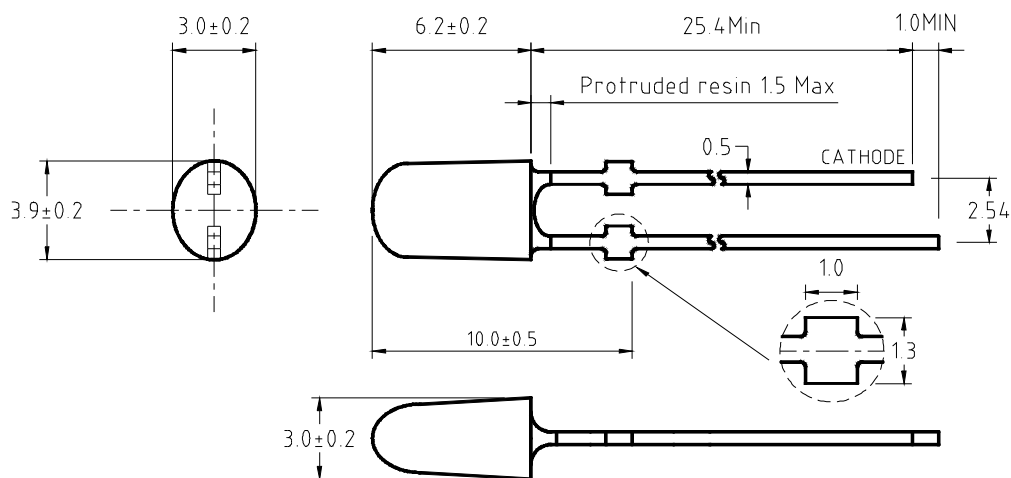

\* Tolerance :  $\pm \frac{0.01}{0.25}$  Unit :  $\pm \frac{\text{inch}}{\text{mm}}$

**Model No : CSLO-N34SSB1-QA0R**

■ **Absolute Maximum Rating -**

(Ta=25°C)

Parameter	Symbol	Rating	Unit
Power Dissipation	Pd	114	mW
Forward Current (DC)	IF	30	mA
Peak Forward Current *	IFP	100	mA
Reverse Voltage	VR	5	V
Operating Temp.	Topr	-30 ~ +85	°C
Storage Temp.	Tstg	-40 ~ +100	°C
Lead Soldering Temperature	Tsol	Max. 260°C for 5 sec Max. (3mm from the epoxy bulb)	

\* Pulse width  $\leq 0.1$  msec. duty  $\leq 1/10$

■ **Electro-optical Characteristics -**

(Ta=25°C)

Parameter	Symbol	Min.	Typ.	Max.	Unit	Condition
Forward Voltage	VF	-----	3.2	3.8	V	IF=20mA
Luminous Intensity	Iv	400	600	1150	mcd	
Dominant Wavelength	$\lambda d$	460	470	480	nm	
Peak Wavelength	$\lambda p$	-----	465	-----	nm	
Spectral Half Width	$\Delta\lambda 1/2$	-----	20	-----	nm	
Viewing Angle	$2\theta 1/2$	-----	110(X)	-----	deg	
		-----	40(Y)	-----		
Reverse Current	IR	-----	-----	50	$\mu A$	VR=5V



**Model No : CSLO-N34SSB1-QA0R**

■ **Luminous Intensity Rank Limits (  $I_F = 20\text{mA}$  )**

unit : mcd

Part No Code	CSLO-N34SSB1-QA0R	
	min.	max.
L	400	520
M	520	680
N	680	880
P	880	1150

■ **Color Rank Limits (  $I_F = 20\text{mA}$  )**

unit : nm

Part No Code	CSLO-N34SSB1-QA0R	
	min.	min.
1	460	465
2	465	470
3	470	475
4	475	480

Notes:

1. Tolerance of measurement of luminous intensity :±15%
2. Tolerance of measurement of Color Coordinates :±0.01
3. Tolerance of measurement of forward voltage :±0.05v
4. All data are measured by CSC's test equipment.
5. One delivery will include several color rank, VF rank and Iv ranks of the products.
6. The quantity-ratio of the ranks is decided by CSC.
7. Please confirm with CSC salesman,if your request different form standard specification.

Spec. No.	PS-LL-N34SSB1-QA0R
Rev.	A

**Model No : CSLO-N34SSB1-QA0R**

**Typical Electrical / Optical Characteristics Curves -  
(Ta = 25°C Unless Otherwise Noted)**

Forward Current vs. Forward Voltage

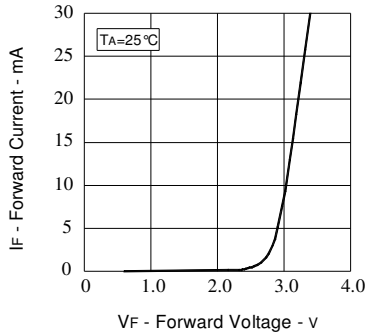

Relative Intensity vs. Forward Current

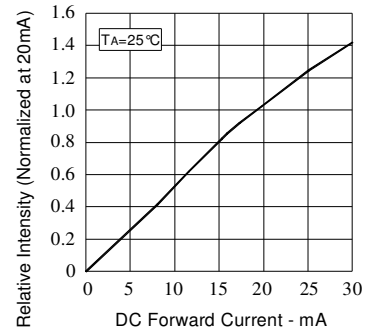

Forward Current vs. Ambient Temperature

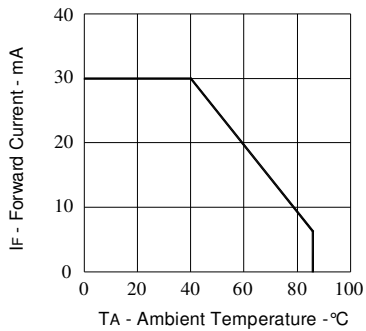

Relative Intensity vs. Wavelength

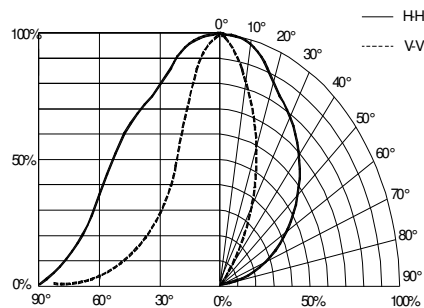
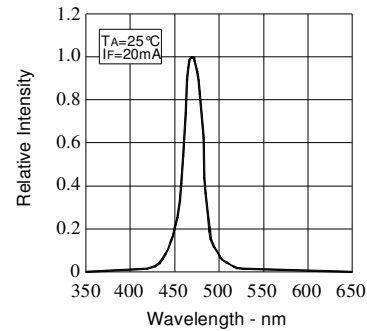

Relative Luminous Intensity vs. Radiation Angle

Spec. No.	PS-LL-N34SSB1-QA0R
Rev.	A

Model No : CSLO-N34SSB1-QA0R

## Taping Dimensions

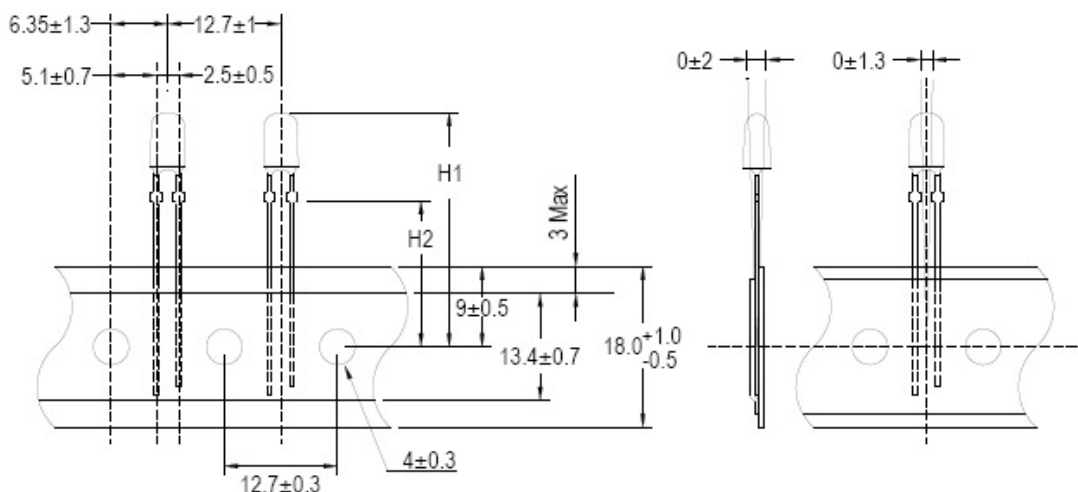

**H1=26.0mm**

**H2=16.0mm**

1. The cumulative tolerance for pitch of the sprocket holes is  $\pm 1$ mm per 20 pitches
2. The cathode side must be drawn out first
3. The minimum order quantity for taped LEDs is 10K pieces

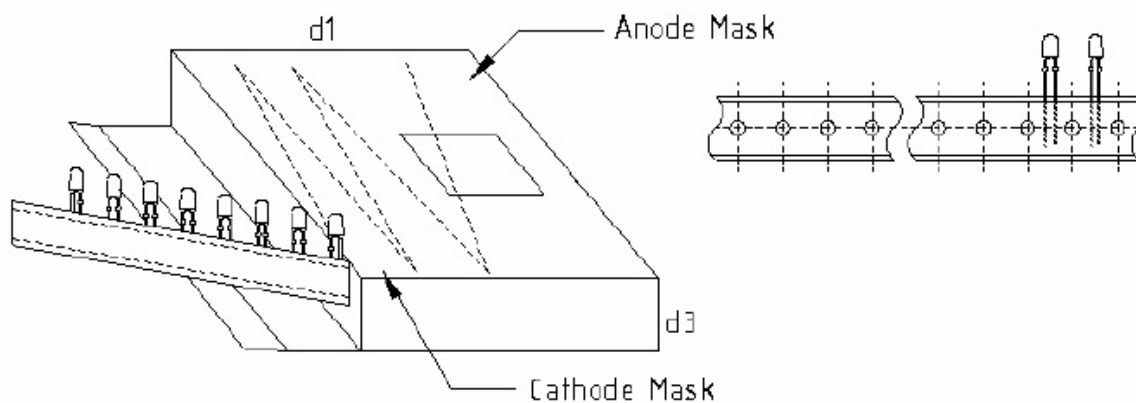

**d1=285mm**

**d3= 50mm**

1. The tape is folded every 25 elements
2. At each end of the tape there is an empty length of equal to more than 10 elements spacing of tape
3. The cathode side must be drawn out first

**Model No : CSLO-N34SSB1-QA0R**

**■ Precautions For Use -**

**1. Recommended Soldering conditions**

**Wave Soldering**

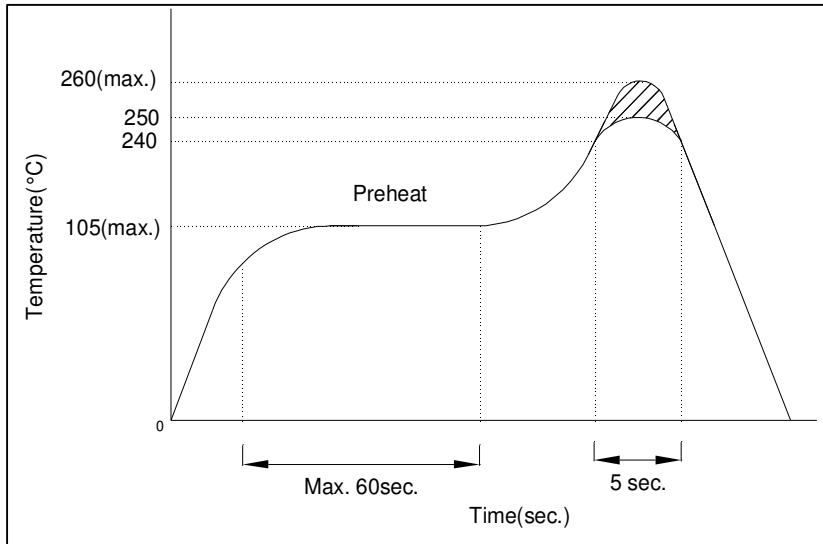

**2. Soldering Iron**

Basic SPEC. is  $\leq 5\text{sec.}$  When  $260^{\circ}\text{C}$ . If temperature is higher, time should be shorter ( $+10^{\circ}\text{C} \rightarrow -1\text{sec.}$ ). Power dissipation of iron should be smaller than 15W, and temperature should be controllable. Surface temperature of the device should be under  $230^{\circ}\text{C}$ .

**3. Static Electricity**

- a. Static electricity or surge voltage damages LEDs..  
It is recommended that a wrist band or an anti-electrostatic glove be used when handling the LEDs.
- b. All devices, equipment and machinery must be properly grounded. It is recommended that measures be taken against surge voltage to the equipment that mounts the LEDs.

Note: The specifications are subject to change without notice. Please contact us for updated information.