

A. Electrical Specifications:

P/N	Marking	Tol.	Inductance (μH)	Test Freq. (KHz)	DCR Max. (Ω)	Rated Current (A)
CSN075D-6R8K	6R8	K	6.8	100	0.058	3.00
CSN075D-8R2K	8R2	K	8.2	100	0.06	2.40
CSN075D-100K	100	K	10	100	0.07	2.30
CSN075D-120K	120	K	12	100	0.08	2.00
CSN075D-150K	150	K	15	100	0.09	1.80
CSN075D-180K	180	K	18	100	0.10	1.60
CSN075D-220K	220	K	22	100	0.11	1.50
CSN075D-270K	270	K	27	100	0.12	1.30
CSN075D-330K	330	K	33	100	0.13	1.20
CSN075D-390K	390	K	39	100	0.16	1.10
CSN075D-470K	470	K	47	100	0.18	1.10
CSN075D-560K	560	K	56	100	0.24	0.94
CSN075D-680K	680	K	68	100	0.28	0.85
CSN075D-820K	820	K	82	100	0.37	0.78
CSN075D-101K	101	K	100	10	0.43	0.72
CSN075D-121K	121	K	120	10	0.47	0.66
CSN075D-151K	151	K	150	10	0.64	0.58
CSN075D-181K	181	K	180	10	0.71	0.51
CSN075D-221K	221	K	220	10	0.96	0.49
CSN075D-271K	271	K	270	10	1.11	0.42
CSN075D-331K	331	K	330	10	1.26	0.40
CSN075D-391K	391	K	390	10	1.77	0.36
CSN075D-471K	471	K	470	10	1.96	0.34

B. Dimensions: mm (Inch)

Series	a	b	c	d	e	f	g
CSN075D	7.0 (0.276)	7.8 (0.307)	5.0 (0.197)	1.6 (0.063)	7.5 (0.295)	2.0 (0.079)	3.0 (0.118)
Tol.	±0.3 (0.012)	±0.3 (0.012)	±0.5 (0.020)	Typ.	Typ.	Typ.	Typ.

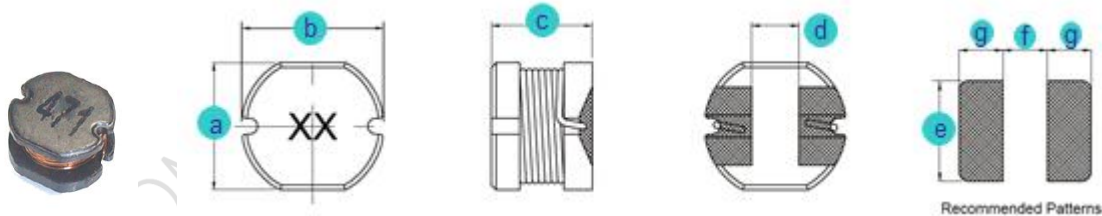

C. General Information:

1. CSN075D-xxx, “CSN075D” = P/N, “xxx” = Inductance, “_” = Tolerance.
2. Tolerance “_”: K = ±10%.
3. Operating temperature range: -30°C to +100°C (Including self-heating).
4. Storage temperature: -40°C to +85°C.
5. Inductance measured using the HP4284A and Chroma1320 & 3302.
6. DCR measured using Chroma 16502 milliohm meter.
7. Inductance drop no more than 10% of initial value at rated current, temperature rise Δt < 40°C.
8. Inductance and Current range: From 6.80 μH (3.00A) to 470 μH (0.34A).
9. MSL: Level 1.

D. Applications:

1. Game Consoles
2. Set Top Boxes
3. Cables Modems
4. Computers
5. Mobile Communication Devices (Cell Phones, Radios, etc.)
6. PDA, LCD, DVD, BRP, HD

E. Characteristics Curve:

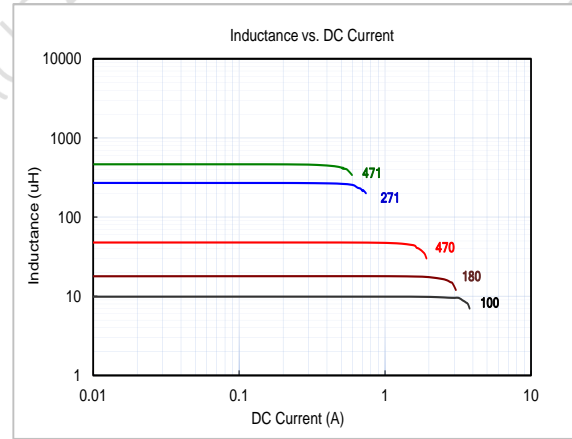
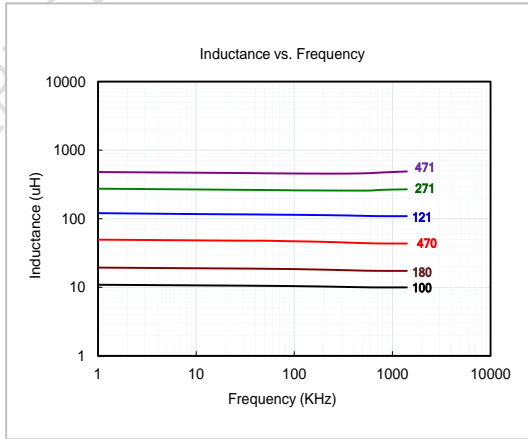

F. Supplementary Information:

1. Packaging Information

CARRIER TAPE REELS

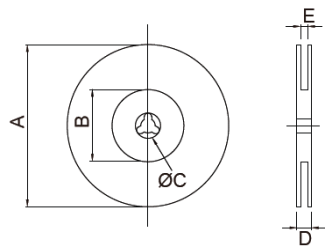

TAPE DIMENSIONS (mm)

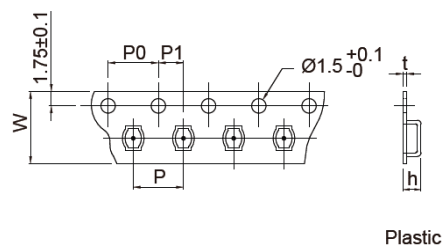

Plastic

Series P/N	Reel dimensions (mm)					Tape dimensions (mm)						Parts per reel		Quantity per	
	A	B	C	D	E	W	P	P0	P1	h	t	7"	13"	Box	Carton
CSN075D	340	80	13	22.4	16.5	16	12	4	2	5.50	0.40	---	1,000	2,000	6,000

2. RoHS Reflow Solder Profile

Typical RoHS Reflow Profile

