

CTDO1608 Series

From 1.0 μH to 1,000 μH

ENGINEERING KIT #9

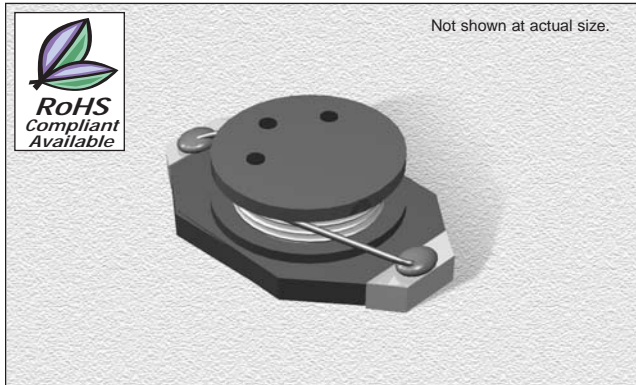

CHARACTERISTICS

Description: SMD power inductor

Applications: VTR power supplies, OA equipment, LCD televisions, PC notebooks, portable communication equipment, DC/DC converters. Step up & step down converters and flash memory programmers

Operating Temperature: -40°C to +85°C

Inductance Tolerance: $\pm 20\%$

Inductance Drop: 10% typically at Isatt

Testing: Inductance is tested on an HP4285A at 100 kHz

Packaging: Tape & Reel

Marking: Color dots OR Inductance code

Miscellaneous: RoHS Compliant available.

Additional Information: Additional electrical & physical information available upon request

Samples available. See website for ordering information.

PAD LAYOUT

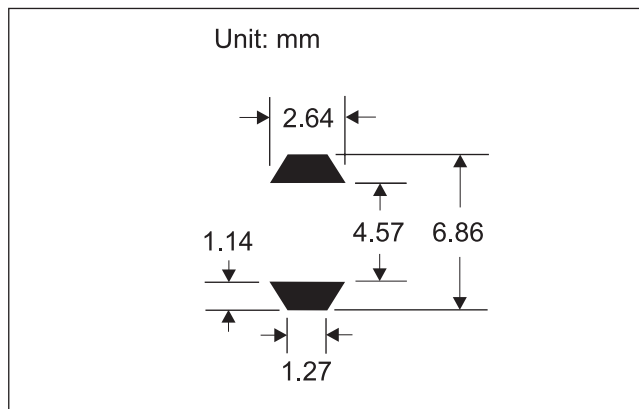

SPECIFICATIONS

Parts are available in $\pm 20\%$ tolerance only.
CTDO1608CE Please specify "F" for RoHS compliant

Part Number	Inductance (μH)	L Test Freq. (kHz)	DCR (Ω)	SRF Typ. (MHz)	Isat (A)	Irms (A)
CTDO1608C_-102	1.0	100	.05	130	2.9	2.9
CTDO1608C_-152	1.5	100	.05	115	2.6	2.8
CTDO1608C_-222	2.2	100	.07	90	2.3	2.4
CTDO1608C_-332	3.3	100	.08	70	2.0	2.0
CTDO1608C_-472	4.7	100	.09	50	1.5	1.5
CTDO1608C_-682	6.8	100	.13	45	1.2	1.4
CTDO1608C_-103	10	100	.16	35	1.1	1.1
CTDO1608C_-153	15	100	.23	30	.90	1.2
CTDO1608C_-223	22	100	.37	20	.70	.80
CTDO1608C_-333	33	100	.51	15	.58	.60
CTDO1608C_-473	47	100	.64	14	.50	.50
CTDO1608C_-683	68	100	.86	11	.40	.40
CTDO1608C_-104	100	100	1.3	9.0	.31	.30
CTDO1608C_-154	150	100	2.0	6.0	.27	.25
CTDO1608C_-224	220	100	3.1	5.5	.22	.20
CTDO1608C_-334	330	100	3.8	5.0	.18	.16
CTDO1608C_-474	470	100	5.1	4.0	.16	.15
CTDO1608C_-684	680	100	9.2	3.0	.14	.12
CTDO1608C_-105	1000	100	14	2.0	.10	.07

PHYSICAL DIMENSIONS

Size	A Max.	B Max.	C Max.	D	E	F	G
mm	6.58	4.45	2.92	0.78	1.27	4.80	2.34
inches	0.26	0.18	0.12	0.03	0.05	0.19	0.09

Parts will be marked with Significant Digit Dots OR Inductance Code

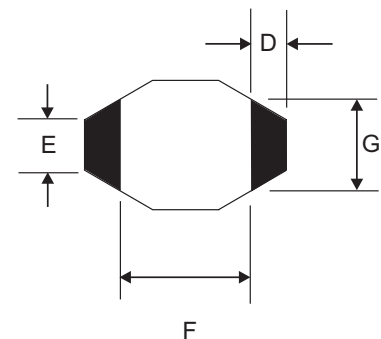
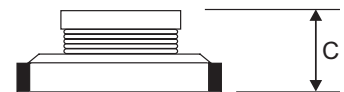
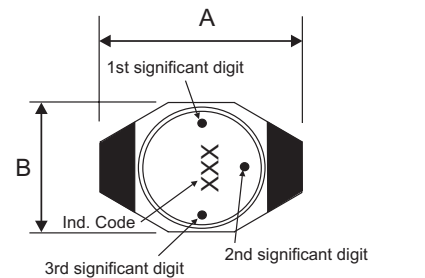

01.14.05