

## CTDO3316HC Series

From 0.33  $\mu\text{H}$  to 100  $\mu\text{H}$

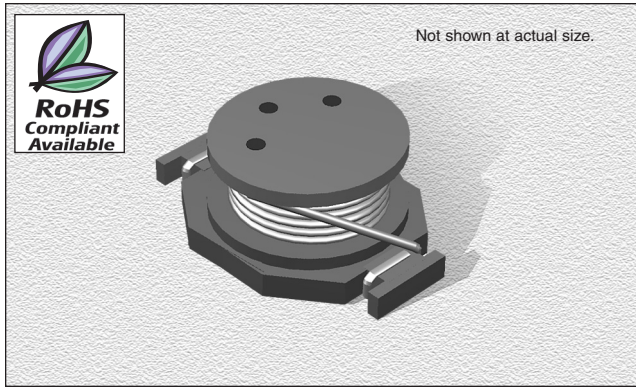

### CHARACTERISTICS

- Description:** SMD (high current) power inductor
- Applications:** DC/DC converters, computers, LCD displays, telecommunication equipment and PDA palm tops.
- Operating Temperature:** -40°C to +85°C
- $\Delta T$ :** 40°C typically at  $I_{rms}$
- Inductance Tolerance:**  $\pm 20\%$
- Inductance Drop:** 10% typically at  $I_{sat}$
- Testing:** Inductance is tested on an HP4285A at 100 kHz
- Packaging:** Tape & Reel
- Marking:** Color dots OR Inductance code
- Miscellaneous:** RoHS Compliant available
- Additional Information:** Additional electrical & physical information available upon request
- Samples available. See website for ordering information.**

### PAD LAYOUT

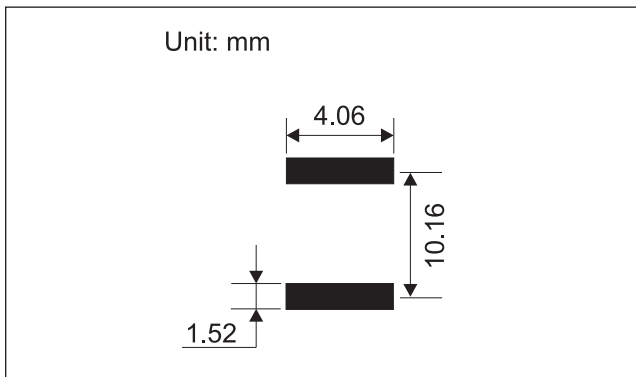

### SPECIFICATIONS

Parts are available in  $\pm 20\%$  tolerance only.  
CTDO3316PE Please specify "F" for RoHS Compliant

Part Number	Inductance ( $\mu\text{H}$ )	L Test Freq. (kHz)	DCR Max. ( $\Omega$ )	SRF Typ. (MHz)	$I_{sat}$ Typ. (A)	$I_{rms}$ (A)
CTDO3316P_-331HC	.33	100	.002	300	20	16
CTDO3316P_-681HC	.68	100	.005	200	13	12
CTDO3316P_-102HC	1.0	100	.006	100	11	10
CTDO3316P_-152HC	1.5	100	.008	90	9.0	9.0
CTDO3316P_-222HC	2.2	100	.011	90	7.8	7.4
CTDO3316P_-272HC	2.7	100	.012	65	7.0	6.6
CTDO3316P_-332HC	3.3	100	.014	65	6.4	5.9
CTDO3316P_-472HC	4.7	100	.018	45	5.4	4.8
CTDO3316P_-682HC	6.8	100	.035	35	3.6	5.0
CTDO3316P_-103HC	10	100	.04	26	3.3	4.3
CTDO3316P_-153HC	15	100	.06	21	2.4	3.5
CTDO3316P_-223HC	22	100	.08	17	2.0	2.8
CTDO3316P_-333HC	33	100	.15	14	1.7	2.1
CTDO3316P_-473HC	47	100	.28	12	1.4	1.7
CTDO3316P_-683HC	68	100	.30	9	1.2	1.5
CTDO3316P_-104HC	100	100	.40	7	.95	1.2

### PHYSICAL DIMENSIONS

Size	A Max.	B Max.	C Max.	D Max.
mm	9.91	8.38	6.35	13.21
inches	0.39	0.33	0.25	0.52

Parts will be marked with Significant Digit Dots OR Inductance Code

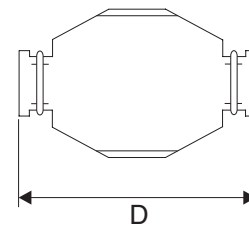
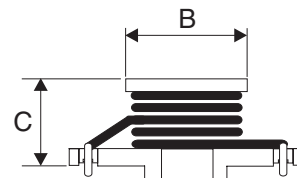
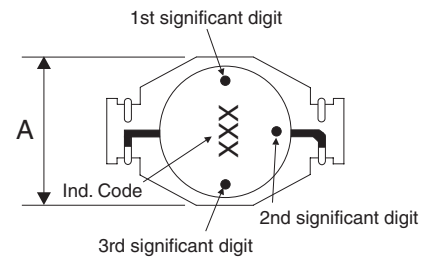

01.14.05