

CTLS5064-M532  
CTLS5064R-M532

**SURFACE MOUNT  
SILICON CONTROLLED RECTIFIER**

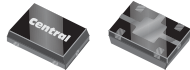

Top View Bottom View

**TLM532 CASE**

• Device is **Halogen Free** by design



[www.centrasemi.com](http://www.centrasemi.com)

**DESCRIPTION:**

The CENTRAL SEMICONDUCTOR CTLS5064-M532 and CTLS5064R-M532 (reverse pinout) are epoxy molded PNP Silicon Controlled Rectifiers manufactured in a TLM532 case, designed for control systems and sensing circuit applications.

**MARKING CODES: CTLS5064-M532: CS64  
CTLS5064R-M532: CFF**

**FEATURES:**

- High Voltage ( $V_{DRM}=400V$  MAX)

**MAXIMUM RATINGS:** ( $T_A=25^\circ C$ )

Peak Repetitive Off-State Voltage  
Peak Repetitive Reverse Voltage  
RMS On-State Current  
Average On-State Current  
Power Dissipation  
Operating and Storage Junction Temperature  
Thermal Resistance

**SYMBOL**

$V_{DRM}$  400  
 $V_{RRM}$  400  
 $I_T(RMS)$  0.8  
 $I_T(AV)$  0.51  
 $P_D$  1.0  
 $T_J, T_{stg}$  -65 to +150  
 $\theta_{JA}$  77

**UNITS**

V  
V  
A  
A  
W  
 $^\circ C$   
 $^\circ C/W$

**ELECTRICAL CHARACTERISTICS:** ( $T_A=25^\circ C$  unless otherwise noted)

SYMBOL	TEST CONDITIONS	MIN	TYP	MAX	UNITS
$I_{DRM}$	$V_D=Rated V_{DRM}, R_{GK}=1.0K\Omega$			1.0	$\mu A$
$I_{RRM}$	$V_D=Rated V_{DRM}, R_{GK}=1.0K\Omega$			1.0	$\mu A$
$I_{DRM}$	$V_D=Rated V_{DRM}, R_{GK}=1.0K\Omega, T_A=125^\circ C$	—		50	$\mu A$
$I_{RRM}$	$V_D=Rated V_{DRM}, R_{GK}=1.0K\Omega, T_A=125^\circ C$			50	$\mu A$
$V_T$	$I_T=1.2A$			1.7	V
$I_{GT}$	$V_D=7.0V, R_L=100\Omega, R_{GK}=1.0K\Omega$			200	$\mu A$
$V_{GT}$	$V_D=7.0V, R_L=100\Omega, R_{GK}=1.0K\Omega$			0.8	V
$V_{GD}$	$V_D= Rated V_{DRM}, R_L=100\Omega, T_A=125^\circ C$	0.1			V
$I_H$	$V_D=7.0, R_{GK}=1.0K\Omega$			5.0	mA
$t_{ON}$	$V_D= Rated V_{DRM}, I_{GT}=1.0mA, R_{GK}=1.0\Omega, di/dt=6.0A/\mu s$		2.8		$\mu s$

**CTLS5064-M532**  
**CTLS5064R-M532**

**SURFACE MOUNT**  
**SILICON CONTROLLED RECTIFIER**



**TLM532 CASE - MECHANICAL OUTLINE**

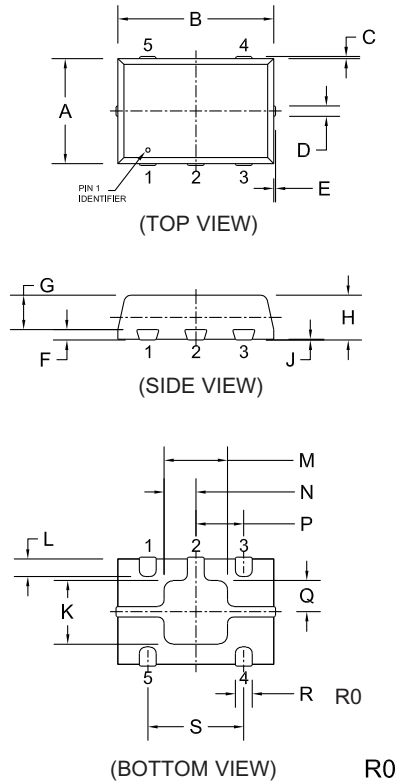

SYMBOL	DIMENSIONS			
	INCHES		MILLIMETERS	
	MIN	MAX	MIN	MAX
A	0.007	0.012	0.170	0.300
B	-	0.005	-	0.125
C	0.114	0.122	2.900	3.100
D	0.075	0.083	1.900	2.100
E	0.006	0.010	0.150	0.250
F	0.026	0.030	0.650	0.750
G	0.031	0.039	0.800	1.000
H	0.000	0.002	0.000	0.050
J	0.009	0.013	0.240	0.340
K	0.006	0.014	0.160	0.360
L	0.008	0.018	0.200	0.450
M	0.013		0.325	
N	0.026		0.650	
P	0.040	0.048	1.010	1.210
Q	0.004		0.100	
R	0.032	0.040	0.820	1.020
S	0.017	0.025	0.430	0.630

TLM832D (REV: R2)

**SUGGESTED MOUNTING PADS**  
(Dimensions in mm)

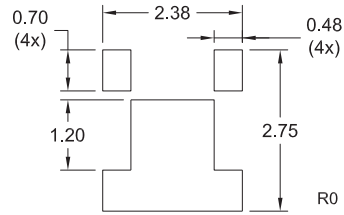

**PIN CONFIGURATIONS**

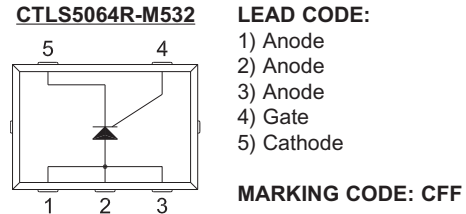
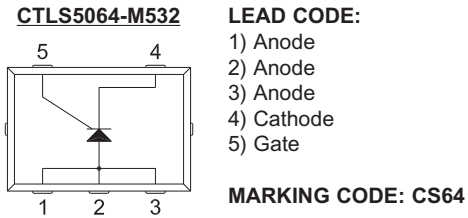

R2 (19-February 2010)