

## SOT-323 Plastic-Encapsulated Diode

### DAN202U SWITCHING DIODE

#### FEATURES:

Power dissipation

$$P_D: 200 \text{ mW (} T_{amb}=25^\circ\text{C)}$$

Collector current

$$I_F: 100 \text{ mA}$$

Collector-base voltage

$$V_R: 80 \text{ V}$$

Operating and storage junction temperature range

$$T_J, T_{stg}: -55^\circ\text{C to } +150^\circ\text{C}$$

#### SOT-323

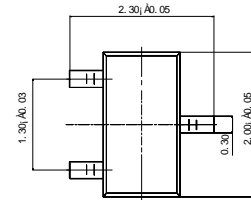
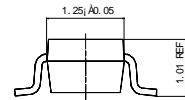
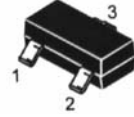

Unit: mm

#### CIRCUIT:

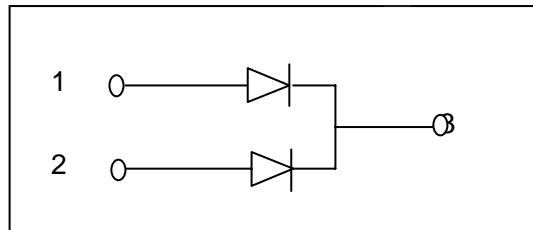

MARKING: N

#### ELECTRICAL CHARACTERISTICS ( $T_{amb}=25^\circ\text{C}$ unless otherwise specified)

Parameter	Symbol	Test conditions	MIN	MAX	UNIT
Reverse breakdown voltage	$V_{(BR)}$	$I_R = 100\mu\text{A}$	80		V
Reverse voltage leakage current	$I_R$	$V_R = 70\text{V}$		0.1	$\mu\text{A}$
Forward voltage	$V_F$	$I_F = 100\text{mA}$		1.2	V
Diode capacitance	$C_D$	$V_R = 6\text{V}, f = 1\text{MHz}$		3.5	pF
Reverse recovery time	$t_{rr}$	$V_R = 6\text{V}, I_F = 5\text{mA}$		4	ns