

DMH SERIES

NEW

Load Life: 85°C 1000 hours

◆FEATURES

- High Temperature.
- RoHS compliance.

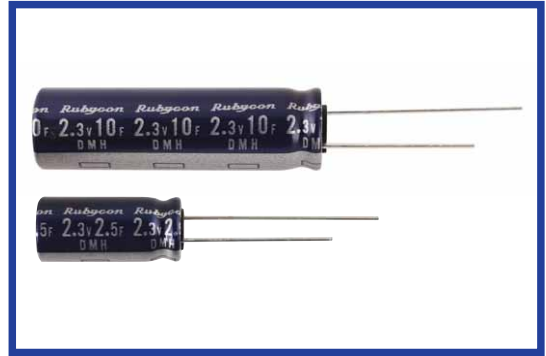

◆SPECIFICATIONS

Items	Characteristics				
Category Temperature Range	-25~+85°C				
Rated Voltage Range	2.3Vdc				
Capacitance Tolerance	±20% (20°C)				
Characteristics at High and low Temperatures	<table border="1"> <tr> <td>Capacitance Change</td> <td> ΔC/C(+20°C) ≤30%</td> </tr> <tr> <td>ESR</td> <td>Max, 4 times of value at +20°C (at -25°C)</td> </tr> </table>	Capacitance Change	ΔC/C(+20°C) ≤30%	ESR	Max, 4 times of value at +20°C (at -25°C)
Capacitance Change	ΔC/C(+20°C) ≤30%				
ESR	Max, 4 times of value at +20°C (at -25°C)				
Endurance	<p>After 1000 hours with rated voltage at 85°C, the capacitors shall meet the following requirements.</p> <table border="1"> <tr> <td>Capacitance Change</td> <td> ΔC/C(initial) ≤30%</td> </tr> <tr> <td>ESR</td> <td>Max, 3 times of the specification</td> </tr> </table>	Capacitance Change	ΔC/C(initial) ≤30%	ESR	Max, 3 times of the specification
Capacitance Change	ΔC/C(initial) ≤30%				
ESR	Max, 3 times of the specification				
Storage at High Temperature	After 1000 hours without load at 85°C, the capacitors shall meet the same requirements specified for endurance.				

◆PART NUMBER

DMH D×L
 Rated Voltage Series Capacitance Capacitance Tolerance Option Lead Forming Case Size

Lead Forming : Please refer to aluminum electrolytic capacitors section.

◆DIMENSIONS

(mm)

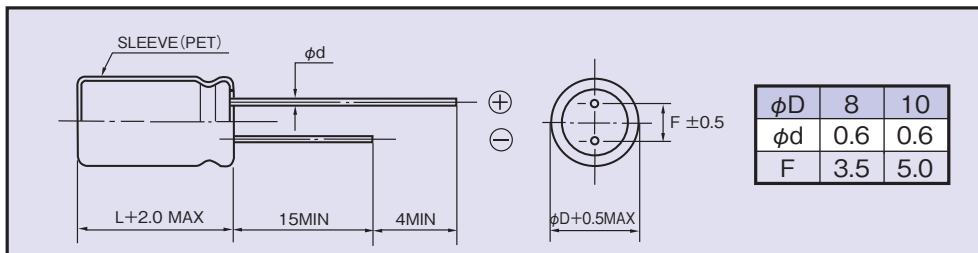

◆STANDARD SIZE

:Tolerance(M:±20) **:Lead Forming

Rated Voltage (Vdc)	Capacitance (F)	ESR (Ω/20°C, 1kHz)	φD×L (mm)	Part No.
2.3	2	1	8×16	2.3DMH2 <input type="checkbox"/> **8X16
	2.5	0.8	8×18	2.3DMH2R5 <input type="checkbox"/> **8X18
	3.3	0.7	10×16	2.3DMH3R3 <input type="checkbox"/> **10X16
	4.7	0.5	10×20	2.3DMH4R7 <input type="checkbox"/> **10X20
	6.8	0.3	10×30	2.3DMH6R8 <input type="checkbox"/> **10X30
	10	0.2	10×35	2.3DMH10 <input type="checkbox"/> **10X35