

Since 1968

COMMAX
SmartHome & Security

User Manual

TELE VIDEO DOOR PHONE DPV-4NT2



www.commax.com

COMMAX Co.,Ltd.



- Thank you for purchasing COMMAX products.
- Please carefully read this User's Guide (in particular, precautions for safety) before using a product and follow instructions to use a product exactly.
- The company is not responsible for any safety accidents caused by abnormal operation of the product.

INTRODUCTION

Congratulations on the purchase of your new video doorphone system!
Please read these instructions carefully before installing your system and follow all of the directions to ensure proper installation.

This instruction manual explains in simple steps how to install, use, and care for your new video doorphone system in homes, offices or businesses.

Serial Number(From Rear Panel)

Date of Purchase

Place of Purchase

TABLE OF CONTENTS	Page
PARTS CHECKLIST	2
FEATURES	3-4
INSTALLATION	5-6
WIRING DIAGRAM	7
OPERATION	8
TROUBLE SHOOTING GUIDE	9
SPECIFICATIONS	9



Warnings and caution

◎ Make sure to follow the instructions to prevent any danger or property losses.



Warning Death or serious injury is expected.

- It indicates prohibition.
- It indicates prohibition of disassembly.
- It indicates prohibition of contact.
- It indicates dos and don'ts.
- It indicates that the plug should be pulled out from the socket.



Warning

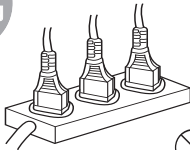

Do not put the plug in the socket simultaneously.

It may generate abnormal heat or cause a fire.



Do not connect to other products while in use.

It may cause breakdown.



Do not forcibly bend the cord or put a heavy object on the product.

It may cause a fire.

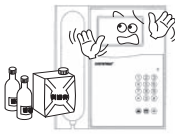

Do not use water, thinner or a detergent used to wash oil products when you wash the exterior.

Make sure to wash it by using a dry cloth to prevent any breakdown or electric shock.



Do not install the product in a humid place.

It may cause an electric shock or a fire.



Do not forcibly pull out the cord from the socket.

If the cord is damaged, it may cause a fire or an electric shock.

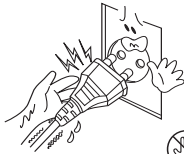

Do not put the plug in the socket with a wet hand.

It may cause an electric shock.

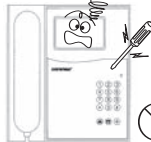

Do not disassemble, repair or modify the product.

It may cause a fire, an electric shock or an injury due to malfunction of the product.

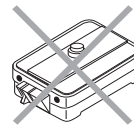

Do not use AC circuit breaker.

It may cause an electric shock.



Warnings and caution



Caution An injury or property losses are expected

- It indicates prohibition.
- It indicates prohibition of disassembly.
- It indicates prohibition of contact.
- It indicates dos and don'ts.
- It indicates that the plug should be pulled out from the socket.



Caution

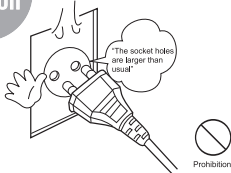

If the socket holes are larger than normal, do not put the plug.
It may cause an electric shock or a fire.

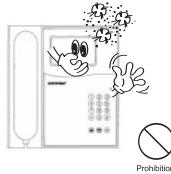

Make sure that dust or foreign substances are not gathered on the product.

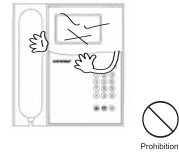

Make sure to prevent foreign substances from entering the product.
It may cause a breakdown.

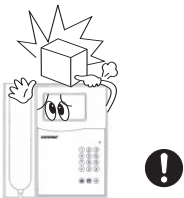

Do not put a heavy object on the product.
It may cause a breakdown.

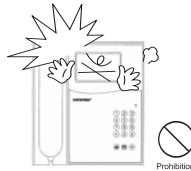

Do not disassemble or give an impact to the product.



Avoid direct rays of the sun or heating devices at a time of installation.

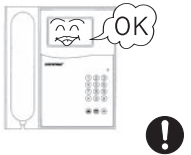

Install the product in a flat and stable place.
Otherwise, it may not function properly.

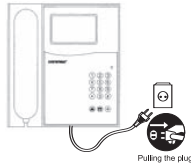

Pull the plug if the product is not used for a long time.

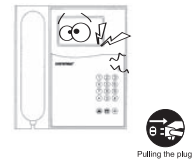

If the product generates strange sound, make sure to pull the plug immediately and contact Commax service center.

PARTS CHECKLIST

■ Monitor	1
■ Handset	1
■ Mounting Bracket.....	1
■ Mounting Screws for Bracket.....	2
■ Monitor Mounting Screw (to Bracket)	1
■ Connector 2p x 200mm(for Tel. Line)	1
■ Connetor 4p	2

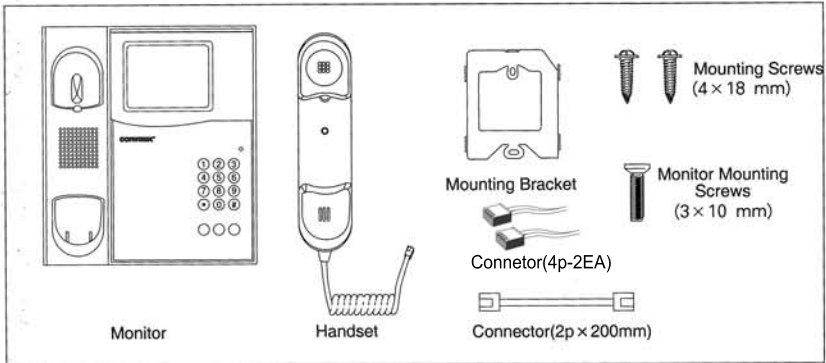

Figure 1

Camera

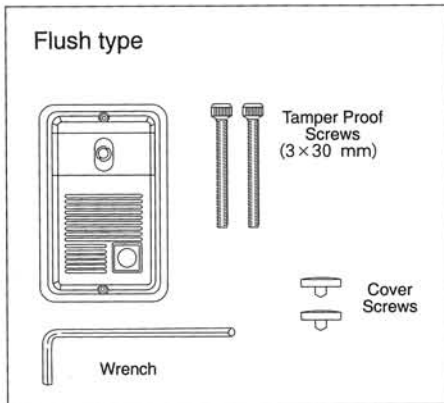
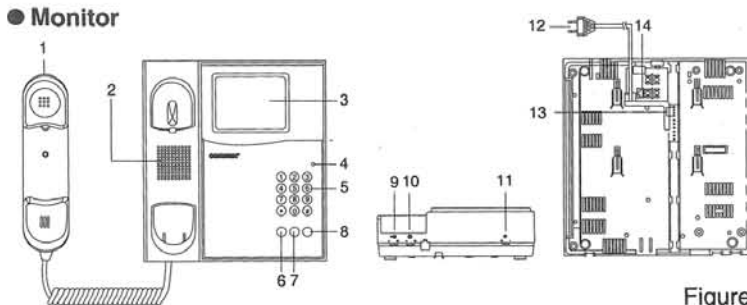

Figure 2

FEATURES



1. Handset

Lift to communicate with caller.

2. Speaker

Chime tone sounds when callers push the call button on the camera.

3. Monitor screen

4" flat type B/W C.R.T.

4. Power Lamp

Illuminates when the system is on.

5. Dial Pad

6. Monitor Button

Press this button to activate camera and view the picture on the monitor screen.

When you have two cameras connected, you can check visitor's image through first camera by pushing "Monitoring Button" and second camera by pushing the button again.

7. Telephone Button

Press this button to activate telephone

8. Door Release Button

Releases the door to let your visitors come in after viewing them (with optional door release).

9. Volume

Adjusts the call chime and telephone volume.

10. Brightness Control

Adjusts the picture brightness.

11. Power Switch

Activates and deactivates the Video doorphone.

12. AC Power Cord

Plug the monitor into the AC outlet.

13. Camera Connector

14. Telephone Jack

FEATURES

● Camera

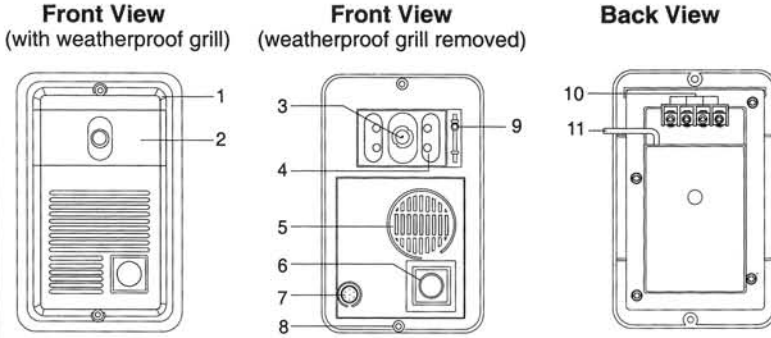

Figure 4

- 1. Panel**
Weatherproof speaker grill with aluminium die cast cover.
- 2. Camera Window**
Protects the lens and the infrared LED's.
- 3. Camera Lens**
C.C.D.(Solid State Charge Coupled Device).
- 4. Infrared LED's**
Allows for the viewing of the callers, regardless of lighting conditions.
- 5. Speaker**
Provides high quality audio to the caller.
- 6. Call Button**
Activates the monitor and chime, alerting you and showing the picture of the caller automatically.
- 7. Microphone**
Highly sensitive condenser microphone.
- 8. Tamper Proof Screws**
Prevents the camera from being removed, without a special tool.
- 9. Angle Control**
Permits the adjustment of the camera lens angle.
- 10. Terminal Block**
Connects to the monitor.
- 11. Door Release Cable**
For use with optional door release.
(Not Supplied)

INSTALLATION

● MONITOR

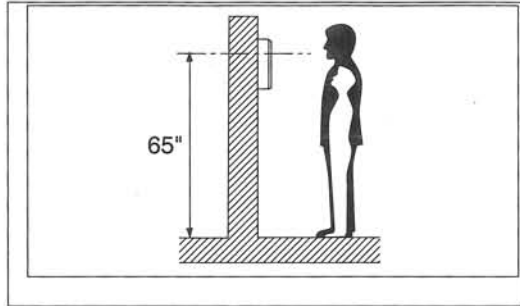

Figure 5

● CAMERA

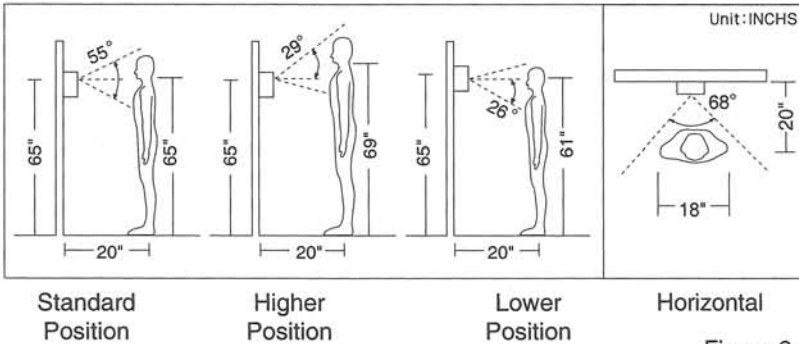

Figure 6

Important Mounting Notes:

- Do not install the monitor where it will be exposed to dirt, direct moisture, high temperature (over 104° F) or high humidity conditions. Do not select an installation location that may be subjected to vibration or pounding.
- Select a mounting location close to an AC outlet where it is easy to view and operate the monitor.
- Do not install the camera where it will be exposed to the direct rays.
- Installation of additional lamp(light) recommended to clear view of caller at night.

INSTALLATION

MONITOR

1. Connect the handset and cord to the Monitor Jack.
2. Determine the position of the Camera Lens. The standard position is at eye level.
3. Place the Mounting Bracket at the desired location, and attach it to the wall with two mounting screws(provided).
4. Connect the video cable to the back of Monitor at Terminal.(Cable not Supplied)
5. Connect telephone line to the telephone jack in the back of monitor.
6. Insert the tabs of the bracket into the holes on the Monitor and pull downward.

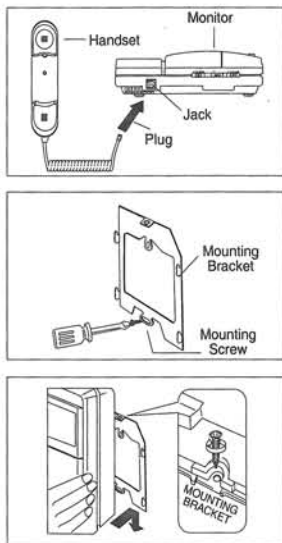

Figure 7

CAMERA

1. Install the recessed camera box into the wall, secure properly.
2. Remove the front panel from main unit.
3. Place the main unit and the front panel into the box using the two tamperproof screws. Tighten with wrench supplied.

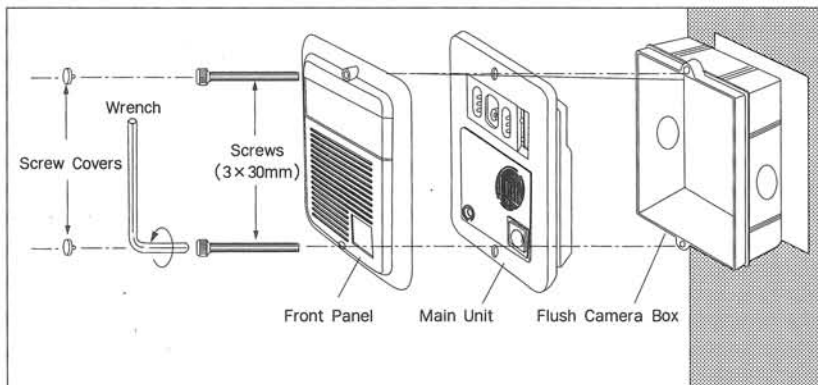
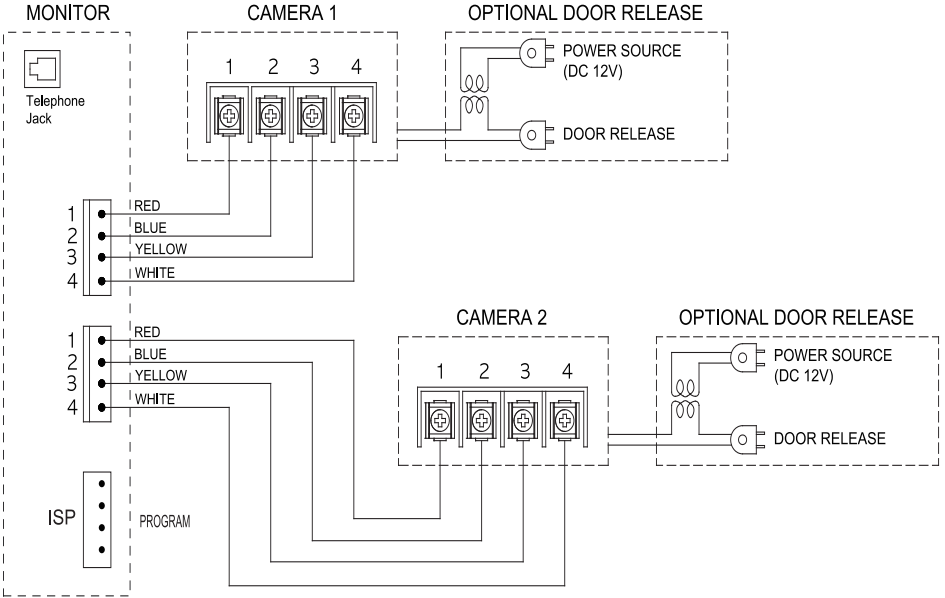

Figure 8

WIRING DIAGRAM



OPERATION

Turn power switch ON. Use the center position for volume and brightness controls.

Caller Calling:

1. A caller presses the Call button on the Camera.
A call tone is heard which alerts occupant.
2. The caller then talks handsfree after you answer the call.

Monitor Station:

1. A chime sounds and the caller appears on the Monitor Screen automatically.
2. Pick up the handset to talk to the caller.
3. Hanging up the Handset returns the Monitor to stand by mode.

Operating the Electric Door Release:

If desired, depress and hold the Door Release Button which will activate the electric door strike(optional accessory required).

(See Wiring Diagram)

Monitoring:

Press Monitor Button. You will see the Camera's field of view for 30 seconds.

Telephone:

1. Please lift up handset and press telephone button.
you can hear a dial tone for dialing.
2. If doorstation(camera) calls when you are on the line, you can hear chime and the caller appears on the monitor for 60 seconds.



Figure 10

TROUBLE SHOOTING GUIDE

Carefully read and perform the following procedures before returning your Video Doorphone for repair.

- If the Power Lamp fails to light, check that the Power On/Off Switch is in the On position.
Also, make sure that the plug of power supply is properly inserted into the AC outlet.
- If the Power Lamp is dim, there is a possible short in the wires between the Monitor and Camera.
- If there is audio, but no picture on the Monitor CRT, the brightness control may be incorrectly adjusted.(Too Low)

SPECIFICATIONS

● MONITOR

Wiring :	4 wires(Polarity)
Voltage Requirements :	AC 100-240V, 50/60Hz .
Power Consumption :	Maximum 16W; stand by 1W
Monitor Screen :	4" Flat type B/W C.R.T.
Call Tone :	Electronic Chime.
Audio Communication System :	Simultaneous.
Maximum Wiring Distance :	165ft.(22AWG wire) .
Video Lead Time :	60 secs \pm 5secs
Optimal Working Temperature :	0°C to + 40°C (+32°F to 104°F)
Dimensions :	213(W) \times 220(H) \times 80(D)mm

● CAMERA

Wiring :	4 wires(Polarity)
Voltage Requirements :	DC14V. (Provided from monitor)
CCD :	1/3" B/W C.C.D
Audio Communication System :	Simultaneous.
Frequency :	15.75KHz(H), 60Hz(V)
Angle :	68° (H), 55° (V)
Illumination :	0.1 Lux
Optimal Working Temperature :	-10°C to + 40°C (+14°F to 104°F)
Dimensions :	99(W) \times 140(H) \times 29(D)mm



Memo

COMMAX

COMMAX Co.,Ltd.

513-11, Sangdaewon-dong, Jungwon-gu, Seongnam-si, Gyeonggi-do, Korea

Int'l Business Dept. Tel. : +82-31-7393-540~550 Fax. : +82-31-745-2133

Web site : www.commax.com

Printed In Korea / 2011.11.104