

ALTERNATOR DIODE FOR AUTOMOTIVE APPLICATION.

#### FEATURES

- Average Forward Current :  $I_O=30A$ .
- Zener Voltage : 23V(Typ.)

#### POLARITY

E30A23VS E30A23VR

(+ Type) (- Type)

#### MAXIMUM RATING ( $T_a=25$ )

CHARACTERISTIC	SYMBOL	RATING	UNIT
Average Forward Current	$I_{F(AV)}$	30	A
Peak 1 Cycle Surge Current	$I_{FSM}$	300(50Hz)	A
Repetitive Peak Reverse Surge Current	$I_{RSM}$	30	A
Transient Peak Reverse Voltage	$V_{RSM}$	17	V
Peak Reverse Voltage	$V_{RM}$	17	V
Junction Temperature	$T_j$	-40 190	
Storage Temperature Range	$T_{stg}$	-40 150	

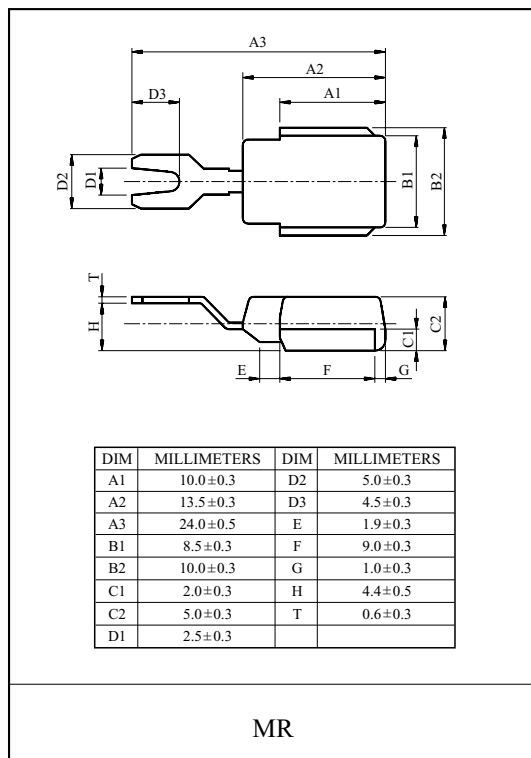

#### ELECTRICAL CHARACTERISTICS ( $T_a=25$ )

CHARACTERISTIC	SYMBOL	TEST CONDITION	MIN.	TYP.	MAX.	UNIT
Peak Forward Voltage	$V_{FM}$	$I_{FM}=100A$	-	-	1.2	V
Zener Voltage	$V_Z$	$I_Z=10mA$	20	23	26	V
Repetitive Peak Reverse Current	$I_{RRM}$	$V_R=V_{RM}$	-	-	10	$\mu A$
Transient Thermal Resistance	$V_F$	$I_{FM}=100A$	-	-	100	mV
Reverse Leakage Current Under High Temperature	HIR	$T_a=150$ , $V_R=V_{RM}$	-	-	2.5	mA
Reverse Recovery Time	$t_{rr}$	$I_F=100mA$ , $-I_R=100mA$ , 90% Recovery Point	-	-	1.5	$\mu s$
Temperature Resistance	$R_{th}$	DC total junction to case	-	-	1.0	/W

# E30A23VS, E30A23VR

