

1. Scope

The present specifications shall apply to an EL1.

2. Outline

Type	Silicon Diode
Structure	Resin Molded Flammability : UL94V-0 (Equivalent)
Applications	Pulse Rectification, etc.

3. Absolute maximum ratings

No.	Item	Symbol	Unit	Rating	Conditions
1	Transient Peak Reverse Voltage	V_{RSM}	V	400	
2	Peak Reverse Voltage	V_{RM}	V	400	
3	Average Forward Current	$I_{F(AV)}$	A	1.5	$T_c=114^{\circ}\text{C}$, sinewave
4	Peak Surge Forward Current	I_{FSM}	A	40	10msec. Half sinewave, one shot
5	I^2t Limiting Value	I^2t	A^2s	8	
6	Junction Temperature	T_j	$^{\circ}\text{C}$	-40~+150	
7	Storage Temperature	T_{stg}	$^{\circ}\text{C}$	-40~+150	

4. Electrical characteristics

No	Item	Symbol	Unit	Value	Conditions
1	Forward Voltage Drop	V_F	V	1.3 max.	$I_F=1.5\text{A}$
2	Reverse Leakage Current	I_R	μA	10 max.	$V_R=V_{RM}$
3	Reverse Leakage Current Under High Temperature	$H \cdot I_R$	μA	50 max.	$V_R=V_{RM}$, $T_j=150^{\circ}\text{C}$
4	Reverse Recovery Time	trr1	nsec	50 max.	$I_F=I_{RP}=100\text{mA}$, 90% Recovery point, $T_j=25^{\circ}\text{C}$
		trr2	nsec	35 max.	$I_F=100\text{mA}$, $I_{RP}=200\text{mA}$, 75% Recovery point, $T_j=25^{\circ}\text{C}$
5	Thermal Resistance	$R_{th(j-l)}$	$^{\circ}\text{C}/\text{W}$	17 max.	Between Junction and Lead

5. Characteristics

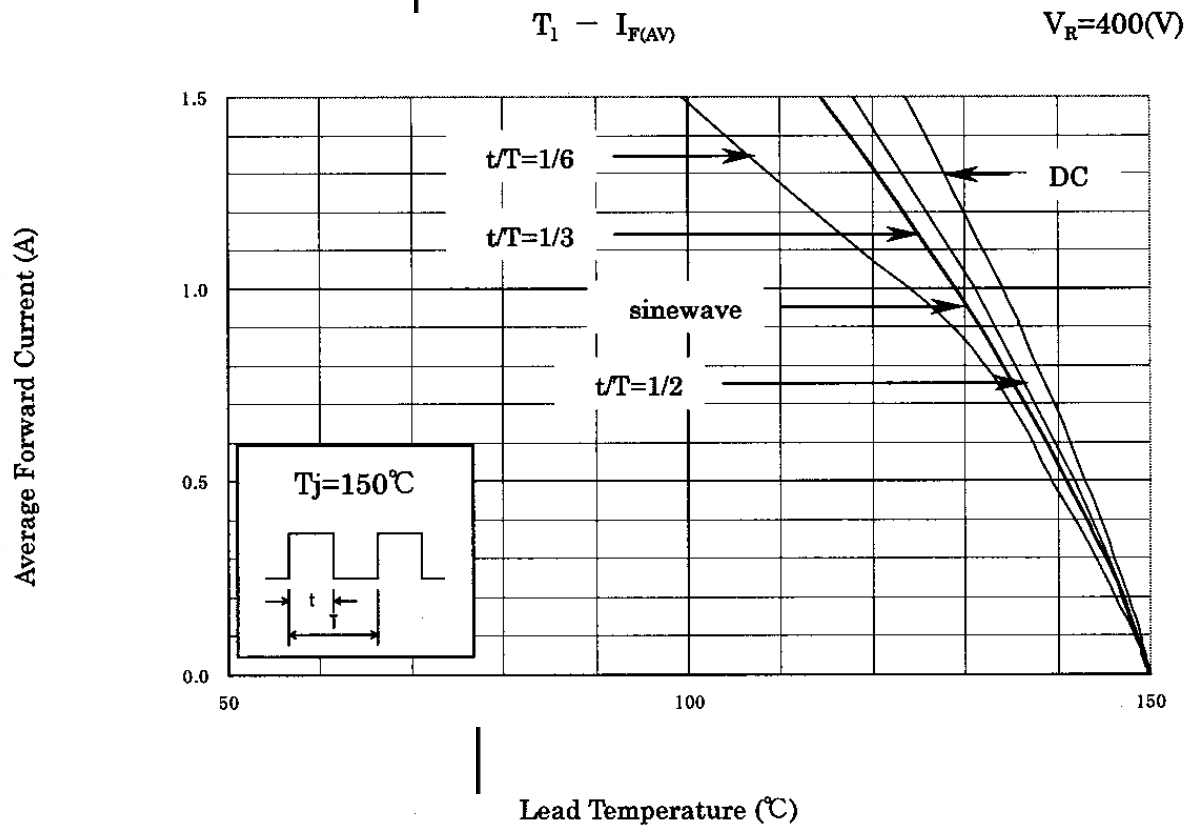
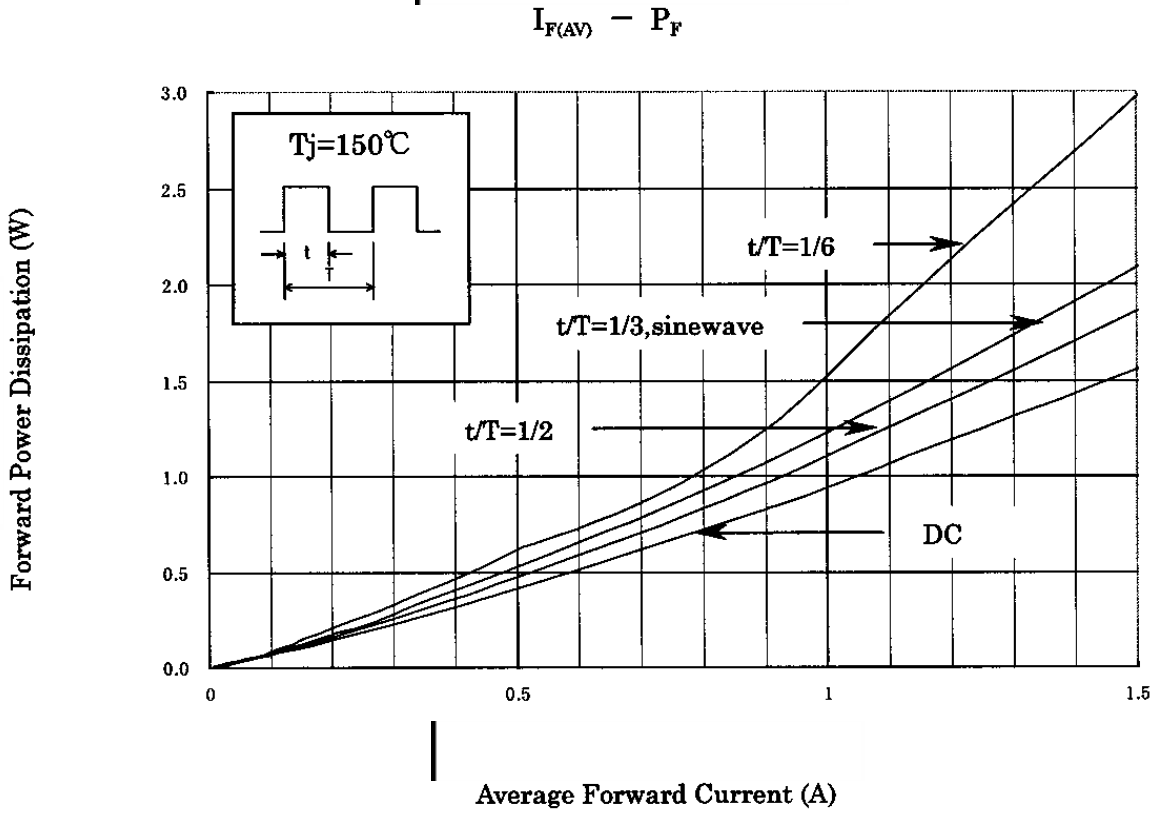

6. Packing information

6-1 Packing type

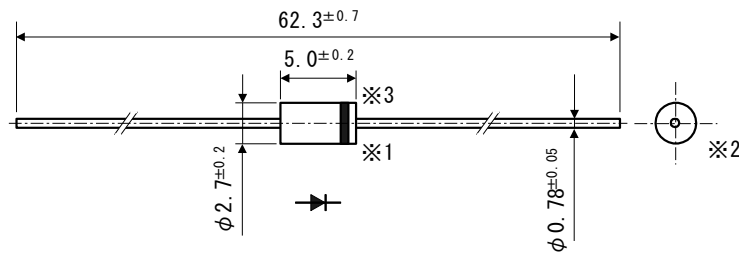

- *1 The allowance position of Body against the center of whole lead wire is 0.5mm(max.)
- *2 The centric allowance of lead wire against center of physical body is 0.3mm(max.)
- *3 The burr may exit up to 2mm from the body of lead

Dimensions in mm

6-2 Appearance

The body shall be clean and shall not bear any stain, rust or flaw.
The color of the case will be black.

6-3 Marking

Cathode Band

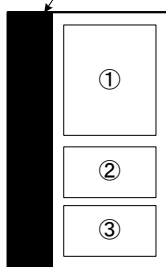

- ① Type number : EL1 is abbreviated as L1
- ② Lot number 1
First digit: Last digit of Year
Second digit: Month
From 1 to 9 for Jan. to Sep.
O for Oct., N for Nov., and D for Dec.
- ③ Lot number 2 (ten days)
· : (Top of the month)
·· : (Middle of month)
··· : (End of month)

The Type number and Lot number are to be marked in Silver.