

ÚÜQ	œÿÁÓPœÜœVòÜQVòUÁ
ÚÜÁ	ÏÍY Á
XÜY T Ê œ Á	Í ÈXÁ
QÜÁ	Í ÈOÁ
XôÁ	FÍ ÈXÁ
XóÜÊ ã Á	Î ÈXÁ
V _{RE} œ Á	FG °CÁ

ΕΙ ΕΗΑΑΑ ÜOÖSœOÖÒÀ

- Body Marking Example
Marking : \overline{R}

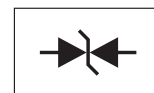

Bi-Directional

ØOÖ/WÜOÙÀ

- Á OÖÁ FœœÈ ÈGŠ^ç|Á ÒÜOÁ
] |{ ç & ç } ÈÁ
- Á Š |, Á œ œ ^ Á & || ^ } çÁÁ
- Á T [ã ç | ^ Á ^ } • ã ç Š^ç|Á

T ÒOÖPœP ÖOÖŠÖOÖVÖÁ

- Á Ôœ ^ : T [|á^áÁ | œ ç È ÈÁ
- Á Ú [| œ ç : Q á œ œ ^ á Á ^ Á œ Q á ^ Á œ á ÁÁ
- Á V^ | { ã ç Á Ö [| á ^ } Á | œ œ ^ á Á | { ã ç ÈÁ
• [| á ^ | œ œ | Á ^ | Á ^ ŠÈÜVÖÈ Í È Ê ^ ç á Á
GEG ÁÁÁ
- Á Ò [ç Á Á Š | È È Á œ œ á Á œ ^ Á
| ^ œ œ á ç Á

Maximum ratings (at T_A=25°C unless otherwise noted)

PARAMETER	CONDITIONS	Symbol	MIN.	TYP.	MAX.	UNIT
Peak pulse power	tp = 8/20us	P _{PP}			75	W
Peak pulse current	tp = 8/20us	I _{PP}			5	A
ESD per IEC 61000-4-2	Air discharge	ESD			±16	KV
	Contact discharge				±8	
Operating Junction temperature range		T _J	-55		+125	°C
Storage temperature range		T _{STG}	-55		+150	°C

Stresses exceeding Maximum Ratings may damage the device. Maximum Ratings are stress ratings only. Functional operation above the Recommended Operating Conditions is not implied. Extended exposure to stresses above the Recommended Operating Conditions may affect device reliability.

Electrical characteristics (at T_A=25°C unless otherwise noted)

Part No.	V _{RWM} (V) Max.	I _R (µA) @V _{RWM} Max.	I _T (mA)	V _{BR} (V) @I _T Min.	V _C (V) @I _{PP} =5A Max.	C _J (pF) @V _R =0V, F=1MHz Max.
ESD5FN5.0C	5.0	2.0	1.0	6.0	15	20

Over voltage available upon request.
1. V_{BR} is measured with a pulse test current I_T at an ambient temperature of 25°C.
2. Surge current waveform per Figure 1.

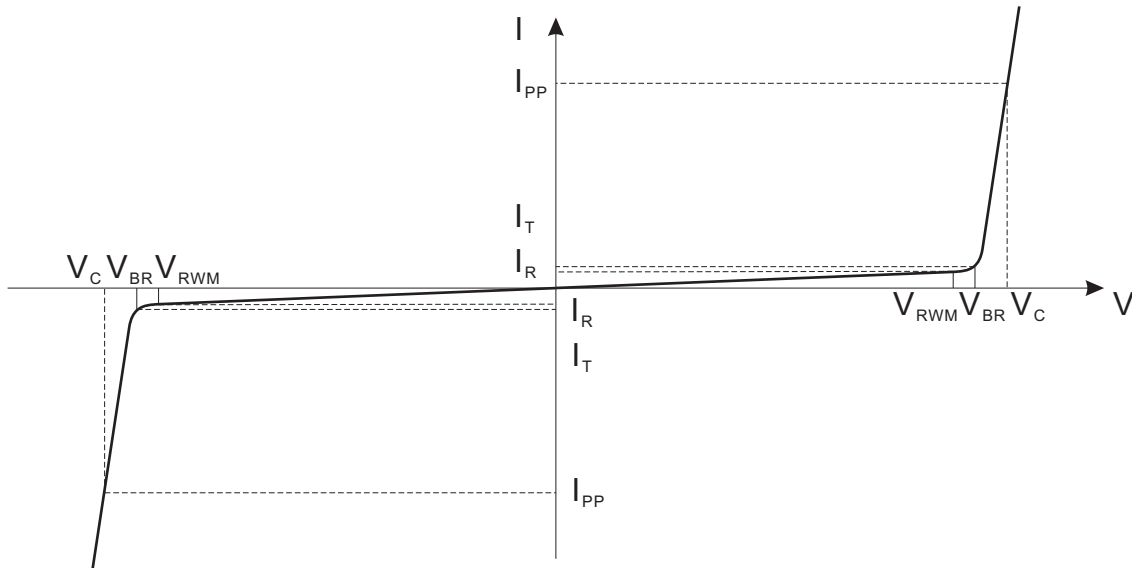
Typical characteristics (at $T_a=25^\circ\text{C}$ unless otherwise noted)

Bi-Directional TVS

V_C : Clamping Voltage @ I_{PP}

I_{PP} : Maximum Reverse Peak Pulse Current

V_{RWM} : Maximum Reverse Working voltage

I_R : Maximum Reverse Leakage Current @ V_{RWM}

V_{BR} : Breakdown voltage @ I_T

I_T : Test Current

P_{PP} : Peak Pulse Power

C_J : Max. Capacitance @ $V_R = 0\text{V}$ and $f = 1\text{MHz}$

Rating and characteristic curves (ESD5FN5.0C)

FIG.1- 8 X 20us PULSE WAVEFORM

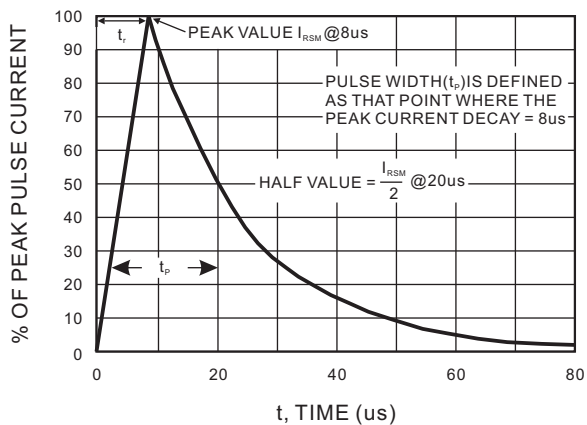

FIG.2- CLAMPING VOLTAGE VS. PEAK PULSE CURRENT

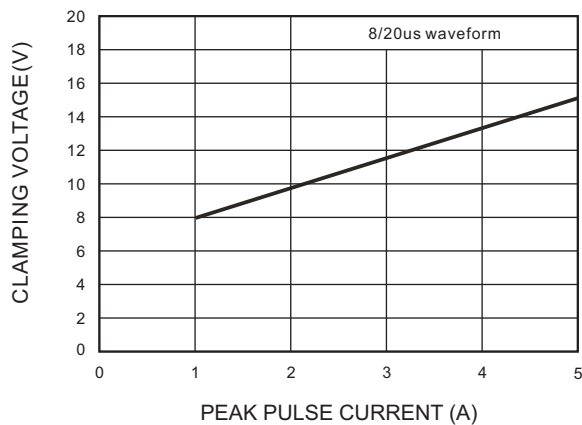

FIG.3- TERMINALS CHARACTERISTICS

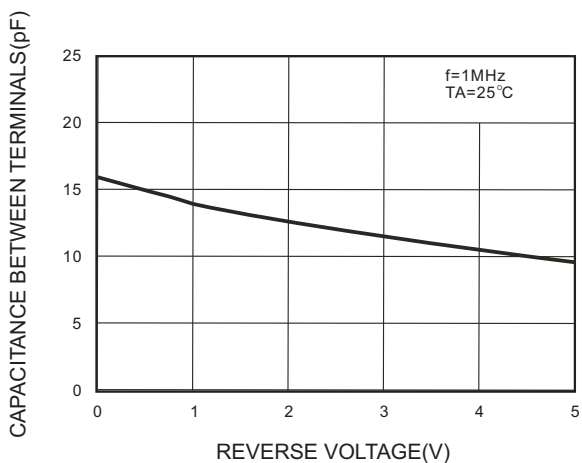
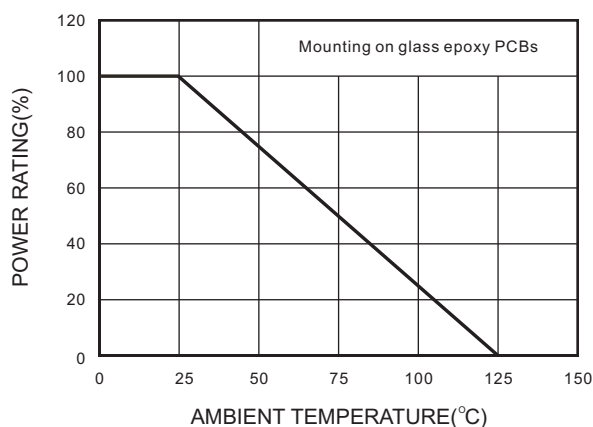
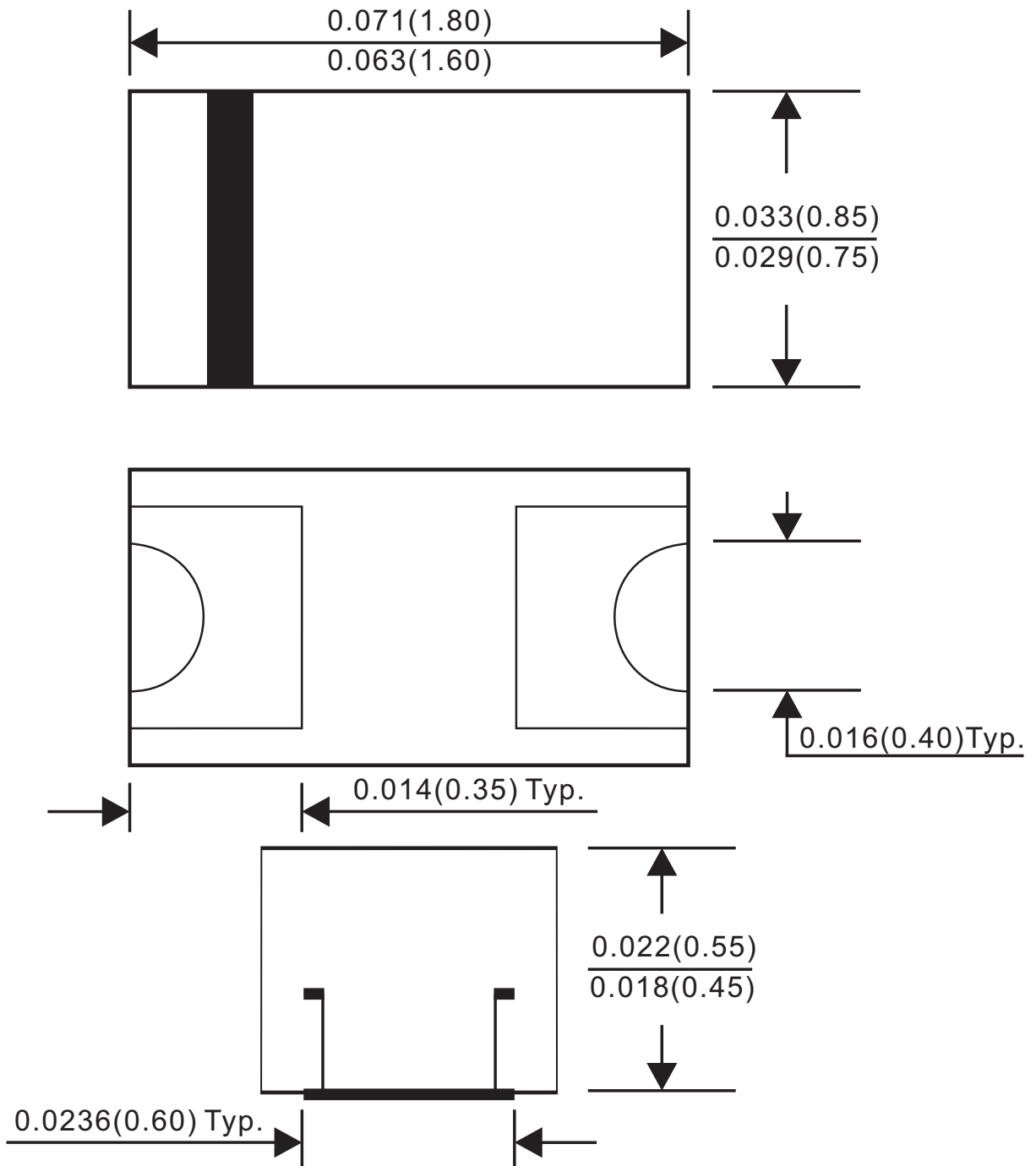

FIG.4- POWER RATING DERATING CURVE



Outline Drawing

0603



Dimensions in inches and (millimeters)

Rev.B

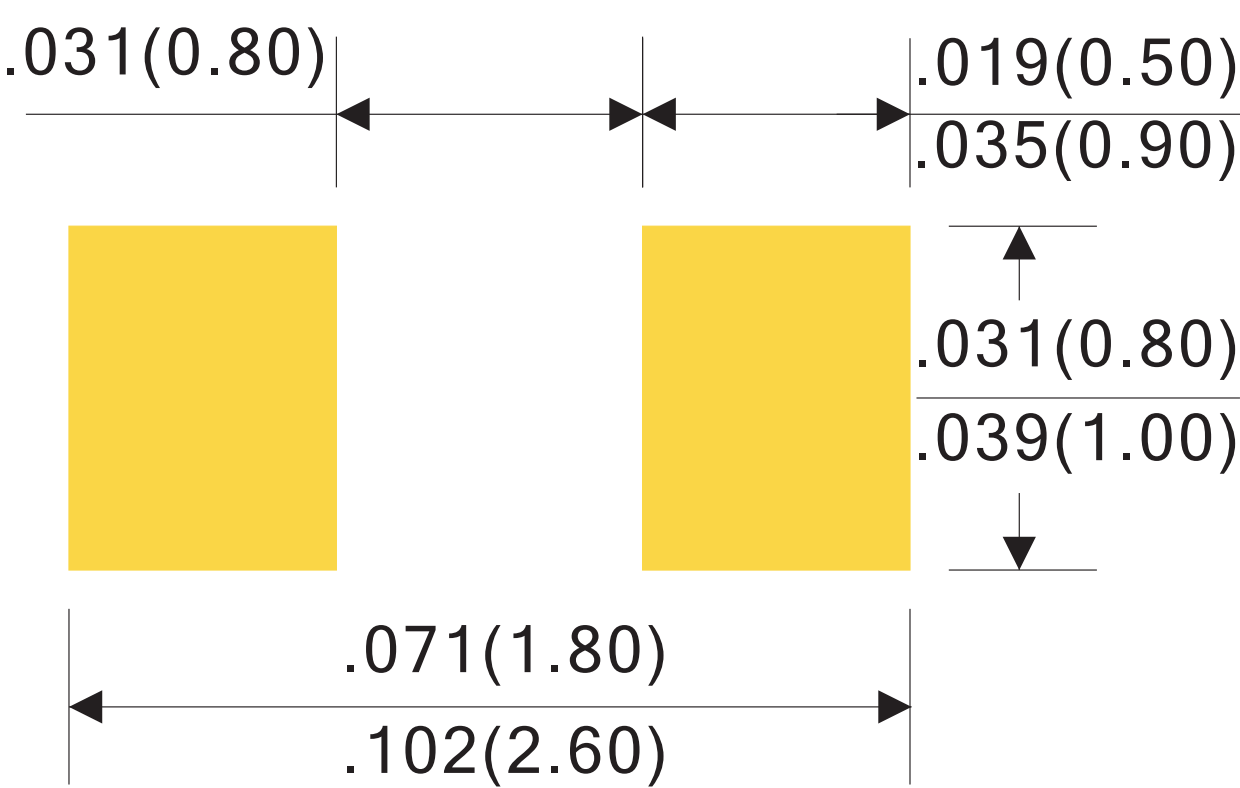
Suggested Soldering Pad Layout	0603
 <p>Dimensions in inches and (millimeters)</p>	
RevA	

Packing information

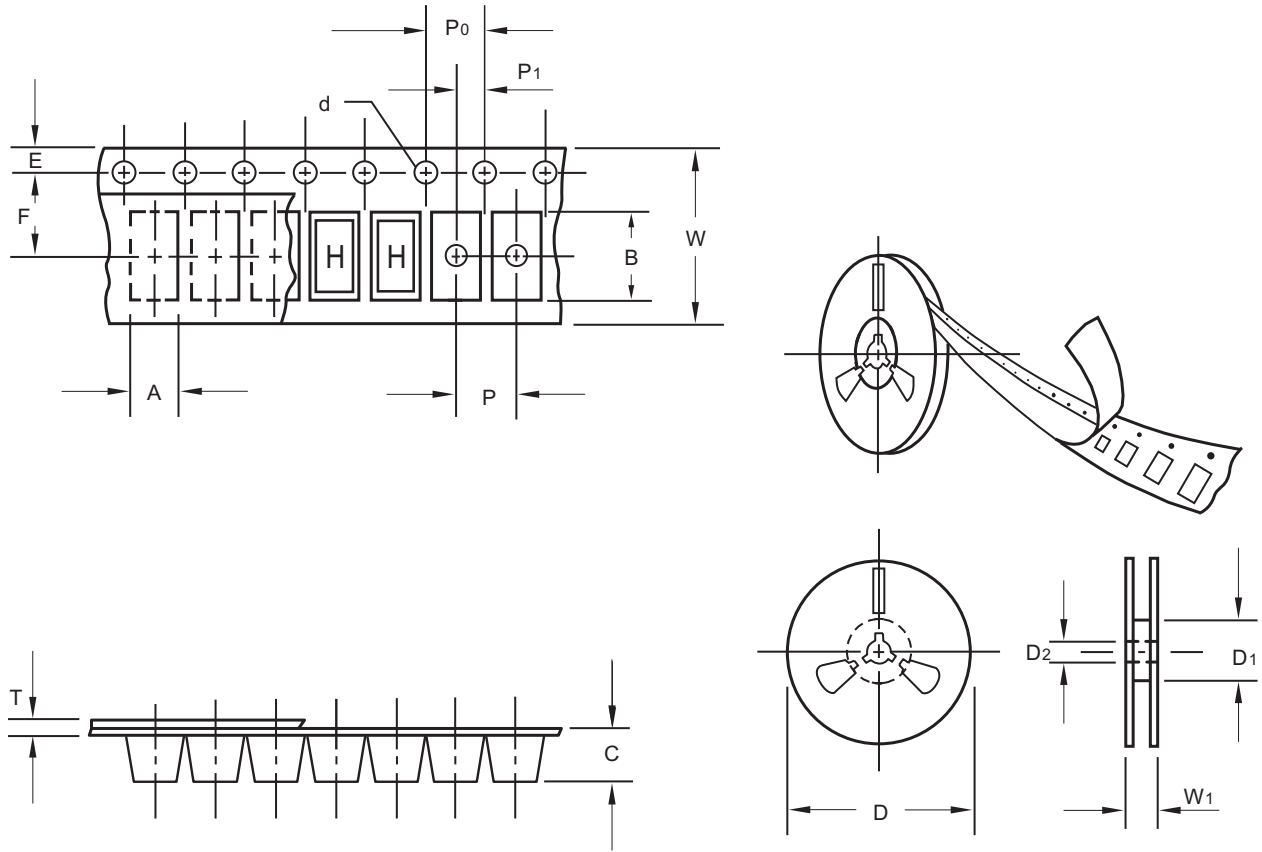

unit:mm

Item	Symbol	Tolerance	0603
Carrier width	A	0.1	1.00
Carrier length	B	0.1	1.80
Carrier depth	C	0.1	0.65
Sprocket hole	d	0.1	1.50
13" Reel outside diameter	D	2.0	-
13" Reel inner diameter	D ₁	min	-
7" Reel outside diameter	D	2.0	178.00
7" Reel inner diameter	D ₁	min	62.00
Feed hole diameter	D ₂	0.5	13.00
Sprocket hole position	E	0.1	1.75
Punch hole position	F	0.05	3.50
Punch hole pitch	P	0.1	4.00
Sprocket hole pitch	P ₀	0.1	4.00
Embossment center	P ₁	0.05	2.00
Overall tape thickness	T	0.1	0.23
Tape width	W	0.1	8.00
Reel width	W ₁	1.0	11.40

Note: Devices are packed in accordance with EIA standard 481-D and specifications listed above.

Ordering Information:

Device PN	Packing
ESD5FN5.0# -T ⁽¹⁾ H ⁽²⁾ -WS	Tape&Reel: 5 Kpcs/Reel

Note: (1) Packing code, Tape & Reel Packing

(2) Halogen free product for packing code suffix "H"

*****Disclaimer*****

WILLAS reserves the right to make changes without notice to any product specification herein, to make corrections, modifications, enhancements or other changes. WILLAS or anyone on its behalf assumes no responsibility or liability for any errors or inaccuracies. Data sheet specifications and its information contained are intended to provide a product description only. "Typical" parameters which may be included on WILLAS data sheets and/ or specifications can and do vary in different applications and actual performance may vary over time. WILLAS does not assume any liability arising out of the application or use of any product or circuit.

This is the preliminary specification. WILLAS products are not designed, intended or authorized for use in medical, life-saving implant or other applications intended for life-sustaining or other related applications where a failure or malfunction of component or circuitry may directly or indirectly cause injury or threaten a life without expressed written approval of WILLAS. Customers using or selling WILLAS components for use in such applications do so at their own risk and shall agree to fully indemnify WILLAS Inc and its subsidiaries harmless against all claims, damages and expenditures.